

Submit to Appropriate
District Office
State Lease - 4 copies
Fee Lease - 3 copies

Energy, Minerals and Natural Resources Department

Form C-102
Revised 1-1-89

CONSERVATION DIVISION

P.O. Box 2088

Santa Fe, New Mexico 87504-2088

DISTRICT I
P.O. Box 1980, Hobbs, NM 88240

DISTRICT II
P.O. Drawer DD, Artesia, NM 88210

DISTRICT III
1000 Rio Brazos Rd., Aztec, NM 87410

WELL LOCATION AND ACREAGE DEDICATION PLAT

All Distances must be from the outer boundaries of the section

Operator The Wiser Oil Company			Lease State "17"		Well No. 9
Unit Letter F	Section 17	Township 17 South	Range 33 East	County Lea	
Actual Footage Location of Well: 1335 feet from the North line and 1335 feet from the West line					
Ground level Elev. 4202	Producing Formation Grayburg & San Andres		Pool Maljamar Grayburg San Andres	Dedicated Acreage: 40 Acres	
<p>1. Outline the acreage dedicated to the subject well by colored pencil or hatchure marks on the plat below.</p> <p>2. If more than one lease is dedicated to the well, outline each and identify the ownership thereof (both as to working interest and royalty).</p> <p>3. If more than one lease of different ownership is dedicated to the well, have the interest of all owners been consolidated by communitization, unitization, force-pooling, etc.? <input type="checkbox"/> Yes <input type="checkbox"/> No If answer is "yes" type of consolidation _____</p> <p>If answer is "no" list the owners and tract descriptions which have actually been consolidated. (Use reverse side of this form if necessary.) _____</p> <p>No allowable will be assigned to the well until all interests have been consolidated (by communitization, unitization, forced-pooling, or otherwise) or until a non-standard unit, eliminating such interest, has been approved by the Division.</p>					

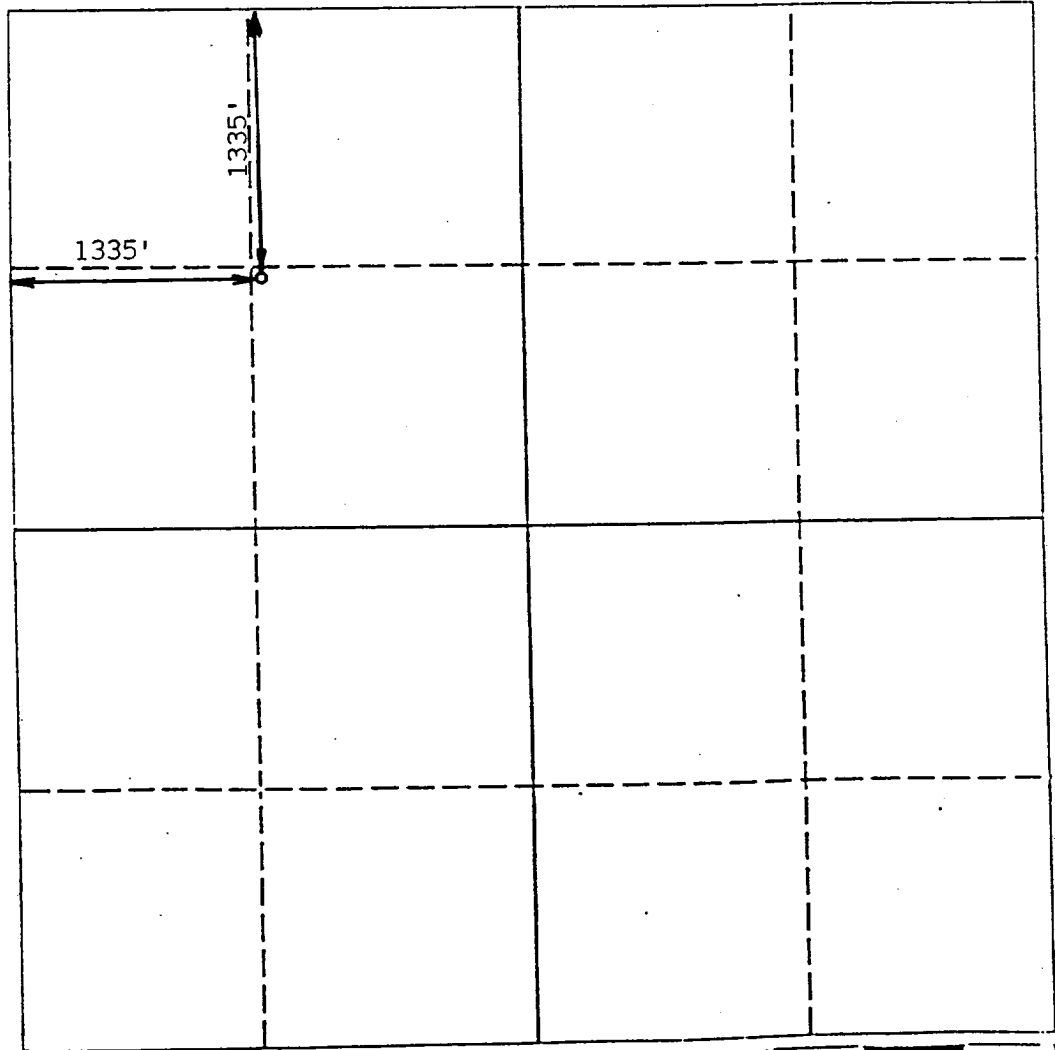

OPERATOR CERTIFICATION	
I hereby certify that the information contained herein is true and complete to the best of my knowledge and belief.	
Signature	Perry L. Hughes
Printed Name	Perry L. Hughes
Position	Agent
Company	The Wiser Oil Co.
Date	January 26, 1994
SURVEYOR CERTIFICATION	
I hereby certify that the well location shown on this plat was plotted from field notes of actual surveys made by me or under my supervision, and that the same is true and correct to the best of my knowledge and belief.	
Date Surveyed	June 22, 1993
Signature & Seal of Professional Surveyor	P.R. Patton
Certificate No.	8112