

OPER. OGRID NO. 30

IMMISSION

FORM APPROVED
OMB NO. 1004-0136
Expires: February 28, 1995

DEPARTMENT
BUREAU

PROPERTY NO. 14578

st ns on
88240

POOL CODE 43320

EFF. DATE 5/3/96

API NO. 30-025-33412

APPLICATION

1a TYPE OF WORK

DRILL ☒

b. TYPE OF WELL

OIL
WELL ☒

GAS
WELL ☐

OTHER

SINGLE
ZONE ☐

MULTIPLE
ZONE ☐

2. NAME OF OPERATOR

The Wiser Oil Company

3. ADDRESS AND TELEPHONE NO.

c/o J. O. Easley, Inc., P. O. Box 1796, Roswell, NM 88201-1796 (505) 623-3758

4. LOCATION OF WELL (Report location clearly and in accordance with any State requirements.)*

At Surface 2610' FSL & 1290' FEL, Unit I

At proposed prod. Zone 2610' FSL & 1290' FEL, Unit I

UNORTHODOX
LOCATION:
Subject to
Like Approval
By State

5. LEASE DESIGNATION AND SERIAL NO.

LC-059152-B

6. IF INDIAN, ALLOTTEE OR TRIBE NAME

7. UNIT AGREEMENT NAME

Caprock Maljamar Unit

8. FARM OR LEASE NAME, WELL NO.

#188

9. API WELL NO.

30-025-

10. FIELD AND POOL OR WILDCAT

Maljamar Grayburg San Andres

11. SEC., T., R., M., OR BLK.
AND SURVEY OR AREA

24, 17S-32E, N.M.P.M.

14. DISTANCE IN MILES AND DIRECTION FROM NEAREST TOWN OR POST OFFICE*

± 4 miles Southeast of Maljamar, New Mexico

12. COUNTY FOR PARISH

Lea

13. STATE

NM

15. DISTANCE FROM PROPOSED *

LOCATION TO NEAREST

PROPERTY OR LEASE LINE, FT. 1290'

(Also to nearest drlg. unit line, if any)

16. NO. OF ACRES IN LEASE

480.00

17. NO. OF ACRES ASSIGNED

TO THIS WELL

40

18. DISTANCE FROM PROPOSED LOCATION *

TO NEAREST WELL, DRILLING, COMPLETED 893'

OR APPLIED FOR, ON THIS LEASE, FT.

19. PROPOSED DEPTH

4800'

20. ROTARY OR CABLE TOOLS

Rotary

21. ELEVATIONS (Show whether DF, RT, GR, etc.)

4083'

22. APPROX. DATE WORK WILL START *

January 1, 1997

23. PROPOSED CASING AND CEMENTING PROGRAM

SIZE OF HOLE	GRADE, SIZE OF CASING	WEIGHT PER FOOT	SETTING DEPTH	QUANTITY OF CEMENT
12 1/4"	8 5/8" J-55	24#	550'	Circulate
7 7/8"	5 1/2" J-55	17#	4800'	Sufficient to bring cmt 100'
				above 8 5/8" casing shoe.

Duration of Program: Drilling - Nine (9) days

Completion - Thirty (30) days

See attached for complete Drilling Program

Subject to
General Requirements and
Special Stipulations
Attached

EXHIBITS

Exhibit "A": Drilling Program

Exhibit "D": Land Survey Plat

Exhibit "G": Rig Layout

Exhibit "B": H₂S Plan

Exhibit "E": Location Plat

Exhibit "H": BOP Layout

Exhibit "C": Surface Use Plan

Exhibit "F": Existing Well Plat

IN ABOVE SPACE DESCRIBE PROPOSED PROGRAM: If proposal is to deepen, give data on present productive zone and proposed new productive zone. If proposal is to drill or deepen directionally, give pertinent data on subsurface locations and measured and true vertical depths. Give blowout preventer program, if any.

24.

SIGNED

Michael R. Burch

TITLE

Agent for The Wiser Oil Company

DATE

4-2-96

Michael R. Burch, CPL

This space for Federal or State office use)

PERMIT NO.

APPROVAL DATE

Application approval does not warrant or certify that the applicant holds legal or equitable title to those rights in the subject lease which would entitle the applicant to conduct operations thereon.

CONDITIONS OF APPROVAL, IF ANY:

APPROVED BY

Timothy P. O'Brien

TITLE

Adm.

DATE

4-2-96

*See Instructions On Reverse Side

Title 18 U.S.C. Section 1001, makes it a crime for any person knowingly and willfully to make to any department or agency of the United States any false, fictitious or fraudulent statements or representations as to any matter within its jurisdiction.

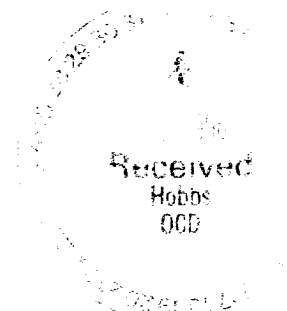

16					<div>17 OPERATOR CERTIFICATION</div> <div>I hereby certify that the information contained herein is true and complete to the best of my knowledge and belief.</div> <div>Michael R. Burch</div> <div>Signature</div> <div>MICHAEL R. BURCH</div> <div>Printed Name</div> <div>AGENT FOR THE WISER OIL CO.</div> <div>Title</div> <div>4-2-96</div> <div>Date</div>
					<div>18 SURVEYOR CERTIFICATION</div> <div>I hereby certify that the well location shown on this plat was plotted from field notes of actual surveys made by me or under my supervision, and that the same is true and correct to the best of my belief.</div> <div>February 27, 1996</div> <div>Date of Survey</div> <div>P. R. Patton</div> <div>Signature and Seal of Professional Surveyor</div> <div></div> <div>Certificate Number</div> <div>8112</div>



EXHIBIT "A"

DRILLING PROGRAM

I. The geological surface formation is recent Permian with quaternary alluvium and other surficial deposits.

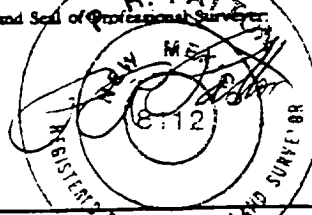
II. Estimated Tops of Geological Markers:

<u>FORMATION</u>	<u>DEPTH</u>
Rustler Anhydrite	540'
Top of Salt	670'
Base of Salt	1570'
Queen	2650'
Grayburg	3050'
San Andres	3430'
TD	4800'

III. Estimated depths at which water, oil, gas, or other mineral-bearing formations are expected to be encountered:

<u>SUBSTANCE</u>	<u>DEPTH</u>
Fresh Water	There is little, if any, in this section
Oil	Fren 7-Rivers; Grayburg and San Andres below 3200'
Gas	None anticipated

IV. A. Proposed Casing Program:

<u>HOLE SIZE</u>	<u>CASING SIZE</u>	<u>GRADE</u>	<u>WEIGHT PER FOOT</u>	<u>DEPTH</u>
12 ¼"	8 5/8"	New 8RD ST&C J-55	24#	550'
7 7/8"	5 ½"	New 8RD LT&C J-55	17#	4800'

B. Proposed Cement Program:

8 5/8" Cmt w/ 300 sx Class "C" cmt w/2% CaCl. Circulate to surface.

5 1/2" Cmt w/ 700 sx Halliburton Lite w/1/4# Flocele, 325 sx Premium Plus w/.5% Halad-9, & 325 sx Premium Plus w/.5% Halad-344 w/3% KCl.

The top of cement is designed to reach 100' above 8 5/8" casing shoe.

V. Proposed Mud Program:

The well will be drilled to total depth using brine & fresh water. Depths of systems are as follows:

<u>INTERVAL</u>	<u>MUD TYPE</u>	<u>MUD WT.</u>	<u>VISCOSITY</u>
0-550'	Fresh Water	8.8 ppg	30
550'-TD	Brine Water	9.5-10.5 ppg	28

VI. Proposed Control Equipment:

Will install on the 8 5/8" surface casing a 10" Series 900 Type "E" Shaffer Double Hydraulic BOP and will test before drilling in the Queen formation. BOP working pressure: 3000 psi. See Exhibit "H" for BOP layout.

VII. Auxiliary Equipment:

Blowout preventor, gas detector, kelly cock, pit level monitor, flow sensors, and stabbing valve.

VIII A. Testing Program:

Drill Stem Tests: None planned

B. Logging Program:

<u>LOG</u>	<u>Interval</u>
GR-DLL-MSFL-Cal	T.D. - 2,300'
GR-CNL-CDL-Cal	T.D. - Surface

C. Coring Program:

None planned

- IX No abnormal pressures or temperatures are anticipated. In the event abnormal pressures are encountered, the proposed mud program will be modified to increase the mud weight. The estimated maximum bottom hole pressure is 1980 psi.

BOP & CHOKE MANIFOLD

12"/900 Cameron SS Space Saver
3000# Working Pressure
3000# Working Pressure Choke Manifold

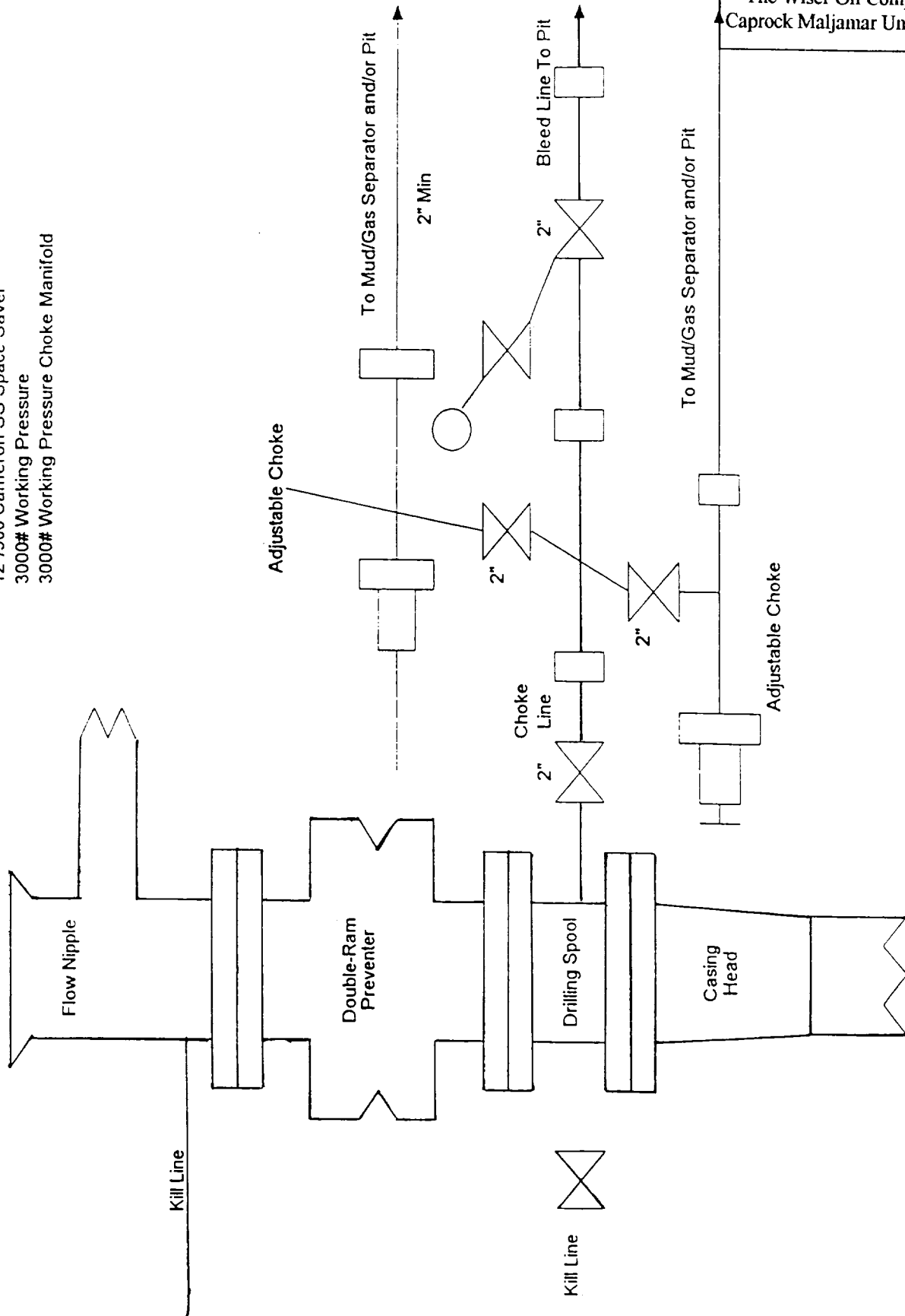

EXHIBIT "H"

BOP LAYOUT

The Wiser Oil Company
Caprock Maljamar Unit #188

