

OPER. OGRID NO. 22922

ON

UNITED STATES
DEPARTMENT OF THE
BUREAU OF LAND MANAGEMENT

PROPERTY NO. 14578

POOL CODE 43320

EFF. DATE 5/7/96

API NO. 30-025-33422

FORM APPROVED
OMB NO. 1004-0136
Expires: February 28, 1995

5. LEASE DESIGNATION AND SERIAL NO.

LC-059152-B

6. IF INDIAN, ALLOTTEE OR TRIBE NAME

APPLICATION FOR PERMIT

1a. TYPE OF WORK

DRILL ☒

DEEPCEN ☐

b. TYPE OF WELL

OIL
WELL ☒

GAS
WELL ☐

OTHER

SINGLE
ZONE ☐

MULTIPLE
ZONE ☐

2. NAME OF OPERATOR

The Wiser Oil Company

3. ADDRESS AND TELEPHONE NO.

c/o J. O. Easley, Inc., P. O. Box 1796, Roswell, NM 88201-1796 (505) 623-3758

4. LOCATION OF WELL (Report location clearly and in accordance with any State requirements.)*

At Surface 2568' FSL & 1094' FWL, Unit L

At proposed prod. Zone 2568' FSL & 1094' FWL, Unit L

UNORTHODOX Subject to
LOCATION: Like Approval
By State

7. UNIT AGREEMENT NAME

Caprock Maljamar Unit

8. FARM OR LEASE NAME, WELL NO.

#186

9. API WELL NO.

30-025-

10. FIELD AND POOL OR WILDCAT

Maljamar Grayburg San Andres

11. SEC., T., R., M., OR BLK.
AND SURVEY OR AREA

24, 17S-32E, N.M.P.M.

14. DISTANCE IN MILES AND DIRECTION FROM NEAREST TOWN OR POST OFFICE*

± 3.4 miles Southeast of Maljamar, New Mexico

12. COUNTY FOR PARISH

Lea

13. STATE

NM

15. DISTANCE FROM PROPOSED *

LOCATION TO NEAREST

PROPERTY OR LEASE LINE, FT.

1094'

(Also to nearest drlg. unit line, if any)

16. NO. OF ACRES IN LEASE

480.00

17. NO. OF ACRES ASSIGNED
TO THIS WELL

40

18. DISTANCE FROM PROPOSED LOCATION *

TO NEAREST WELL, DRILLING, COMPLETED
OR APPLIED FOR, ON THIS LEASE, FT.

686'

19. PROPOSED DEPTH

4800'

20. ROTARY OR CABLE TOOLS

Rotary

21. ELEVATIONS (Show whether DF, RT, GR, etc.)

4047'

Roswell Controlled Water Basin

22. APPROX. DATE WORK WILL START *

May 1, 1996

23. PROPOSED CASING AND CEMENTING PROGRAM

SIZE OF HOLE	GRADE, SIZE OF CASING	WEIGHT PER FOOT	SETTING DEPTH	QUANTITY OF CEMENT
12 1/4"	8 5/8" J-55	24#	550'	Circulate
7 7/8"	5 1/2" J-55	17#	4800'	Sufficient to bring cmt 100' above 8 5/8" casing shoe.

Duration of Program: Drilling - Nine (9) days

Completion - Thirty (30) days

See attached for complete Drilling Program

Approval Subject to
General Requirements and
Special Stipulations
Attached

Exhibit "A": Drilling Program

Exhibit "D": Land Survey Plat

Exhibit "G": Rig Layout

Exhibit "B": H₂S Plan

Exhibit "E": Location Plat

Exhibit "H": BOP Layout

Exhibit "C": Surface Use Plan

Exhibit "F": Existing Well Plat

IN ABOVE SPACE DESCRIBE PROPOSED PROGRAM: If proposal is to deepen, give data on present productive zone and proposed new productive zone. If proposal is to drill or deepen directionally, give pertinent data on subsurface locations and measured and true vertical depths. Give blowout preventer program, if any.

24.

SIGNED

Michael R. Burch

TITLE

Agent for The Wiser Oil Company

DATE

4-2-96

Michael R. Burch, CPL

This space for Federal or State office use)

PERMIT NO.

APPROVAL DATE

Application approval does not warrant or certify that the applicant holds legal or equitable title to those rights in the subject lease which would entitle the applicant to conduct operations thereon.

CONDITIONS OF APPROVAL, IF ANY:

APPROVED BY (ORIG) SGD) RICHARD L. MANUS

TITLE

DATE

May 1, 1996

*See Instructions On Reverse Side

Title 18 U.S.C. Section 1001, makes it a crime for any person knowingly and willfully to make to any department or agency of the United States any false, fictitious or fraudulent statements or representations as to any matter within its jurisdiction.

EXHIBIT "A"

DRILLING PROGRAM

I. The geological surface formation is recent Permian with quaternary alluvium and other surficial deposits.

II. Estimated Tops of Geological Markers:

<u>FORMATION</u>	<u>DEPTH</u>
Rustler Anhydrite	540'
Top of Salt	670'
Base of Salt	1570'
Queen	2650'
Grayburg	3050'
San Andres	3430'
TD	4800'

III. Estimated depths at which water, oil, gas, or other mineral-bearing formations are expected to be encountered:

<u>SUBSTANCE</u>	<u>DEPTH</u>
Fresh Water	There is little, if any, in this section
Oil	Fren 7-Rivers; Grayburg and San Andres below 3200'
Gas	None anticipated

IV. A. Proposed Casing Program:

<u>HOLE SIZE</u>	<u>CASING SIZE</u>	<u>GRADE</u>	<u>WEIGHT PER FOOT</u>	<u>DEPTH</u>
12 ¼"	8 5/8"	New 8RD ST&C J-55	24#	550'
7 7/8"	5 ½"	New 8RD LT&C J-55	17#	4800'

B. Proposed Cement Program:

8 5/8" Cmt w/ 300 sx Class "C" cmt w/2% CaCl. Circulate to surface.

5 1/2" Cmt w/ 700 sx Halliburton Lite w/1/4# Flocele, 325 sx Premium Plus w/.5% Halad-9, & 325 sx Premium Plus w/.5% Halad-344 w/3% KCl.

The top of cement is designed to reach 100' above 8 5/8" casing shoe.

V. Proposed Mud Program:

The well will be drilled to total depth using brine & fresh water. Depths of systems are as follows:

<u>INTERVAL</u>	<u>MUD TYPE</u>	<u>MUD WT.</u>	<u>VISCOSITY</u>
0-550'	Fresh Water	8.8 ppg	30
550'-TD	Brine Water	9.5-10.5 ppg	28

VI. Proposed Control Equipment:

Will install on the 8 5/8" surface casing a 10" Series 900 Type "E" Shaffer Double Hydraulic BOP and will test before drilling in the Queen formation. BOP working pressure: 3000 psi. See Exhibit "H" for BOP layout.

VII. Auxiliary Equipment:

Blowout preventor, gas detector, kelly cock, pit level monitor, flow sensors, and stabbing valve.

VIII A. Testing Program:

Drill Stem Tests: None planned

B. Logging Program:

<u>LOG</u>	<u>Interval</u>
GR-DLL-MSFL-Cal	T.D. - 2,300'
GR-CNL-CDL-Cal	T.D. - Surface

C. Coring Program:

None planned

- IX No abnormal pressures or temperatures are anticipated. In the event abnormal pressures are encountered, the proposed mud program will be modified to increase the mud weight. The estimated maximum bottom hole pressure is 1980 psi.

BOP & CHOKE MANIFOLD

12"/900 Cameron SS Space Saver
 3000# Working Pressure
 3000# Working Pressure Choke Manifold

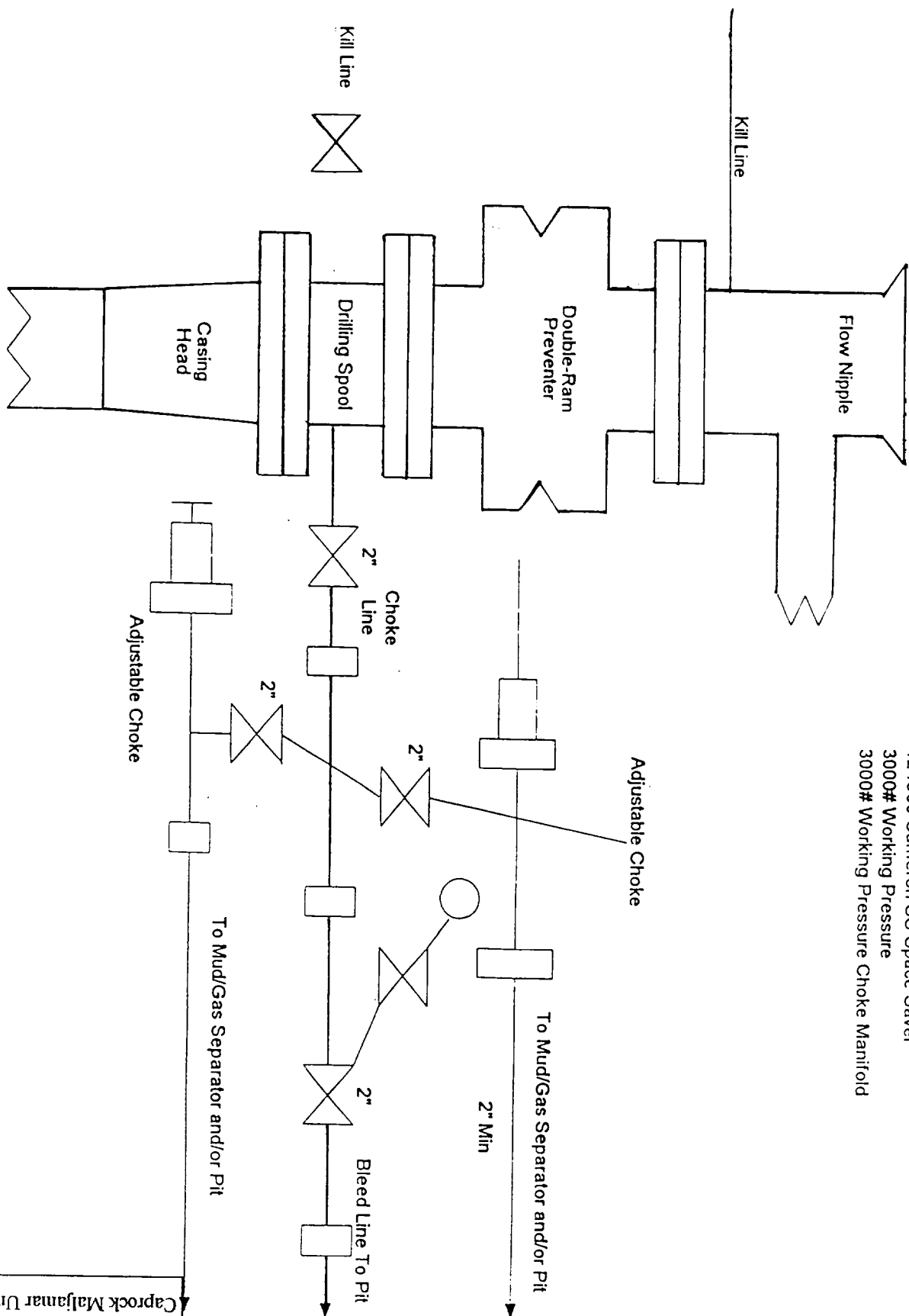

EXHIBIT "H"
 BOP LAYOUT

The Wiser Oil Company
 Caprock Maljamar Unit #186

Received
Hobbs
OCD
JAN 18 1920 21

District I
PO Box 1980, Hobbs, NM 88241-1980
District II
PO Drawer DD, Artesia, NM 88211-0719
District III
1000 Rio Brazos Rd., Aztec, NM 87410
District IV
PO Box 2083, Santa Fe, NM 87504-2083

State of New Mexico
Energy, Minerals & Natural Resources Department

OIL CONSERVATION DIVISION
PO Box 2088
Santa Fe, NM 87504-2088

EXHIBIT "D"

Form C-102
Revised February 10, 1994
Instructions on back
Submit to Appropriate District Office
State Lease - 4 Copies
Fee Lease - 3 Copies

☐ AMENDED REPORT

WELL LOCATION AND ACREAGE DEDICATION PLAT

API Number 30-025-33422	Pool Code 43320	Pool Name MALJAMAR GRAYBURG SAN ANDRES
Property Code 14578	Property Name Caprock Maljamar Unit	Well Number 186
OGRID No. 22922	Operator Name The Wiser Oil Company	Elevation 4047'

¹⁰ Surface Location

UL or lot no.	Section	Township	Range	Lot Idn	Feet from the	North/South line	Feet from the	East/West line	County
L	24	17 S	32 E		2568	South	1094	West	Lea

¹¹ Bottom Hole Location If Different From Surface

UL or lot no.	Section	Township	Range	Lot Idn	Feet from the	North/South line	Feet from the	East/West line	County

¹² Dedicated Acres 40	¹³ Joint or Infill	¹⁴ Consolidation Code	¹⁵ Order No.
--	-------------------------------	----------------------------------	-------------------------

NO ALLOWABLE WILL BE ASSIGNED TO THIS COMPLETION UNTIL ALL INTERESTS HAVE BEEN CONSOLIDATED
OR A NON-STANDARD UNIT HAS BEEN APPROVED BY THE DIVISION

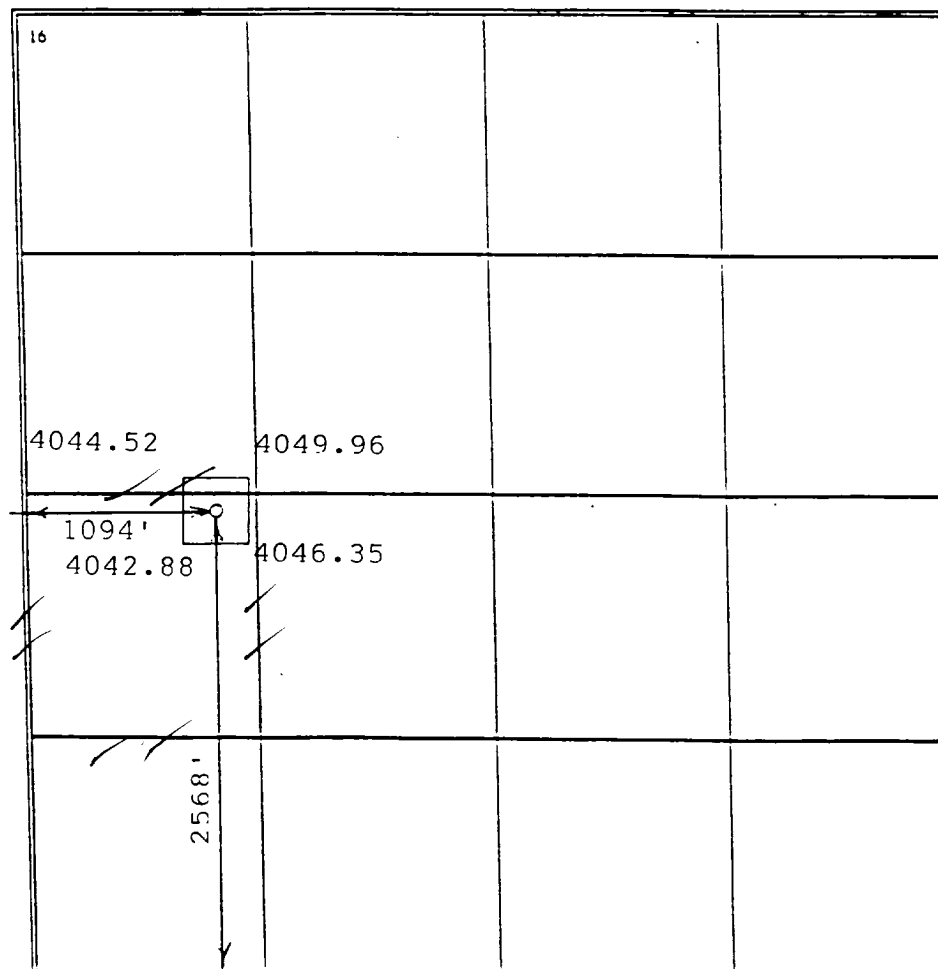
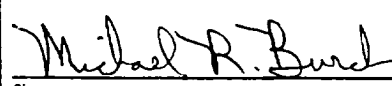
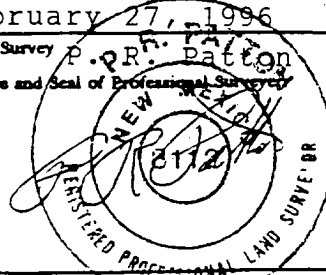
<div>16</div> <div></div>	<div>17 OPERATOR CERTIFICATION</div> <div>I hereby certify that the information contained herein is true and complete to the best of my knowledge and belief.</div> <div> Signature MICHAEL R. BURCH Printed Name AGENT FOR THE WISER OIL CO. Title 4-2-96 Date</div>
	<div>18 SURVEYOR CERTIFICATION</div> <div>I hereby certify that the well location shown on this plat was plotted from field notes of actual surveys made by me or under my supervision, and that the same is true and correct to the best of my belief.</div> <div>February 27, 1996 Date of Survey P. P. R. Patton Signature and Seal of Professional Surveyor  Certificate Number 8112</div>