

DEPARTMENT OF THE
BUREAU OF LAND MANAGEMENT

APPLICATION FOR PERMIT

1a. TYPE OF WORK

DRILL ☒

b. TYPE OF WELL

OIL
WELL ☐

GAS
WELL ☐

OTHER Water Injection

SINGLE
ZONE ☐

MULTIPLE
ZONE ☐

2. NAME OF OPERATOR

The Wiser Oil Company

3. ADDRESS AND TELEPHONE NO.

c/o J. O. Easley, Inc., P. O. Box 1796, Roswell, NM 88201-1796 (505) 623-3758

4. LOCATION OF WELL (Report location clearly and in accordance with any State requirements.)*

At Surface 730' FSL & 2045' FEL, Unit O

At proposed prod. Zone 730' FSL & 2045' FEL, Unit O

14. DISTANCE IN MILES AND DIRECTION FROM NEAREST TOWN OR POST OFFICE*

± 3.2 miles Southeast of Maljamar, New Mexico

15. DISTANCE FROM PROPOSED

LOCATION TO NEAREST

PROPERTY OR LEASE LINE, FT. 590'
(Also to nearest drlg. unit line, if any)

16. NO. OF ACRES IN LEASE

160.00

17. NO. OF ACRES ASSIGNED
TO THIS WELL

40

18. DISTANCE FROM PROPOSED LOCATION *

TO NEAREST WELL, DRILLING, COMPLETED
OR APPLIED FOR, ON THIS LEASE, FT. 100'

19. PROPOSED DEPTH

4800'

20. ROTARY OR CABLE TOOLS

Rotary

21. ELEVATIONS (Show whether DF, RT, GR, etc.)

4072'

22. APPROX. DATE WORK WILL START *

12-9-96, or when approved

23.

PROPOSED CASING AND CEMENTING

RESERVOIR CONTROLLED WATER BASIN

SIZE OF HOLE	GRADE, SIZE OF CASING	WEIGHT PER FOOT	SETTING DEPTH	QUANTITY OF CEMENT
12 1/4"	8 5/8" X-42	20#	350'	Circulate
7 7/8"	5 1/2" X-42	17#	4800'	Sufficient to bring cmt 100'
				above 8 5/8" casing shoe.

Duration of Program: Drilling - Nine (9) days

Completion - Thirty (30) days

See attached for complete Drilling Program

EXHIBITS

Exhibit "A": Drilling Program

Exhibit "D": Land Survey Plat

Exhibit "G": Rig Layout

Exhibit "B": H₂S Plan

Exhibit "E": Location Plat

Exhibit "H": BOP Layout

Exhibit "C": Surface Use Plan

Exhibit "F": Existing Well Plat

IN ABOVE SPACE DESCRIBE PROPOSED PROGRAM: If proposal is to deepen, give data on present productive zone and proposed new productive zone. If proposal is to drill or deepen directionally, give pertinent data on subsurface locations and measured and true vertical depths. Give blowout preventer program, if any.

24.

SIGNED

Michael R. Burch, CPL

TITLE

Agent for The Wiser Oil Company

DATE

10-24-96

This space for Federal or State office use)

PERMIT NO.

APPROVAL DATE

Application approval does not warrant or certify that the applicant holds legal or equitable title to those rights in the subject lease which would entitle the applicant to conduct operations thereon.

CONDITIONS OF APPROVAL, IF ANY:

APPROVED BY

Armando A. Lopez

TITLE

Acting ADM-Mineral

DATE

12/24/96

*See Instructions On Reverse Side

Title 18 U.S.C. Section 1001, makes it a crime for any person knowingly and willfully to make to any department or agency of the United States any false, fictitious or fraudulent statements or representations as to any matter within its jurisdiction.

DISTRICT I
P.O. Box 1280, Hobbs, NM 88241-1280
EXHIBIT "D"

DISTRICT II
P.O. Drawer DD, Artesia, NM 88211-0719

DISTRICT III
1000 Rio Brazos Rd., Aztec, NM 87410

DISTRICT IV
P.O. BOX 2088, SANTA FE, N.M. 87504-2088

State of New Mexico
Energy, Minerals and Natural Resources Department

Form C-102
Revised February 10, 1994
Submit to Appropriate District Office
State Lease - 4 Copies
Fee Lease - 3 Copies

OIL CONSERVATION DIVISION

P.O. Box 2088
Santa Fe, New Mexico 87504-2088

☐ AMENDED REPORT

WELL LOCATION AND ACREAGE DEDICATION PLAT

API Number 30-015-D25-33250	Pool Code 43329	Pool Name Maljamar Grayburg San Andres
Property Code 14578	Property Name CAPROCK MALJAMAR UNIT	Well Number 269
OGRID No. 022922	Operator Name THE WISER OIL COMPANY	Elevation 4048'

Surface Location

UL or lot No. 0	Section 24	Township 17 S	Range 32 E	Lot Idn	Feet from the 730	North/South line SOUTH	Feet from the 2045	East/West line EAST	County LEA
---------------------------	----------------------	-------------------------	----------------------	---------	-----------------------------	----------------------------------	------------------------------	-------------------------------	----------------------

Bottom Hole Location If Different From Surface

UL or lot No.	Section	Township	Range	Lot Idn	Feet from the	North/South line	Feet from the	East/West line	County
Dedicated Acres 40	Joint or Infill	Consolidation Code	Order No.						

NO ALLOWABLE WILL BE ASSIGNED TO THIS COMPLETION UNTIL ALL INTERESTS HAVE BEEN CONSOLIDATED
OR A NON-STANDARD UNIT HAS BEEN APPROVED BY THE DIVISION

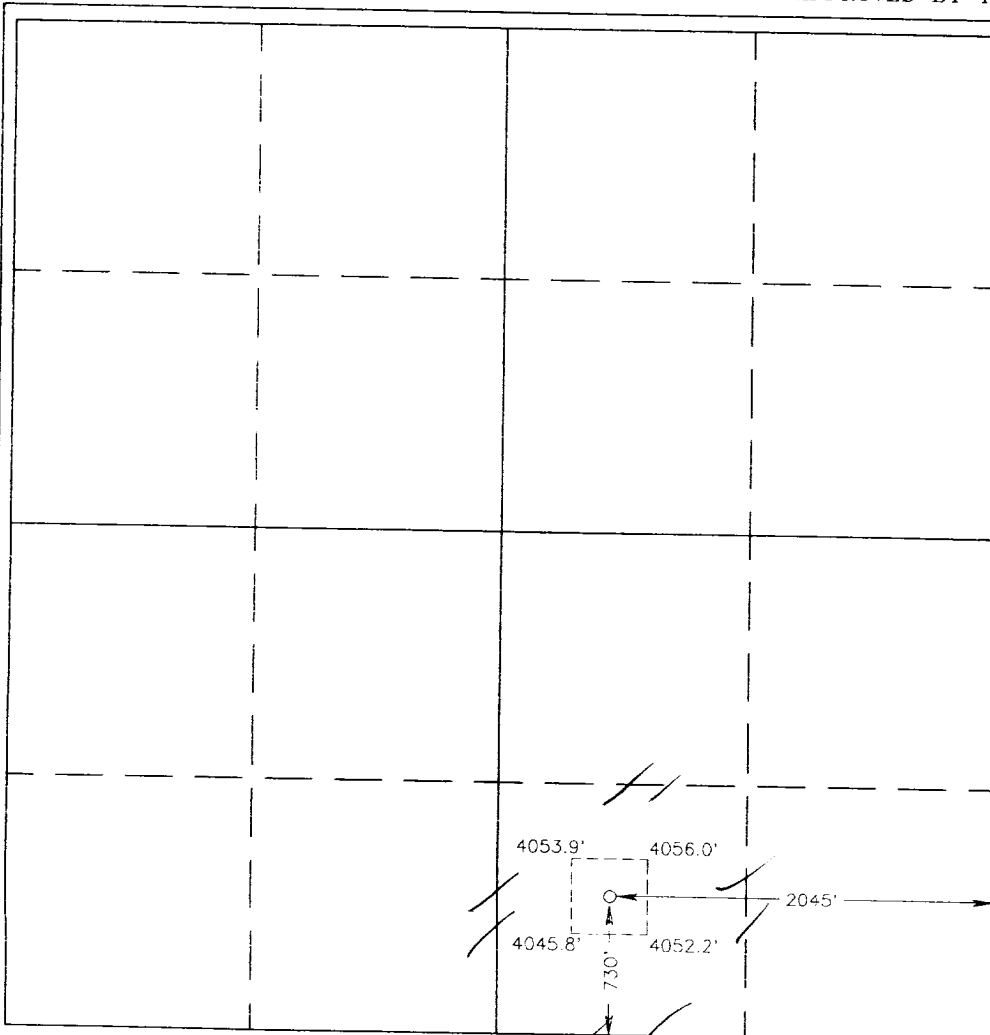

OPERATOR CERTIFICATION

I hereby certify the the information
contained herein is true and complete to the
best of my knowledge and belief.

Michael R. Burch
Signature

Michael R. Burch, CPL
Agent for The Wiser Oil
Company

Title **9-24-96**

Date

SURVEYOR CERTIFICATION

I hereby certify that the well location shown
on this plat was plotted from field notes of
actual surveys made by me or under my
supervision and that the same is true and
correct to the best of my belief.

OCTOBER 18, 1996

Date Surveyed
Signature & Seal of
Professional Surveyor

Ronald W. Eidson
RONALD W. EIDSON
3239
12641

EXHIBIT "A"

DRILLING PROGRAM

I. The geological surface formation is recent Permian with quaternary alluvium and other surficial deposits.

II. Estimated Tops of Geological Markers:

<u>FORMATION</u>	<u>DEPTH</u>
Rustler Anhydrite	540'
Top of Salt	670'
Base of Salt	1570'
Queen	2650'
Grayburg	3050'
San Andres	3430'
TD	4800'

III. Estimated depths at which water, oil, gas, or other mineral-bearing formations are expected to be encountered:

<u>SUBSTANCE</u>	<u>DEPTH</u>
Fresh Water	There is little, if any, in this section
Oil	Fren 7-Rivers; Grayburg and San Andres below 3200'
Gas	None anticipated

IV. A. Proposed Casing Program:

<u>HOLE SIZE</u>	<u>CASING SIZE</u>	<u>GRADE</u>	<u>WEIGHT PER FOOT</u>	<u>DEPTH</u>
12 1/4"	8 5/8"	New 8RD ST&C X-42	20#	350'
7 7/8"	5 1/2"	New 8RD LT&C X-42	17#	4800'

B. Proposed Cement Program:

8 5/8" Cmt w/ 300 sx Class "C" cmt w/2% CaCl. Circulate to surface.

5 1/2" Cmt w/ 700 sx Halliburton Lite w/1/4# Flocele, 325 sx Premium Plus w/.5% Halad-9, & 325 sx Premium Plus w/.5% Halad-344 w/3% KCl.

The top of cement is designed to reach 100' above 8 5/8" casing shoe.

V. Proposed Mud Program:

The well will be drilled to total depth using brine & fresh water. Depths of systems are as follows:

<u>INTERVAL</u>	<u>MUD TYPE</u>	<u>MUD WT.</u>	<u>VISCOSITY</u>
0-550'	Fresh Water	8.8 ppg	30
550'-TD	Brine Water	9.5-10.5 ppg	28

VI. Proposed Control Equipment:

Will install on the 8 5/8" surface casing a 10" Series 900 Type "E" Shaffer Double Hydraulic BOP and will test before drilling in the Queen formation. BOP working pressure: 3000 psi. See Exhibit "H" for BOP layout.

VII. Auxiliary Equipment:

Blowout preventor, gas detector, kelly cock, pit level monitor, flow sensors, and stabbing valve.

VIII A. Testing Program:

Drill Stem Tests: None planned

B. Logging Program:

<u>LOG</u>	<u>Interval</u>
GR-DLL-MSFL-Cal	T.D. - 2,300'
GR-CNL-CDL-Cal	T.D. - Surface

C. Coring Program:

None planned

- IX No abnormal pressures or temperatures are anticipated. In the event abnormal pressures are encountered, the proposed mud program will be modified to increase the mud weight. The estimated maximum bottom hole pressure is 1980 psi.

BOP & CHOKE MANIFOLD

12"/900 Cameron SS Space Saver
3000# Working Pressure
3000# Working Pressure Choke Manifold

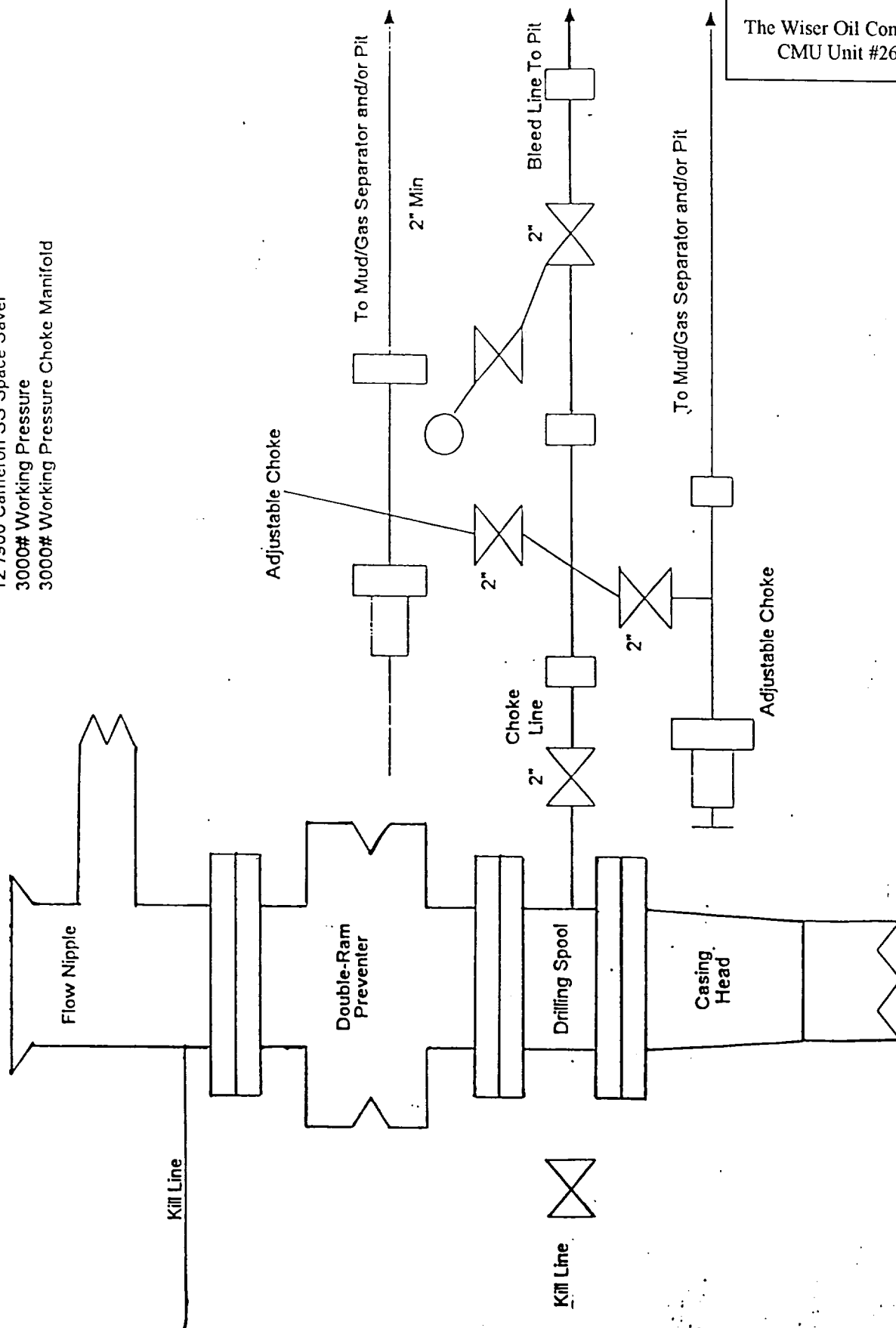

EXHIBIT "H"

BOP LAYOUT

The Wiser Oil Company
CMU Unit #269