

DEPARTMENT OF THE  
BUREAU OF LAND MANAGEMENT

POOL CODE 43329

EFF. DATE 12/31/96

API NO. 30-025-33751

## APPLICATION FOR PERMIT

1a. TYPE OF WORK

DRILL ☒DEEPEEN ☐

UNIT 3 STA

b. TYPE OF WELL

OIL  
WELL ☐GAS  
WELL ☐

OTHER Water Injection

SINGLE  
ZONE ☐MULTIPLE  
ZONE ☐

5. LEASE DESIGNATION AND SERIAL NO.

LC-059152-B

6. IF INDIAN, ALLOTTEE OR TRIBE NAME

7. UNIT AGREEMENT NAME

Caprock Maljamar Unit

8. FARM OR LEASE NAME, WELL NO.

#267

9. API WELL NO.

30-025-

10. FIELD AND POOL OR WILDCAT

Maljamar Grayburg San Andres

11. SEC., T., R., M., OR BLK.  
AND SURVEY OR AREA

24, 17S-32E, N.M.P.M.

12. COUNTY FOR PARISH

Lea

13. STATE

NM

14. DISTANCE IN MILES AND DIRECTION FROM NEAREST TOWN OR POST OFFICE\*

± 3.2 miles Southeast of Maljamar, New Mexico

15. DISTANCE FROM PROPOSED

LOCATION TO NEAREST

PROPERTY OR LEASE LINE, FT.

2003'

(Also to nearest drlg. unit line, if any)

18. DISTANCE FROM PROPOSED LOCATION \*

TO NEAREST WELL, DRILLING, COMPLETED

100'

OR APPLIED FOR, ON THIS LEASE, FT.

19. PROPOSED DEPTH

4800'

20. ROTARY OR CABLE TOOLS

Rotary

21. ELEVATIONS (Show whether DF, RT, GR, etc.)

4072'

22. APPROX. DATE WORK WILL START \*

12-9-96, or when approved

23.

PROPOSED CASING AND CEMENTING PROGRAM

SIZE OF HOLE	GRADE, SIZE OF CASING	WEIGHT PER FOOT	SETTING DEPTH	QUANTITY OF CEMENT
12 1/4"	8 5/8" X-42	20#	350'	Circulate <b>WITNESS</b>
7 7/8"	5 1/2" X-42	17#	4800'	Sufficient to bring cmt 100' above 8 5/8" casing shoe.

Duration of Program: Drilling - Nine (9) days

Completion - Thirty (30) days

See attached for complete Drilling Program

## EXHIBITS

Exhibit "A": Drilling Program

Exhibit "D": Land Survey Plat

Exhibit "G": Rig Layout

Exhibit "B": H<sub>2</sub>S Plan

Exhibit "E": Location Plat

Exhibit "H": BOP Layout

Exhibit "C": Surface Use Plan

Exhibit "F": Existing Well Plat

IN ABOVE SPACE DESCRIBE PROPOSED PROGRAM: If proposal is to deepen, give data on present productive zone and proposed new productive zone. If proposal is to drill or deepen directionally, give pertinent data on subsurface locations and measured and true vertical depths. Give blowout preventer program, if any.

24.

SIGNED

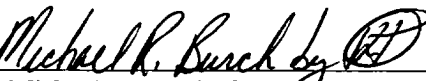
  
Michael R. Burch, CPL

TITLE

Agent for The Wiser Oil Company

DATE

10-24-96

This space for Federal or State office use)

PERMIT NO.

APPROVAL DATE

Application approval does not warrant or certify that the applicant holds legal or equitable title to those rights in the subject lease which would entitle the applicant to conduct operations thereon.

CONDITIONS OF APPROVAL, IF ANY:

APPROVED BY

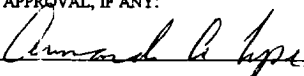

TITLE

Acting ADM-Mineral

DATE

12/28/96

\*See Instructions On Reverse Side

Title 18 U.S.C. Section 1001, makes it a crime for any person knowingly and willfully to make to any department or agency of the United States any false, fictitious or fraudulent statements or representations as to any matter within its jurisdiction.

DISTRICT I  
P.O. Box 1980, Hobbs, NM 88241-1090  
**EXHIBIT "D"**

DISTRICT II  
P.O. Drawer DD, Artesia, NM 88211-0719

DISTRICT III  
1000 Rio Brazos Rd., Aztec, NM 87410

DISTRICT IV  
P.O. BOX 2088, SANTA FE, N.M. 87504-2088

State of New Mexico  
Energy, Minerals and Natural Resources Department

Form C-102  
Revised February 10, 1994  
Submit to Appropriate District Office  
State Lease - 4 Copies  
Fee Lease - 3 Copies

## OIL CONSERVATION DIVISION

P.O. Box 2088  
Santa Fe, New Mexico 87504-2088

☐ AMENDED REPORT

### WELL LOCATION AND ACREAGE DEDICATION PLAT

API Number 30-015- <b>025-33751</b>	Pool Code 43329	Pool Name Maljamar Grayburg San Andres
Property Code 14578	Property Name CAPROCK MALJAMAR UNIT	Well Number 267
OGRID No. 022922	Operator Name THE WISER OIL COMPANY	Elevation 4058'

#### Surface Location

UL or lot No. F	Section 24	Township 17 S	Range 32 E	Lot Idn	Feet from the 1956	North/South line NORTH	Feet from the 2003	East/West line WEST	County LEA
--------------------	---------------	------------------	---------------	---------	-----------------------	---------------------------	-----------------------	------------------------	---------------

#### Bottom Hole Location If Different From Surface

UL or lot No.	Section	Township	Range	Lot Idn	Feet from the	North/South line	Feet from the	East/West line	County
Dedicated Acres 40	Joint or Infill	Consolidation Code	Order No.						

NO ALLOWABLE WILL BE ASSIGNED TO THIS COMPLETION UNTIL ALL INTERESTS HAVE BEEN CONSOLIDATED  
OR A NON-STANDARD UNIT HAS BEEN APPROVED BY THE DIVISION

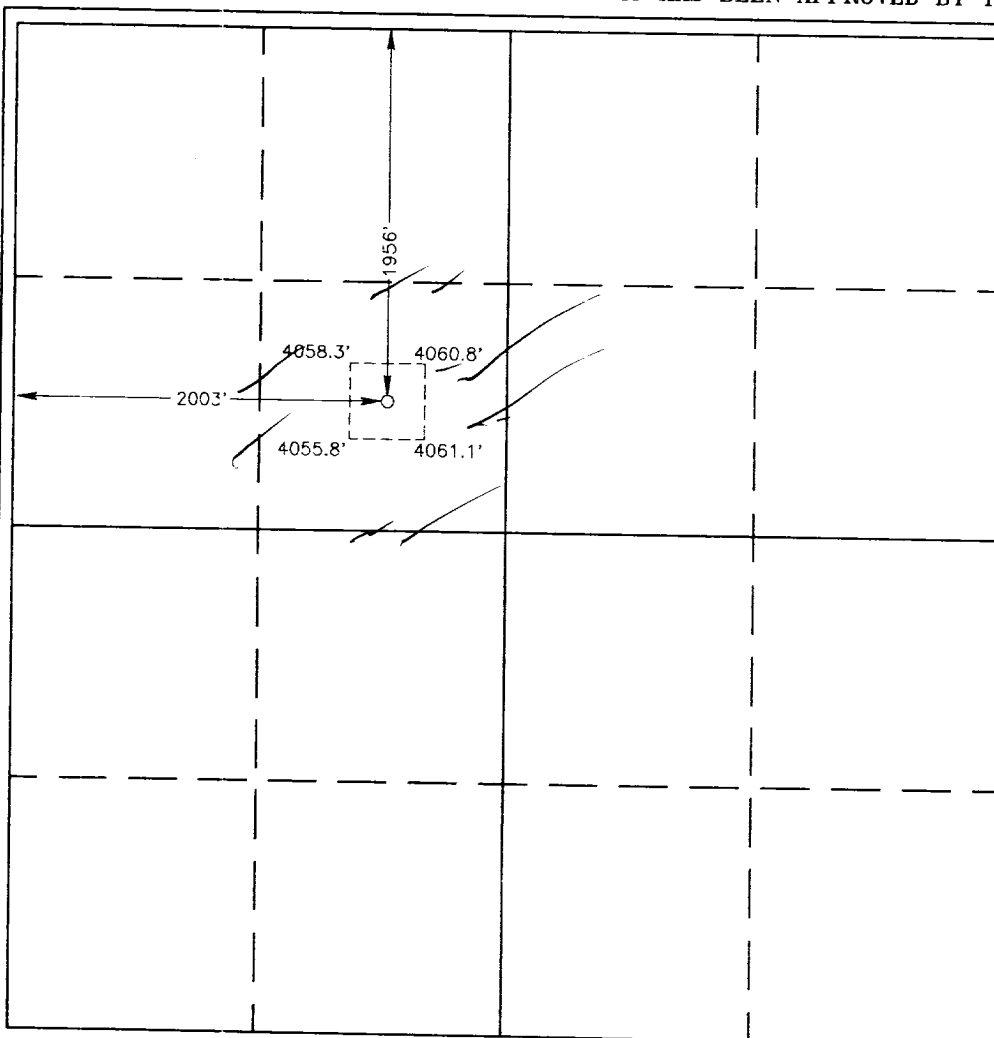

#### OPERATOR CERTIFICATION

I hereby certify the the information  
contained herein is true and complete to the  
best of my knowledge and belief.

*Michael R. Burch by [Signature]*  
Signature  
Michael R. Burch, CPL  
Agent for The Wiser Oil  
Printed Name  
Company  
Title  
9-24-96  
Date

#### SURVEYOR CERTIFICATION

I hereby certify that the well location shown  
on this plat was plotted from field notes of  
actual surveys made by me or under my  
supervision, and that the same is true and  
correct to the best of my belief.

OCTOBER 16, 1996

Date Surveyed  
Signature & Seal of  
Professional Surveyor  
CDG  
10-21-96  
Certificate No. JOHN W. WEST 676  
RONALD J. EIDSON 3239  
GARY EIDSON 12641

## EXHIBIT "A"

### DRILLING PROGRAM

I. The geological surface formation is recent Permian with quaternary alluvium and other surficial deposits.

II. Estimated Tops of Geological Markers:

<u>FORMATION</u>	<u>DEPTH</u>
Rustler Anhydrite	540'
Top of Salt	670'
Base of Salt	1570'
Queen	2650'
Grayburg	3050'
San Andres	3430'
TD	4800'

III. Estimated depths at which water, oil, gas, or other mineral-bearing formations are expected to be encountered:

<u>SUBSTANCE</u>	<u>DEPTH</u>
Fresh Water	There is little, if any, in this section
Oil	Fren 7-Rivers; Grayburg and San Andres below 3200'
Gas	None anticipated

IV. A. Proposed Casing Program:

<u>HOLE SIZE</u>	<u>CASING SIZE</u>	<u>GRADE</u>	<u>WEIGHT PER FOOT</u>	<u>DEPTH</u>
12 1/4"	8 5/8"	New 8RD ST&C X-42	20#	350'
7 7/8"	5 1/2"	New 8RD LT&C X-42	17#	4800'

B. Proposed Cement Program:

8 5/8" Cmt w/ 300 sx Class "C" cmt w/2% CaCl. Circulate to surface.

5 1/2" Cmt w/ 700 sx Halliburton Lite w/1/4# Flocele, 325 sx Premium Plus w/.5% Halad-9, & 325 sx Premium Plus w/.5% Halad-344 w/3% KCl.

The top of cement is designed to reach 100' above 8 5/8" casing shoe.

V. Proposed Mud Program:

The well will be drilled to total depth using brine & fresh water. Depths of systems are as follows:

<u>INTERVAL</u>	<u>MUD TYPE</u>	<u>MUD WT.</u>	<u>VISCOSITY</u>
0-550'	Fresh Water	8.8 ppg	30
550'-TD	Brine Water	9.5-10.5 ppg	28

VI. Proposed Control Equipment:

Will install on the 8 5/8" surface casing a 10" Series 900 Type "E" Shaffer Double Hydraulic BOP and will test before drilling in the Queen formation. BOP working pressure: 3000 psi. See Exhibit "H" for BOP layout.

VII. Auxiliary Equipment:

Blowout preventor, gas detector, kelly cock, pit level monitor, flow sensors, and stabbing valve.

VIII A. Testing Program:

Drill Stem Tests: None planned

B. Logging Program:

<u>LOG</u>	<u>Interval</u>
GR-DLL-MSFL-Cal	T.D. - 2,300'
GR-CNL-CDL-Cal	T.D. - Surface

C. Coring Program:

None planned

- IX No abnormal pressures or temperatures are anticipated. In the event abnormal pressures are encountered, the proposed mud program will be modified to increase the mud weight. The estimated maximum bottom hole pressure is 1980 psi.

# BOP & CHOKE MANIFOLD

12"/900 Cameron SS Space Saver  
 3000# Working Pressure  
 3000# Working Pressure Choke Manifold

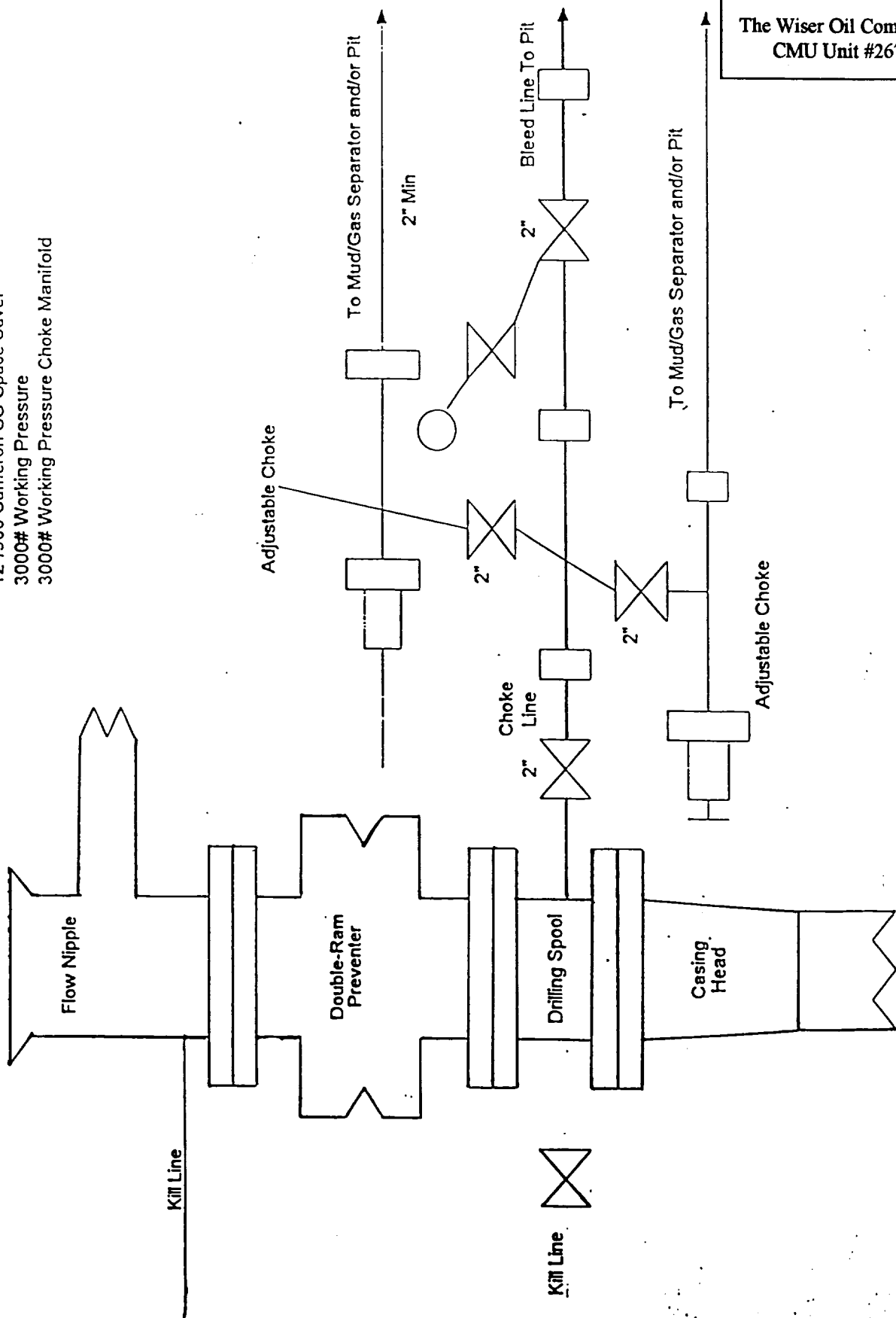

EXHIBIT "H"

BOP LAYOUT

The Wiser Oil Company  
 CMU Unit #267