



NEW MEXICO ENERGY, MINERALS and NATURAL RESOURCES DEPARTMENT

GARY E. JOHNSON

Governor
Betty Rivera
Cabinet Secretary

5/16/02

Lori Wrotenbery
Director
Oil Conservation Division

Oil Conservation Division
1220 S. Francis Drive
Santa Fe, NM 87505

RE: Proposed:

MC _____
DHC _____ X
NSL _____
NSP _____
SWD _____
WFX _____
PMX _____

Gentlemen:

I have examined the application for the:

Conoco Elvis #4-F-20-175-32e
Operator Lease & Well No. Unit S-T-R API# 30-025-33949

and my recommendations are as follows:

OK [Signature]

Yours very truly,

Chris Williams [Signature]

Chris Williams
Supervisor, District 1

DATE IN	SUSPENSE	ENGINEER	LOGGERS	TYPE
---------	----------	----------	---------	------

ABOVE THIS LINE FOR DIVISION USE ONLY

NEW MEXICO OIL CONSERVATION DIVISION

- Engineering Bureau -

ADMINISTRATIVE APPLICATION COVERSHEET

THIS COVERSHEET IS MANDATORY FOR ALL ADMINISTRATIVE APPLICATIONS FOR EXCEPTIONS TO DIVISION RULES AND REGULATIONS

Application Acronyms:

[NSP -Non-Standard Proration Unit] [NSL-Non-Standard Location]
 [DD- Directional Drilling] [SD- Simultaneous Dedication]
 [DHC-Downhole Commingle] [CTB-Lease Commingle] [PLC-Pool /Lease Commingle]
 [PC- Pool Commingle] [OLS - Off-Lease Storage] [OLM- Off-Lease Measurement]
 [WFX-Waterflood Expansion] [PMX-Pressure Maintenance Expansion]
 [SWD-Salt Water Disposal] [IPI-Injection Pressure Increase]
 [EOR-Qualified Enhanced Oil Recovery Certification] [PPR-Positive Production Response]

[1] **TYPE OF APPLICATION** - Check Those Which Apply for [A]

[A] Location - Spacing Unit - Directional Drilling

☐ NSL ☐ NSP ☐ DD ☐ SD

Check One Only for [B] and [C]

[B] Commingle - Storage - Measurement

☒ DHC ☐ CTB ☐ PLC ☐ PC ☐ OLS ☐ OLM

[C] Injection - Disposal - Pressure Increase - Enhanced Oil Recovery

☐ WFX ☐ PMX ☐ SWD ☐ IPI ☐ EOR ☐ PPR

[2] **NOTIFICATION REQUIRED TO:** - Check Those Which Apply, or ☐ Does Not Apply

[A] ☐ Working, Royalty or Overriding Royalty Interest Owners

[B] ☐ Offset Operators, Leaseholders or Surface Owner

[C] ☐ Application is One Which Requires Published Legal Notice

[D] ☐ Notification and/or Concurrent Approval by BLM or SLO

U.S. Bureau of Land Management - Commissioner of Public Lands, State Land Office

[E] ☐ For all of the above, Proof of Notification or Publication is Attached, and/or,

[F] ☐ Waivers are Attached

[3] **INFORMATION / DATA SUBMITTED IS COMPLETE** - Statement of Understanding

I hereby certify that I, or personnel under my supervision, have read and complied with all applicable Rules and Regulations of the Oil Conservation Division. Further, I assert that the attached application for administrative approval is accurate and complete to the best of my knowledge and where applicable, verify that all interest (WI, RI, ORRI) is common. I understand that any omission of data, information or notification is cause to have the application package returned with no action taken.

Note: Statement must be completed by an individual with supervisory capacity.

Kay Maddox

Print or Type Name

Kay Maddox

Signature

Regulatory Agent

Title

5/7/2002

Date

Conoco Inc.

10 Desta Dr. Ste 100W, Midland, Tx. 79705-4500

Operator

Address

Elvis

#4

Section 20, T-17-S, R-32-E, F

Lea

Lease

Well No

Unit Ltr Sec Twp Rge

County

OGRID NO. 005073

Property Code 019491

API NO. 30-025-33949

Spacing Unit Lease Types: (check 1 or more)
Federal ☒ , State ☐ (and/or) Fee ☐

The following facts are submitted in support of downhole commingling:	Upper Zone	intermediate Zone	Lower Zone
1. Pool Name and Pool Code	Baish Wolfcamp (04480)		Maljamar Cisco (43270)
2. TOP and Bottom of Pay Section (Perforations)	8986-9592'		10,392-10,890'
3. Type of production (Oil or Gas)	Oil		Oil
4. Method of Production {Flowing or Artificial Lift}	Artificial Lift		Artificial Lift
5. Bottomhole Pressure Oil Zones - Artificial Lift: Estimated Current Gas & Oil - Flowing: Measured Current All Gas Zones: Estimated Or Measured Original	a (Current) 650	a. 	a. 750
	b(Original) 4022	b. 	b. 4274
6. Oil Gravity (°API) or Gas BT Content	39.4		40
7. Producing or Shut-In?	Producing		Shut-in
Production Marginal? (yes or no) • If Shut-In give date and oil/gas/water rates of lsst production <small>Note For new zones with no production history applicant shad be required to attach product ion estimates and supporting data</small> • If Producing, date and oil/gas/water rates of recent test oil/gas / (within 60 days)	Yes		Yes
	Date Rates 5/1/01 5 BO, 148 BW, 14 MCFGPD	Date Rates 	Date Rates 5/30/02 0 BW, 5 BO, 8 MCFGPD
	Date Rates 	Date Rates 	Date Rates
8. Fixed Percentage Allocation Formula -% or each zone	oil: 50 % Gas 64 %	oil: % Gas %	oil: 50 % Gas 36 %

9. If allocation formula is based upon something other than current or past production, or is based upon some other method, submit attachments with supporting data and/or explaining method and providing rate projections or other required data.
10. Are all working, overriding, and royalty interests identical in all commingled zones?
If not, have all working, overriding, and royalty interests been notified by certified mail?
Have all offset operators been given written notice of the proposed downhole commingling?

X

Yes

No

Yes

No

Yes

X

No
11. Will cross-flow occur? Yes X No If yes, are fluids compatible, will the formations not be damaged, will any cross-flowed production be recovered, and will the allocation formula be reliable. Yes No (If No, attach explanation)
12. Are all produced fluids from all commingled zones compatible with each others X Yes No
13. Will the value of production be decreased by commingling? Yes X No (If Yes, attach explanation)
14. If this well is on, or communitized with, state or federal lands, either the Commissioner of Public Lands or the United States Bureau of Land Management has been notified in writing of this application. X Yes No
15. NMOCD Reference Cases for Rule 303(D) Exceptions: ORDER NO(S).
16. ATTACHMENTS
 - * C-102 for each zone to be commingled showing its spacing unit and acreage dedication.
 - * Production curve for each zone for at least one year. (If not available, attach explanation.)
 - * For zones with no production history, estimated production rates and supporting data.
 - * Data to support allocation method or formula.
 - * Notification list of all offset operators.
 - * Notification list of working, overriding and royalty interests for unconmmon interest cases.
 - * Any additional statements, data, or documents required to support commingling.

I hereby certify that the information above is true and complete to the best of my knowledge and belief.

SIGNATURE

Kay Maddox

TITLE

Regulatory Agent

DATE

May 7, 2002

TYPE OR PRINT NAME

Kay Maddox

TELEPHONE NO.

(915) 686-5798



Elvis 4 Production Data

	Days Produced	BO per day produced	MCF per day produced	MBO/Mo	MMCF/Mo	MBW/Mo	
Nov-97	0			0	0	0	
Dec-97	0			2.1	4.74	0.19	Original Cisco Completion
Jan-98							
Feb-98							
Mar-98	0			0.74	4.42	0.13	
Apr-98							
May-98							
Jun-98							
Jul-98							
Aug-98							
Sep-98							
Oct-98	30	10.0	39.3	0.3	1.18	0.03	
Nov-98	31	6.8	35.2	0.21	1.09	0.03	
Dec-98	27	6.3	34.4	0.17	0.93	0.02	
Jan-99	31	6.8	22.6	0.21	0.7	0.03	
Feb-99	31	8.7	21.0	0.27	0.65	0	
Mar-99	28	8.2	20.4	0.23	0.57	0	
Apr-99	31	8.1	20.3	0.25	0.63	0	
May-99	30	6.7	20.0	0.2	0.6	0.03	
Jun-99	31	5.5	19.0	0.17	0.59	0.03	
Jul-99	29	5.5	19.3	0.16	0.56	0.03	
Aug-99	31	5.8	18.1	0.18	0.56	0.03	
Sep-99	30	4.7	15.0	0.14	0.45	0	
Oct-99	31	5.8	21.9	0.18	0.68	0	
Nov-99	30	6.0	15.7	0.18	0.47	0	
Dec-99	31	5.2	15.8	0.16	0.49	0	
Jan-00	31	6.1	14.8	0.19	0.46	0	
Feb-00	29	4.8	10.7	0.14	0.31	0	
Mar-00	31	5.5	9.0	0.17	0.28	0	
Apr-00	30	4.3	8.7	0.13	0.26	0	
May-00	31	4.8	8.4	0.15	0.26	0	
Jun-00	1	10.0	200.0	0.01	0.2	0	0 1 day test - not representative
Jul-00	31	0.0	4.5	0	0.14	0	0 well not pumping - gas flowing up casing
Aug-00	31	0.0	2.9	0	0.09	0	0 tests not representative 7/00 to 5/01
Sep-00	30	0.0	1.7	0	0.05	0	
Oct-00	31	0.0	3.9	0	0.12	0	
Nov-00	30	0.0	3.7	0	0.11	0	
Dec-00	31	0.0	3.5	0	0.11	0	
Jan-01	31	0.0	3.9	0	0.12	0	
Feb-01	28	0.0	3.6	0	0.1	0	
Mar-01	31	0.0	3.2	0	0.1	0	
Apr-01	30	0.0	2.7	0	0.08	0	
May-01	31	0.0	2.9	0	0.09	0	
Jun-01	14	0.0	22.9	0	0.32	0	0 Wolfcamp Recompletion
Jul-01	16	3.8	16.3	0.06	0.26	0.06	6/6/01 to 6/21/01
Aug-01	7	8.6	27.1	0.06	0.19	0.01	
Sep-01	30	3.0	13.7	0.09	0.41	0.03	
Oct-01							
Nov-01							
Dec-01							
Jan-02	27	4.1	14.4	0.11	0.39	3.65	
Feb-02	27	4.1	14.4	0.11	0.39	3.65	
							above data from production database only updated through February 2002
May-02		5.0	14.0				4.6 Field Test Data

Last representative test Cisco 5 BOPD 8 MCFPD May-00
Last representative test Wolfcamp 5 BOPD 14 MCFPD Feb-02

Total 10 BOPD 22 MCFPD

Proposed Allocation:		
	Oil	Gas
Wolfcamp percentage	0.50	0.64
Cisco percentage	0.50	0.36

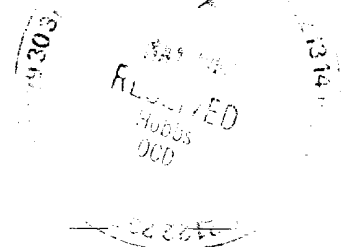

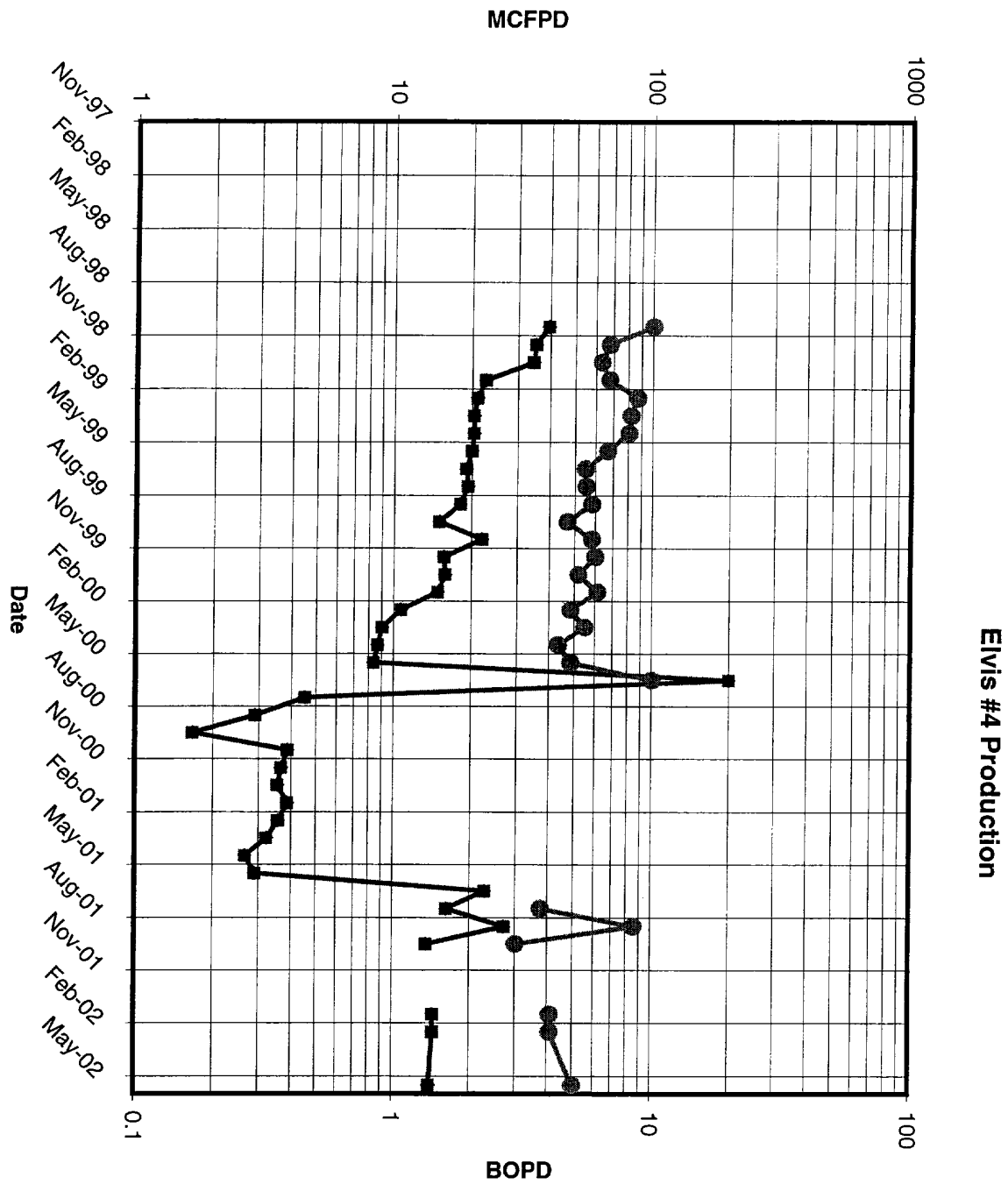

02625

RECEIVED
Hobbs
000

05/16/02

District I
PO Box 1980, Hobbs. NM 88241-1980

District II
PO Drawer DD, Artesia, NM 88211-0719

District III
1000 Rio Brazos Rd. Aztec, NM 87410

District IV
PO Box 2088, Santa Fe. NM 87504-2088

State of New Mexico
Energy, Minerals & Natural Resources Department

OIL CONSERVATION DIVISION
PO Box 2088
Santa Fe, NM 87504-2088

Form C-10

Revised February 21, 199

Instructions on back

Submit to Appropriate District Office

State Lease - 4 Copies

Fee Lease - 3 Copies

☐ AMENDED REPORT

WELL LOCATION AND ACREAGE DEDICATION PLAT

API Number 30-025-33949		2 Pool Code 4480		3 Pool Name Baish Wolfcamp	
4 Property Code		5 Property Name Elvis			6 Well Number # 4
7 OGRID No. 005073		8 Operator Name Conoco Inc., 10 Desta Drive, Ste. 100W, Midland, TX 79705-4500			9 Elevation 3984

10 Surface Location

UL or lot no.	Section	Township	Range	Lot Idn	Feet from the	North/South line	Feet from the	East/West line	County
F	20	17S	32E		1660	North	1866	West	Lea

11 Bottom Hole Location If Different From Surface

UL or lot no.	Section	Township	Range	Lot Idn	Feet from the	North/South line	Feet from the	East/West line	County
12 Dedicated Acres 80		13 Joint or Infill		14 Consolidation Code		15 Order No.			

NO ALLOWABLE WILL BE ASSIGNED TO THIS COMPLETION UNTIL ALL INTERESTS HAVE BEEN CONSOLIDATED
OR A NON-STANDARD UNIT HAS BEEN APPROVED BY THE DIVISION

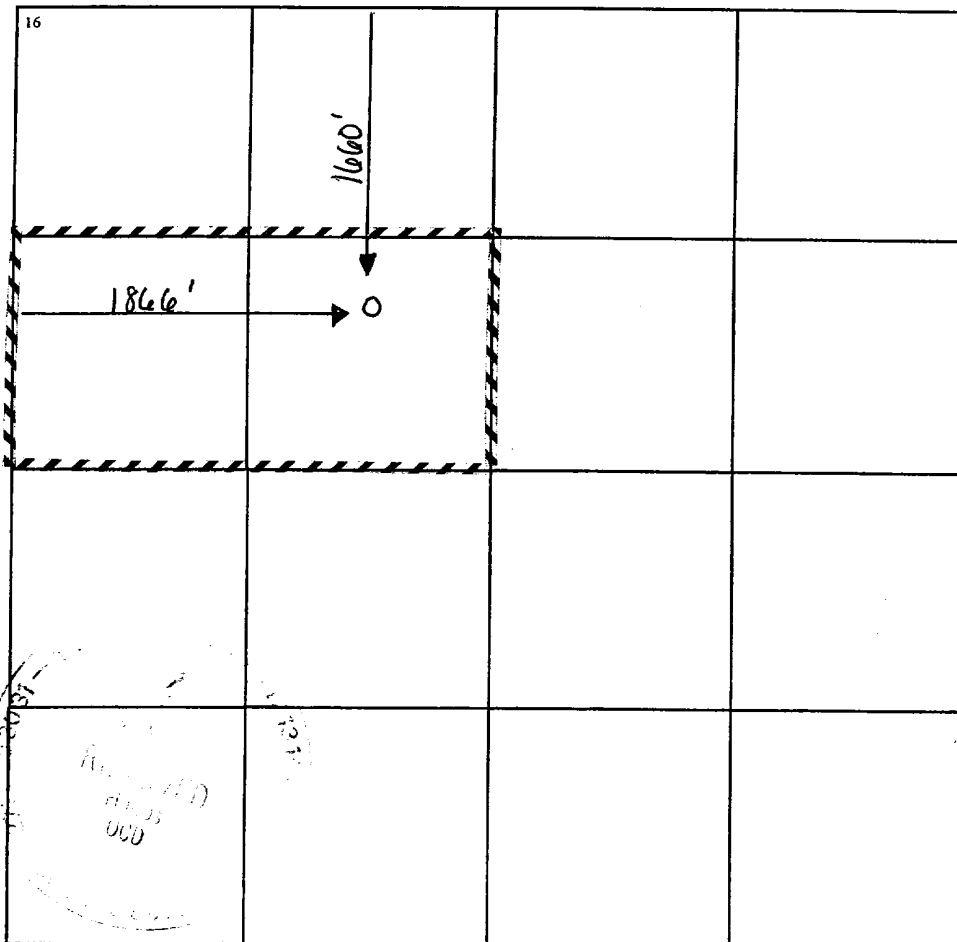

17 OPERATOR CERTIFICATION

I hereby certify that the information contained herein is true and complete to the best of my knowledge and belief

Kay Maddox
Signature
Kay Maddox

Printed Name
Regulatory Agent

Title
March 1, 2001

Date

18 SURVEYOR CERTIFICATION

I hereby certify that the well location shown on this plat was plotted from field notes of actual surveys made by me or under my supervision, and that the same is true and correct to the best of my belief.

Date of Survey

Signature and Seal of Professional Surveyor:

Certificate Number

PO Box 1900, Hobbs, NM 88241-1900
District II
PO Drawer DD, Artesia, NM 88211-0719
District III
1000 Rio Bravo Rd., Aztec, NM 87410
District IV
PO Box 2088, Santa Fe, NM 87504-2088

Energy, Minerals & Natural Resources Department

OIL CONSERVATION DIVISION
PO Box 2088
Santa Fe, NM 87504-2088

Form C-102
Revised February 10, 1994
Instructions on back
Submit to Appropriate District Office
State Lease - 4 Copies
Fee Lease - 3 Copies

☐ AMENDED REPORT

WELL LOCATION AND ACREAGE DEDICATION PLAT

API Number 30 025 33949		Pool Code 43270		Well Name BRISH Matamor Cisco	
Property Code 19491	Property Name Elvis				Well Number 4
OGRID No. 005073	Operator Name Conoco, Inc.				Elevation 3984'

10 Surface Location



UL or lot no. F	Section 20	Township 17S	Range 32E	Lot Idn	Feet from the 1660	North/South line North	Feet from the 1866	East/West line West	County Lea
--------------------	---------------	-----------------	--------------	---------	-----------------------	---------------------------	-----------------------	------------------------	---------------

11 Bottom Hole Location If Different From Surface

UL or lot no.	Section	Township	Range	Lot Idn	Feet from the	North/South line	Feet from the	East/West line	County
---------------	---------	----------	-------	---------	---------------	------------------	---------------	----------------	--------

12 Dedication Acres 40	13 Joint or Infill	14 Consolidation Code	15 Order No.
---------------------------	--------------------	-----------------------	--------------

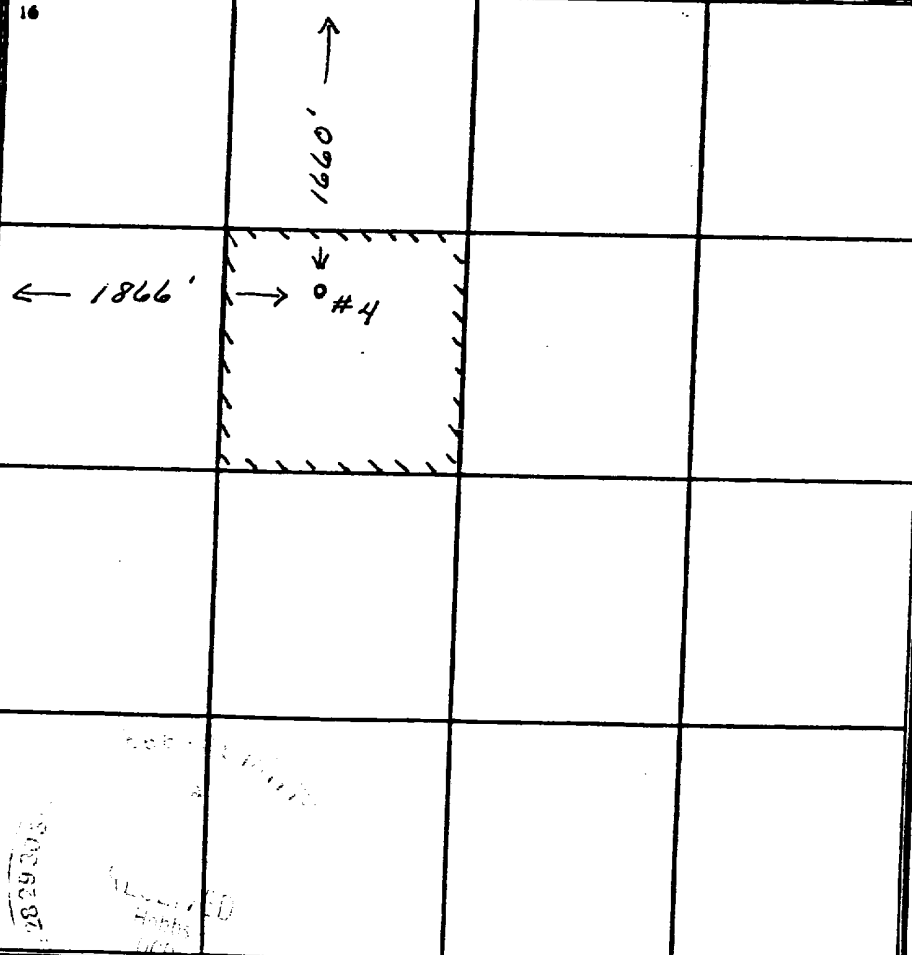
NO ALLOWABLE WILL BE ASSIGNED TO THIS COMPLETION UNTIL ALL INTERESTS HAVE BEEN CONSOLIDATED OR A NON-STANDARD UNIT HAS BEEN APPROVED BY THE DIVISION

16 	17 OPERATOR CERTIFICATION I hereby certify that the information contained herein is true and complete to the best of my knowledge and belief. Signature:  Printed Name: Ann E. Ritchie Title: Regulatory Agent Date: 7-2-98	
	18 SURVEYOR CERTIFICATION I hereby certify that the well location shown on this plat was plotted from field notes of actual surveys made by me or under my supervision, and that the same is true and correct to the best of my belief. Date of Survey: Signature and Seal of Professional Surveyer: Certificate Number:	