

DISTRICT II  
P.O. Drawer 80, Artesia, NM 88211-0719

DISTRICT III  
1000 Rio Brazos Rd., Artesia, NM 87410

DISTRICT IV  
P.O. Box 2088, Santa Fe, NM 87504-2088

# OIL CONSERVATION DIVISION

P.O. Box 2088

Santa Fe, New Mexico 87504-2088

☐ AMENDED REPORT

## WELL LOCATION AND ACREAGE DEDICATION PLAT

API Number 30-025-34068	Pool Code 56290	Pool Name Shoebar Wolfcamp
Property Code 21102	Property Name EIDSON "23"	Well Number 1
OGRIID No. 036554	Operator Name TMBR/SHARP DRILLING, INC.	Elevation 3973

### Surface Location

UL or lot No. L	Section 23	Township 16 S	Range 35 E	Lot Idn	Feet from the 1980	North/South line SOUTH	Feet from the 660	East/West line WEST	County LEA
--------------------	---------------	------------------	---------------	---------	-----------------------	---------------------------	----------------------	------------------------	---------------

### Bottom Hole Location If Different From Surface

UL or lot No.	Section	Township	Range	Lot Idn	Feet from the	North/South line	Feet from the	East/West line	County
---------------	---------	----------	-------	---------	---------------	------------------	---------------	----------------	--------

Dedicated Acres 40	Joint or Infill	Consolidation Code	Order No.
-----------------------	-----------------	--------------------	-----------

NO ALLOWABLE WILL BE ASSIGNED TO THIS COMPLETION UNTIL ALL INTERESTS HAVE BEEN CONSOLIDATED  
OR A NON-STANDARD UNIT HAS BEEN APPROVED BY THE DIVISION

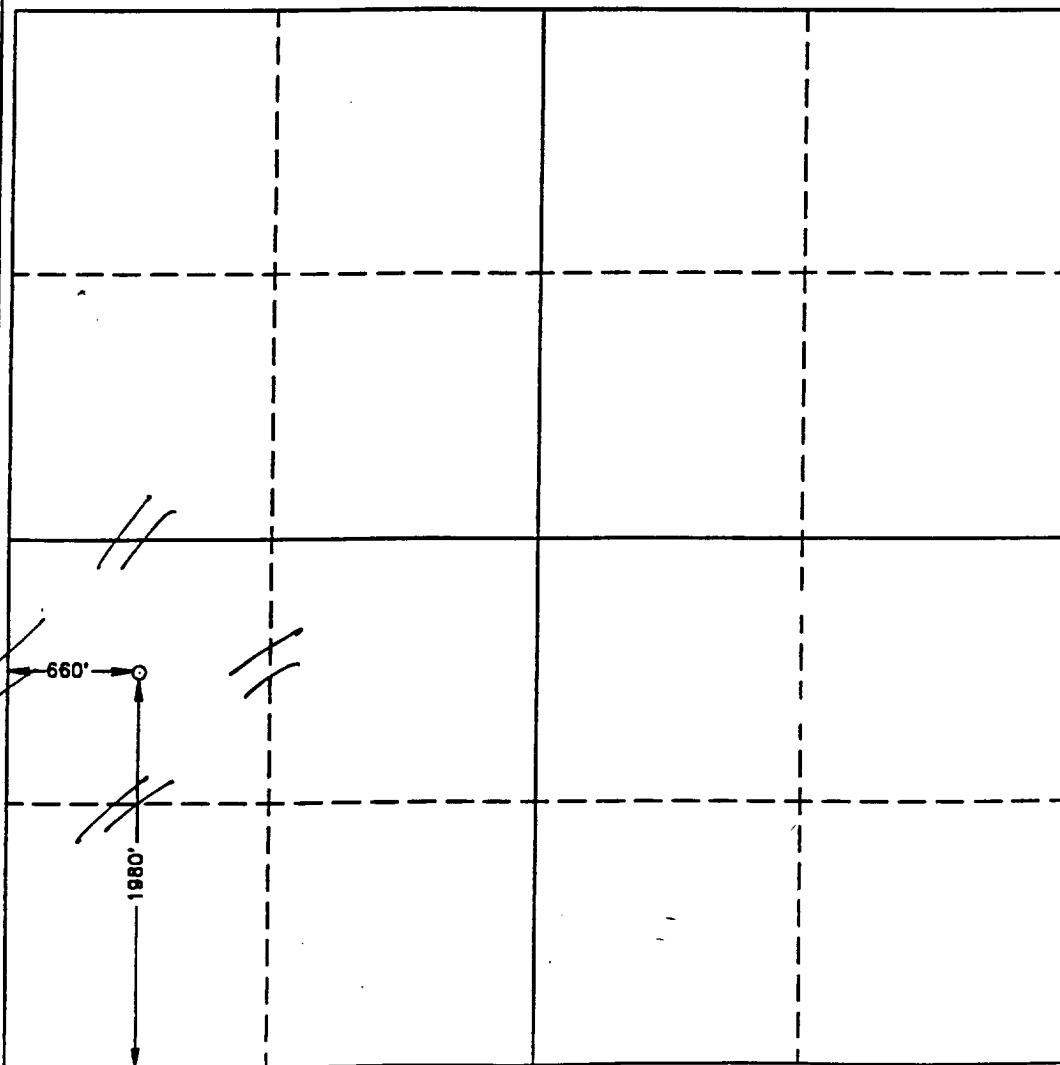

### OPERATOR CERTIFICATION

I hereby certify the the information  
contained herein is true and complete to the  
best of my knowledge and belief.

*Jeff Phillips*  
Signature

Jeff Phillips  
Printed Name

Engineering Manager  
Title

7/17/97  
Date

### SURVEYOR CERTIFICATION

I hereby certify that the well location shown  
on this plat was plotted from field notes of  
actual surveys made by me or under my  
supervision, and that the same is true and  
correct to the best of my belief.

JULY 10, 1997

Date Surveyed  
Signature & Seal of  
Professional Surveyor

*Ronald J. Eidson*  
R. J. EIDSON  
NEW MEXICO  
3239  
No. Num. 97-114151

Certification No. JOHN G. WEST. 676  
EIDSON. 3239  
GARY G. EIDSON. 12841

Submit 3 Copies  
to Appropriate  
District Office

State of New Mexico  
Energy, Minerals and Natural Resources Department

Form C-103  
Revised 1-1-89

DISTRICT I  
P.O. Box 1980, Hobbs, NM 88240

DISTRICT II  
P.O. Drawer 110, Artesia, NM 88210

DISTRICT III  
1000 Rio Brazos Rd., Aztec, NM 87410

OIL CONSERVATION DIVISION

P.O. Box 2088  
Santa Fe, New Mexico 87504-2088

WELL API NO.

30-025-34068

5. Indicate Type of Lease

STATE ☐

FEE ☒

6. State Oil & Gas Lease No.

SUNDRY NOTICES AND REPORTS ON WELLS  
(DO NOT USE THIS FORM FOR PROPOSALS TO DRILL OR TO DEEPEN OR PLUG BACK TO A  
DIFFERENT RESERVOIR. USE "APPLICATION FOR PERMIT"  
(FORM C-101) FOR SUCH PROPOSALS.)

1. Type of Well:

Oil  
WELL ☒

GAS  
WELL ☐

OTHER

2. Name of Operator

TMBR/Sharp Drilling, Inc.

3. Address of Operator

-P. O. Drawer 10970, Midland, TX 79702

8. Well No.

1

9. Pool name or Wildcat

4. Well Location

Unit Letter L : 1980 Feet From The South Line and 660 Feet From The West

Section 23

Township 16S

Range 35E

NMPM

Lea

Co:

10. Elevation (Show whether DF, RKB, RT, GR, etc.)

11.

Check Appropriate Box to Indicate Nature of Notice, Report, or Other Data

NOTICE OF INTENTION TO:

PERFORM REMEDIAL WORK ☐

PLUG AND ABANDON ☐

TEMPORARILY ABANDON ☐

CHANGE PLANS ☐

PULL OR ALTER CASING ☐

OTHER: ☐

SUBSEQUENT REPORT OF:

REMEDIAL WORK ☐

ALTERING CASING ☐

COMMENCE DRILLING OPNS. ☐

PLUG AND ABANDON ☐

CASING TEST AND CEMENT JOB ☒

OTHER: ☐

12. Describe Proposed or Completed Operations (Clearly state all pertinent details, and give pertinent dates, including estimated date of starting any proposed work) SEE RULE 1103.

07/26/97 Ran 9 jts 13-3/8" 54.5#/ft J-55 ST&C csg & set @ 396'. Ran 4 centralizers on Joints No. 1, 3, 5 and 7. Pumped 20 BBL fresh wtr. Mixed & pumped 445 sx CI "C" w/2% CaCl<sub>2</sub> (14.8#/gal). Displaced w/55 BBL fresh wtr. PD @ 7:18 PM 07/25/97. Did not circ cmt to surface. Temp survey showed TOC @ 51' @ 12:30 PM 07/25/97. Mr. Charley Perrin with the NMOCDC requested circ cmt to surface w/1" pipe. One-inched w/79 sx CI "C" (14.8#/gal). PD @ 3:00 AM 07/27/97. Circ 42 sx cmt to surface.

08/03/97 Ran 105 jts (4486') 8-5/8" csg & set @ 4480'. Cmt w/1385 sx Premium Plus Lite followed by 200 sx CI C, 2% CaCl. PD @ 4:15 PM 08/02/97. Circ 87 sx.

09/10/97 Ran 261 jts (10,372') 5 1/2" 17# L-80/N-80/K-70 LT&C csg & set @ 10,368'. Cmt w/200 sx CI H w/.5% Halad 344 + .3% CFR3 + 5#/sk Gilsonite + 3#/sk salt + 1/4#/sk Flocele. Slurry wt 13.0 ppg, slurry vol 61 BBL. PD @ 1:19 PM CDT 09/09/97. WOCU.

I hereby certify that the information above is true and complete to the best of my knowledge and belief.

SIGNATURE

TITLE Engineering Manager

DATE 9/12/97

TYPE OR PRINT NAME

Jeff Phillips

(915) 699-5050

TELEPHONE NO.

(This space for State Use)

Orig. Signed by  
Paul Kautz  
Geologist

OCT 06 1997