

State of New Mexico  
Energy, Minerals & Natural Resources Department

District I  
PO Box 1980, Hobbs, NM 88241-1980  
District II  
811 S. First St., Artesia, NM 88210  
District III  
1000 Rio Brazos Rd., Aztec, NM 87410  
District IV  
2040 S. Pacheco St., Santa Fe, NM 87504

Form C-101  
Revised February 10, 1994  
Instructions on back  
Submit to Appropriate District Office  
State Lease - 6 Copies  
Fee Lease - 5 Copies

OIL CONSERVATION DIVISION  
2040 S. Pacheco St.  
Santa Fe, NM 97504

☐ AMENDED REPORT

APPLICATION FOR PERMIT TO DRILL, RE-ENTER, DEEPEN, PLUGBACK OR ADD A ZONE

|   |   |                                  |
|---|---|----------------------------------|
| 1. Operator Name and Address<br><b>Shahara Oil, LLC<br/>207 W. McKay<br/>Carlsbad, NM 88220</b> |   | 2. OGRID Number<br><b>143119</b> |
| 3. API Number<br><b>30-025-34090</b>  |   |                                  |
| 4. Property Code<br><b>16770</b>  | 5. Property Name<br><b>Phillips State</b> | 6. Well No.<br><b>9</b>          |

| 7. Surface Location |           |            |            |          |               |                  |               |                |            |
|---------------------|-----------|------------|------------|----------|---------------|------------------|---------------|----------------|------------|
| UL or lot no.       | Section   | Township   | Range      | Lot Idn. | Feet From the | North/South Line | Feet From the | East/West Line | County     |
| <b>F</b>            | <b>16</b> | <b>17S</b> | <b>33E</b> |          | <b>1335</b>   | <b>North</b>     | <b>1335</b>   | <b>West</b>    | <b>Lea</b> |

| 8. Proposed Bottom Hole Location If Different From Surface |         |          |       |          |                     |                  |               |                |        |
|--|---------|----------|-------|----------|---------------------|------------------|---------------|----------------|--------|
| UL or lot no.  | Section | Township | Range | Lot Idn. | Feet From the       | North/South Line | Feet From the | East/West Line | County |
|  |         |          |       |          |                     |                  |               |                |        |
| 9. Proposed Pool 1<br><b>Maljamar Grayburg San Andres</b>  |         |          |       |          | 10. Proposed Pool 2 |                  |               |                |        |

|                                |                                    |                                    |   |  |
|--------------------------------|------------------------------------|------------------------------------|---|--|
| 11. Work Type Code<br><b>N</b> | 12. Well Type Code<br><b>O</b>     | 13. Cable/Rotary<br><b>R</b>       | 14. Lease Type Code<br><b>S</b>             | 15. Ground Level Elevation<br><b>4193'</b> |
| 16. Multiple<br><b>No</b>      | 17. Proposed Depth<br><b>4850'</b> | 18. Formation<br><b>San Andres</b> | 19. Contractor<br><b>L &amp; M Drilling</b> | 20. Spud Date<br><b>September 1, 1997</b>  |

| 21. Proposed Casing and Cement Program |               |                    |               |                 |                               |
|--|---------------|--------------------|---------------|-----------------|-------------------------------|
| Hole Size                              | Casing Size   | Casing weight/foot | Setting Depth | Sacks of Cement | Estimated TOC                 |
| <b>12 1/4"</b>                         | <b>8 5/8"</b> | <b>24#</b>         | <b>500'</b>   | <b>300</b>      | <b>Circulate</b>              |
| <b>7 7/8"</b>                          | <b>5 1/2"</b> | <b>17#</b>         | <b>4850'</b>  | <b>970</b>      | <b>Circ 100' above 8 5/8"</b> |
|  |               |                    |               |                 | <b>casing shoe</b>            |
|  |               |                    |               |                 |                               |
|  |               |                    |               |                 |                               |

22. Describe the proposed program. If this application is to DEEPEN or PLUG BACK, give the data on the present productive zone and proposed new productive zone. Describe the blowout prevention program, if any. Use additional sheets if necessary.

It is proposed to drill the above captioned well to a total depth of 4850' with rotary tools.  
If commercial production is indicated, the well will be perforated and stimulated as necessary

Blow Out Prevention: 10" Series 900 Type "E" Shaffer Hydraulic BOP

|  |                              |   |                  |
|--|------------------------------|---|------------------|
| 23. I hereby certify that the information given above is true and complete to the best of my knowledge and belief. |                              | OIL CONSERVATION DIVISION<br>ORIGINAL SIGNED BY CHRIS WILLIAMS<br>DISTRICT I SUPERVISOR |                  |
| Signature: <i>Perry L. Hughes</i>  | Approved by:                 | Title: <b>AUG 08 1997</b>   | Expiration Date: |
| Printed Name: <b>Perry L. Hughes</b>   | Approval Date:               |   |                  |
| Title: <b>President</b>  | Conditions of Approval:      |   |                  |
| Date: <b>07/07/97</b>  | Phone: <b>(505) 885-5433</b> | Attached: <input type="checkbox"/>  |                  |

ORIGINAL SIGNED BY CHRIS WILLIAMS  
DISTRICT I SUPERVISOR  
AUG 08 1997

## DISTRICT I

P.O. Box 1960, Hobbs, NM 88241-1960

## DISTRICT II

P.O. Drawer DD, Artesia, NM 88211-0719

## DISTRICT III

1000 Rio Brazos Rd., Artec, NM 87410

## DISTRICT IV

P.O. Box 2088, Santa Fe, NM 87504-2088

## State of New Mexico

Energy, Minerals and Natural Resources Department

Form C-102

Revised February 10, 1994  
 Submit to Appropriate District Office  
 State Lease - 4 Copies  
 Fee Lease - 3 Copies

## OIL CONSERVATION DIVISION

P.O. Box 2088

Santa Fe, New Mexico 87504-2088

☐ AMENDED REPORT

## WELL LOCATION AND ACREAGE DEDICATION PLAT

|                                   |   |   |
|-----------------------------------|---|---|
| API Number<br><b>30-025-34090</b> | Pool Code<br>43329                              | Pool Name<br>Maljamar Grayburg San Andres |
| Property Code<br>16770            | Property Name<br>Phillips State <del>XXXX</del> | Well Number<br>9                          |
| OGRID No.<br>143119               | Operator Name<br>SHAHARA OIL CORPORATION, LLC   | Elevation<br>4193                         |

## Surface Location

| UL or lot No. | Section | Township | Range | Lot Idn | Feet from the | North/South line | Feet from the | East/West line | County |
|---------------|---------|----------|-------|---------|---------------|------------------|---------------|----------------|--------|
| F             | 16      | 17 S     | 33 E  |         | 1335          | NORTH            | 1335          | WEST           | LEA    |

## Bottom Hole Location If Different From Surface

| UL or lot No.                | Section         | Township           | Range     | Lot Idn | Feet from the | North/South line | Feet from the | East/West line | County |
|------------------------------|-----------------|--------------------|-----------|---------|---------------|------------------|---------------|----------------|--------|
|                              |                 |                    |           |         |               |                  |               |                |        |
| Dedicated Acres<br><b>40</b> | Joint or Infill | Consolidation Code | Order No. |         |               |                  |               |                |        |

NO ALLOWABLE WILL BE ASSIGNED TO THIS COMPLETION UNTIL ALL INTERESTS HAVE BEEN CONSOLIDATED  
 OR A NON-STANDARD UNIT HAS BEEN APPROVED BY THE DIVISION

|  |  |
|--|--|
|  | <p><b>OPERATOR CERTIFICATION</b></p> <p>I hereby certify the the information contained herein is true and complete to the best of my knowledge and belief.</p> <p><i>Perry E. Hughes</i><br/>       Signature<br/>       Perry E. Hughes<br/>       Printed Name<br/>       President<br/>       Title<br/>       07/07/97<br/>       Date</p> <p><b>SURVEYOR CERTIFICATION</b></p> <p>I hereby certify that the well location shown on this plat was plotted from field notes of actual surveys made by me or under my supervision, and that the same is true and correct to the best of my belief.</p> <p>JUNE 23, 1997<br/>       Date Surveyed<br/>       Signature &amp; Seal of<br/>       Professional Surveyor<br/>       J. EIDSON<br/>       3239<br/>       WFO Num. 97-115-003<br/>       Certified No. JOHN W. WEST, 676<br/>       J. EIDSON, 3239<br/>       G. EIDSON, 12641</p> |
|--|--|

DISTRICT I  
P.O. Box 1960, Hobbs, NM 86241-1960

DISTRICT II  
P.O. Drawer DD, Artesia, NM 88211-0719

DISTRICT III  
1000 Rio Brazos Rd., Artec, NM 87410

DISTRICT IV  
P.O. Box 2088, Santa Fe, NM 87504-2088

State of New Mexico  
Energy, Minerals and Natural Resources Department

Form C-102  
Revised February 10, 1994  
Submit to Appropriate District Office  
State Lease - 4 Copies  
Fee Lease - 3 Copies

OIL CONSERVATION DIVISION

P.O. Box 2088  
Santa Fe, New Mexico 87504-2088

☐ AMENDED REPORT

WELL LOCATION AND ACREAGE DEDICATION PLAT

|                        |   |   |
|------------------------|---|---|
| API Number             | Pool Code<br>43329  | Pool Name<br>Maljamar Grayburg San Andres |
| Property Code<br>16770 | Property Name<br>Phillips State <del>SSIX</del>           | Well Number<br>9                          |
| OGRID No.<br>143119    | Operator Name<br>SHAHARA <del>XXX CORPORATION</del> , LLC | Elevation<br>4193                         |

Surface Location

| UL or lot No. | Section | Township | Range | Lot Idn | Feet from the | North/South line | Feet from the | East/West line | County |
|---------------|---------|----------|-------|---------|---------------|------------------|---------------|----------------|--------|
| F             | 16      | 17 S     | 33 E  |         | 1335          | NORTH            | 1335          | WEST           | LEA    |

Bottom Hole Location If Different From Surface

| UL or lot No. | Section | Township | Range | Lot Idn | Feet from the | North/South line | Feet from the | East/West line | County |
|---------------|---------|----------|-------|---------|---------------|------------------|---------------|----------------|--------|
|               |         |          |       |         |               |                  |               |                |        |

| Dedicated Acres | Joint or Infill | Consolidation Code | Order No. |
|-----------------|-----------------|--------------------|-----------|
|                 |                 |                    |           |

NO ALLOWABLE WILL BE ASSIGNED TO THIS COMPLETION UNTIL ALL INTERESTS HAVE BEEN CONSOLIDATED  
OR A NON-STANDARD UNIT HAS BEEN APPROVED BY THE DIVISION

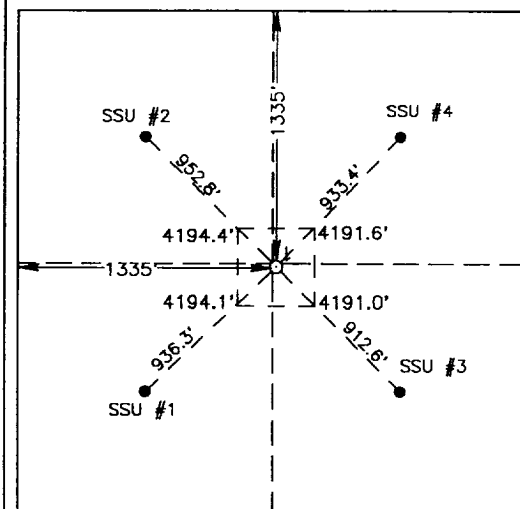
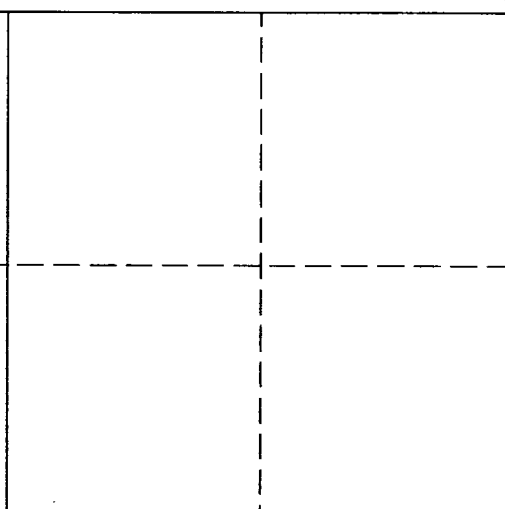
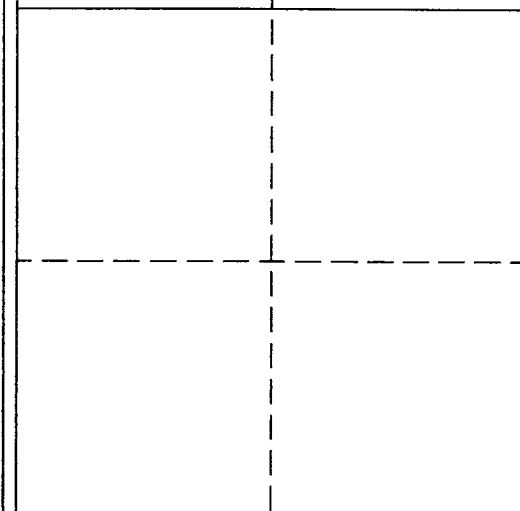
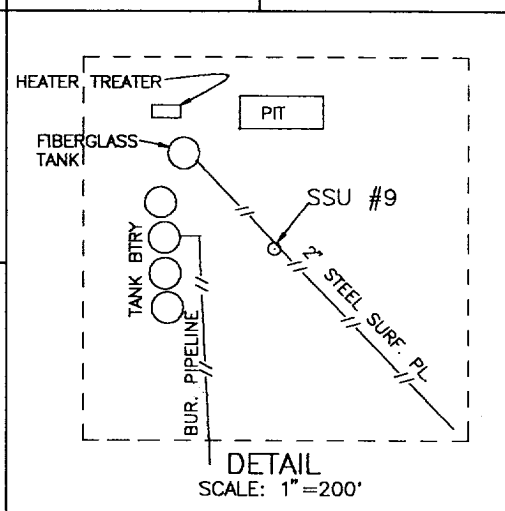
|  |  |  |
|--|--|--|
|  |  | <p><b>OPERATOR CERTIFICATION</b></p> <p>I hereby certify the the information contained herein is true and complete to the best of my knowledge and belief.</p> <p><i>Perry L. Hughes</i><br/>Signature<br/>Perry L. Hughes<br/>Printed Name<br/>President<br/>Title<br/>07/07/97<br/>Date</p>  |
|  |  | <p><b>SURVEYOR CERTIFICATION</b></p> <p>I hereby certify that the well location shown on this plat was plotted from field notes of actual surveys made by me or under my supervision, and that the same is true and correct to the best of my belief.</p> <p>JUNE 23, 1997<br/>Date Surveyed<br/>Signature &amp; Seal of Professional Surveyor<br/>JLP</p> <p>W.O. Num. 97-11-1003</p> <p>Certificate No. JOHN W. WEST, 676<br/>RONALD J. EIDSON, 3239<br/>GARY G. EIDSON, 12641</p> |

# VICINITY MAP

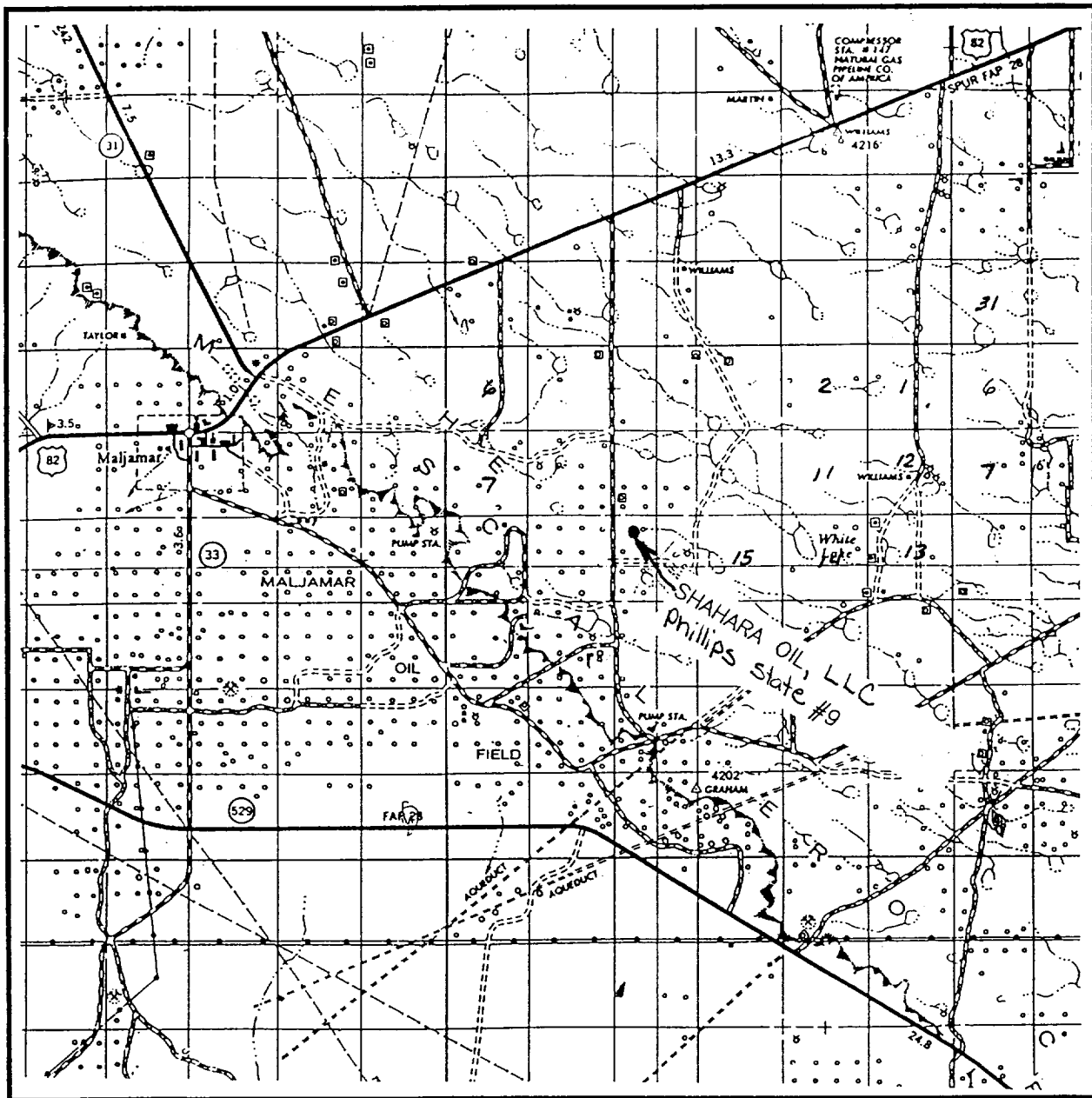

SCALE: 1" = 2 MILES

SEC. 16 TWP. 17-S RGE. 33-E

SURVEY N.M.P.M.

COUNTY LEA

DESCRIPTION 1335' FNL & 1335' FWL

ELEVATION 4193'

OPERATOR SHAHARA OIL ~~CORPORATION~~, LLC

LEASE Phillips State

**JOHN WEST ENGINEERING**  
**HOBBS, NEW MEXICO**

(505) 393-3117

# LOCATION VERIFICATION MAP

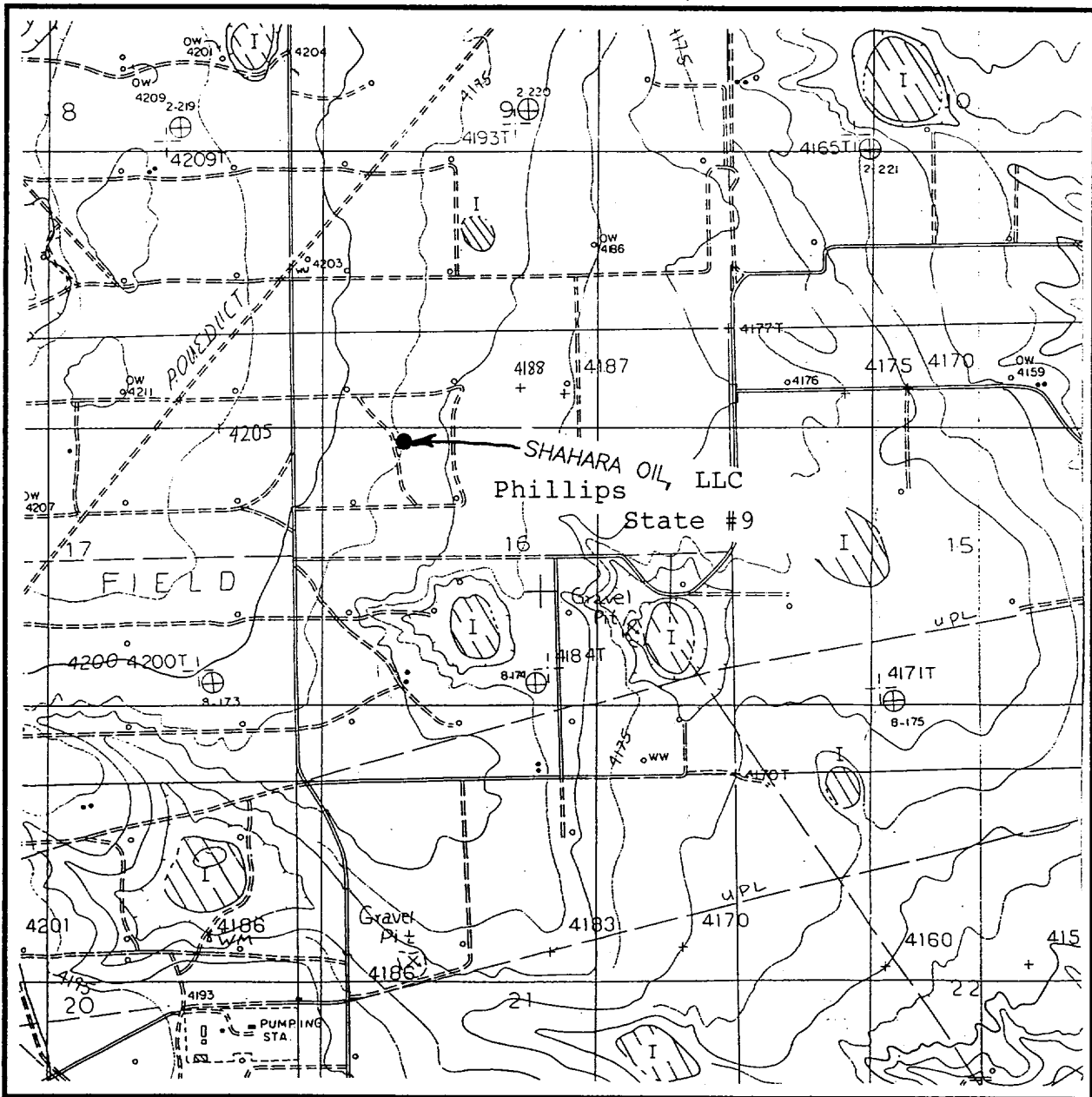

SCALE: 1" = 2000'

CONTOUR INTERVAL - 10'  
SUPPLEMENTAL CONTOUR INTERVAL 5'

SEC. 16 TWP. 17-S RGE. 33-E

SURVEY N.M.P.M.

COUNTY LEA

DESCRIPTION 1335' FNL & 1335' FWL

ELEVATION 4193'

OPERATOR SHAHARA OIL, LLC

LEASE Phillips State

U.S.G.S. TOPOGRAPHIC MAP

DOG LAKE, N.M.

**JOHN WEST ENGINEERING**  
**HOBBS, NEW MEXICO**  
**(505) 393-3117**