

State of New Mexico  
Energy, Minerals & Natural Resources Department

Form C-101

District I  
PO Box 1980, Hobbs, NM 88241-1980

District II  
811 S. First St., Artesia, NM 88210

District III  
1000 Rio Brazos Rd., Aztec, NM 87410

District IV  
2040 S. Pacheco St., Santa Fe, NM 87504

OIL CONSERVATION DIVISION  
2040 S. Pacheco St.  
Santa Fe, NM 97504

Revised February 10, 1994

Instructions on back

Submit to Appropriate District Office

State Lease - 6 Copies

Fee Lease - 5 Copies

☐ AMENDED REPORT

APPLICATION FOR PERMIT TO DRILL, RE-ENTER, DEEPEN, PLUGBACK OR ADD A ZONE

1. Operator Name and Address <b>Shahara Oil, LLC 207 W. McKay Carlsbad, NM 88220</b>		2. OGRID Number <b>143119</b>
3. API Number <b>30-025-34092</b>		
4. Property Code <b>16770</b>	5. Property Name <b>Phillips State</b>	6. Well No. <b>11</b>

7. Surface Location									
UL or lot no.	Section	Township	Range	Lot Idn.	Feet From the	North/South Line	Feet From the	East/West Line	County
<b>M</b>	<b>16</b>	<b>17S</b>	<b>33E</b>		<b>1305</b>	<b>South</b>	<b>1301</b>	<b>West</b>	<b>Lea</b>

8. Proposed Bottom Hole Location If Different From Surface									
UL or lot no.	Section	Township	Range	Lot Idn.	Feet From the	North/South Line	Feet From the	East/West Line	County
9. Proposed Pool 1 <b>Maljamar Grayburg San Andres</b>					10. Proposed Pool 2				

11. Work Type Code <b>N</b>	12. Well Type Code <b>O</b>	13. Cable/Rotary <b>R</b>	14. Lease Type Code <b>S</b>	15. Ground Level Elevation <b>4189'</b>
16. Multiple <b>No</b>	17. Proposed Depth <b>4850'</b>	18. Formation <b>San Andres</b>	19. Contractor <b>L &amp; M Drilling</b>	20. Spud Date <b>September 1, 1997</b>

21. Proposed Casing and Cement Program					
Hole Size	Casing Size	Casing weight/foot	Setting Depth	Sacks of Cement	Estimated TOC
<b>12 1/4"</b>	<b>8 5/8"</b>	<b>24#</b>	<b>500'</b>	<b>300</b>	<b>Circulate</b>
<b>7 7/8"</b>	<b>5 1/2"</b>	<b>17#</b>	<b>4850'</b>	<b>970</b>	<b>Circ 100' above 8 5/8"</b>
					<b>casing shoe</b>

22. Describe the proposed program. If this application is to DEEPEN or PLUG BACK, give the data on the present productive zone and proposed new productive zone. Describe the blowout prevention program, if any. Use additional sheets if necessary.

It is proposed to drill the above captioned well to a total depth of 4850' with rotary tools.  
If commercial production is indicated, the well will be perforated and stimulated as necessary

Blow Out Prevention: 10" Series 900 Type "E" Shaffer Hydraulic BOP

23. I hereby certify that the information given above is true and complete to the best of my knowledge and belief.

Signature:

Printed Name:

Title:

Date:

**Perry L Hughes**

**President**

**07/07/97**

Phone:

**505-885-5433**

OIL CONSERVATION DIVISION

Approved by:

Title:

Approval Date:

Conditions of Approval:

Attached: ☐

**ORIGINAL SIGNED BY**  
**DISTRICT I SUPERVISOR**

**AUG 08 1997**

Expiration Date:

Permit Expires 1 Year From Approval  
Date Unless Drilling Underway

DISTRICT I  
P.O. Box 1900, Hobbs, NM 88241-1900

DISTRICT II  
P.O. Drawer DD, Artesia, NM 88211-0719

DISTRICT III  
1000 Rio Brazos Rd., Aztec, NM 87410

DISTRICT IV  
P.O. Box 2088, Santa Fe, NM 87504-2088

State of New Mexico  
Energy, Minerals and Natural Resources Department

Form C-102  
Revised February 10, 1994  
Submit to Appropriate District Office  
State Lease - 4 Copies  
Fee Lease - 3 Copies

OIL CONSERVATION DIVISION

P.O. Box 2088  
Santa Fe, New Mexico 87504-2088

☐ AMENDED REPORT

WELL LOCATION AND ACREAGE DEDICATION PLAT

API Number <b>30-025-34092</b>	Pool Code 43329	Pool Name Maljamar Grayburg San Andres
Property Code 16770	Property Name Phillips State <del>SSX</del>	Well Number 11
OGRID No. 143119	Operator Name SHAHARA OIL CORPORATION, LLC	Elevation 4189

Surface Location

UL or lot No.	Section	Township	Range	Lot Idn	Feet from the	North/South line	Feet from the	East/West line	County
M	16	17 S	33 E		1305	SOUTH	1301	WEST	LEA

Bottom Hole Location If Different From Surface

UL or lot No.	Section	Township	Range	Lot Idn	Feet from the	North/South line	Feet from the	East/West line	County
Dedicated Acres <b>40</b>	Joint or Infill	Consolidation Code	Order No.						

NO ALLOWABLE WILL BE ASSIGNED TO THIS COMPLETION UNTIL ALL INTERESTS HAVE BEEN CONSOLIDATED  
OR A NON-STANDARD UNIT HAS BEEN APPROVED BY THE DIVISION

	<p><b>OPERATOR CERTIFICATION</b></p> <p>I hereby certify the the information contained herein is true and complete to the best of my knowledge and belief.</p> <p><i>Perry D. Hughes</i> Signature Perry D. Hughes Printed Name President Title 07/07/97 Date</p> <p><b>SURVEYOR CERTIFICATION</b></p> <p>I hereby certify that the well location shown on this plat was plotted from field notes of actual surveys made by me or under my supervision, and that the same is true and correct to the best of my belief.</p> <p>JUNE 23, 1997 Date Surveyed Signature &amp; Seal of Professional Surveyor <i>Ronald J. Eidson</i> W.Q. Num. 97-11-1005 Certificate No. 676 RONALD J. EIDSON, 3239 GARY G. EIDSON, 12641</p>
--	--

DISTRICT I  
P.O. Box 1980, Hobbs, NM 88241-1980

DISTRICT II  
P.O. Drawer DD, Artesia, NM 88211-0719

DISTRICT III  
1000 Rio Brazos Rd., Aztec, NM 87410

DISTRICT IV  
P.O. Box 2088, Santa Fe, NM 87504-2088

State of New Mexico

Energy, Minerals and Natural Resources Department

Form C-102  
Revised February 10, 1994  
Submit to Appropriate District Office  
State Lease - 4 Copies  
Fee Lease - 3 Copies

OIL CONSERVATION DIVISION

P.O. Box 2088  
Santa Fe, New Mexico 87504-2088

☐ AMENDED REPORT

WELL LOCATION AND ACREAGE DEDICATION PLAT

API Number	Pool Code	Pool Name
	43329	Maljamar Grayburg San Andres
Property Code	Property Name	Well Number
16770	Phillips State 880	11
OGRID No.	Operator Name	Elevation
143119	SHAHARA OIL CORPORATION, LLC	4189

Surface Location

UL or lot No.	Section	Township	Range	Lot Idn	Feet from the	North/South line	Feet from the	East/West line	County
M	16	17 S	33 E		1305	SOUTH	1301	WEST	LEA

Bottom Hole Location If Different From Surface

UL or lot No.	Section	Township	Range	Lot Idn	Feet from the	North/South line	Feet from the	East/West line	County
Dedicated Acres	Joint or Infill	Consolidation Code	Order No.						

NO ALLOWABLE WILL BE ASSIGNED TO THIS COMPLETION UNTIL ALL INTERESTS HAVE BEEN CONSOLIDATED  
OR A NON-STANDARD UNIT HAS BEEN APPROVED BY THE DIVISION

		<p><b>OPERATOR CERTIFICATION</b></p> <p>I hereby certify the the information contained herein is true and complete to the best of my knowledge and belief.</p> <p><i>Perry L. Hughes</i></p> <p>Signature Perry L. Hughes</p> <p>Printed Name President</p> <p>Title 07/07/97</p> <p>Date</p>
		<p><b>SURVEYOR CERTIFICATION</b></p> <p>I hereby certify that the well location shown on this plat was plotted from field notes of actual surveys made by me or under my supervision, and that the same is true and correct to the best of my belief.</p> <p>JUNE 23, 1997</p> <p>Date Surveyed Signature &amp; Seal of Professional Surveyor</p> <p>W.O. Num. 97-11-1005</p> <p>Certificate No. JOHN W. WEST, 676 RONALD J. EIDSON, 3239 GARY G. EIDSON, 12641</p>

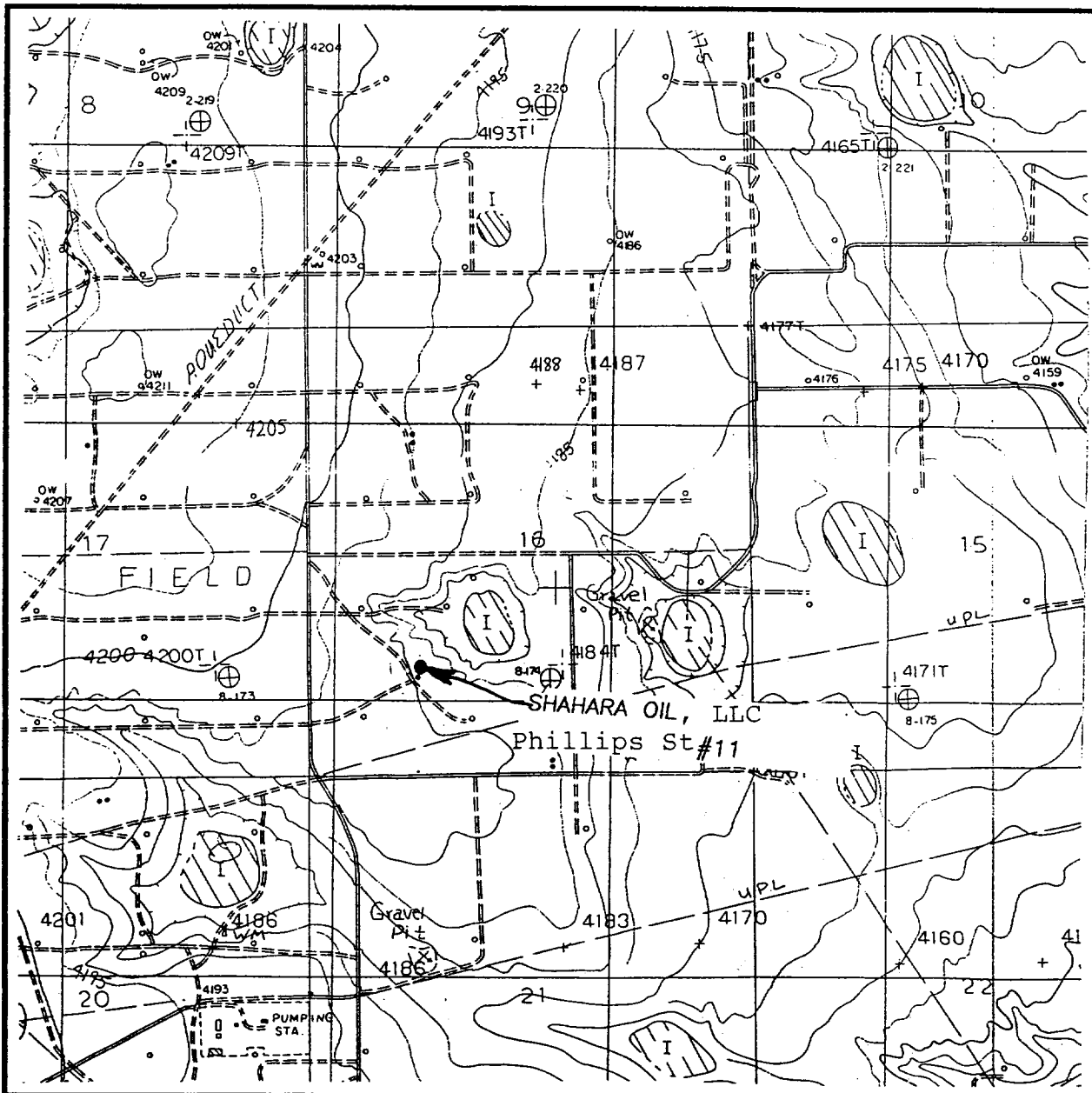

CONTOUR INTERVAL - 10'  
SUPPLEMENTAL CONTOUR INTERVAL 5'

DOG LAKE, N.M.

**JOHN WEST ENGINEERING  
HOBBS, NEW MEXICO  
(505) 393-3117**

# VICINITY MAP

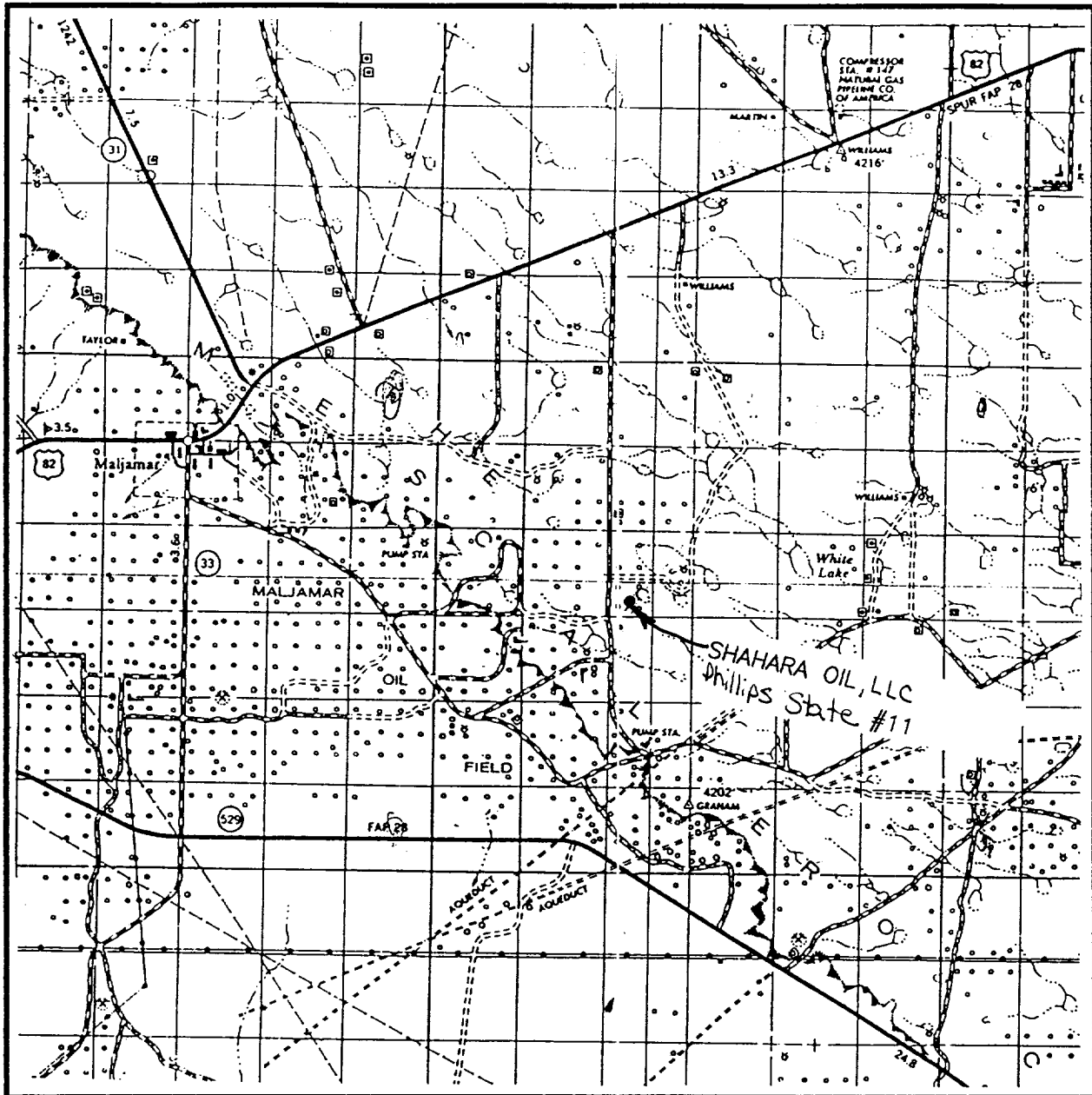

SCALE: 1" = 2 MILES

SEC. 16 TWP. 17-S RGE. 33-E

SURVEY N.M.P.M.

COUNTY LEA

DESCRIPTION 1305' FSL & 1301' FWL

ELEVATION 4189'

OPERATOR SHAHARA OIL, LLC

LEASE Phillips State

**JOHN WEST ENGINEERING**  
**HOBBS, NEW MEXICO**  
**(505) 393-3117**