

DISTRICT I
P.O. Box 1980, Hobbs, NM 88241-1980

DISTRICT II
P.O. Drawer 100, Artesia, NM 88211-0719

DISTRICT III
1000 Rio Brazos Rd., Aztec, NM 87410

DISTRICT IV
P.O. Box 2088, Santa Fe, NM 87504-2088

State of New Mexico
Energy, Minerals and Natural Resources Department

Form C-102
Revised February 10, 1994
Submit to Appropriate District Office
State Lease - 4 Copies
Fee Lease - 3 Copies

OIL CONSERVATION DIVISION

P.O. Box 2088
Santa Fe, New Mexico 87504-2088

☐ AMENDED REPORT

WELL LOCATION AND ACREAGE DEDICATION PLAT

API Number 30-025-34177	Pool Code 43329	Pool Name Malmamar Grayburg San Andres
Property Code 16770	Property Name PHILLIPS STATE	Well Number 12
OGRID No. 143119	Operator Name SHAHARA OIL, LLC	Elevation 4195

Surface Location

UL or lot No. D	Section 16	Township 17 S	Range 33 E	Lot Idn	Feet from the 331	North/South line NORTH	Feet from the 1310	East/West line WEST	County LEA
---------------------------	----------------------	-------------------------	----------------------	---------	-----------------------------	----------------------------------	------------------------------	-------------------------------	----------------------

Bottom Hole Location If Different From Surface

UL or lot No.	Section	Township	Range	Lot Idn	Feet from the	North/South line	Feet from the	East/West line	County
---------------	---------	----------	-------	---------	---------------	------------------	---------------	----------------	--------

Dedicated Acres	Joint or Infill	Consolidation Code	Order No.
-----------------	-----------------	--------------------	-----------

NO ALLOWABLE WILL BE ASSIGNED TO THIS COMPLETION UNTIL ALL INTERESTS HAVE BEEN CONSOLIDATED
OR A NON-STANDARD UNIT HAS BEEN APPROVED BY THE DIVISION

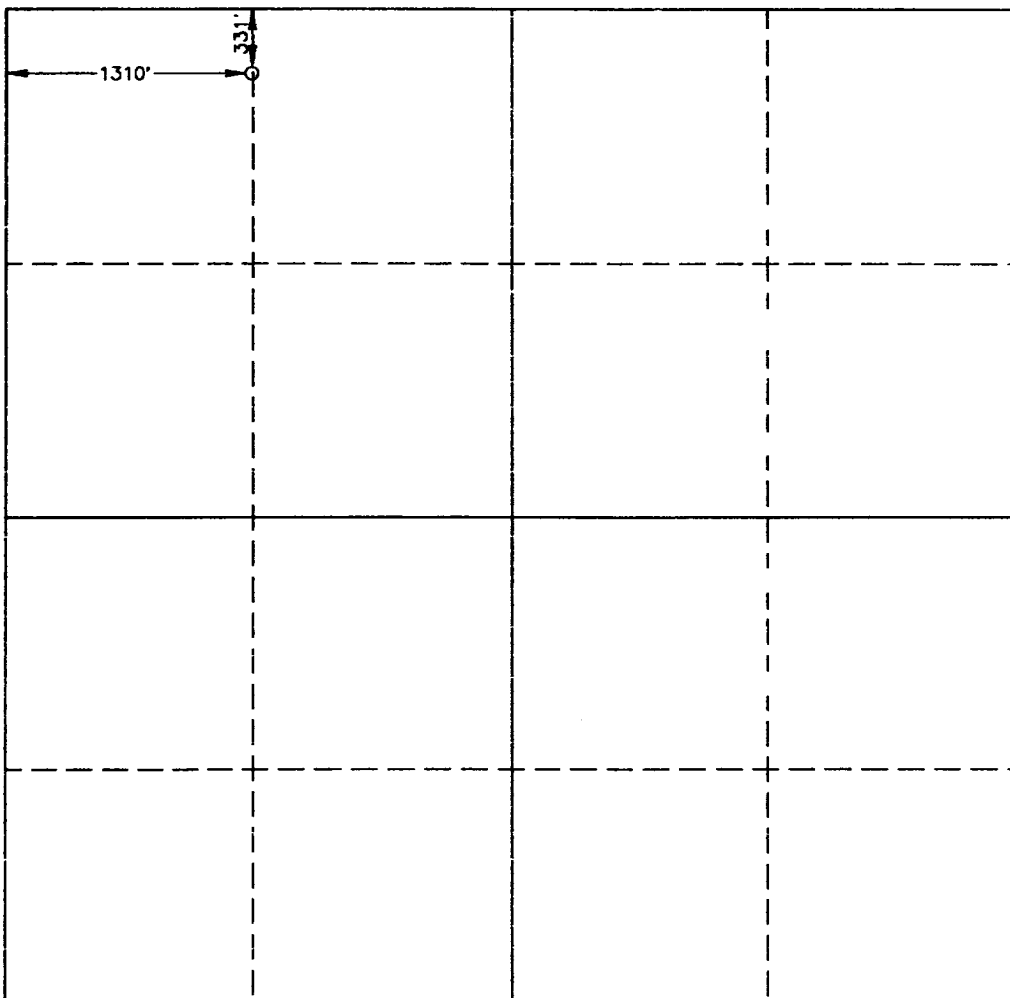
	<p>OPERATOR CERTIFICATION</p> <p>I hereby certify the information contained herein is true and complete to the best of my knowledge and belief.</p> <p><i>Perry L. Hughes</i> Signature Perry L. Hughes Printed Name PRESIDENT Title 10/23/97 Date</p> <p>SURVEYOR CERTIFICATION</p> <p>I hereby certify that the well location shown on this plat was plotted from field notes of actual surveys made by me or under my supervision, and that the same is true and correct to the best of my belief.</p> <p>OCTOBER 20, 1997 Date Surveyed JLP Signature of Seal Professional Surveyor NEW MEXICO 10-21-97 W.O. Num. 97-11671 Certificate No. 676 EDSON 3239 12641</p>
---	---

DISTRICT I
P.O. Box 1980, Hobbs, NM 88241-1980

DISTRICT II
P.O. Drawer DD, Artesia, NM 88211-0719

DISTRICT III
1000 Rio Brazos Rd., Artec, NM 87410

DISTRICT IV
P.O. Box 2088, Santa Fe, NM 87504-2088

State of New Mexico
Energy, Minerals and Natural Resources Department

Form C-102
Revised February 10, 1994
Submit to Appropriate District Office
State Lease - 4 Copies
Fee Lease - 3 Copies

OIL CONSERVATION DIVISION

P.O. Box 2088
Santa Fe, New Mexico 87504-2088

☐ AMENDED REPORT

WELL LOCATION AND ACREAGE DEDICATION PLAT

API Number	Pool Code 43329	Pool Name Maljamar Grayburg San Andres
Property Code 16770	Property Name PHILLIPS STATE	Well Number 12
OGRID No. 143119	Operator Name SHAHARA OIL, LLC	Elevation 4195

Surface Location

UL or lot No. D	Section 16	Township 17 S	Range 33 E	Lot Idn	Feet from the 331	North/South line NORTH	Feet from the 1310	East/West line WEST	County LEA
--------------------	---------------	------------------	---------------	---------	----------------------	---------------------------	-----------------------	------------------------	---------------

Bottom Hole Location If Different From Surface

UL or lot No.	Section	Township	Range	Lot Idn	Feet from the	North/South line	Feet from the	East/West line	County
Dedicated Acres		Joint or Infill	Consolidation Code	Order No.					

NO ALLOWABLE WILL BE ASSIGNED TO THIS COMPLETION UNTIL ALL INTERESTS HAVE BEEN CONSOLIDATED
OR A NON-STANDARD UNIT HAS BEEN APPROVED BY THE DIVISION

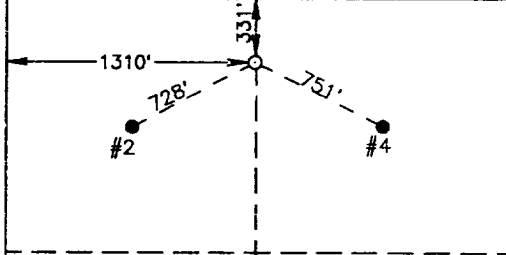
	<p>OPERATOR CERTIFICATION</p> <p>I hereby certify the the information contained herein is true and complete to the best of my knowledge and belief.</p> <p><i>Perry L. Hughes</i> Signature Perry L. Hughes Printed Name President Title 10/23/97 Date</p> <p>SURVEYOR CERTIFICATION</p> <p>I hereby certify that the well location shown on this plat was plotted from field notes of actual surveys made by me or under my supervision, and that the same is true and correct to the best of my belief.</p> <p>OCTOBER 20, 1997 Date Surveyed JLP</p> <p>Signature & Seal of Professional Surveyor</p> <p>W.O. Num. 97-11-1671</p> <p>Certificate No. JOHN W. WEST, 676 RONALD J. EIDSON, 3239 GARY G. EIDSON, 12641</p>
--	--

LOCATION VERIFICATION MAP

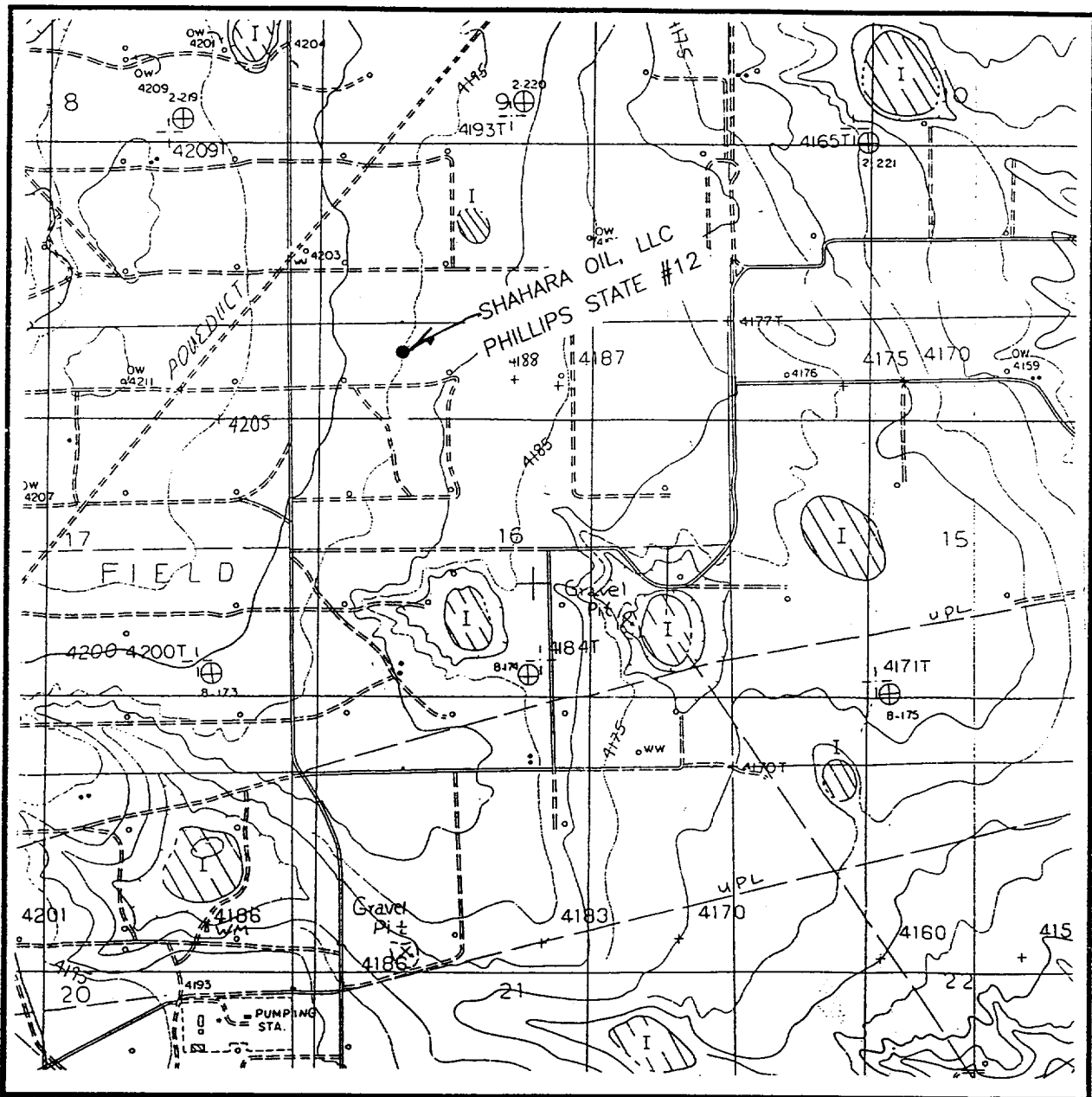

SCALE: 1" = 2000'

CONTOUR INTERVAL - 10'

SUPPLEMENTAL CONTOUR INTERVAL 5'

SEC. 16 TWP. 17-S RGE. 33-E

SURVEY N.M.P.M.

COUNTY LEA

DESCRIPTION 331' FNL & 1310' FWL

ELEVATION 4195

OPERATOR SHAHARA OIL, LLC

LEASE PHILLIPS STATE

U.S.G.S. TOPOGRAPHIC MAP

DOG LAKE, N.M.

JOHN WEST ENGINEERING

HOBBS, NEW MEXICO

(505) 393-3117

VICINITY MAP

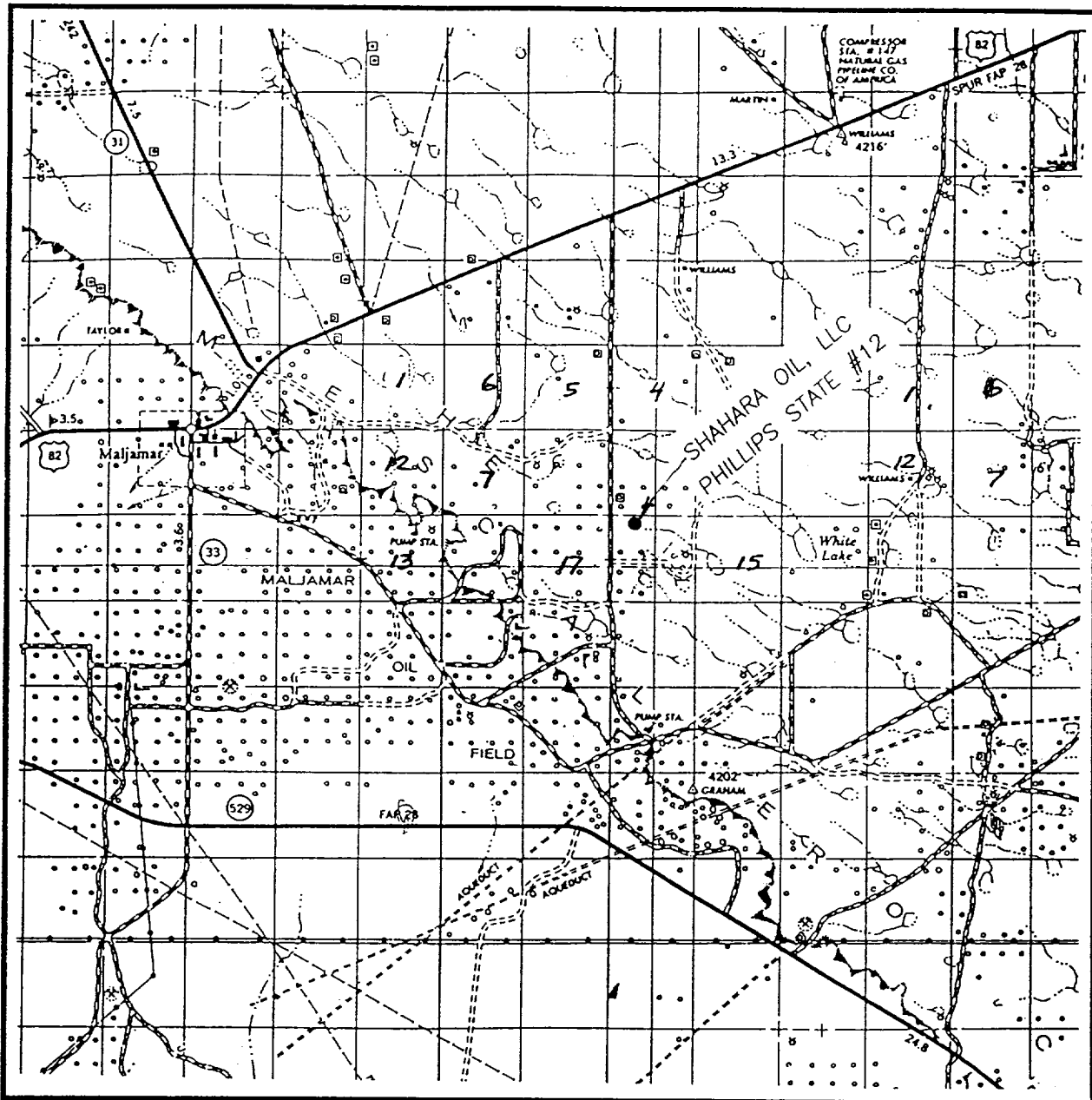

SCALE: 1" = 2 MILES

SEC. 16 TWP. 17-S RGE. 33-E

SURVEY N.M.P.M.

COUNTY LEA

DESCRIPTION 331' FNL & 1310' FWL

ELEVATION 4195

OPERATOR SHAHARA OIL, LLC

LEASE PHILLIPS STATE

JOHN WEST ENGINEERING

HOBBS, NEW MEXICO

(505) 393-3117