

DISTRICT I
P.O. Box 1980, Hobbs, NM 88240

DISTRICT II
P.O. Drawer DD, Artesia, NM 88210

DISTRICT III
1000 Rio Brazos Rd., Aztec, NM 87410

State of New Mexico
Energy, Minerals and Natural Resources Department

Form C-102
Revised February 10, 1984
Instruction on back
Submit to Appropriate District Office
State Lease - 4 Copies
Fee Lease - 3 Copies

OIL CONSERVATION DIVISION
P.O. Box 2088
Santa Fe, New Mexico 87504-2088

☐ AMENDED REPORT

WELL LOCATION AND ACREAGE DEDICATION PLAT

API Number 30-025-34284	Pool Code 40760	Well Name N. E. MONTIETH "C"
Property Code 22371	Property Name MONTIETH "C"	Well Number 1
OGRID No. 001801	Operator Name BASS ENTERPRISES PROD. CO.	Elevation 3858'

Surface Location

UL or lot No. B	Section 13	Township 16 S	Range 36 E	Lot Idn	Feet from the 660	North/South line NORTH	Feet from the 1830	East/West line EAST	County LEA
--------------------	---------------	------------------	---------------	---------	----------------------	---------------------------	-----------------------	------------------------	---------------

Bottom Hole Location If Different From Surface

UL or lot No. B	Section 13	Township 16S	Range 36E	Lot Idn	Feet from the 630.5'	North/South line North	Feet from the 2318'	East/West line East	County Lea
Dedicated Acres 80	Joint or Infill	Consolidation Code	Order No.						

NO ALLOWABLE WILL BE ASSIGNED TO THIS COMPLETION UNTIL ALL INTERESTS HAVE BEEN CONSOLIDATED
OR A NON-STANDARD UNIT HAS BEEN APPROVED BY THE DIVISION

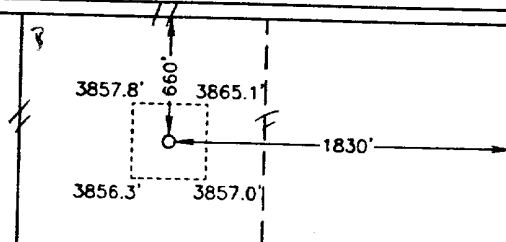
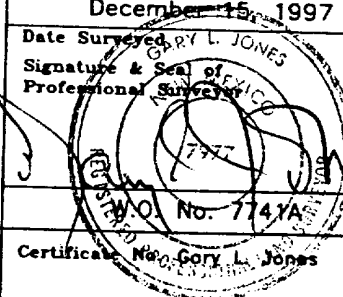
REVISION: 4-24-98 - New Mexico State Plane Coords. East Zone, NAD '27 X-815,600.8 Y-702,724.3				OPERATOR CERTIFICATION I hereby certify the the information contained herein is true and complete to the best of my knowledge and belief. <u>William R. Dannels</u> Signature William R. Dannels Printed Name Division Drilling Supt. Title April 29, 1998 Date	
				SURVEYOR CERTIFICATION I hereby certify that the well location shown on this plat was plotted from field notes of actual surveys made by me or under my supervision, and that the same is true and correct to the best of my belief. December 15, 1997 Date Surveyed Signature & Seal of Professional Surveyor  Certificate No. Gary L. Jones 7977 BASIN SURVEYS	

MATADOR PETROLEUM (Oper.)
RIO PECOS CORP.

COPY

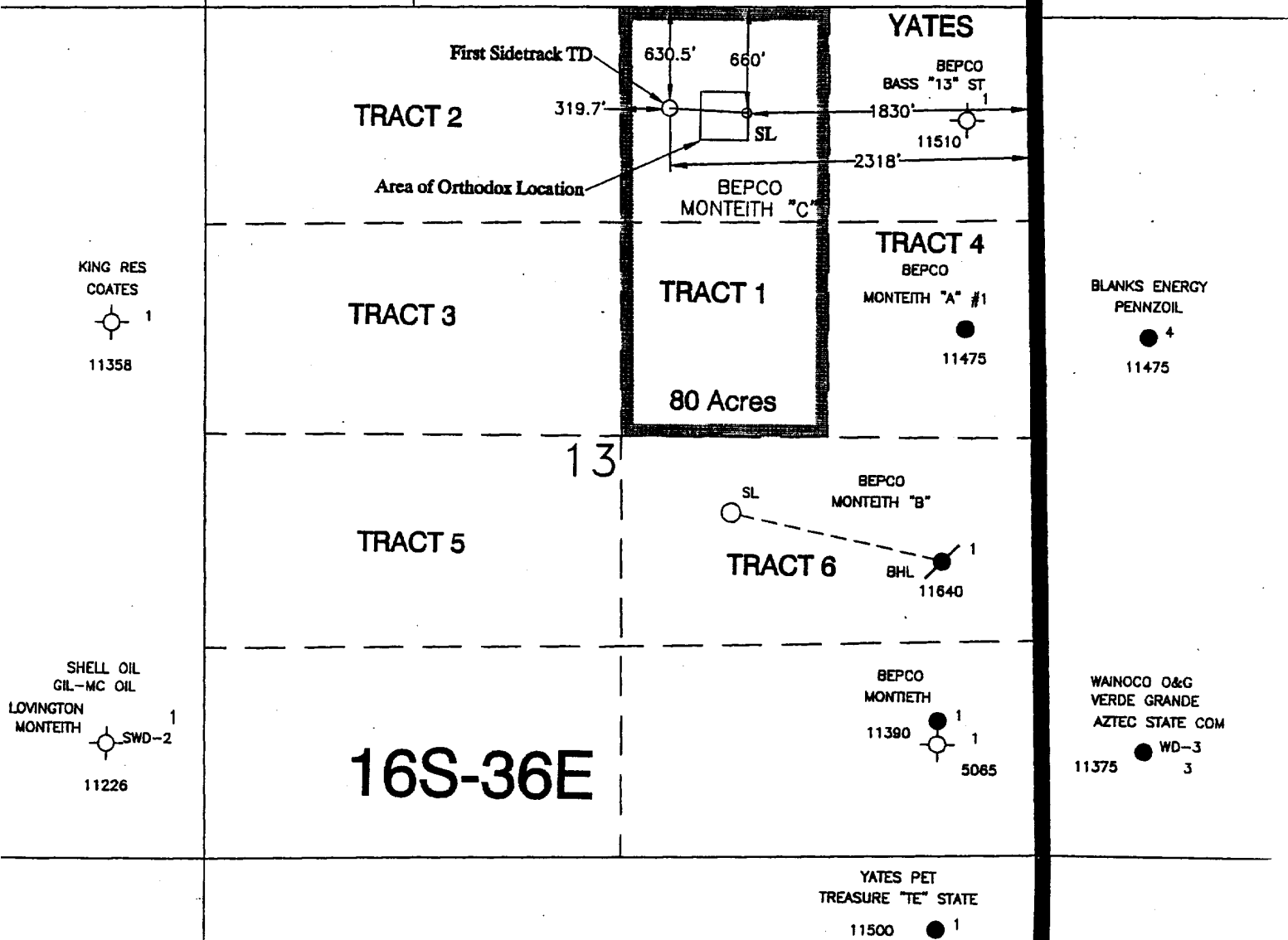

Bass Enterprises Production Co.

MONTEITH PROSPECT
Lea County, New Mexico

SE Lovington Area

LAND PLAT

DATE: 7-14-98	SCALE: 1" = 1000'
DEPT: Land	DRAFTED BY: P. Ortiz
INTER. BY: W. Carlin	FILE: Monteith C-1.dwg

N.M.O.C.D. Case 12010
Bass Enterprises Prod. Co.
Exhibit No.
July 23, 1998