

State of New Mexico
Energy, Minerals & Natural Resources Department

Form C-101

Revised February 10, 1994

Instructions on back

Submit to Appropriate District Office

State Lease - 6 Copies

Fee Lease - 5 Copies

____ AMENDED REPORT

District I

PO Box 1960, Hobbs, NM 88241-1960

District II

PO Drawer DD, Artesia, NM 88211-0719

District III

1000 Rio Brazos Rd., Aztec, NM 87410

District IV

PO Box 2068, Santa Fe, NM 87504-2068

OIL CONSERVATION DIVISION

2040 S. Pacheco
Santa Fe, NM 97504

APPLICATION FOR PERMIT TO DRILL, RE-ENTER, DEEPEN, PLUG BACK OR ADD A ZONE

1. Operator Name and Address Shahara Oil, LLC 207 West McKay Carlsbad, NM 88220		2. OGRID Number 143119
		3. API Number 30-025-34345
4. Property Code 16770	5. Property Name Phillips State	6. Well No. 16

7. Surface Location									
UL or lot no.	Section	Township	Range	Lot Idn.	Feet From the	North/South Line	Feet From the	East/West Line	County
C	16	17S	33E		330	North	2310	West	Lea

8. Proposed Bottom Hole Location If Different From Surface									
UL or lot no.	Section	Township	Range	Lot Idn.	Feet From the	North/South Line	Feet From the	East/West Line	County
9. Proposed Pool 1 43329 - Maljamar Grayburg San Andres					10. Proposed Pool 2				

11. Work Type Code N	12. Well Type Code O	13. Cable/Rotary R	14. Lease Type Code S	15. Ground Level Elevation 4190'
16. Multiple No	17. Proposed Depth 4900'	18. Formation Grayburg SA	19. Contractor Artesia Fishing Tool	20. Spud Date 04/01/98

21. Proposed Casing and Cement Program					
Hole Size	Casing Size	Casing weight/foot	Setting Depth	Sacks of Cement	Estimated TOC
12 1/4"	8 5/8"	24#	500'	300	Circulate
7 7/8"	5 1/2"	17#	4900'	970	Circ 100' above 8 5/8"
					casing shoe

22. Describe the proposed program. If this application is to DEEPEN or PLUG BACK, give the data on the present productive zone and proposed new productive zone. Describe the blowout prevention program, if any. Use additional sheets if necessary.

It is proposed to drill the above captioned well to a total depth of 4900' with rotary tools.
If commercial production is indicated, the well will be perforated and stimulated as necessary.

Permit Expires 1 Year From Approval
Date Unless Drilling Underway

Blow Out Prevention: 10" Series 900 Type "E" Shaffer Hydraulic BOP

23. I hereby certify that the information given above is true and complete to the best of my knowledge and belief.

Signature: *Thallia Marshall*
Printed Name: **Thallia Marshall**

Title: **Agent**

Date: **03/17/98**

Phone: **505-885-5433**

OIL CONSERVATION DIVISION

Approved by: **ORIGINAL SIGNED BY**

Title: **GARY WINK
FIELD REP. II**

Approval Date:

Conditions of Approval:

Attached: _____

3/18/98

8 mlp

DISTRICT I
P.O. Box 1980, Hobbs, NM 88241-1980

DISTRICT II
P.O. Drawer DD, Artesia, NM 88211-0719

DISTRICT III
1000 Rio Brazos Rd., Aztec, NM 87410

DISTRICT IV
P.O. BOX 2088, SANTA FE, N.M. 87504-2088

State of New Mexico
Energy, Minerals and Natural Resources Department

Form C-102
Revised February 10, 1994
Submit to Appropriate District Office
State Lease - 4 Copies
Fee Lease - 3 Copies

OIL CONSERVATION DIVISION

P.O. Box 2088
Santa Fe, New Mexico 87504-2088

☐ AMENDED REPORT

WELL LOCATION AND ACREAGE DEDICATION PLAT

API Number 30-025-34345	Pool Code 43329	Pool Name Maljamar Grayburg San Andres
Property Code 16770	Property Name PHILLIPS STATE	Well Number 16
OGRID No. 143119	Operator Name SHAHARA OIL LLC	Elevation 4190'

Surface Location

UL or lot No.	Section	Township	Range	Lot Idn	Feet from the	North/South line	Feet from the	East/West line	County
C	16	17 S	33 E		330	NORTH	2310	WEST	LEA

Bottom Hole Location If Different From Surface

UL or lot No.	Section	Township	Range	Lot Idn	Feet from the	North/South line	Feet from the	East/West line	County
Dedicated Acres	Joint or Infill	Consolidation Code	Order No.						

NO ALLOWABLE WILL BE ASSIGNED TO THIS COMPLETION UNTIL ALL INTERESTS HAVE BEEN CONSOLIDATED
OR A NON-STANDARD UNIT HAS BEEN APPROVED BY THE DIVISION

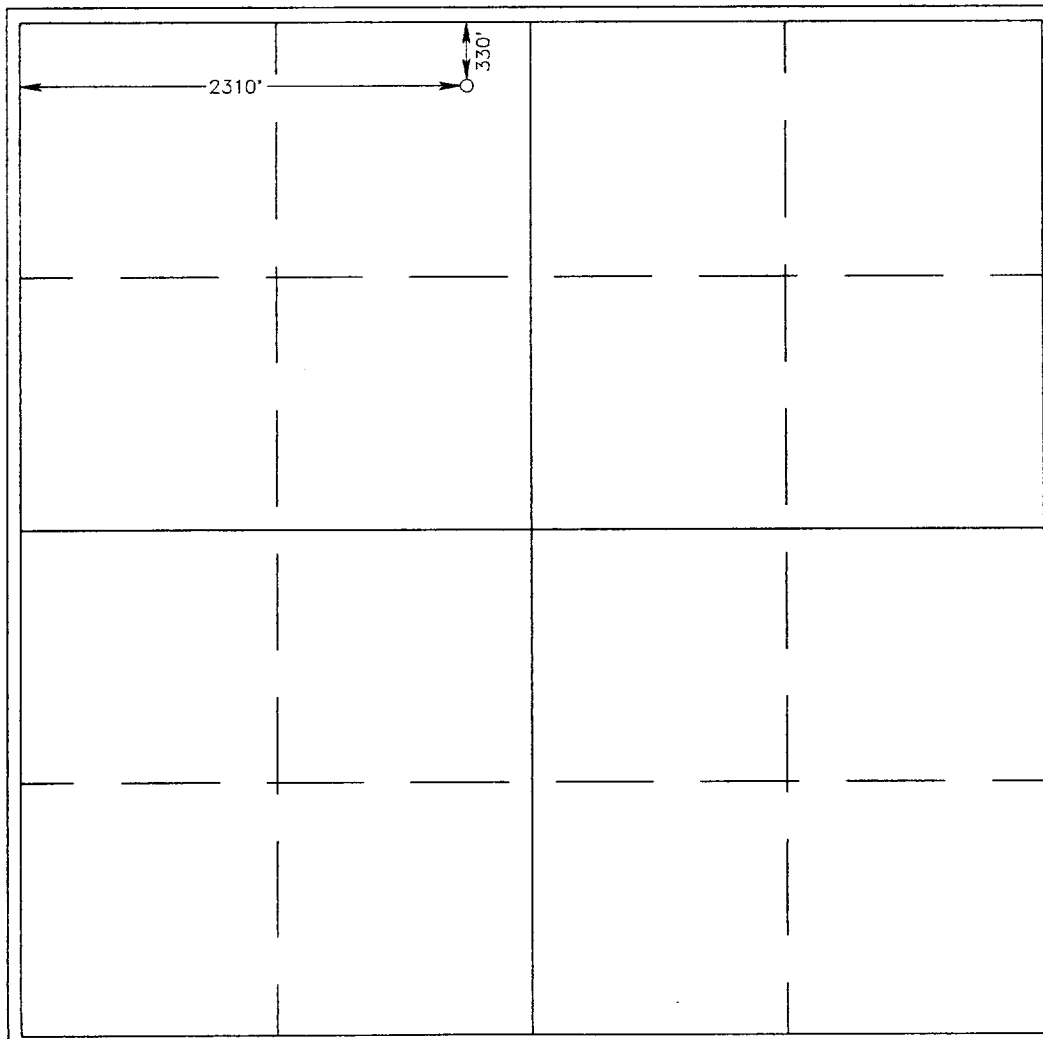
	<p>OPERATOR CERTIFICATION</p> <p>I hereby certify the the information contained herein is true and complete to the best of my knowledge and belief.</p> <p><i>Perry L. Hughes</i> Signature Perry L. Hughes Printed Name PRESIDENT Title 3/17/98 Date</p> <p>SURVEYOR CERTIFICATION</p> <p>I hereby certify that the well location shown on this plat was plotted from field notes of actual surveys made by me or under my supervision and that the same is true and correct to the best of my belief.</p> <p>MARCH 12, 1998</p> <p>Date Surveyed Signature & Seal of Professional Surveyor <i>Ronald D. Edson</i> Professional Surveyor 3-16-98 3239-15-0448 Certificate No. RONALD D. EDSON 3239 SARAH EDSON 12641</p>
---	---

VICINITY MAP

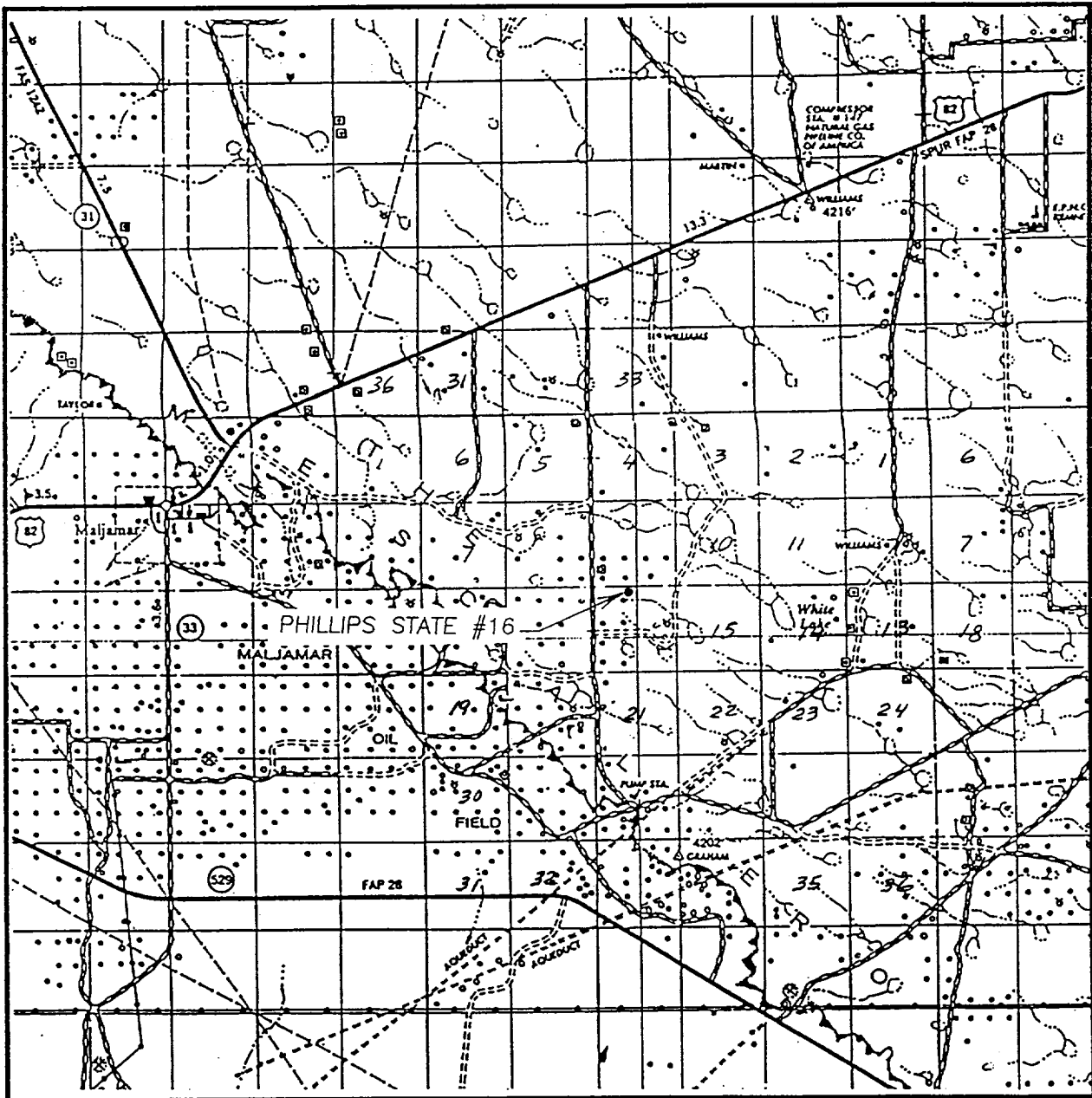

SCALE: 1" = 2 MILES

SEC. 16 TWP. 17-S RGE. 33-E

SURVEY N.M.P.M.

COUNTY LEA

DESCRIPTION 330' FNL & 2310' FWL

ELEVATION 4190'

OPERATOR SHAHARA OIL LLC

LEASE PHILLIPS STATE

JOHN WEST ENGINEERING
HOBBS, NEW MEXICO
(505) 393-3117

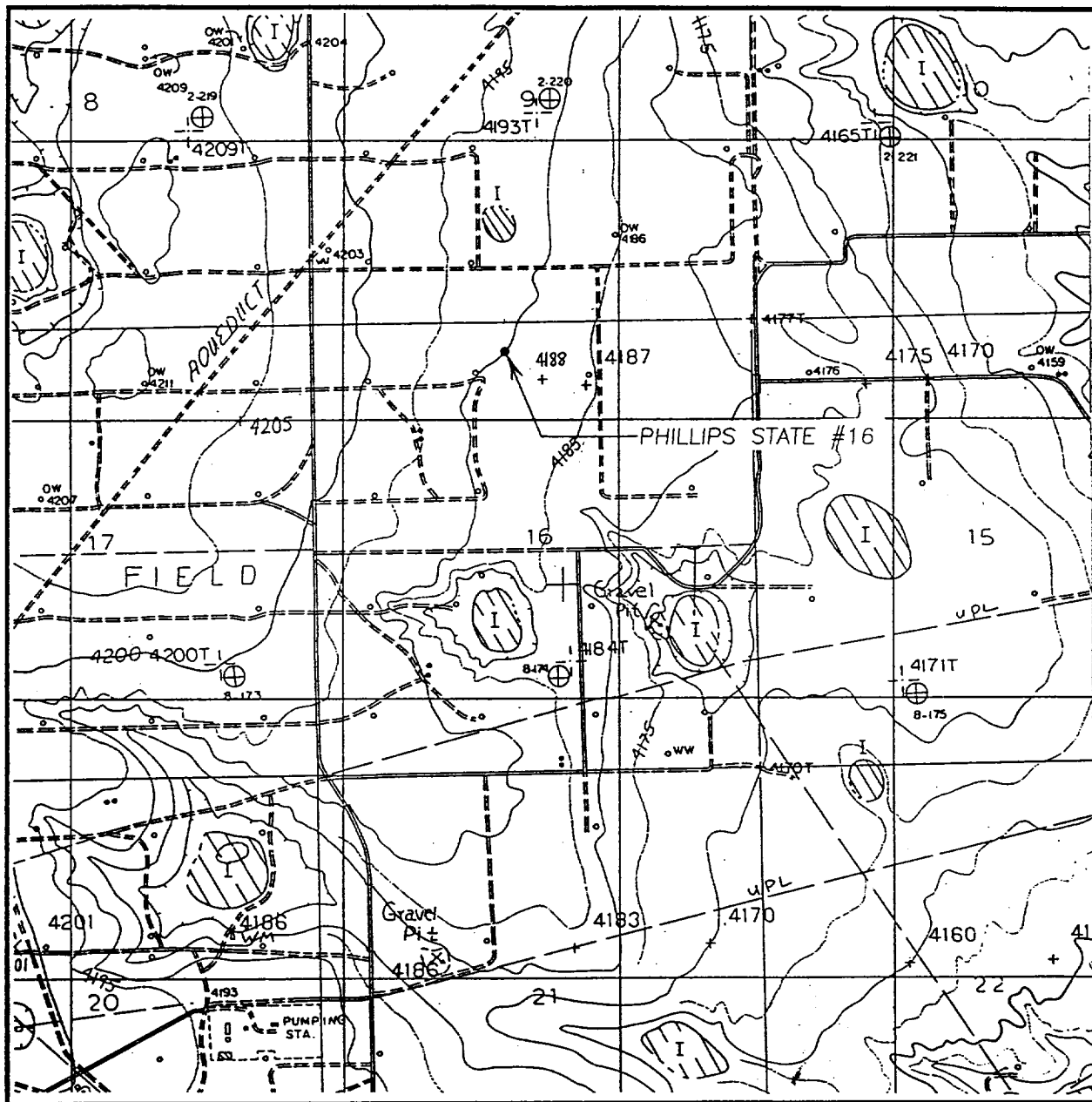

CONTOUR INTERVAL - 10'
SUPPLEMENTAL - 5'

U.S.G.S. TOPOGRAPHIC MAP
DOG LAKE, NM

**JOHN WEST ENGINEERING
HOBBS, NEW MEXICO
(505) 393-3117**