

SECTION 9, TOWNSHIP 16 SOUTH, RANGE 35 EAST, N.M.P.M.,  
LEA COUNTY, NEW MEXICO.

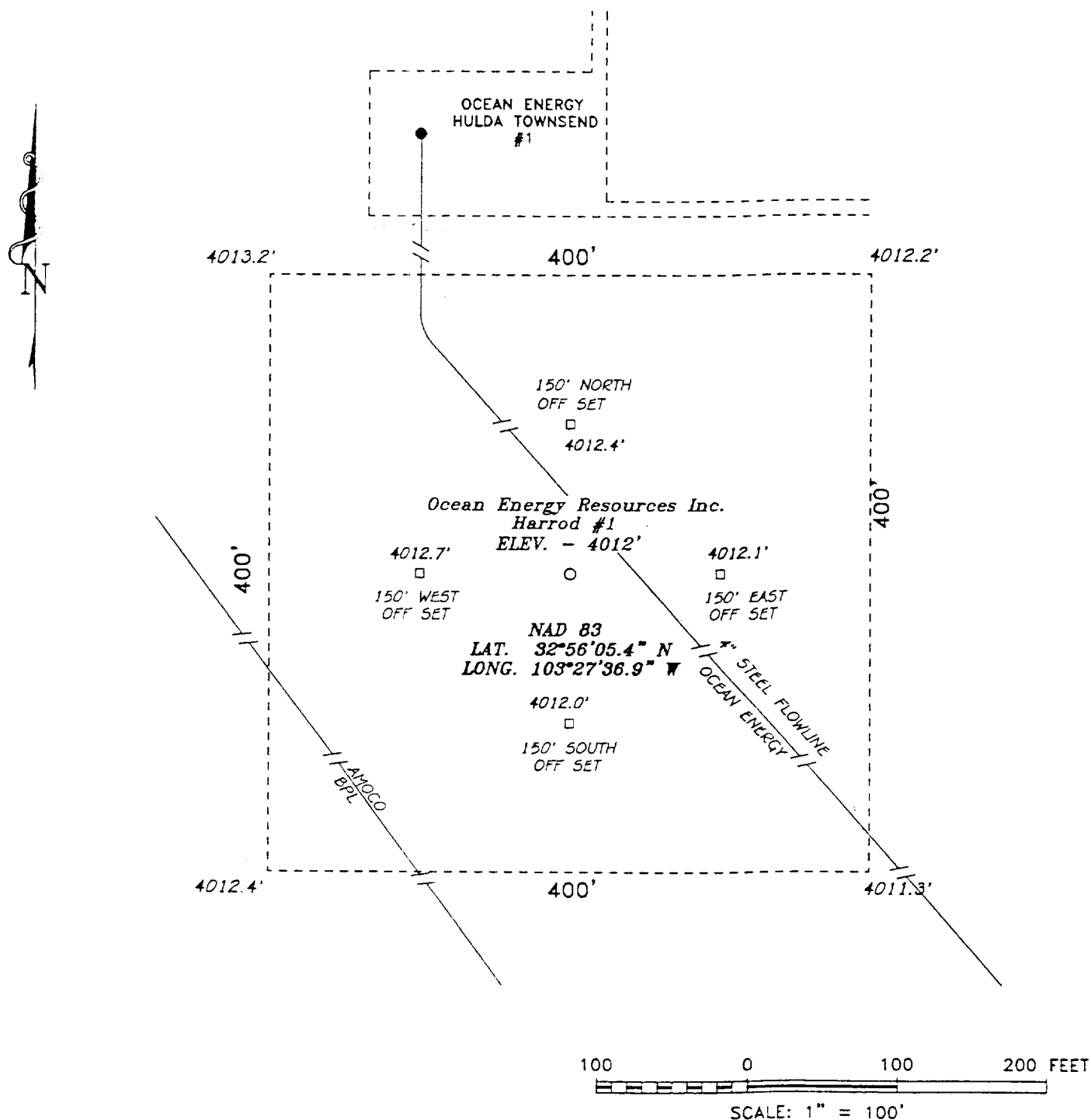

**Ocean Energy Resources Inc.**

REF: Harrod #1 / Well Pad Topo

THE HARROD No. 1 LOCATED 1980' FROM THE  
SOUTH LINE AND 1870' FROM THE EAST LINE OF  
SECTION 9, TOWNSHIP 16 SOUTH, RANGE 35 EAST,  
N.M.P.M., LEA COUNTY, NEW MEXICO.

**BASIN SURVEYS** P.O. BOX 1786-HOBBS, NEW MEXICO

W.O. Number: 8499

Drawn By: K. GOAD

Date: 11-12-98

Disk: KJG #119 - 8499A.DWG

Survey Date: 11-11-98

Sheet 1 of 1 Sheets