

Submit to Appropriate  
District Office  
State Lease - 4 copies  
Fee Lease - 3 copies

State of New Mexico  
Enr Minerals and Natural Resources Department

Form C-102  
Revised 1-1-89

OIL CONSERVATION DIVISION

P.O. Box 2088  
Santa Fe, New Mexico 87504-2088

DISTRICT I  
P.O. Box 1980, Hobbs, NM 88240

DISTRICT II  
P.O. Drawer DD, Artesia, NM 88210

DISTRICT III  
1000 Rio Brazos Rd., Aztec, NM 87410

WELL LOCATION AND ACREAGE DEDICATION PLAT

All Distances must be from the outer boundaries of the section

30-025-34815

Operator David H. Arrington Oil & Gas		Lease Mayfly "14" State Com		Well No. 5
Unit Letter "D"	Section 14	Township -16-S	Range -35-E	County Lea
Actual Footage Location of Well: 330 feet from the North line and 530 feet from the West line				
Ground level Elev. 3985'	Producing Formation Strawn	Pool Northwest Shoe Bar Strawn	Dedicated Acreage: 40 Acres	

1. Outline the acreage dedicated to the subject well by colored pencil or hatchure marks on the plat below.
2. If more than one lease is dedicated to the well, outline each and identify the ownership thereof (both as to working interest and royalty).
3. If more than one lease of different ownership is dedicated to the well, have the interest of all owners been consolidated by communitization, unitization, force-pooling, etc?  
☐ Yes ☐ No If answer is "yes" type of consolidation \_\_\_\_\_  
If answer is "no" list the owners and tract descriptions which have actually been consolidated. (Use reverse side of this form if necessary.)  
No allowable will be assigned to the well until all interests have been consolidated (by communitization, unitization, forced-pooling, or otherwise) or until a non-standard unit, eliminating such interest, has been approved by the Division.

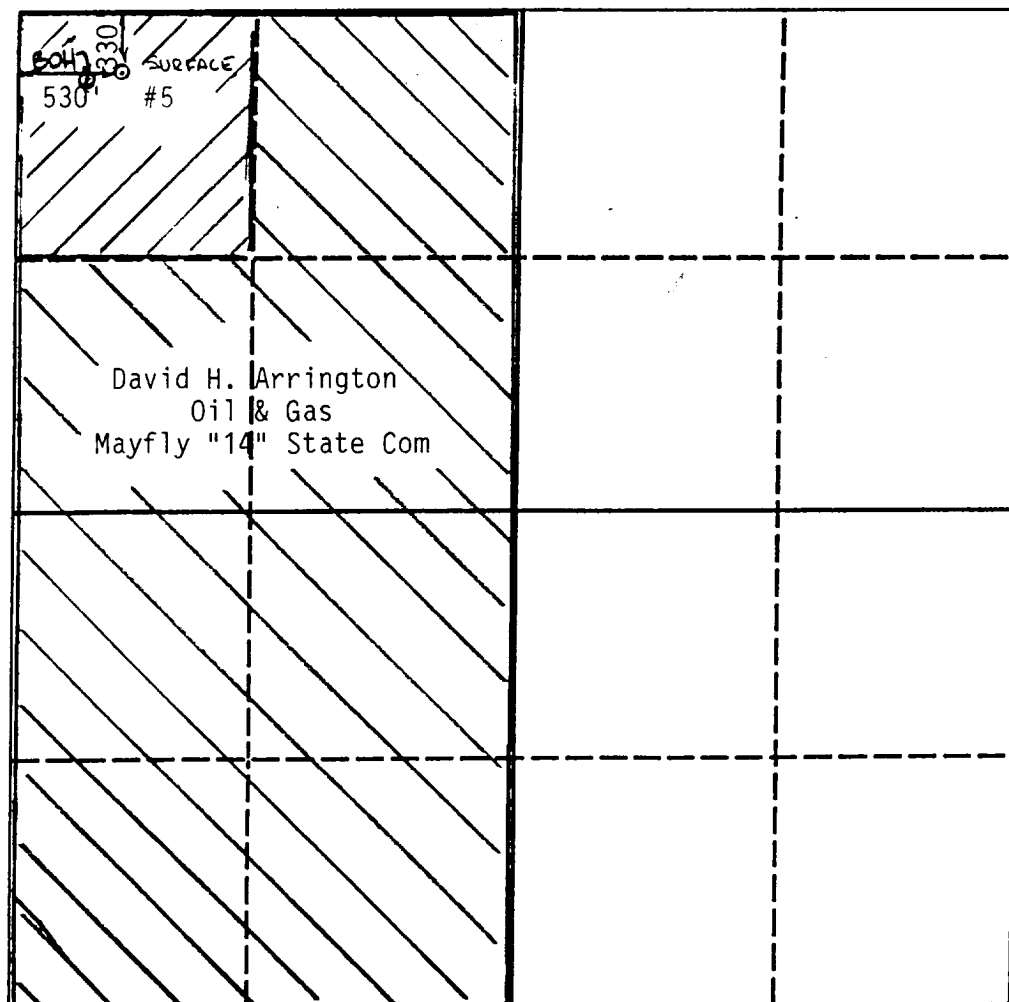

OPERATOR CERTIFICATION

I hereby certify that the information contained herein is true and complete to the best of my knowledge and belief.

Signature

David H. Arrington

Printed Name

President

Position

David H. Arrington Oil & Gas, Inc.

Company

12/21/99

Date

SURVEYOR CERTIFICATION

I hereby certify that the well location shown on this plat was plotted from field notes of actual surveys made by me or under my supervision, and that the same is true and correct to the best of my knowledge and belief.

Date Surveyed

November 8, 1999

Signature & Seal of  
Professional Surveyor

Max A. Schumann, Jr.

Certificate No.

1510

Job No. 65,372

BOTTOM HOLE LOCATION: 350 FT FR NORTH: 350 FT FR WEST LINES

Revised 12/07/99

Added BOH 12/21/99

