

District I
1625 N. French Dr., Hobbs, NM 88240
District II
811 South First, Artesia, NM 88210
District III
1000 Rio Brazos Road, Aztec, NM 87410
District IV
2040 South Pacheco, Santa Fe, NM 87505

State of New Mexico
Energy Minerals and Natural Resources

Oil Conservation Division
2040 South Pacheco
Santa Fe, NM 87505

Form C-101
Revised March 17, 1999

Submit to appropriate District Office
State Lease - 6 Copies
Fee Lease - 5 Copies

☐ AMENDED REPORT

APPLICATION FOR PERMIT TO DRILL, RE-ENTER, DEEPEN, PLUGBACK, OR ADD A ZONE

¹ Operator Name and Address Yates Petroleum Corporation 105 South Fourth Street Artesia, New Mexico 88210		² OGRID Number 025575
³ Property Code 25409	⁴ Property Name BLTN AUY State	⁵ API Number 30-025-34959
		⁶ Well No. 1

⁷ Surface Location

UL or lot no.	Section	Township	Range	Lot 1dn	Feet from the	North/South line	Feet from the	East/West line	County
A	33	16S	35E		660'	North	660'	East	Lea

⁸ Proposed Bottom Hole Location If Different From Surface

UL or lot no.	Section	Township	Range	Lot 1dn	Feet from the	North/South line	Feet from the	East/West line	County

⁹ Proposed Pool 1 Townsend Wildcat Mississippian	¹⁰ Proposed Pool 2
--	-------------------------------

¹¹ Work Type Code N	¹² Well Type Code G	¹³ Cable/Rotary Rotary	¹⁴ Lease Type Code S	¹⁵ Ground Level Elevation 3983'
¹⁶ Multiple No	¹⁷ Proposed Depth 13050'	¹⁸ Formation Mississippian	¹⁹ Contractor Not determined	²⁰ Spud Date ASAP

²¹ Proposed Casing and Cement Program

Hole Size	Casing Size	Casing weight/foot	Setting Depth	Sacks of Cement	Estimated TOC
14 3/4"	11 3/4"	42#	400'	350 sx	circulated
11"	8 5/8"	32#	4950'	1150 sx	circulated
7 7/8"	4 1/2"	11.6#	13050'	700 sx	TOC-9200'

²² Describe the proposed program. If this application is to DEEPEN or PLUG BACK, give the data on the present productive zone and proposed new productive zone.

Describe the blowout prevention program, if any. Use additional sheets if necessary.

Yates Petroleum Corporation proposes to drill and test the Mississippian and intermediate formations. Approximately 400' of surface casing will be set and circulated. Approximately 4950' of intermediate casing will be set and circulated. If commercial production casing will be run and cemented back to approximately 9200', perforated and stimulated as needed for production.

MUD PROGRAM: 0-400' FW gel/paper; 400-4950' FW going to brine; 4950-11800' cut brine w/sweeps; 11800'-TD salt gel/starch/driscap.

BOPE PROGRAM: A 5000# BOPE will be installed on the 8 5/8" casing & tested daily.

²³ I hereby certify that the information given above is true and complete to the best of my knowledge and belief.

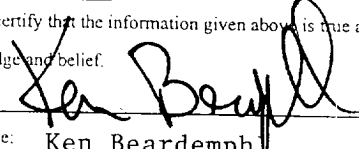
Signature: 

Printed name: Ken Beardemph

Title: Landman

Date: February 24, 2000

Phone: (505) 748-1471

OIL CONSERVATION DIVISION

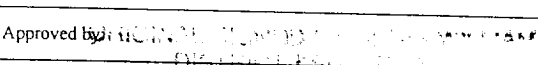
Approved by: 

Title:

Approval Date:

Expiration Date:

Conditions of Approval:

Attached ☐

DISTRICT I
P.O. Box 1980, Hobbs, NM 88240

State of New Mexico
Energy, Minerals and Natural Resources Department

Form C-102
Revised February 10, 1994
Instruction on back
Submit to Appropriate District Office
State Lease - 4 Copies
Fee Lease - 3 Copies

DISTRICT II
P.O. Drawer DD, Artesia, NM 88210

OIL CONSERVATION DIVISION

P.O. Box 2088
Santa Fe, New Mexico 87504-2088

DISTRICT III
1000 Rio Brazos Rd., Artec, NM 87410

☐ AMENDED REPORT

WELL LOCATION AND ACREAGE DEDICATION PLAT

API Number 30-025-34959	Pool Code 86380	Pool Name Townsend Wildcat Mississippian
Property Code 25409	Property Name BLTN "AUY" STATE	Well Number 1
OGED No. 025575	Operator Name YATES PETROLEUM CORPORATION	Elevation 3983

Surface Location

UL or lot No.	Section	Township	Range	Lot Idn	Feet from the	North/South line	Feet from the	East/West line	County
A	33	16S	35E		660	NORTH	660	EAST	LEA

Bottom Hole Location If Different From Surface

UL or lot No.	Section	Township	Range	Lot Idn	Feet from the	North/South line	Feet from the	East/West line	County
Dedicated Acres 320	Joint or Infill	Consolidation Code	Order No.						

NO ALLOWABLE WILL BE ASSIGNED TO THIS COMPLETION UNTIL ALL INTERESTS HAVE BEEN CONSOLIDATED
OR A NON-STANDARD UNIT HAS BEEN APPROVED BY THE DIVISION

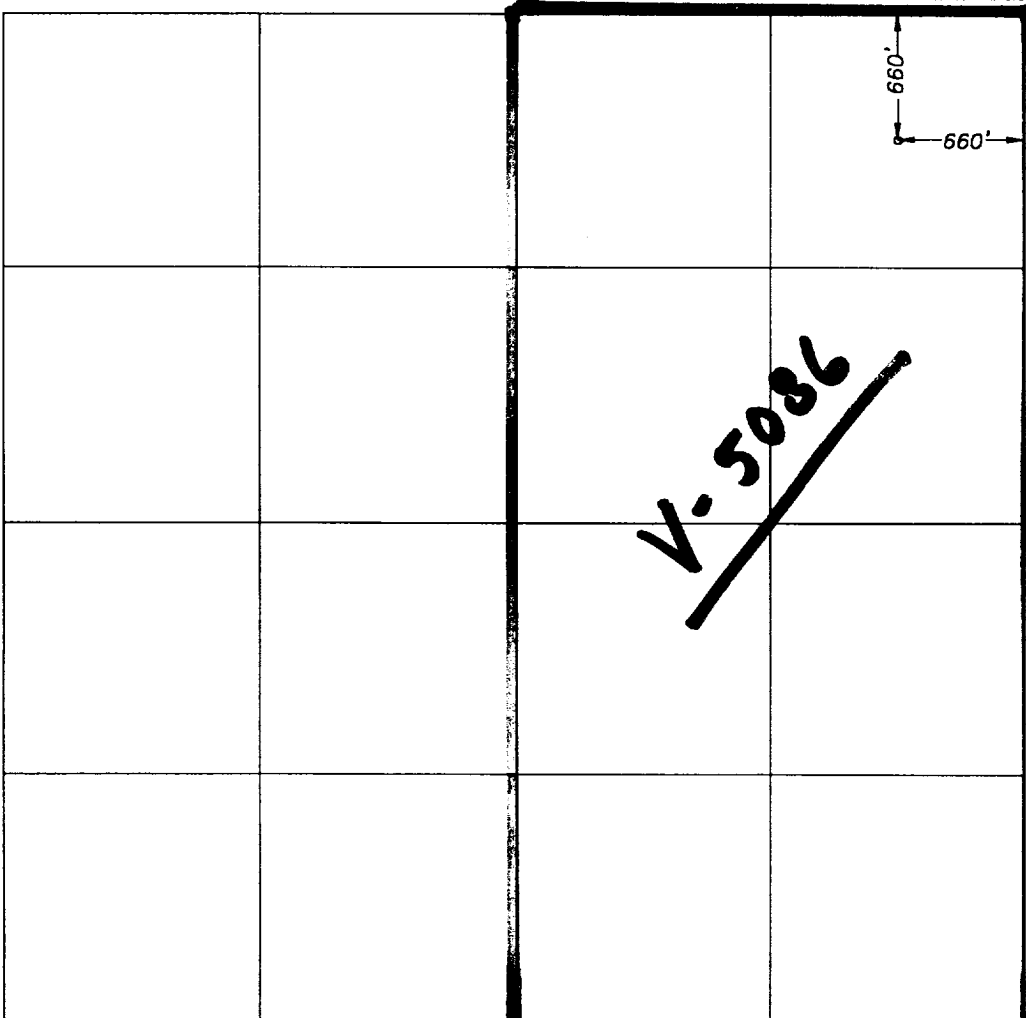
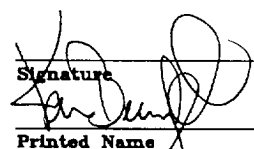
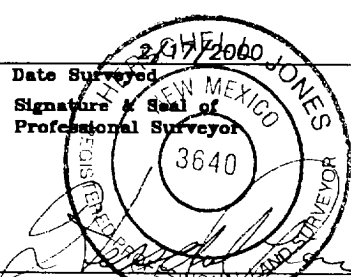
	OPERATOR CERTIFICATION I hereby certify the the information contained herein is true and complete to the best of my knowledge and belief. Signature  Printed Name Ken Beardemphl Title Landman Date February 24, 2000
	SURVEYOR CERTIFICATION I hereby certify that the well location shown on this plat was plotted from field notes of actual surveys made by me or under my supervision, and that the same is true and correct to the best of my belief. Date Surveyed 2/24/2000 Signature & Seal of Professional Surveyor  Certificate No. Herschel L. Jones RLS 3640 BLTN 1 DISK 25 GENERAL SURVEYING COMPANY

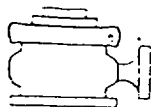

Yates Petroleum Corporation

BOP-4

Typical 5,000 psi Pressure System Schematic Annular with Double Ram Preventer Stack

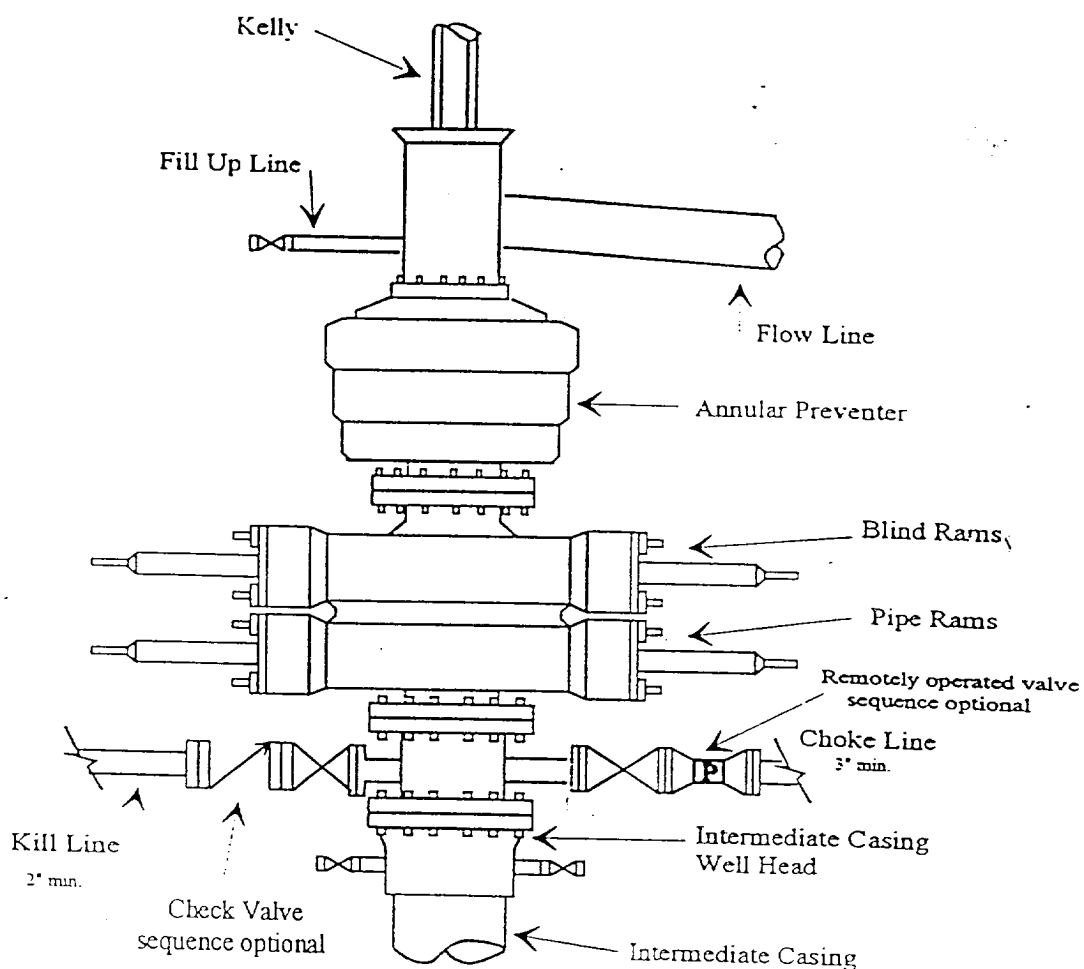

Typical 5,000 psi choke manifold assembly with at least these minimum features

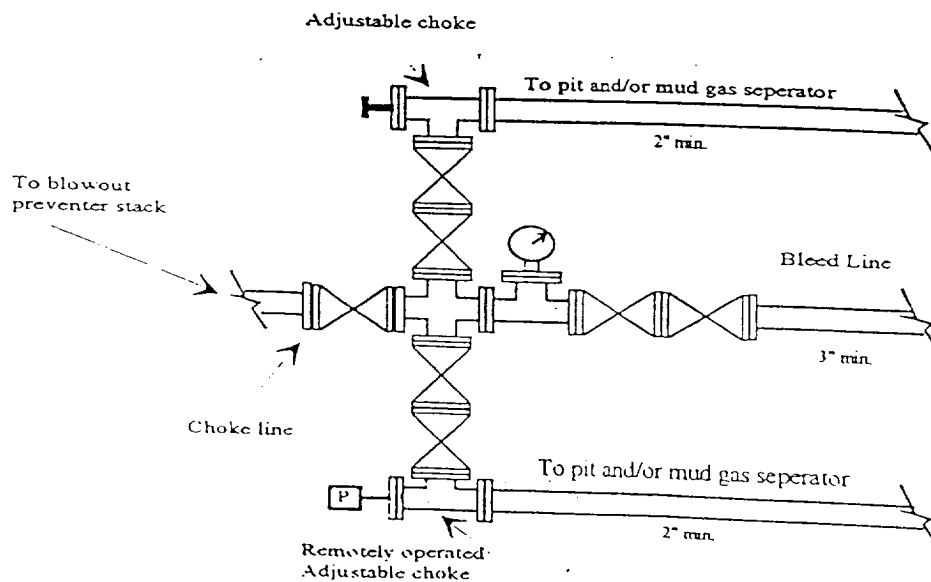

ABOVE DATE DOES NOT
INDICATE WHEN
CONFIDENTIAL LOGS
WILL BE RELEASED

ELF

9/12/01