

SECTION 4, TOWNSHIP 16 SOUTH, RANGE 35 EAST, N.M.P.M.,  
LEA COUNTY, NEW MEXICO.

150' NORTH  
OFF SET □  
4024.0'

Nadel and Gussman Permian, L.L.C  
Top Hat State #1  
ELEV. - 4023'

LAT = N 32°56'45.7"  
LONG = W 103°27'53.8"

150' WEST  
OFF SET □  
4024.4'

150' EAST  
OFF SET □  
4023.2'

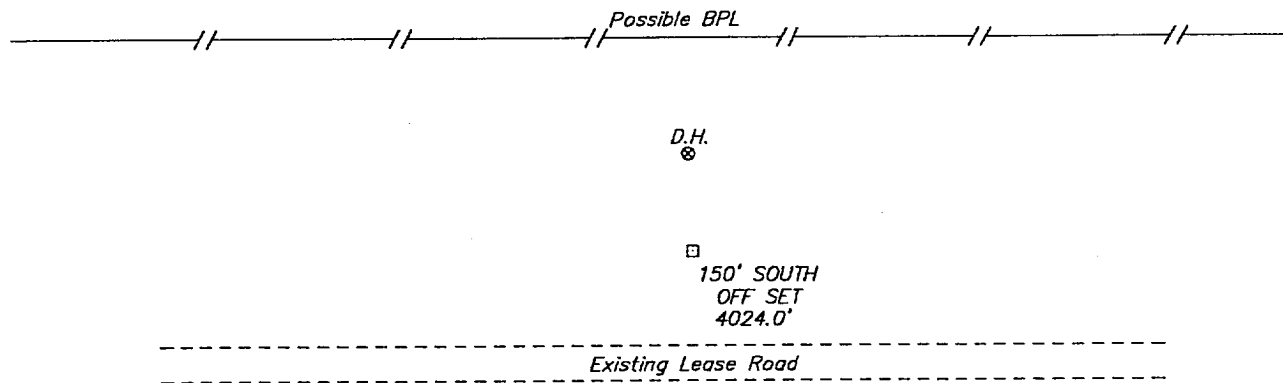

DIRECTIONS TO WELL LOCATION

FROM THE JUNCTION OF US HWY 82 AND STATE  
HWY 8, GO NORTH ON LEASE ROAD APPROX. 400  
FEET TO A LEASE ROAD; THENCE EAST ON LEASE  
ROAD APPROX. 1980 FEET TO A POINT APPROX.  
200 FEET SOUTH OF THE PROPOSED WELL  
LOCATION.

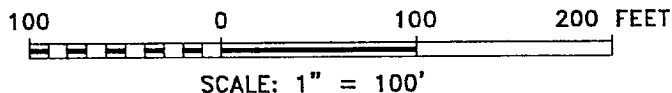

**Nadel and Gussman Permian, L.L.C.**

REF: Top Hat State No. 1 / Well Pad Topo

THE TOP HAT STATE No. 1 LOCATED 760' FROM THE  
SOUTH LINE AND 1980' FROM THE WEST LINE OF  
SECTION 4, TOWNSHIP 16 SOUTH, RANGE 35 EAST,  
N.M.P.M., LEA COUNTY, NEW MEXICO.

**BASIN SURVEYS** P.O. BOX 1786-HOBBS, NEW MEXICO

W.O. Number: 0296

Drawn By: **K. GOAD**

Survey Date: 05-18-2000 Sheet 1 of 1 Sheets