

District I  
PO Box 1980, Hobbs, NM 88241-1980  
District II  
11 S. 1st Street, Artesia, NM 88210-2834  
District III  
1000 Rio Brazos Rd., Aztec, NM 87410  
District IV  
2040 South Pacheco, Santa Fe, NM 87505

State of New Mexico  
Energy, Minerals & Natural Resources Department

OIL CONSERVATION DIVISION  
2040 South Pacheco  
Santa Fe, NM 87505

Form C-101  
Revised October 18, 1994  
Instructions on back  
Submit to Appropriate District Office  
State Lease - 6 Copies  
Fee Lease - 5 Copies

☐ AMENDED REPORT

APPLICATION FOR PERMIT TO DRILL, RE-ENTER, DEEPEN, PLUGBACK, OR ADD A ZONE

<sup>1</sup> Operator name and Address <b>Marathon Oil Company P.O. Box 552 Midland, Tx. 79702</b>		<sup>2</sup> OGRID Number <b>14021</b>
<sup>4</sup> Property Code <b>26882</b>	<sup>5</sup> Property Name <b>Barracuda "9" State</b>	<sup>3</sup> API Number 30-0 <b>25-35248</b>
		<sup>6</sup> Well No. # <b>2</b>

<sup>7</sup> Surface Location

UL or lot no.	Section	Township	Range	Lot. Idn	Feet from the	North/South Line	Feet from the	East/West line	County
<b>"H"</b>	<b>9</b>	<b>17-S</b>	<b>33-E</b>		<b>2209'</b>	<b>North</b>	<b>505'</b>	<b>East</b>	<b>Lea</b>

<sup>8</sup> Proposed Bottom Hole Location If Different From Surface

UL or lot no.	Section	Township	Range	Lot. Idn	Feet from the	North/South Line	Feet from the	East/West line	County
<sup>9</sup> Proposed Pool 1 <b>Wildcat Leamex Wolfcamp North</b>					<sup>10</sup> Proposed Pool 2				

<sup>11</sup> Work Type Code <b>N</b>	<sup>12</sup> Well Type Code <b>O</b>	<sup>13</sup> Cable/Rotary <b>Rotary</b>	<sup>14</sup> Lease Type Code <b>S</b>	<sup>15</sup> Ground Level Elevation <b>4176'</b>
<sup>16</sup> Multiple <b>N</b>	<sup>17</sup> Proposed Depth <b>11,500</b>	<sup>18</sup> Formation <b>Wildcat/ Wolfcamp</b>	<sup>19</sup> Contractor <b>Unknown</b>	<sup>20</sup> Spud Date <b>12-01-00</b>

<sup>21</sup> Proposed Casing and Cement Program

Hole Size	Casing Size	Casing weight/foot	Setting Depth	Sacks of Cement	Estimated TOC
<b>17.5"</b>	<b>13-3/8"</b>	<b>48#</b>	<b>450'</b>	<b>525</b>	<b>Surface</b>
<b>12.25"</b>	<b>9-5/8"</b>	<b>36#</b>	<b>4550</b>	<b>1500</b>	<b>Surface</b>
<b>8.75"</b>	<b>5-1/2"</b>	<b>17#</b>	<b>11,500</b>	<b>1200</b>	<b>3500' F.S.</b>
					<b>D.V. @ 9000'</b>

<sup>22</sup> Describe the proposed program. If this application is to DEEPEN or PLUG BACK give the data on the present productive zone and proposed new productive zone. Describe the blowout prevention program, if any. Use additional sheets if necessary

Propose to drill a 11,500' Wildcat/ Wolfcamp well.

Proposed BOPE: Surface hole 13-5/8" Dual ram annular w/ choke manifold.

All casing shall be run and cemented in accordance w/ OCD Rule # 107.

All BOPE shall be installed and operated in accordance w/ OCD rules 109 and 114.

<sup>23</sup> I hereby certify that the information given above is true and complete to the best of my knowledge and belief.

Signature:

*Jerry Fletcher* 11-08-00

Printed name: **Jerry Fletcher**

Title: **Engineer Tech.**

OIL CONSERVATION DIVISION

Approved by:

*Chris Williams*

Title:

**ASST. DIST. DIRECTOR**

Approval Date:

Expiration Date:

8

DISTRICT I  
P.O. Box 1980, Hobbs, NM 88241-1980

State of New Mexico  
Energy, Minerals and Natural Resources Department

Form C-102  
Revised February 10, 1994  
Submit to Appropriate District Office  
State Lease - 4 Copies  
Fee Lease - 3 Copies

DISTRICT II  
P.O. Drawer 110, Artesia, NM 88211-0719

DISTRICT III  
1000 Rio Brazos Rd., Artesia, NM 87410

OIL CONSERVATION DIVISION

P.O. Box 2088  
Santa Fe, New Mexico 87504-2088

DISTRICT IV  
P.O. Box 2088, Santa Fe, NM 87504-2088

☐ AMENDED REPORT

WELL LOCATION AND ACREAGE DEDICATION PLAT

API Number <b>3D-025-35248</b>	Pool Code <b>97009</b>	Pool Name <b>Wildcat (Leamex Wolfcamp North)</b>
Property Code <b>26882</b>	Property Name <b>BARRACUDA "9" State</b>	Well Number <b>2</b>
OGRID No. <b>14021</b>	Operator Name <b>MARATHON OIL COMPANY</b>	Elevation <b>4176</b>

Surface Location

UL or lot No. <b>H</b>	Section <b>9</b>	Township <b>17 S</b>	Range <b>33 E</b>	Lot Idn	Feet from the <b>2209</b>	North/South line <b>NORTH</b>	Feet from the <b>505</b>	East/West line <b>EAST</b>	County <b>LEA</b>
---------------------------	---------------------	-------------------------	----------------------	---------	------------------------------	----------------------------------	-----------------------------	-------------------------------	----------------------

Bottom Hole Location If Different From Surface

UL or lot No.	Section	Township	Range	Lot Idn	Feet from the	North/South line	Feet from the	East/West line	County
---------------	---------	----------	-------	---------	---------------	------------------	---------------	----------------	--------

Dedicated Acres <b>40-SE/NE</b>	Joint or Infill	Consolidation Code	Order No.
------------------------------------	-----------------	--------------------	-----------

NO ALLOWABLE WILL BE ASSIGNED TO THIS COMPLETION UNTIL ALL INTERESTS HAVE BEEN CONSOLIDATED  
OR A NON-STANDARD UNIT HAS BEEN APPROVED BY THE DIVISION

<p>Barracuda "9" State # 1</p> <p>NAD 27 NME Y=673685 N X=706562 E</p> <p>2209' 505'</p>	<p><b>OPERATOR CERTIFICATION</b></p> <p>I hereby certify the the information contained herein is true and complete to the best of my knowledge and belief.</p> <p><i>Jerry Fletcher</i> Signature</p> <p><b>Jerry Fletcher</b> Printed Name</p> <p><b>11/07/00</b> Title</p> <p><b>Engineer Tech.</b> Date</p> <p><b>SURVEYOR CERTIFICATION</b></p> <p>I hereby certify that the well location shown on this plat was plotted from field notes of actual surveys made by me or under my supervision, and that the same is true and correct to the best of my belief.</p> <p><b>NOVEMBER 2, 2000</b> Date Surveyed</p> <p><b>JLP</b> Signature &amp; Seal of Professional Surveyor</p> <p><i>Ronald J. Eidson</i> W.O. Num. 00-11-1376</p> <p>Certificate No. <b>RONALD J. EIDSON, 3239</b> <b>GARY G. EIDSON, 12641</b></p>
--	---

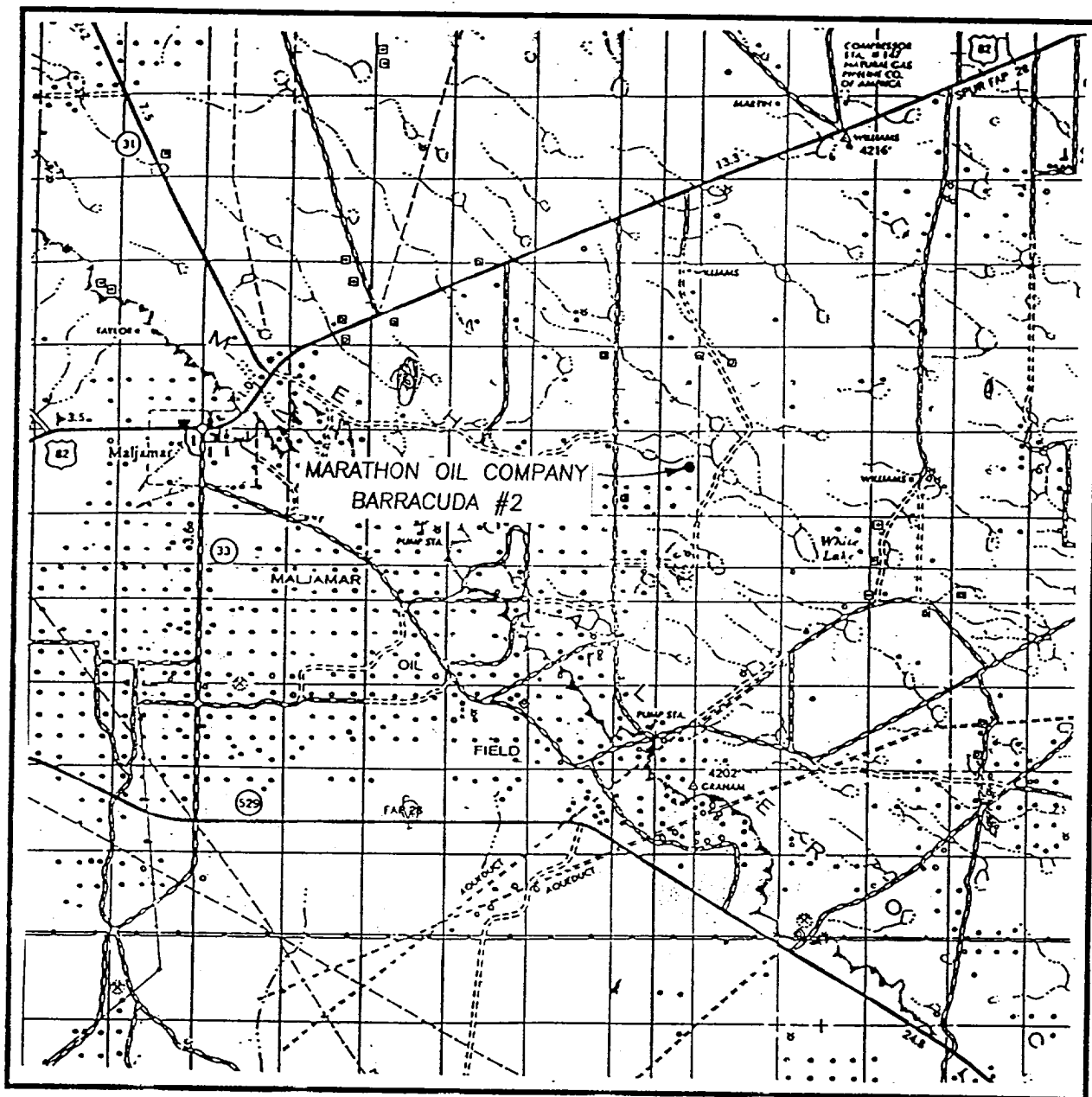

(505) 393-3117

# LOCATION VERIFICATION MAP

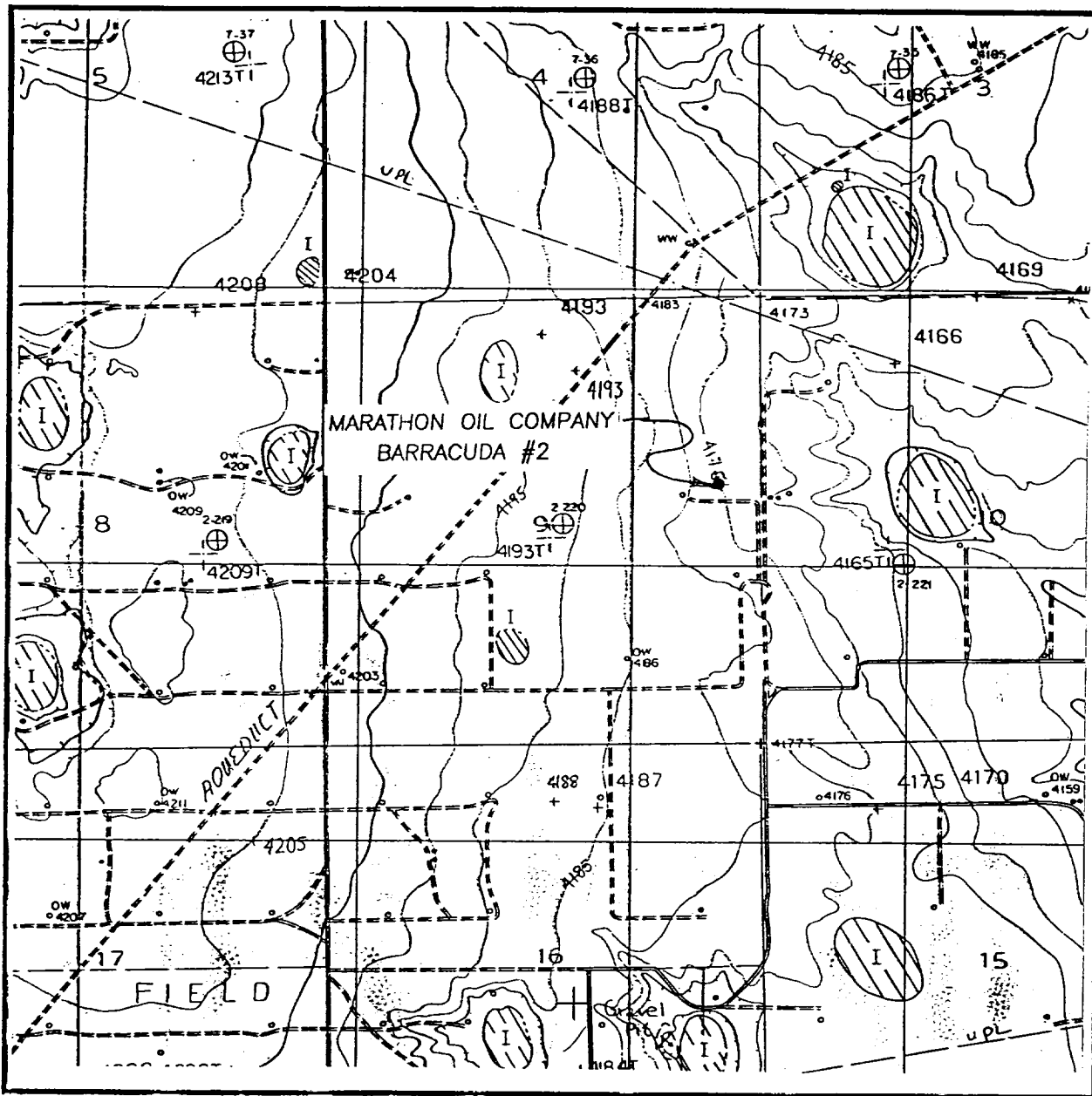

SCALE: 1" = 2000'

CONTOUR INTERVAL - 10'

SEC. 9 TWP. 17-S RGE. 33-E

SURVEY N.M.P.M.

COUNTY LEA

DESCRIPTION 2209' FNL & 505' FEL

ELEVATION 4176

OPERATOR MARATHON OIL COMPANY

LEASE BARRACUDA

U.S.G.S. TOPOGRAPHIC MAP

HOG LAKE, N.M.

**JOHN WEST SURVEYING**  
**HOBBS, NEW MEXICO**

**(505) 393-3117**

