

District I
1625 N. French Dr., Hobbs, NM 88240
District II
811 S. 1st Street, Artesia, NM 88210
District III
1000 Rio Brazos Rd., Aztec, NM 87410
District IV
2040 South Pacheco, Santa Fe, NM 87505

State of New Mexico
Energy, Minerals & Natural Resources

Form C-101
Revised March 17, 1999

Oil Conservation Division
2040 South Pacheco
Santa Fe, NM 87505

Submit to appropriate District Office
State Lease - 6 Copies
Fee Lease - 5 Copies

☐ AMENDED REPORT

APPLICATION FOR PERMIT TO DRILL, RE-ENTER, DEEPEN, PLUGBACK, OR ADD A ZONE

¹ Operator Name and Address Energen Resources Corporation 3300 N. "A" St., Bldg 4, Ste. 100, Midland, TX 79705		² OGRID Number 162928
		³ API Number 30-025-38084
⁴ Property Code 29529	⁵ Property Name State "T"	⁶ Well No. 4

⁷ Surface Location

UL or lot no.	Section	Township	Range	Lot. Idn	Feet from the	North/South Line	Feet from the	East/West line	County
J	5	15-S	33-E		1800'	South	1650'	East	Lea

⁸ Proposed Bottom Hole Location If Different From Surface

UL or lot no.	Section	Township	Range	Lot. Idn	Feet from the	North/South Line	Feet from the	East/West line	County

⁹ Proposed Pool 1 Saunders, San Andres (96196)	¹⁰ Proposed Pool 2
--	-------------------------------

¹¹ Work Type Code N	¹² Well Type Code O	¹³ Cable/Rotary R	¹⁴ Lease Type Code S	¹⁵ Ground Level Elevation 4221'
¹⁶ Multiple No	¹⁷ Proposed Depth 5,200'	¹⁸ Formation San Andres	¹⁹ Contractor TBD	²⁰ Spud Date ASAP

²¹ Proposed Casing and Cement Program

Hole Size	Casing Size	Casing weight/foot	Setting Depth	Sacks of Cement	Estimated TOC
11'	8 5/8"	24.00#	400'	200	Circulate
7 7/8"	5 1/2"	15.50#	5,200'	600	Circulate

²² Describe the proposed program. If this application is to DEEPEN or PLUG BACK, give the data on the present productive zone and proposed new productive zone. Describe the blowout prevention program, if any. Use additional sheets if necessary.

Energen Resources Corporation proposes to drill and test the San Andres Formation as follows:
Drill a 11" hole to approximately 400', run 8 5/8" casing and cement back to surface. Nipple-up a 9" X 3M# hydraulic double ram BOP w/ a 2" x 3M# choke manifold. Install H2S monitoring equipment and train all rig personnel. Drill a 7 7/8" hole to approximately 5,200", run 5 1/2" casing and cement back to the surface if the samples and logs are positive, or P&A in accordance w/the NMOCD's requirements. If production casing is ran, plan to perforate & acidize the San Andres formation as necessary and place the well on production.

²³ I hereby certify that the information given above is true and complete to the best of my knowledge and belief. Signature: <i>Sharon Hindman</i>		OIL CONSERVATION DIVISION PAUL F. KAUTZ PETROLEUM ENGINEER	
Printed name: Sharon Hindman		Title:	
Title: Regulatory Analyst		Approval Date: DEC 20 2002	Expiration Date:
Date: 12/18/2002	Phone: 915 684-3693	Conditions of Approval: Attached <input type="checkbox"/>	

Permit Expires 1 Year From Approval
Date Unless Drilling Underway

DISTRICT I
1625 N. French Dr., Hobbs, NM 88240

DISTRICT II
1301 W. Grand Avenue, Artesia, NM 88210

DISTRICT III
1000 Rio Brazos Rd., Aztec, NM 87410

DISTRICT IV
1220 S. St. Francis Dr., Santa Fe, NM 87505

State of New Mexico

Energy, Minerals, and Natural Resources Department

OIL CONSERVATION DIVISION

1220 South St. Francis Dr.

Santa Fe, New Mexico 87505

Form C-102

Revised August 15, 2000

Submit to Appropriate District Office

State Lease - 4 copies

Fee Lease - 3 copies

☐ AMENDED REPORT

WELL LOCATION AND ACREAGE DEDICATION PLAT

¹ API Number 30-025-3684		² Pool Code 96196		³ Pool Name Saunders, San Andres	
⁴ Property Code 29529		⁵ Property Name STATE "T"			⁶ Well Number 4
⁷ OGRID No. 162928		⁸ Operator Name ENERGEN RESOURCES CORPORATION			⁹ Elevation 4221'

¹⁰ Surface Location

UL or lot no. J	Section 5	Township 15 SOUTH	Range 33 EAST, N.M.P.M.	Lot Idn	Feet from the 1800'	North/South line SOUTH	Feet from the 1650'	East/West line EAST	County LEA
--------------------	--------------	----------------------	----------------------------	---------	------------------------	---------------------------	------------------------	------------------------	---------------

¹¹ Bottom Hole Location If Different From Surface

UL or lot no.	Section	Township	Range	Lot Idn	Feet from the	North/South line	Feet from the	East/West line	County
¹² Dedicated Acres 40		¹³ Joint or Infill		¹⁴ Consolidation Code		¹⁵ Order No.			

NO ALLOWABLE WELL BE ASSIGNED TO THIS COMPLETION UNTIL ALL INTERESTS HAVE BEEN CONSOLIDATED OR A
NON-STANDARD UNIT HAS BEEN APPROVED BY THE DIVISION

¹⁶ 	<p>¹⁷ OPERATOR CERTIFICATION</p> <p>I hereby certify that the information contained herein is true and complete to the best of my knowledge and belief.</p> <p><i>Sharon Hindman</i> Signature</p> <p>Sharon Hindman Printed Name</p> <p>Regulatory Analyst Title</p> <p>12/18/2002 Date</p>
	<p>¹⁸ SURVEYOR CERTIFICATION</p> <p>I hereby certify that the well location shown on this plat was plotted from field notes of actual surveys made by me or under my supervision, and that the same is true and correct to the best of my belief.</p> <p>DECEMBER 9, 2002 Date of Survey</p> <p><i>V. L. Beznar</i> Signature and Seal of Professional Surveyor</p> <p>12-12-02</p> <p>Certificate Number V. L. BEZNER R.P.S. #7920</p> <p>JOB #84994 / 122SE / J.C.P.</p>

ENERGEN

RESOURCES

ENERGEN RESOURCES CORPORATION

STATE "T" #4

BOP DIAGRAM

3,000# MWP BOP & CHOKE MANIFOLD

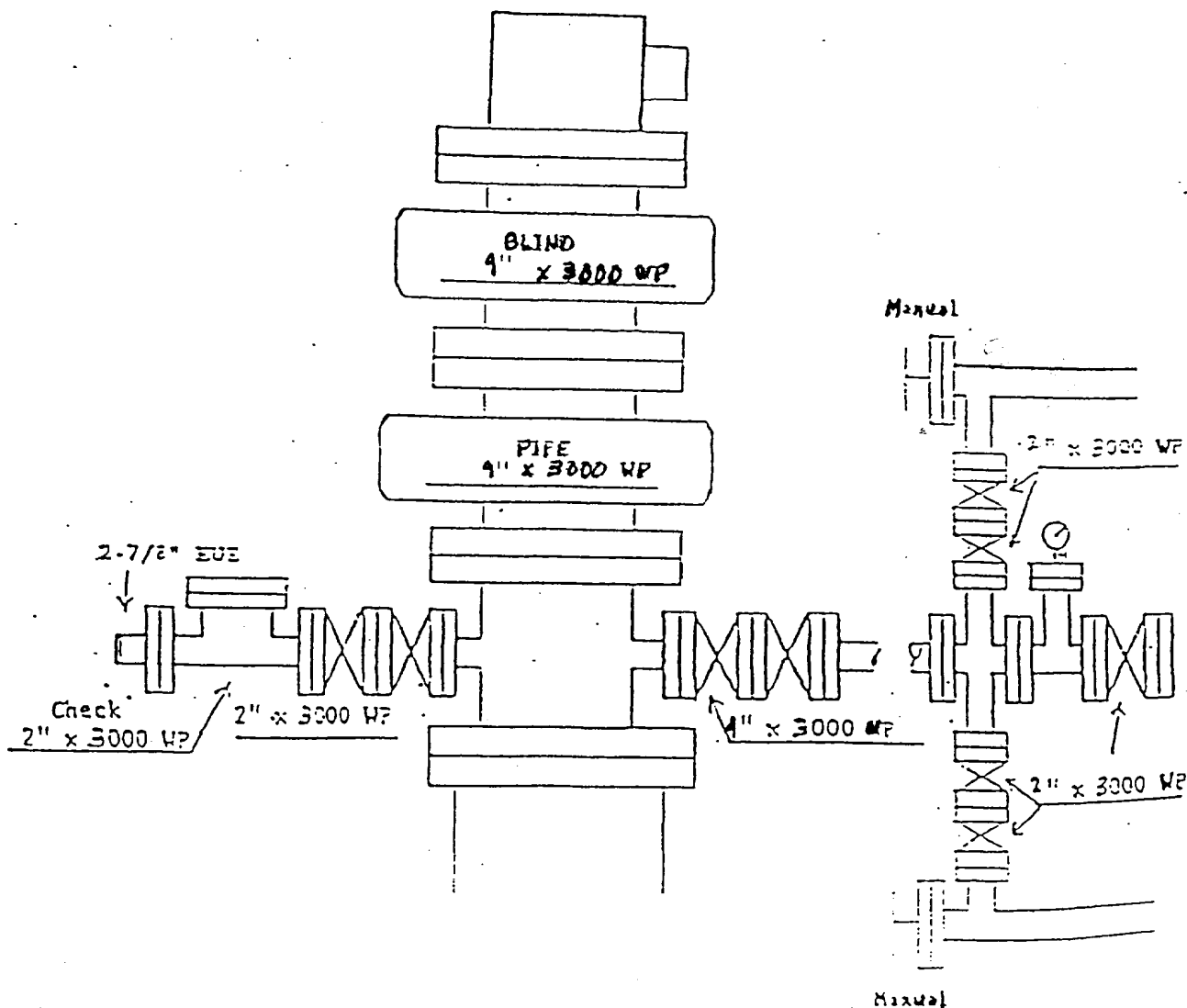

LOCATION & ELEVATION VERIFICATION MAP

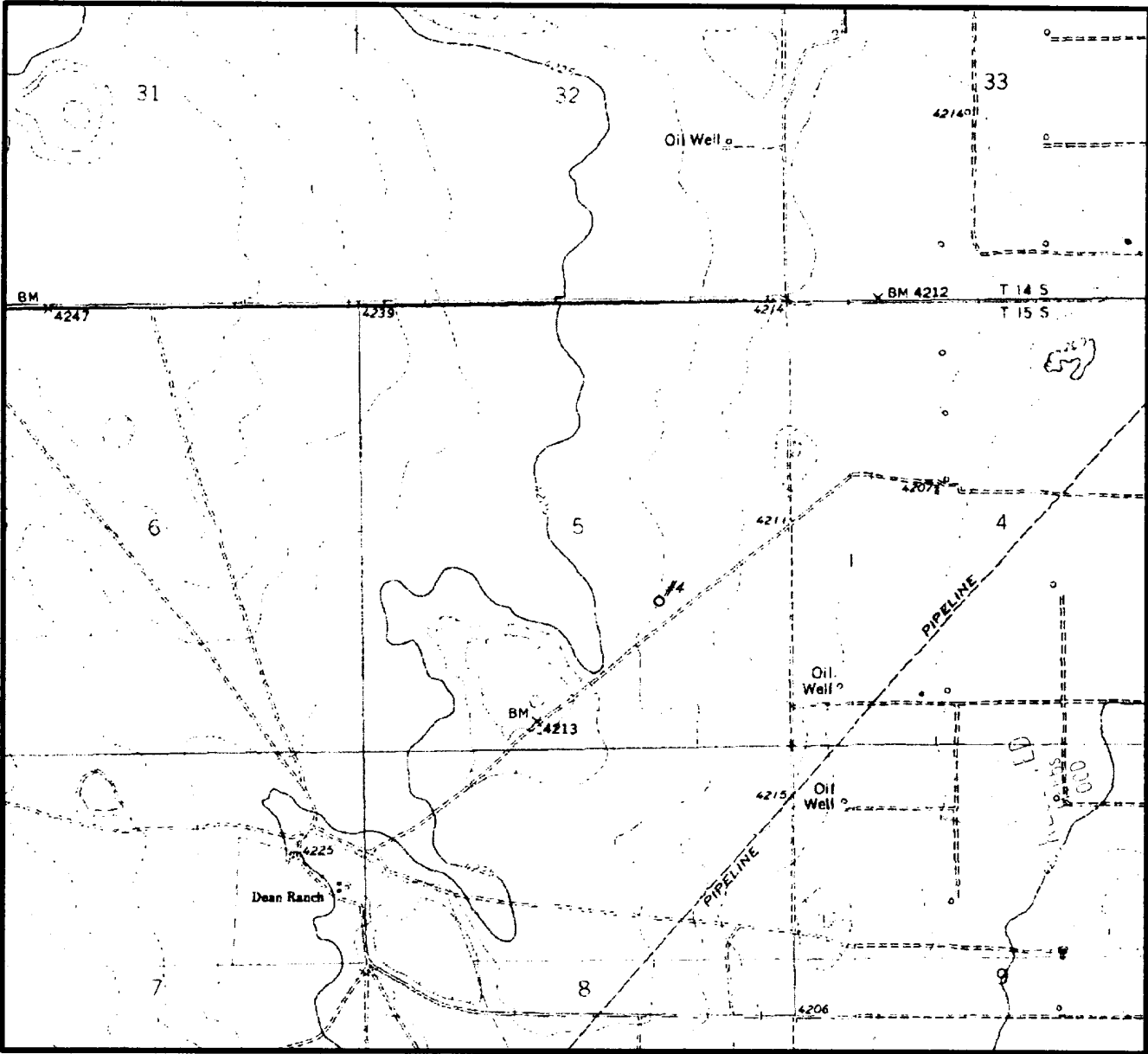

SCALE : 1" = 2000' CONTOUR INTERVAL 5 FEET

SECTION 5 TWP T-15-S RGE R-33-E
SURVEY NEW MEXICO PRINCIPAL MERIDIAN
COUNTY LEA STATE NM
DESCRIPTION 1800' FSL & 1650' FEL
ELEVATION 4221'
OPERATOR ENERGEN RESOURCES CORPORATION
LEASE STATE "T" #4
U.S.G.S. TOPOGRAPHIC MAP
DEAN RANCH, NEW MEXICO
LAT. 33°02'36"
LONG. 103°37'59"

This location has been very carefully staked on the ground according to the best official survey records, maps, and other data available to us.
Review this plat and notify us immediately of any possible discrepancy.

TOPOGRAPHIC LAND SURVEYORS

Surveying & Mapping for the Oil & Gas Industry

1307 N. HOBART
PAMPA, TX. 79065
(800) 658-6382

6709 N. CLASSEN BLVD.
OKLAHOMA CITY, OK. 73116
(800) 654-3219

2903 N. BIG SPRING
MIDLAND, TX. 79705
(800) 767-1653

VICINITY MAP

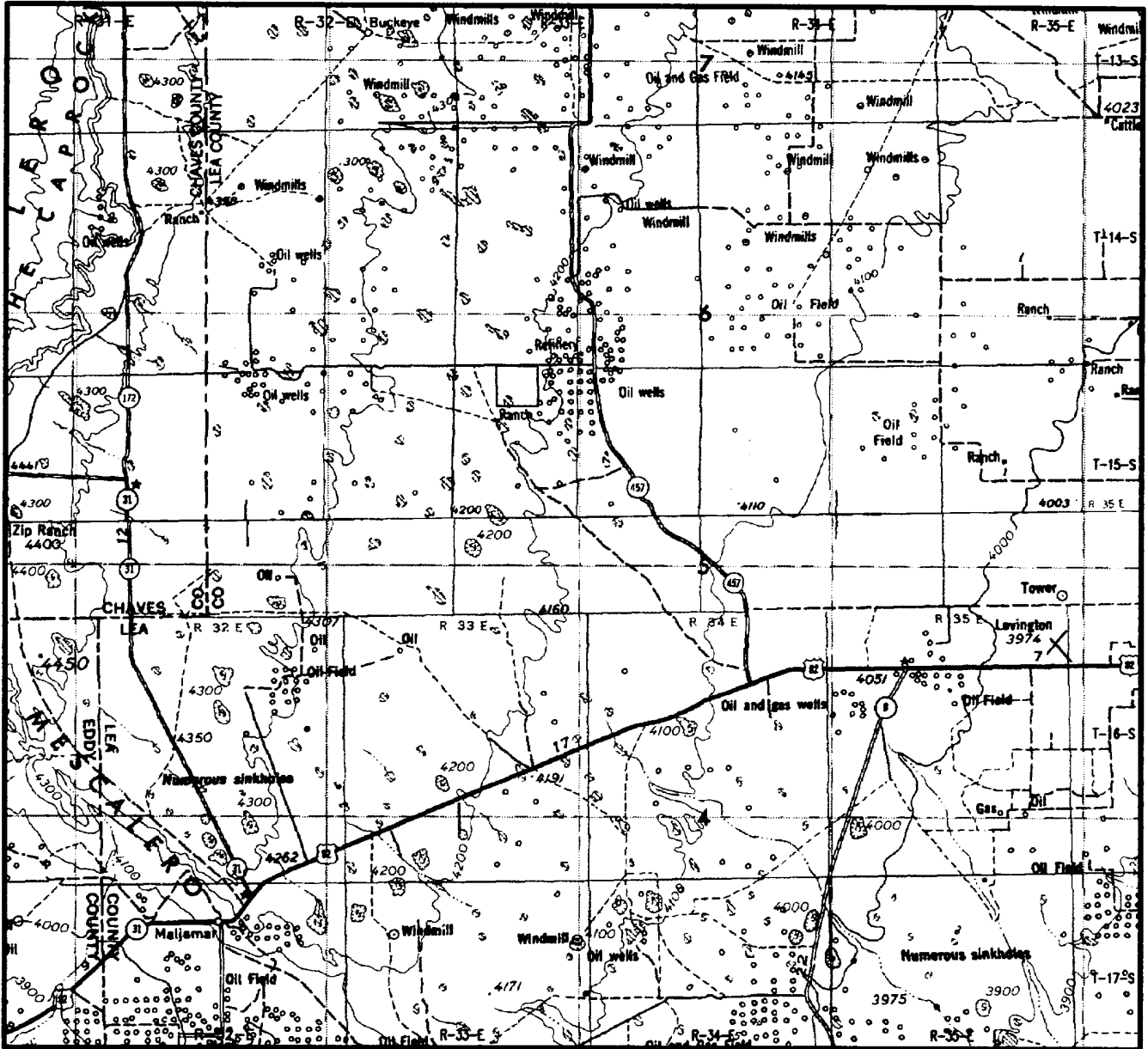

SECTION 5 TWP T-15-S RGE R-33-E
 SURVEY NEW MEXICO PRINCIPAL MERIDIAN
 COUNTY LEA STATE NM
 DESCRIPTION 1800' FSL & 1650' FWL

OPERATOR ENERGEN RESOURCES CORPORATION
 LEASE STATE "T" #4

DISTANCE & DIRECTION FROM JCT. OF U.S. 82 & S.H.
457 ±11.0 MILES WEST OF LOVINGTON, GO NORTH 8.5
MILES ON S.H. 457, THENCE WEST 0.7 MILE ON LEASE
ROAD, THENCE SOUTH 0.2 MILE ON LEASE RD., THENCE
WEST 0.8 MILE ON LEASE ROAD, THENCE NORTH 0.4 MILE
TO POINT ±100' NORTH OF THE LOCATION.

This location has been very carefully staked on the ground according to the best official survey records, maps, and other data available to us.
 Review this plat and notify us immediately of any possible discrepancy.

TOPOGRAPHIC LAND SURVEYORS
Surveying & Mapping for the Oil & Gas Industry

1307 N. HOBART
 PAMPA, TX. 79065
 (800) 658-6382

6709 N. CLASSEN BLVD.
 OKLAHOMA CITY, OK. 73116
 (800) 654-3219

2903 N. BIG SPRING
 MIDLAND, TX. 79705
 (800) 767-1653