

NEW MEXICO OIL CONSERVATION COMMISSION

Santa Fe, New Mexico

NOTICE OF INTENTION TO DRILL

Notice must be given to the Oil Conservation Commission or its proper agent and approval obtained before drilling begins. If changes in the proposed plan are considered advisable, a copy of this notice showing such changes will be returned to the sender. Submit this notice in triplicate. One copy will be returned following approval. See additional instructions in Rules and Regulations of the Commission.

Bartlesville, Oklahoma

OIL CONSERVATION COMMISSION,
Santa Fe, New Mexico,

Gentlemen:

You are hereby notified that it is our intention to commence the drilling of a well to be known as
Phillips Petroleum Company **Denton** Well No. **3** in **NW/4**

Company or Operator
of Sec. **11**, T. **15S**, R. **37E** N. M. P. M., Lease **Denton** Field, **Lea** County.

The well is **659** feet (W.) (S.) of the **north** line and **1987** feet (E.) (W.) of the **west** line of **NW/4 Section 11**

(Give location from section or other legal subdivision lines. Cross out wrong directions.)

If state land the oil and gas lease is No. _____ Assignment No. _____

If patented land the owner is **James M. Denton**

Address **Brownfield, Texas**

If government land the permittee is _____

Address _____

The lessee is **Phillips Petroleum Company** **J. H. McClure (Assigner)**
Bartlesville, Oklahoma **Midland, Texas**

Address _____

AREA 640 ACRES

LOCATE WELL CORRECTLY
to depth sufficient to test the Devonian.

We propose to drill well with drilling equipment as follows: **Drill with rotary**

The status of a bond for this well in conformance with Rule 39 of the General Rules and Regulations of the Commission is as follows: **Blanket Bond**

We propose to use the following strings of casing and to land or cement them as indicated:

Size of Hole	Size of Casing	Weight Per Foot	New or Second Hand	Depth	Landed or Cemented	Sacks Cement
17-1/4	19-3/8	27.5#	new	300	cemented	circulate
11	8-5/8	28 & 32#	new	4800	cemented	circulate
7-7/8	5-1/2	17 & 20#	new	11500	cemented	sufficient cement to tie in base of 8-5/8"

If changes in the above plan become advisable we will notify you before cementing or landing casing. We estimate that the first productive oil or gas sand should occur at a depth of about **11500** feet.

Additional information:

Approved **MAR 21 1951**, 19____
except as follows:

Sincerely yours,

Phillips Petroleum Company

Company or Operator

By **R. D. Pulifer**Position **Asst. Chief Clerk**

Send communications regarding well to

Name **Mr. C. P. Dimit - Vice-President**Address **Bartlesville, Oklahoma**

OIL CONSERVATION COMMISSION,

By **Roy Yunker**Title **Oil & Gas Inspector**

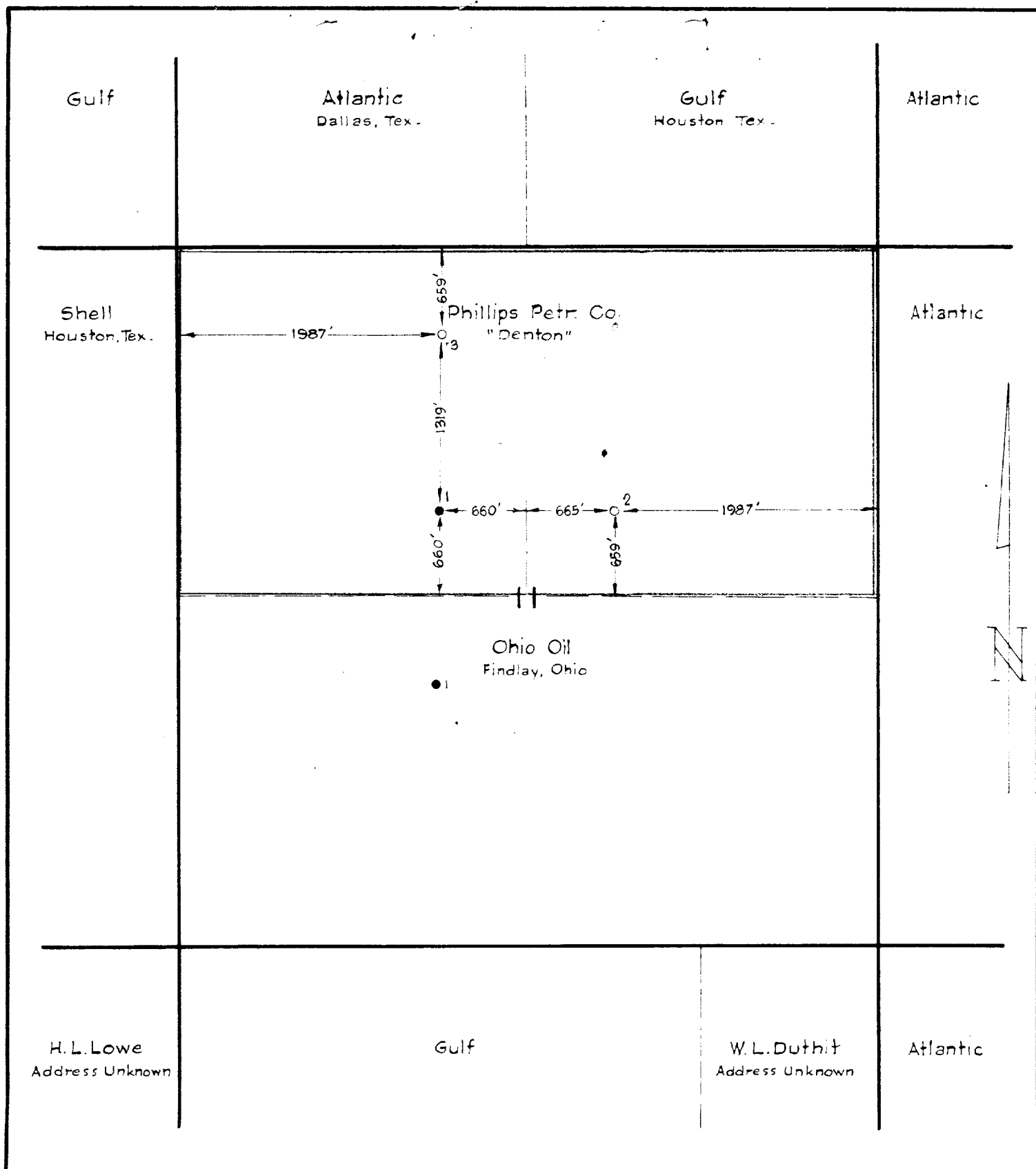

PHILLIPS PETROLEUM CO.

BARTLESVILLE, OKLA.

DENTON LEASE-320.0 ACRES
N. $\frac{1}{2}$ OF SEC. II, TWP. 15 S. R. 37 E.
LEA CO. NEW MEXICO

DRAWN BY: R.E.V.

8-28-50

SCALE 1"=1000'

CONTRACT NO.

DRAWING NO.