

**NEW MEXICO OIL CONSERVATION COMMISSION
WELL LOCATION AND ACREAGE DEDICATION PLAT**

Form O-102
Supersedes O-128
Effective 1-1-65

All distances must be from the outer boundaries of the Section.

Operator TREBOL DRILLING COMPANY			Lease LUSK DEEP UNIT		Well No. 2
Unit Letter 0	Section 18	Township 19S	Range 32E	County LEA	
Actual Location of Well: 660 feet from the SOUTH line of 1980 East					
Ground Level Elev. 3585'	Producing Formation MORROW	Designation UNDESIGNATED		Indicated Acreage 361.63 Acres	

1. Outline the acreage dedicated to the subject well by colored pencil or hatchure marks on the plat below.
2. If more than one lease is dedicated to the well, outline each and identify the ownership thereof (both as to working interest and royalty).
3. If more than one lease of different ownership is dedicated to the well, have the interests of all owners been consolidated by communitization, unitization, forced-pooling, etc?

☒ Yes ☐ No If answer is "yes," type of consolidation UNIT AGREEMENT

If answer is "no," list the owners and tract descriptions which have actually been consolidated. (Use reverse side of this form if necessary.) _____

No allowable will be assigned to the well until all interests have been consolidated (by communitization, unitization, forced-pooling, or otherwise) or until a non-standard unit, eliminating such interests, has been approved by the Commission.

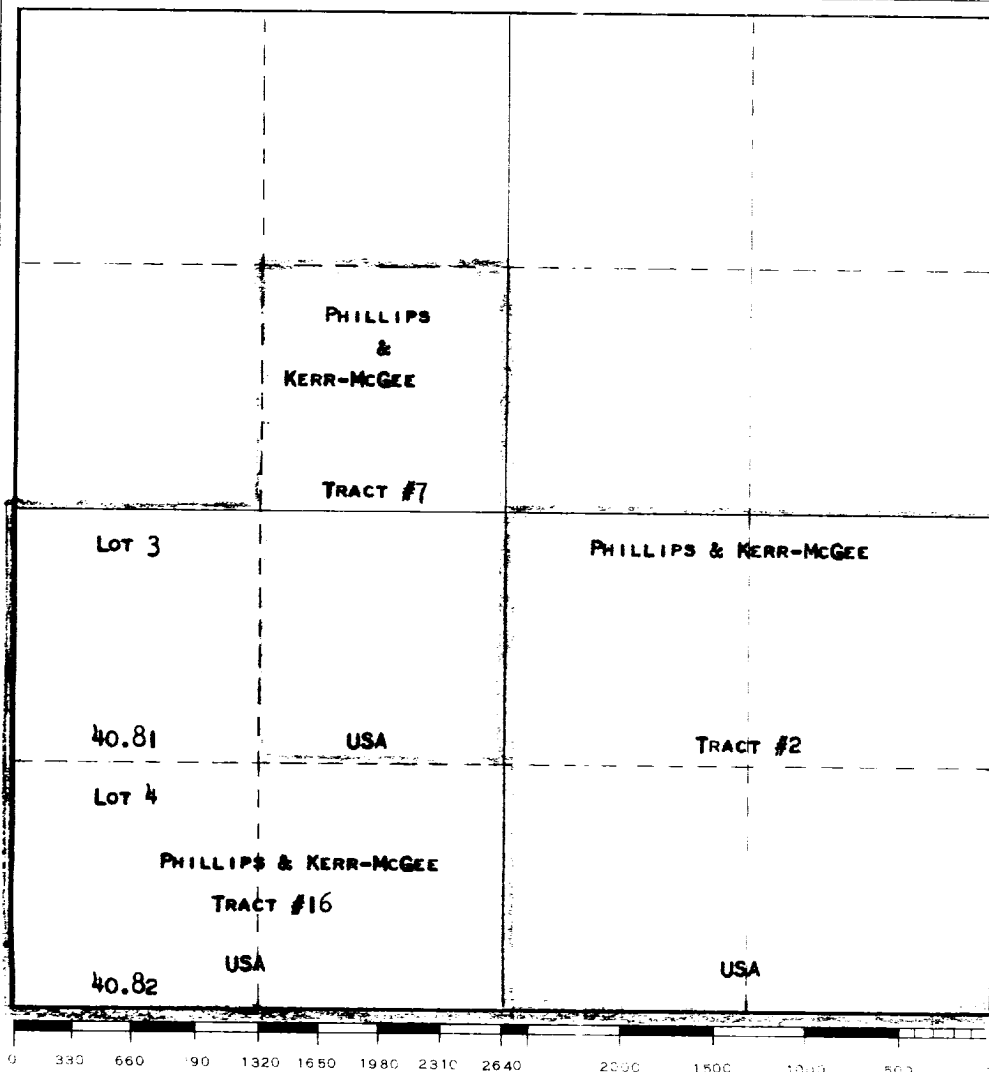

CERTIFICATION

I hereby certify that the information contained herein is true and complete to the best of my knowledge and belief.

Roland L. Hamblin

Name
ROLAND L. HAMBLIN

Position
MANAGER-LAND DEPARTMENT

Company
TREBOL DRILLING COMPANY

Date
AUGUST 29, 1966

I hereby certify that the well location shown on this plat was plotted from field notes of actual surveys made by me or under my supervision, and that the same is true and correct to the best of my knowledge and belief.

Date Surveyed _____

Registered Professional Engineer and/or Land Surveyor

Certified _____

NEW MEXICO OIL CONSERVATION COMMISSION
Well Location and Acreage Dedication Plat

Section A.

Date June 15, 1962

Operator El Paso Natural Gas Company Lease Lusk Deep Unit Q2
Well No. 2 Unit Letter Q Section 13 Township 19-S Range 32-E N.M.P.M.
Located 660 Feet From South Line, 1960 Feet From East Line
County Lea G. L. Elevation 3585' Dedicated Acreage 160 Acres
Name of Producing Formation Strawn Pool Lusk Strawn

1. Is the Operator the only owner* in the dedicated acreage outlined on the plat below?
Yes _____ No X.
2. If the answer to question one is 'no,' have the interests of all the owners been consolidated by communitization agreement or otherwise? Yes X No _____. If answer is "yes," Type of Consolidation Unit Agreement.
3. If the answer to question two is 'no,' list all the owners and their respective interests below:

Owner

Land Description

Section B

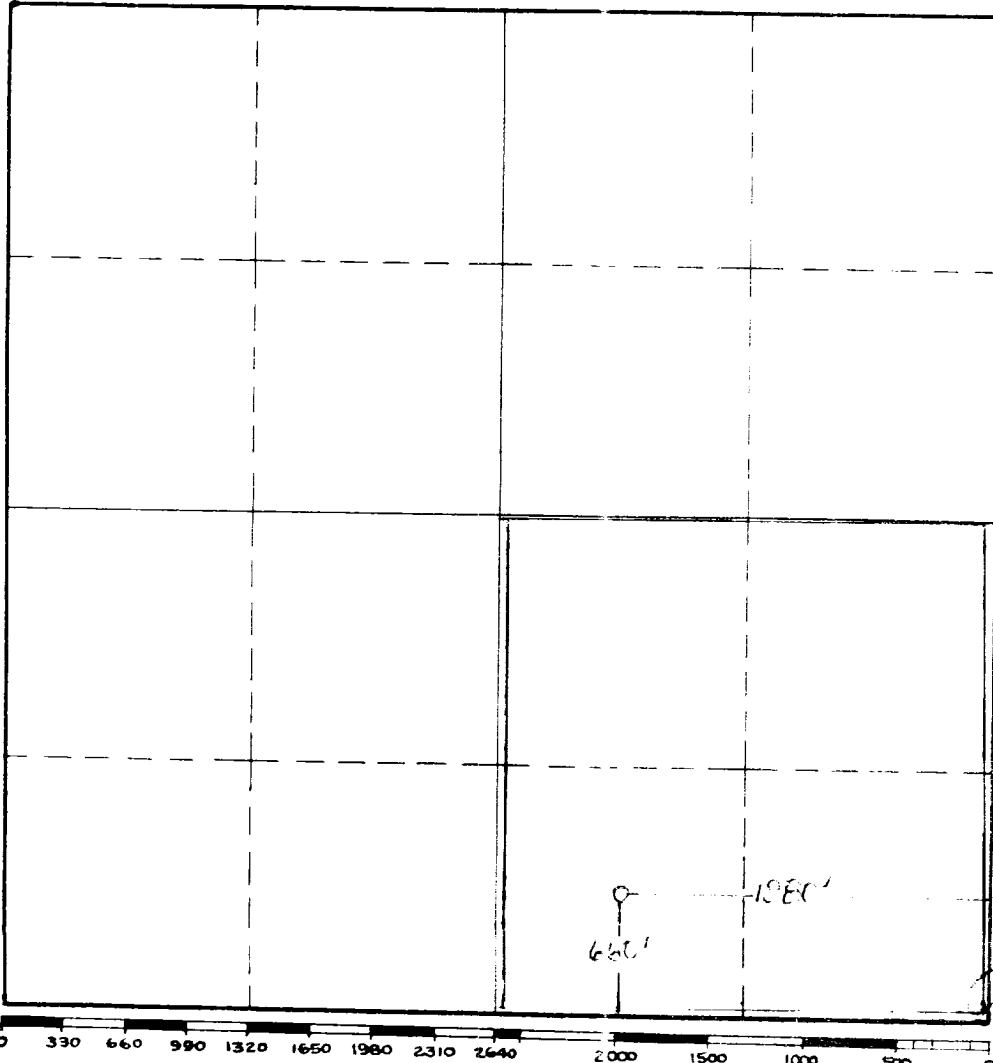

This is to certify that the information in Section A above is true and complete to the best of my knowledge and belief.

El Paso Natural Gas Company

(Operator).

John A. Disch
(Representative)

Box 1384 - Jal, New Mexico

Address

This is to certify that the well location shown on the plat in Section B was plotted from field notes of actual surveys made by me or under my supervision and that the same is true and correct to the best of my knowledge and belief.

Date Surveyed 2-3-66

James B. Allen
Registered Professional
Engineer and/or Land Surveyor.

Certificate No. 3067

INSTRUCTIONS FOR COMPLETION:

1. Operator shall furnish and certify to the information called for in Section A.
2. Operator shall outline the dedicated acreage for both oil and gas wells on the plat in Section B.
3. A registered professional engineer or land surveyor registered in the State of New Mexico or approved by the Commission shall show on the plat the location of the well and certify this information in the space provided.
4. All distances shown on the plat must be from the outer boundaries of Section.
5. If additional space is needed for listing owners and their respective interests as required in question 3, Section A, please use space below

* "Owner" means the person who has the right to drill into and to produce from any pool and to appropriate the production either for himself or for himself and another. (65-3-29 (e) NMSA 1953 Comp.)