

(SUBMIT IN TRIPLICATE)

UNITED STATES  
DEPARTMENT OF THE INTERIOR  
GEOLOGICAL SURVEY

Land Office \_\_\_\_\_  
Lease No. **LC 060 967**  
Unit **Phillips Pet. Corp.**

**SUNDRY NOTICES AND REPORTS ON WELLS**

|   |                                     |   |
|---|-------------------------------------|---|
| NOTICE OF INTENTION TO DRILL.....                   | <input checked="" type="checkbox"/> | SUBSEQUENT REPORT OF WATER SHUT-OFF.....        |
| NOTICE OF INTENTION TO CHANGE PLANS.....            |                                     | SUBSEQUENT REPORT OF SHOOTING OR ACIDIZING..... |
| NOTICE OF INTENTION TO TEST WATER SHUT-OFF.....     |                                     | SUBSEQUENT REPORT OF ALTERING CASING.....       |
| NOTICE OF INTENTION TO RE-DRILL OR REPAIR WELL..... |                                     | SUBSEQUENT REPORT OF RE-DRILLING OR REPAIR..... |
| NOTICE OF INTENTION TO SHOOT OR ACIDIZE.....        |                                     | SUBSEQUENT REPORT OF ABANDONMENT.....           |
| NOTICE OF INTENTION TO PULL OR ALTER CASING.....    |                                     | SUPPLEMENTARY WELL HISTORY.....                 |
| NOTICE OF INTENTION TO ABANDON WELL.....            |                                     |   |

(INDICATE ABOVE BY CHECK MARK NATURE OF REPORT, NOTICE, OR OTHER DATA)

**Phillips-Federal**

**December 11**, 19**57**

Well No. **2-X** is located **330** ft. from **[N]** line and **1650** ft. from **[E]** line of sec. **33**

**NE 1/4 of NE 1/4 Sec 33** (Sec. and Sec. No.) **17a8** (Twp.) **33-E** (Range) **T. 17 N. R. 33 E.** (Meridian)  
**Midland** (Field) **Lea** (County or Subdivision) **New Mexico** (State or Territory)

The elevation of the derrick floor above sea level is **4182** ft.

**DETAILS OF WORK**

(State names of and expected depths to objective sands; show sizes, weights, and lengths of proposed casings; indicate mudding jobs, cementing points, and all other important proposed work)

**Grayburg top @ approximately 4100' TD - 4500'**

Surface String - 8 5/8" 24# Set @ 350' cemented w/ 150 sac  
Oil String - 3 1/2" 15.5# Set @ 4500' cemented to top salt.  
Mud Program - Clear water to 4000', 2 cc water loss salt water starch  
mud to T.D. prepare to perforate for production in Grayburg Formation.

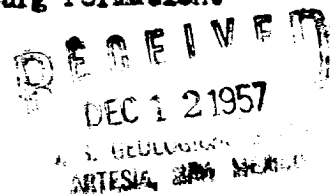

I understand that this plan of work must receive approval in writing by the Geological Survey before operations may be commenced.

Company **Zapata Petroleum Corporation**  
Address **P. O. Box 2216**  
**Midland, Texas**  
By **James L. Wood**  
Title **Engineer**

**APPROVED**

DEC 12 1957

JOHN A. FROST  
DISTRICT ENGINEER

NEW MEXICO OIL CONSERVATION COMMISSION

Well Location and Acreage Dedication Plat

Form C-128  
Revised 5/1/57

Section A.

Date December 11, 1957

Operator ZAPATA PETROLEUM CORPORATION Lease Phillips-Federal  
Well No. 2-X Unit Letter        Section 33 Township 17 South Range 33 East NMPM  
Located 330 Feet From North Line, 1650 Feet From East Line  
County Lee G. L. Elevation 4177.4 Dedicated Acreage 40 Acres  
Name of Producing Formation Grayburg Pool Maljamar

1. Is the Operator the only owner\* in the dedicated acreage outlined on the plat below?  
Yes X No       .
2. If the answer to question one is "no," have the interests of all the owners been consolidated by communitization agreement or otherwise? Yes        No       . If answer is "yes," Type of Consolidation
3. If the answer to question two is "no," list all the owners and their respective interests below:

Owner

Land Description

**RECEIVED**  
DEC 12 1957

Section B

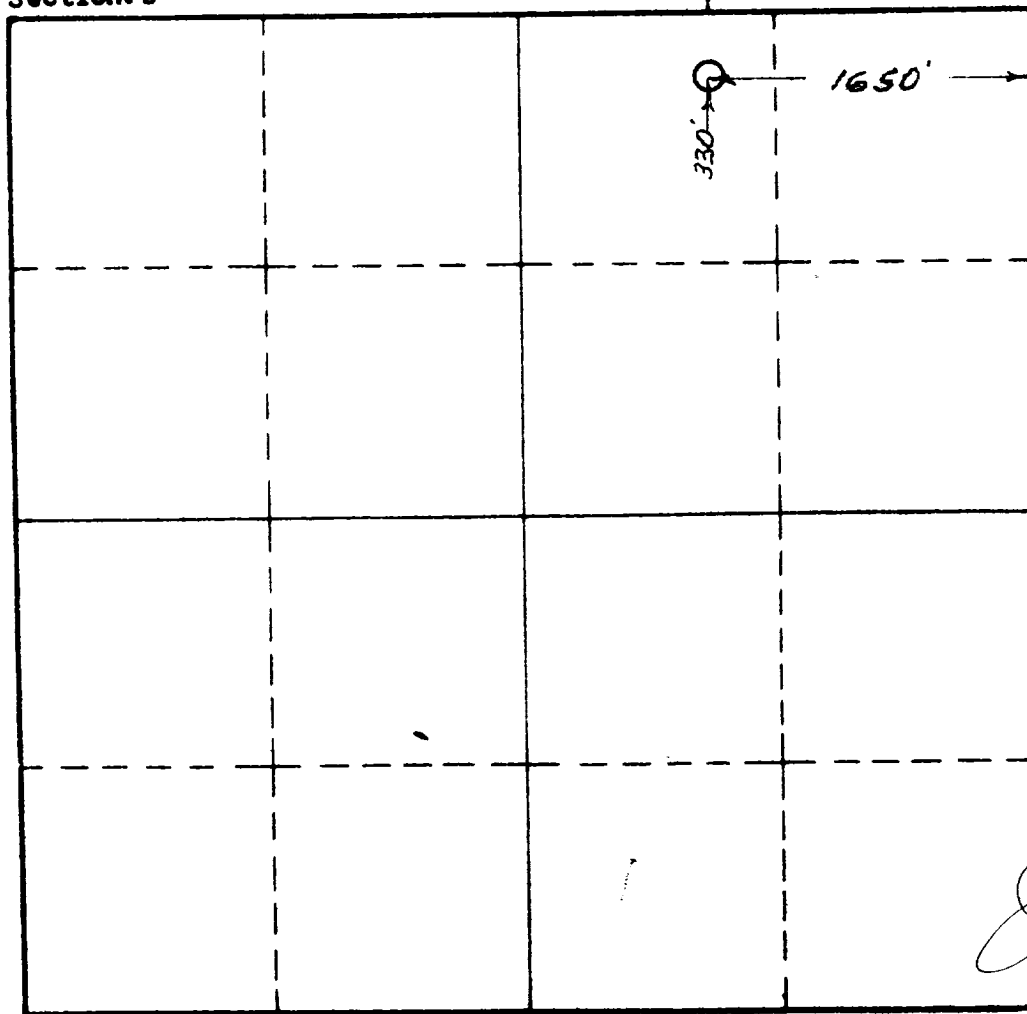

This is to certify that the information in Section A above is true and complete to the best of my knowledge and belief.

ZAPATA PETROLEUM CORP.

(Operator)

W. C. Rife  
(Representative)

Box 2216, Midland, Texas  
Address

This is to certify that the well location shown on the plat in Section B was plotted from field notes of actual surveys made by me or under my supervision and that the same is true and correct to the best of my knowledge and belief.

Date Surveyed Dec. 11, 1957

John W. Shuman  
Registered Professional  
Engineer and/or Land Surveyor.

Certificate No. 1559

(See instructions for completing this form on the reverse side)