

NOTICE OF INTENTION TO DRILL

Notice must be given to the District Office of the Oil Conservation Commission and approval obtained before drilling or recompletion begins. If changes in the proposed plan are considered advisable, a copy of this notice showing such changes will be returned to the sender. Submit this notice in QUINTUPLICATE. One copy will be returned following approval. See additional instructions in Rules and Regulations of the Commission. If State Land submit 6 Copies Attach Form O-128 in triplicate to first 3 copies of form O-101

Abilene, Texas
(Place)

April 11, 1961
(Date)

OIL CONSERVATION COMMISSION
SANTA FE, NEW MEXICO

Gentlemen:

You are hereby notified that it is our intention to commence the Drilling of a well to be known as

Don C. Wiley and Dick Lowe

(Company or Operator)

Mobil State

(Lease)

Well No. 1-Q

0

The well is

located 1650 feet from the east line and 660 feet from the

south

line of Section 36, T. 17S

R. 33E, NMPM.

(GIVE LOCATION FROM SECTION LINE)

Wildcat

Pool, Lea

County

If State Land the Oil and Gas Lease in No. E-1571

If patented land the owner is

Address

We propose to drill well with drilling equipment as follows:

Rotary rig from surface to 4100 feet

The status of plugging bond is

Blanket Bond on file

Drilling Contractor El Chorro Exploration, Inc.

We intend to complete this well in the Queen Sand

formation at an approximate depth of 3950 feet.

CASING PROGRAM

We propose to use the following strings of Casing and to cement them as indicated:

Size of Hole	Size of Casing	Weight per Foot	New or Second Hand	Depth	Sacks Cement
12 1/4"	8 5/8	24#	New	280	Circulate
6 3/4"	4 1/2	9.5#	New	4010	Cover Salt Section

If changes in the above plans become advisable we will notify you immediately.

ADDITIONAL INFORMATION (If recompletion give full details of proposed plan of work.)

Approved _____, 19____
Except as follows:

OIL CONSERVATION COMMISSION

By _____

Sincerely yours,

Don C. Wiley and Dick Lowe

(Company or Operator)

By Dick Lowe

Position Partner

Send Communications regarding well to

Name Dick Lowe

Address 814 Citizens Bk. Bldg. Abilene, Texas

NUMBER OF COPIES RECEIVED	
DISTRIBUTION	
SANTA FE	
FILE	
U.S.G.S.	
LAND OFFICE	
TRANSPORTER	OIL GAS
PRODUCTION OFFICE	
OPERATOR	

NEW MEXICO OIL CONSERVATION COMMISSION
WELL LOCATION AND ACREAGE DEDICATION PLAT
 SEE INSTRUCTIONS FOR COMPLETING THIS FORM ON THE REVERSE SIDE

FORM C-128
 Revised 5/1/57

SECTION A

Operator Don C. Wiley & Dick Lowe		Lease Mobil-State		Well No. 1-Q
Unit Letter	Section 36	Township 17 South	Range 33 East	County Lea
Actual Footage Location of Well: 660 feet from the South line and 1650 feet from the East line				
Ground Level Elev. 4101	Producing Formation Queen Sand		Pool Wildcat	Dedicated Acreage: 40 Acres

1. Is the Operator the only owner in the dedicated acreage outlined on the plat below? YES ☒ NO ____ . ("Owner" means the person who has the right to drill into and to produce from any pool and to appropriate the production either for himself or for himself and another. (65-3-29 (e) NMSA 1935 Comp.)
2. If the answer to question one is "no," have the interests of all the owners been consolidated by communitization agreement or otherwise? YES ____ NO ____ . If answer is "yes," Type of Consolidation ____
3. If the answer to question two is "no," list all the owners and their respective interests below:

Owner	Land Description

SECTION B

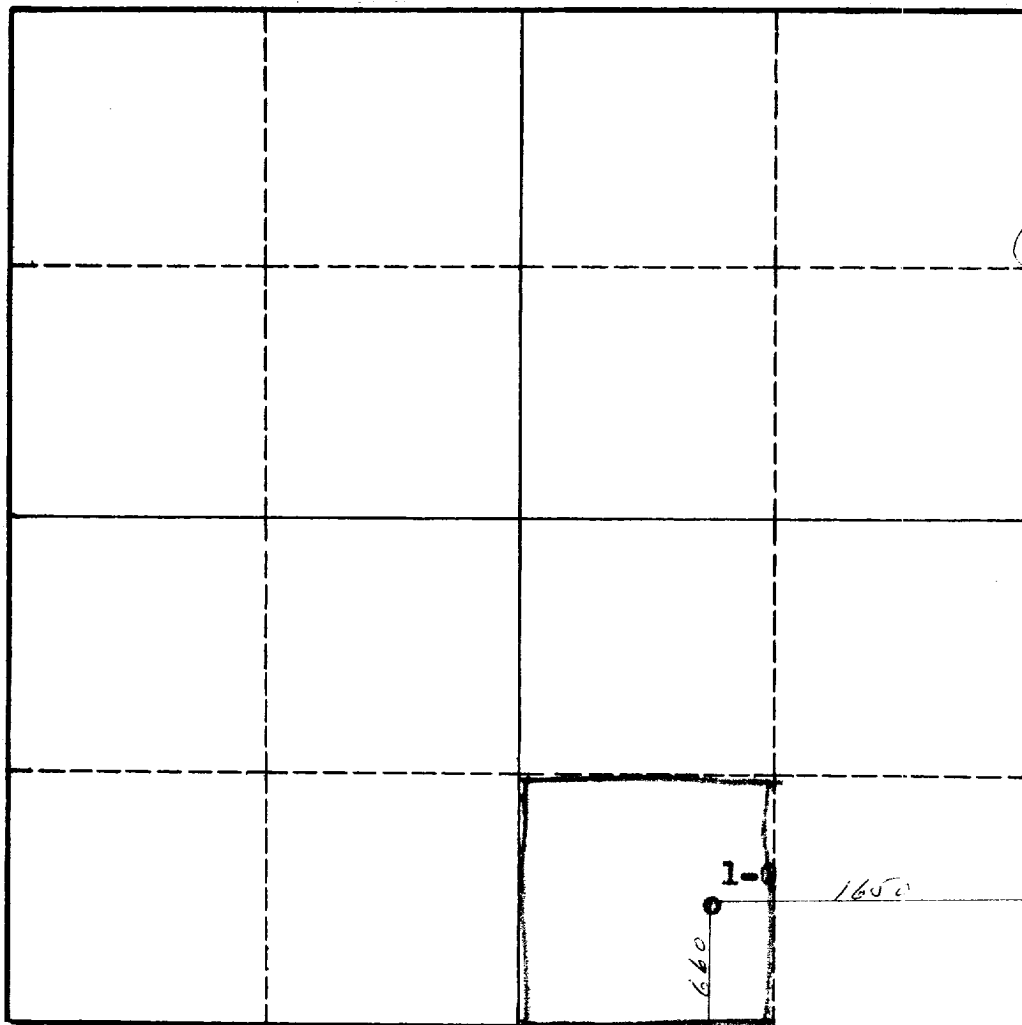

CERTIFICATION

I hereby certify that the information in SECTION A above is true and complete to the best of my knowledge and belief.

Joseph H. Roeder
 Name
Joseph H. Roeder
 Position
Agent
 Company
Don C Wiley & Dick Lowe
 Date
April 13, 1961

I hereby certify that the well location shown on the plat in SECTION B was plotted from field notes of actual surveys made by me or under my supervision, and that the same is true and correct to the best of my knowledge and belief.

Date Surveyed
April 12, 1961
 Registered Professional Engineer and/or Land Surveyor
John A. Matlock Jr
 Certificate No.
1502

INSTRUCTIONS FOR COMPLETION OF FORM C-128

1. Operator shall furnish and certify to the information called for in Section A.
2. Operator shall outline the dedicated acreage for *both* oil and gas wells on the plat in Section B.
3. A registered professional engineer or land surveyor registered in the State of New Mexico or approved by the Commission shall show on the plat the location of the well and certify this information in the space provided.
4. All distances shown on the plat must be from the outer boundaries of the Section.
5. If additional space is needed for listing owners and their respective interests as required in question 3 of Section A, please use space below.