

NEW MEXICO OIL CONSERVATION COMMISSION

Santa Fe, New Mexico

NOTICE OF INTENTION TO DRILL OR RECOMPLETE

Notice must be given to the District Office of the Oil Conservation Commission and approval obtained before drilling or recompletion begins. If changes in the proposed plan are considered advisable, a copy of this notice showing such changes will be returned to the sender. Submit this notice in QUINTUPLICATE. One copy will be returned following approval. See additional instructions in Rules and Regulations of the Commission. If State Land submit 6 Copies

Midland, Texas

(Place)

November 12, 1958

(Date)

OIL CONSERVATION COMMISSION
SANTA FE, NEW MEXICO

Gentlemen:

You are hereby notified that it is our intention to commence the (Drilling) (Recompletion) of a well to be known as Phillips Petroleum Company

(Company or Operator)

Leasex

(Lease)

Well No. 7

in P

The well is

located 1980 feet from the North

North

line and 1976

(Unit)

feet from the

North

line of Section 23, T 17-S, R 33-E, NMPM.

(GIVE LOCATION FROM SECTION LINE)

Leasex (Peas) Pool, Lea

County

If State Land the Oil and Gas Lease is No. B-2148

If patented land the owner is

Address

We propose to drill well with drilling equipment as follows: Rotary

The status of plugging bond is Blanket

Drilling Contractor Phillips Petroleum Company Rig #18

Box 6666

Odessa, Texas

We intend to complete this well in the Pennsylvanian

formation at an approximate depth of 12,000 feet.

CASING PROGRAM

We propose to use the following strings of Casing and to cement them as indicated:

| Size of Hole | Size of Casing | Weight per Foot | New or Second Hand | Depth | Sacks Cement |
|--------------|----------------|-----------------|--------------------|----------|---|
| 17-3/4" | 13-3/8" | 48# | New | 440 | 450 |
| 12-1/4" | 9-5/8" | 36# | New | 4750 | 4350 CF 40% Diacel 161 w/100 sxs reg |
| 8-3/4" | 5-1/2" | 23# | New | 12000 TD | 240 |

If changes in the above plans become advisable we will notify you immediately.

ADDITIONAL INFORMATION (If recompletion give full details of proposed plan of work.)

Approved: DEC 5 1958, 19

Except as follows:

Sincerely yours,

Phillips Petroleum Company

(Company or Operator)

By: J. N. Perkins

Position: Ass't Div. Superintendent

Send Communications regarding well to

Name: J. N. Perkins

OIL CONSERVATION COMMISSION

By: [Signature]

NEW MEXICO OIL CONSERVATION COMMISSION
Well Location and Acreage Dedication Plat

Section A.

Date November 12, 1958

Operator Phillips Petroleum Company Lease Lease 4
Well No. 7 Unit Letter F Section 23 Township 17-S Range 33-E NMPM
Located 1980 Feet From North Line, 1976 Feet From West Line
County Lea G. L. Elevation Later Dedicated Acreage 40 Acres
Name of Producing Formation Pennsylvanian Pool Lease (Penn.)

1. Is the Operator the only owner* in the dedicated acreage outlined on the plat below?
Yes No .
2. If the answer to question one is "no," have the interests of all the owners been consolidated by communitization agreement or otherwise? Yes No . If answer is "yes," Type of Consolidation _____
3. If the answer to question two is "no," list all the owners and their respective interests below:

Owner

Land Description

SE/4 of NW/4 Sec. 23, T-17-S, R-33-E.

Lea County, New Mexico

State Lease B-2148

Section B

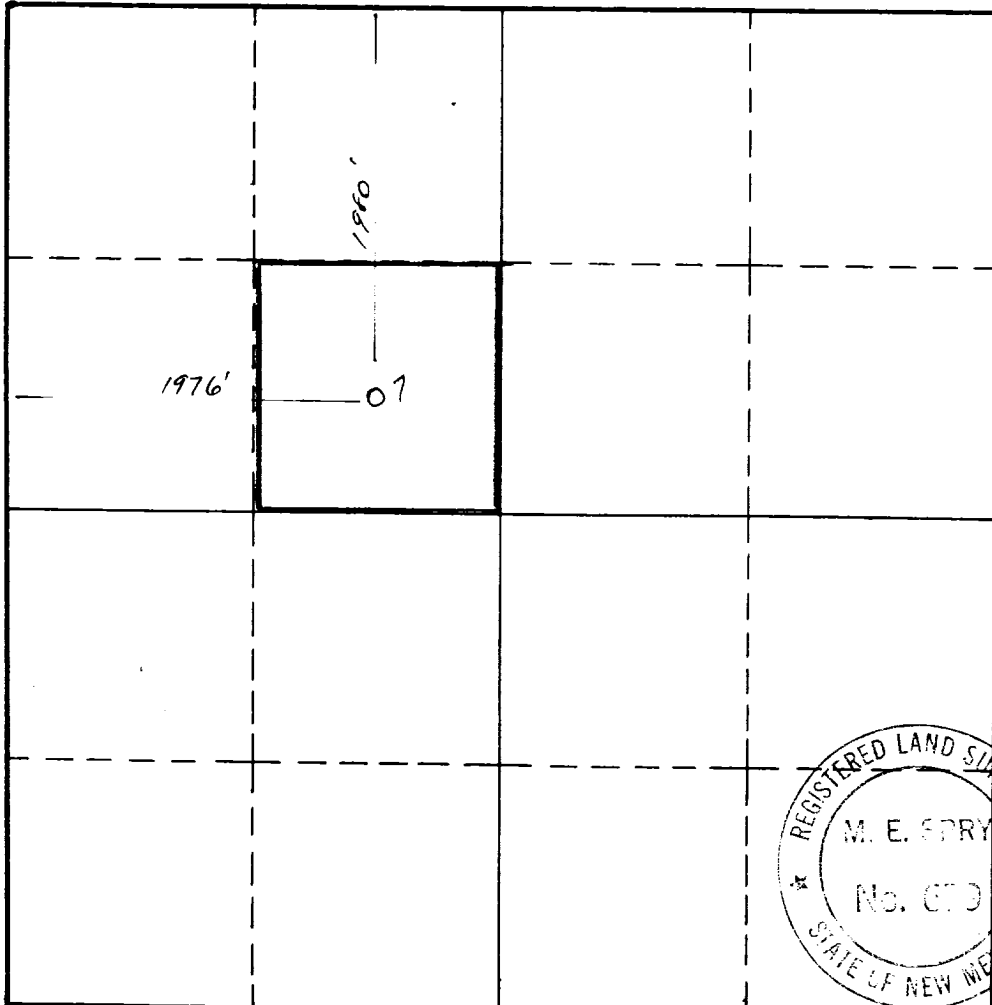

This is to certify that the information in Section A above is true and complete to the best of my knowledge and belief.

Phillips Petroleum Company
(Operator)

[Signature]
(Representative)

3rd Flr, Permian Bldg. Midland
Address Texas

This is to certify that the well location shown on the plat in Section B was plotted from field notes of actual surveys made by me or under my supervision and that the same is true and correct to the best of my knowledge and belief.

Date Surveyed 11-7-58

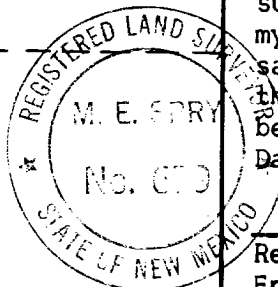

M. E. Spry
Registered Professional
Engineer and/or Land Surveyor.

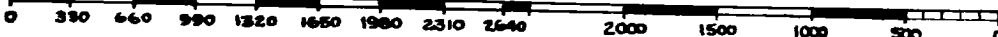

INSTRUCTIONS FOR COMPLETION:

1. Operator shall furnish and certify to the information called for in Section A.
2. Operator shall outline the dedicated acreage for both oil and gas wells on the plat in Section B.
3. A registered professional engineer or land surveyor registered in the State of New Mexico or approved by the Commission shall show on the plat the location of the well and certify this information in the space provided.
4. All distances shown on the plat must be from the outer boundaries of Section.
5. If additional space is needed for listing owners and their respective interests as required in question 3, Section A, please use space below

* "Owner" means the person who has the right to drill into and to produce from any pool and to appropriate the production either for himself or for himself and another. (65-3-29 (e) NMSA 1953 Comp.)