

NEW MEXICO OIL CONSERVATION COMMISSION
Santa Fe, New Mexico

NOTICE OF INTENTION TO DRILL OR RECOMPLETE

Notice must be given to the District Office of the Oil Conservation Commission and approval obtained before drilling or recompletion begins. If changes in the proposed plan are considered advisable, a copy of this notice showing such changes will be returned to the sender. Submit this notice in QUADRUPPLICATE. One copy will be returned following approval. See additional instructions in Rules and Regulations of the Commission. If State Land submit 6 Copies

Midland, Texas

November 1, 1955

(Place)

(Date)

OIL CONSERVATION COMMISSION
SANTA FE, NEW MEXICO

Gentlemen:

You are hereby notified that it is our intention to commence the (Drilling) (Recompletion) of a well to be known as

Phillips Petroleum Company

(Company or Operator)

Leasex

(Lease)

Well No. 5

0

(Unit)

The well is located 660 feet from the South line and 1900 feet from the East

East

line of Section 25

T 17-S

R 33-E

NMPM.

(GIVE LOCATION FROM SECTION LINE)

(Undesignated)

Pool,

Lee

County

If State Land the Oil and Gas Lease is No. B-2148

If patented land the owner is

Address

We propose to drill well with drilling equipment as follows: Rotary

The status of plugging bond is Blanket

Drilling Contractor Warren-Bradshaw Exploration Company

National Bank of Tulsa Bldg.

Tulsa, Oklahoma

We intend to complete this well in the San Andres

formation at an approximate depth of 5100 feet.

CASING PROGRAM

We propose to use the following strings of Casing and to cement them as indicated:

Size of Hole	Size of Casing	Weight per Foot	New or Second Hand	Depth	Sacks Cement
12-1/4"	9-5/8"	28# & 32#	New	2510'	2100
7-7/8"	5 1/2" or 7"	15.5# & 17#	New	T.D.	850 C.F. 40% Diaseal

If changes in the above plans become advisable we will notify you immediately.

ADDITIONAL INFORMATION (If recompletion give full details of proposed plan of work.)

Approved _____, 19____
Except as follows:

Sincerely yours,

Phillips Petroleum Company

(Company or Operator)

By

Position

Division Chief Clerk

Send Communications regarding well to

Name M.R. Hayes

OIL CONSERVATION COMMISSION

By _____

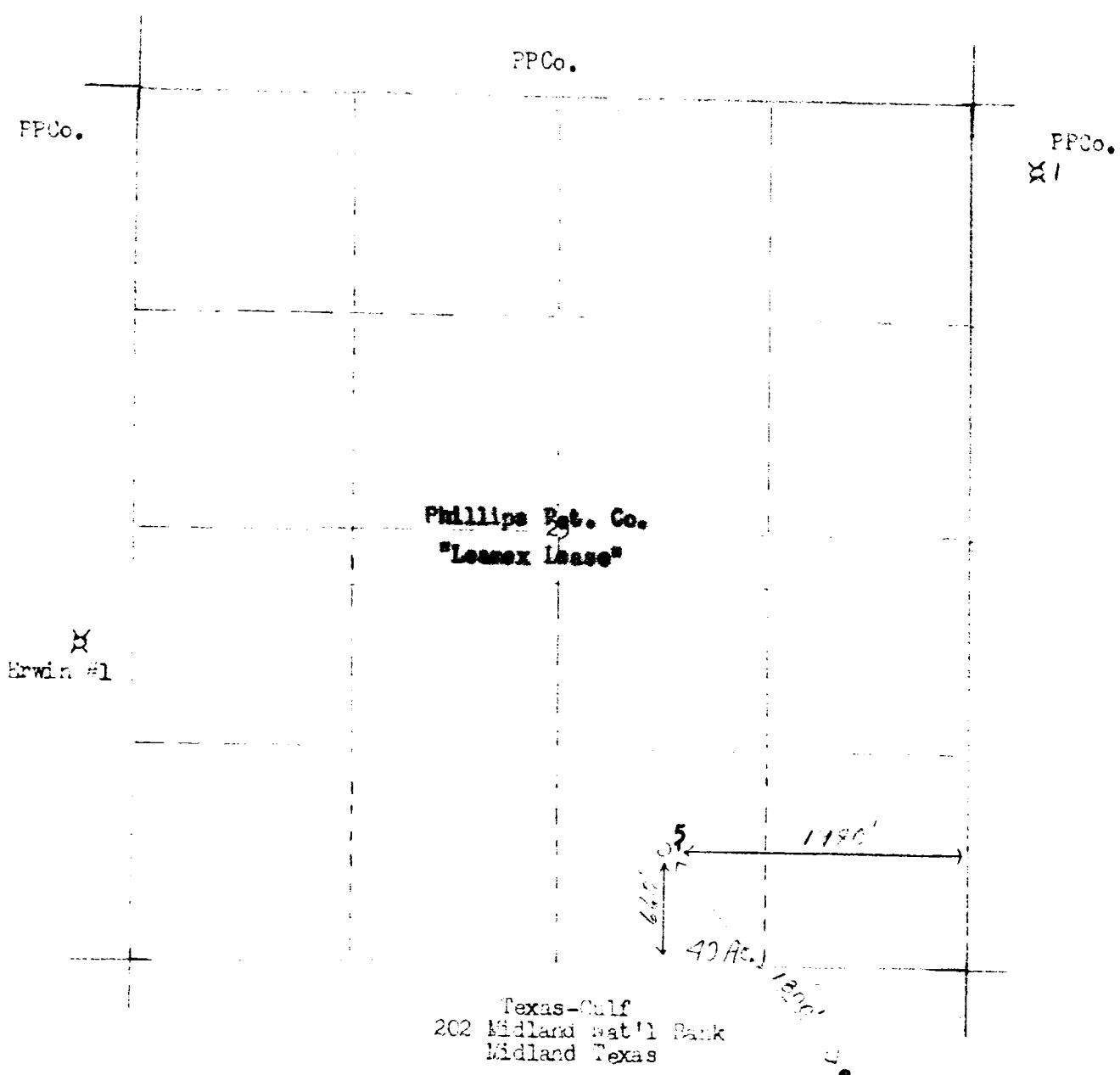

PHILLIPS PETROLEUM COMPANY

BARTLESVILLE, OKLAHOMA

LEAMEX LEASE - 1280 ACRES.

640 ACRES, SECTION 17, T-17-S, R-33-E, LEA COUNTY, NEW MEXICO

640 ACRES, SECTION 25, T-17-S, R-33-E, LEA COUNTY, NEW MEXICO

DRAWN	wjd	REVISION	BY	DATE	AFE. NO. 1" - 1000'	DWG. NO.
CHECKED					SCALE	SHEET NO.
APPROVED						

Laurence E. Hecht

Laurence E. Hecht

Division Chief Clerk
1 November 55

Midland Texas

D. J. Beneman