

NEW MEXICO OIL CONSERVATION COMMISSION

Well Location and Acreage Dedication Plat

Section A.

Date Dec. 23, 57

Operator Warren-Bradshaw Expl. Co. Lease State "E"  
Well No. 1 Unit Letter A Section 29 Township 17 S Range 33 E NMFM  
Located 330 Feet From North Line, 360 Feet From East Line  
County Lea G. L. Elevation 4184 Dedicated Acreage 40 Acres  
Name of Producing Formation Shinarump Pool

1. Is the Operator the only owner\* in the dedicated acreage outlined on the plat below?  
Yes  No .
2. If the answer to question one is "no," have the interests of all the owners been consolidated by communitization agreement or otherwise? Yes  No . If answer is "yes," Type of Consolidation
3. If the answer to question two is "no," list all the owners and their respective interests below:

Owner

Land Description

1953 JAN 3 AM 9 12

HOUSTON OFFICE EOC

Section B

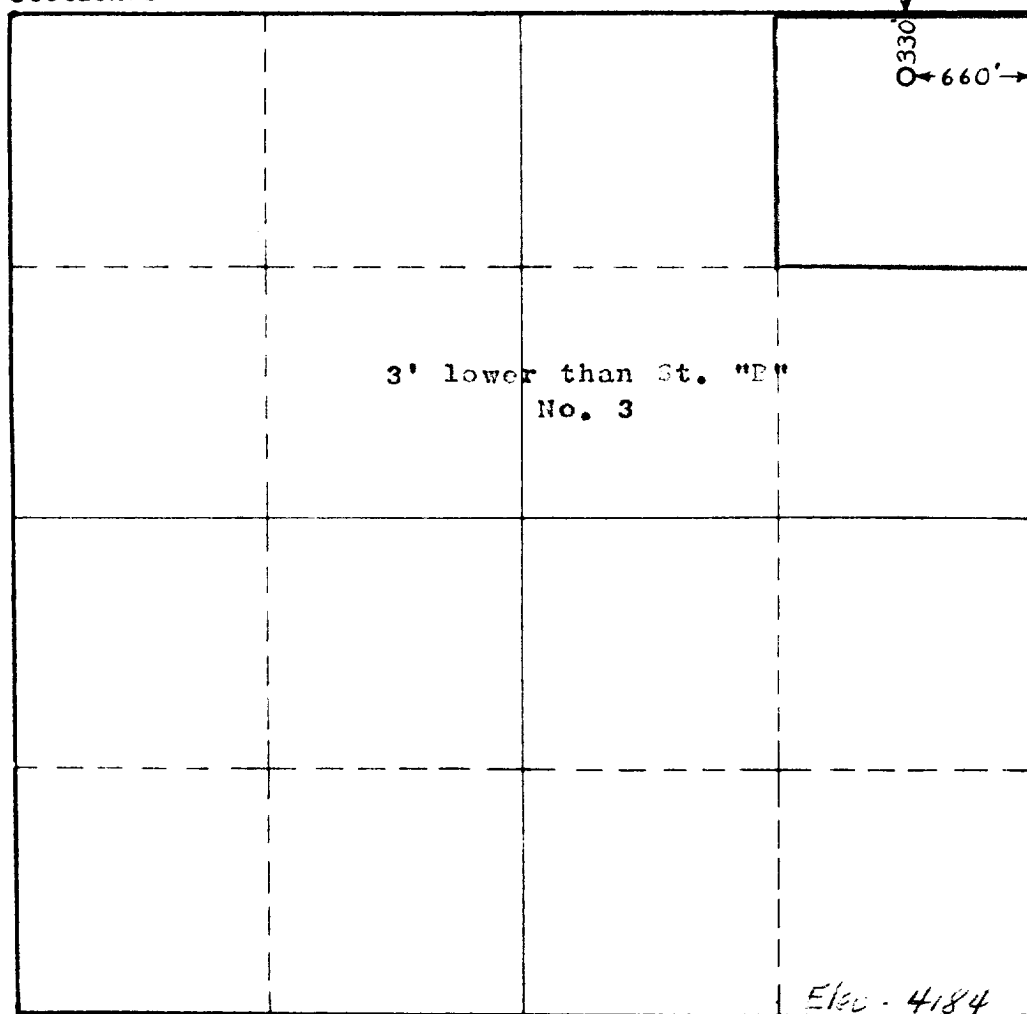

This is to certify that the information in Section A above is true and complete to the best of my knowledge and belief.

Warren-Bradshaw Exp Co  
(Operator)

W. H. Rad  
(Representative)

Box 1417, Loveland, Texas  
Address

This is to certify that the well location shown on the plat in Section B was plotted from field notes of actual surveys made by me or under my supervision and that the same is true and correct to the best of my knowledge and belief.

Date Surveyed Dec. 27, 57

John W. West  
Registered Professional  
Engineer and/or Land Surveyor.

Certificate No. 376

(See instructions for completing this form on the reverse side)