

| | |
|---------------------------|---------|
| NUMBER OF COPIES RECEIVED | |
| DISTRIBUTION | |
| SANTA FE | |
| FILE | |
| U.S.G.S. | |
| LAND OFFICE | |
| TRANSPORTER | OIL GAS |
| PRODUCTION OFFICE | |
| OPERATOR | |

NEW MEXICO OIL CONSERVATION COMMISSION

WELL LOCATION AND ACREAGE DEDICATION PLAT

SEE INSTRUCTIONS FOR COMPLETING THIS FORM ON THE REVERSE SIDE

FORM C-128
Revised 5/1/57

| | | | |
|---|---------------------|---------------------------------------|--|
| SECTION A | | 1961 JUN 2 PM 12 58 | |
| Operator James P. Dunigan | | Lease Carper-Cockburn-State | Well No. 1 |
| Unit Letter H | Section 1 | Township 18 South | Range 33 East County Lea |
| Actual Footage Location of Well: 1980 feet from the North line and 660 feet from the East line | | | |
| Ground Level Elev. 4095 | Producing Formation | Pool Wildcat | Dedicated Acreage: 40 Acres |

1. Is the Operator the only owner in the dedicated acreage outlined on the plat below? YES _____ NO **X**. ("Owner" means the person who has the right to drill into and to produce from any pool and to appropriate the production either for himself or for himself and another. (65-3-29 (e) NMSA 1935 Comp.) **Carper Drilling Company owns all rights above the Abo. James P. Dunigan owns Abo rights.**
2. If the answer to question one is "no," have the interests of all the owners been consolidated by communitization agreement or otherwise? YES **X** NO _____. If answer is "yes," Type of Consolidation **Operating Agreement**
3. If the answer to question two is "no," list all the owners and their respective interests below:

| Owner | Land Description |
|-------|------------------|
| | |
| | |

SECTION B

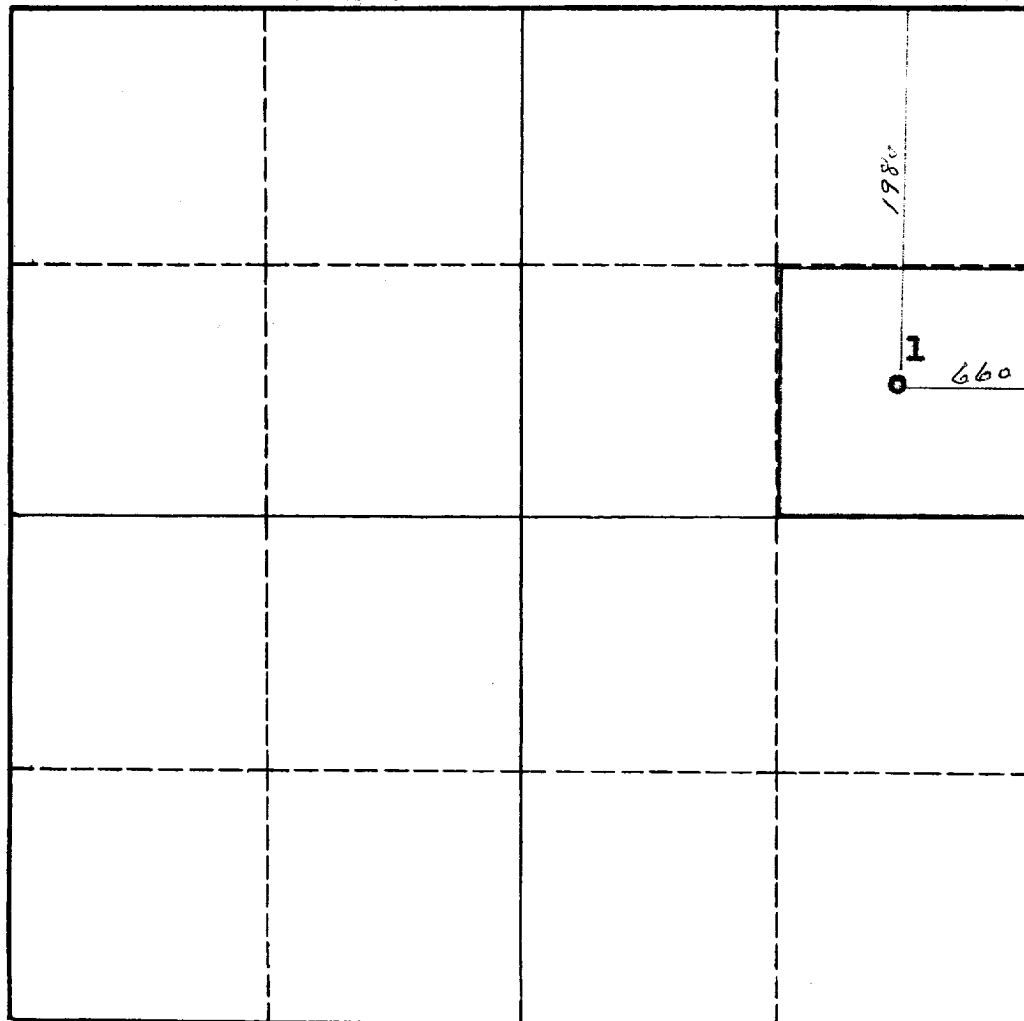

CERTIFICATION

I hereby certify that the information in SECTION A above is true and complete to the best of my knowledge and belief.

| | |
|----------|-------------------------|
| Name | <i>[Signature]</i> |
| Position | Superintendent |
| Company | James P. Dunigan |
| Date | 6-1-61 |

I hereby certify that the well location shown on the plat in SECTION B was plotted from field notes of actual surveys made by me or under my supervision, and that the same is true and correct to the best of my knowledge and belief.

| | |
|---|---------------------|
| Date Surveyed | May 31, 1961 |
| Registered Professional Engineer and/or Land Surveyor | <i>[Signature]</i> |
| Certificate No. | 1502 |

0 330 660 990 1320 1650 1980 2310 2640 2000 1500 1000 500 0

INSTRUCTIONS FOR COMPLETION OF FORM C-128

1. Operator shall furnish and certify to the information called for in Section A.
2. Operator shall outline the dedicated acreage for *both* oil and gas wells on the plat in Section B.
3. A registered professional engineer or land surveyor registered in the State of New Mexico or approved by the Commission shall show on the plat the location of the well and certify this information in the space provided.
4. All distances shown on the plat must be from the outer boundaries of the Section.
5. If additional space is needed for listing owners and their respective interests as required in question 3 of Section A, please use space below.