

NEW MEXICO
OIL CONSERVATION COMMISSION

Form C-128

Well Location and/or Gas Proration Plat

Date FEB 7 1956

Operator NEVILLE G PENROSE

Lease RESLER STATE

Well No. 1 Section 14 Township 18S Range 33E NMPM

Located 1980 Feet From SOUTH Line, 1980 Feet From WEST Line,

LEA

County, New Mexico. G. L. Elevation 3919.5

Name of Producing Formation _____ Pool _____ Dedicated Acreage _____

(Note: All distances must be from outer boundaries of Section)

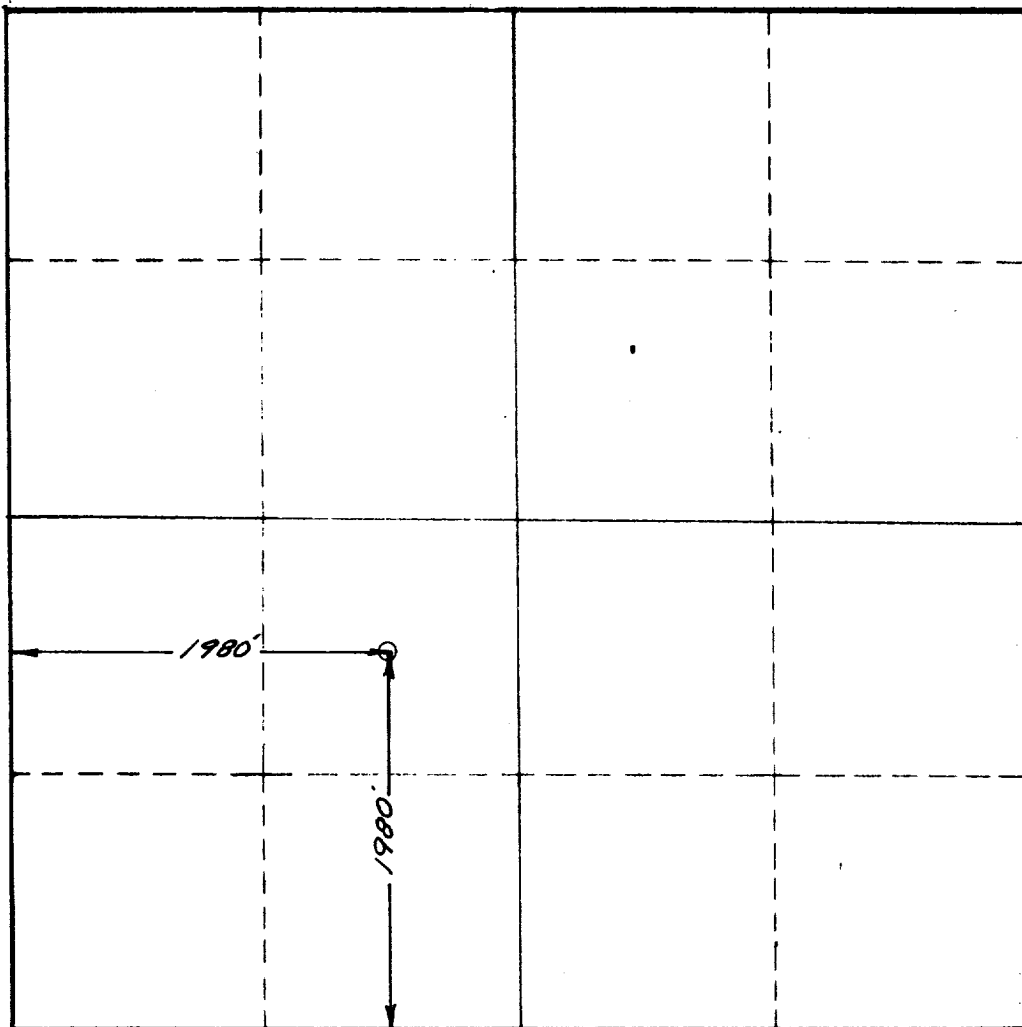

SCALE: 1" = 1000'

1. Is this Well a Dual Comp.? Yes ___ No ___
2. If the answer to Question 1 is yes, are there any other dually completed wells within the dedicated acreage? Yes ___ No ___

This is to certify that the above plat was prepared from field notes of actual surveys made by me or under my supervision and that the same are true and correct to the best of my knowledge and belief.

Name _____
Position _____
Representing _____
Address _____

Date Surveyed FEB 7, 1956

John W West
Registered Professional Engineer and/or
Land Surveyor