

(SUBMIT IN TRIPLICATE)

Land Office New Mexico

Lease No. 04591

Unit \_\_\_\_\_

UNITED STATES  
DEPARTMENT OF THE INTERIOR  
GEOLOGICAL SURVEY

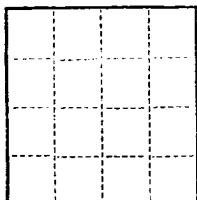

SUNDRY NOTICES AND REPORTS ON WELLS

NOTICE OF INTENTION TO DRILL.....	<input checked="" type="checkbox"/>	SUBSEQUENT REPORT OF WATER SHUT-OFF.....	
NOTICE OF INTENTION TO CHANGE PLANS.....		SUBSEQUENT REPORT OF SHOOTING OR ACIDIZING.....	
NOTICE OF INTENTION TO TEST WATER SHUT-OFF.....		SUBSEQUENT REPORT OF ALTERING CASING.....	
NOTICE OF INTENTION TO RE-DRILL OR REPAIR WELL.....		SUBSEQUENT REPORT OF RE-DRILLING OR REPAIR.....	
NOTICE OF INTENTION TO SHOOT OR ACIDIZE.....		SUBSEQUENT REPORT OF ABANDONMENT.....	
NOTICE OF INTENTION TO PULL OR ALTER CASING.....		SUPPLEMENTARY WELL HISTORY.....	
NOTICE OF INTENTION TO ABANDON WELL.....			

(INDICATE ABOVE BY CHECK MARK NATURE OF REPORT, NOTICE, OR OTHER DATA)

November 26, 19 56

Federal "T" Lease

Well No. 11-24 is located 2310 ft. from N line and 660 ft. from E line of sec. 24

NE 1/4 Sec. 24 18-S 33-E R.M.P.M.  
(1/4 Sec. and Sec. No.) (Twp.) (Range) (Meridian)

E-K Queen Lea New Mexico  
(Field) (County or Subdivision) (State or Territory)

The elevation of the derrick floor above sea level is 3958 ft. (est.)

DETAILS OF WORK

(State names of and expected depths to objective sands; show sizes, weights, and lengths of proposed casings; indicate mudding jobs, cementing points, and all other important proposed work)

I propose to drill this well to a depth of 4410', using rotary to a depth of approximately 1700 feet, and cable tools from there to total depth.

13-3/8" surface casing will be set at 250' and cemented with 200 sacks, which will circulate to the surface.

An intermediate string of 8-5/8" casing will be cemented in the top of Anhydrite at approximately 1700' with 50 sacks.

A 5 1/2" oil production string will be cemented above the Queen pay sand at approximately 4385' with 100 sacks.

All casing will be run and set following practices approved by the U. S. Geological Survey.

I understand that this plan of work must receive approval in writing by the Geological Survey before operations may be commenced.

Company John H. Trigg

Address P. O. Box 5629

Roswell, New Mexico

By

Title Owner

NEW MEXICO  
OIL CONSERVATION COMMISSION

Form C-128

Well Location and/or Gas Proration Plat.

Date 11-16-56

Operator JOHN H. TRIGG Lease FEDERAL "T"

Well No. 11-24 Section 24 Township 18-S Range 33-E NMPM

Located 2310 Feet From SOUTH Line, 660 Feet From EAST Line,

LEA County, New Mexico. G. L. Elevation 3955.6

Name of Producing Formation \_\_\_\_\_ Pool \_\_\_\_\_ Dedicated Acreage \_\_\_\_\_

(Note: All distances must be from outer boundaries of Section)

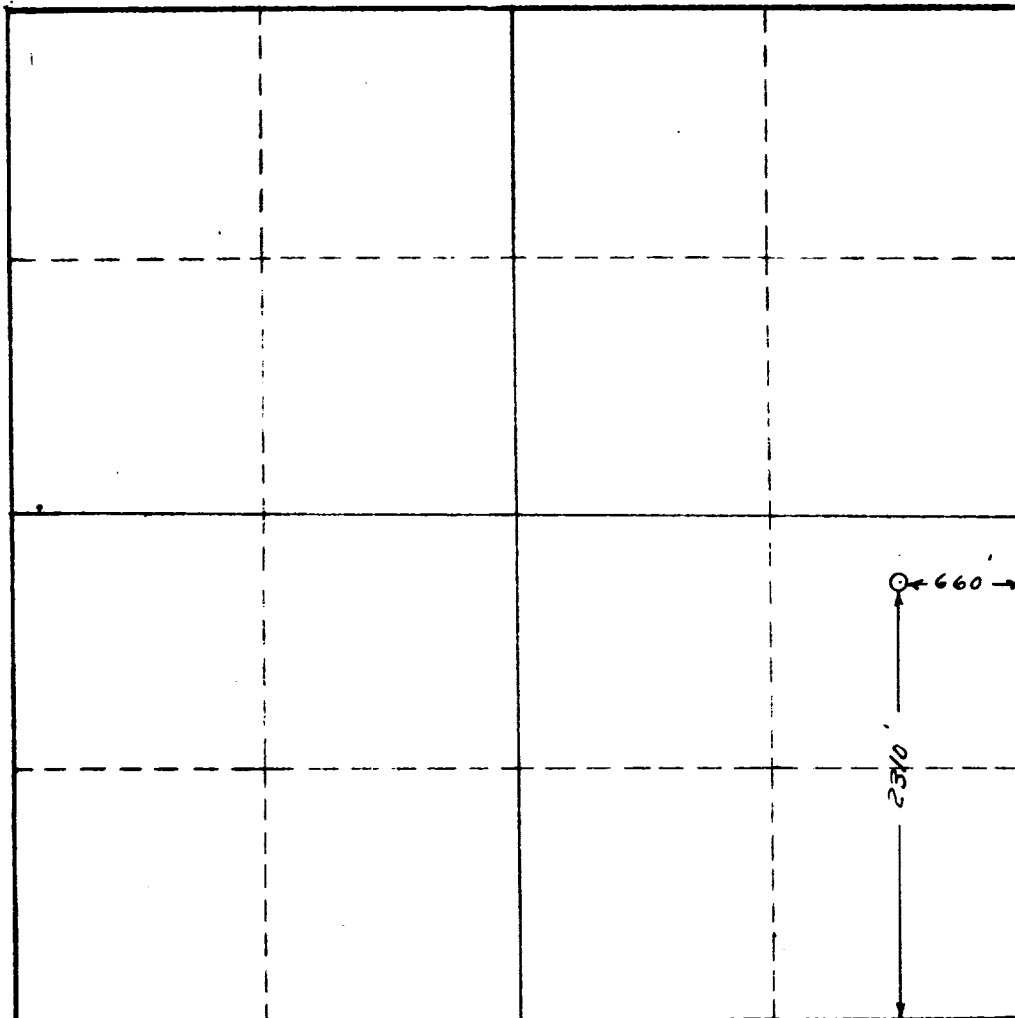

SCALE: 1" = 1000'

1. Is this Well a Dual Comp.? Yes \_\_\_ No \_\_\_.
2. If the answer to Question 1 is yes, are there any other dually completed wells within the dedicated acreage? Yes \_\_\_ No \_\_\_

This is to certify that the above plat was prepared from field notes of actual surveys made by me or under my supervision and that the same are true and correct to the best of my knowledge and belief.

Name \_\_\_\_\_  
Position \_\_\_\_\_  
Representing \_\_\_\_\_  
Address \_\_\_\_\_

Date Surveyed 11-16-56  
John H. Trigg  
Registered Professional Engineer and/or  
Land Surveyor

NOV 27 1956  
U. S. GEOLOGICAL SURVEY  
ARTESIA, NEW MEXICO