

NEW MEXICO OIL CONSERVATION COMMISSION  
Well Location and Acreage Dedication Plat

Section A.

Date 8-22-57

Operator Pan American Pet. Corp. Lease Buffalo Federal Unit  
Well No. 4 Unit Letter H Section 4 Township 19 S Range 33 E NMPM  
Located 1980 Feet From North Line, 660 Feet From East Line  
County Lea G. L. Elevation furnish later Dedicated Acreage 40 Acres  
Name of Producing Formation Wolfcamp Pool Wildcat

1. Is the Operator the only owner\* in the dedicated acreage outlined on the plat below?  
Yes \_\_\_\_\_ No x.
2. If the answer to question one is "no," have the interests of all the owners been consolidated by communitization agreement or otherwise? Yes x No \_\_\_\_\_. If answer is "yes," Type of Consolidation Unit agreement
3. If the answer to question two is "no," list all the owners and their respective interests below:

Owner

Land Description

Section B

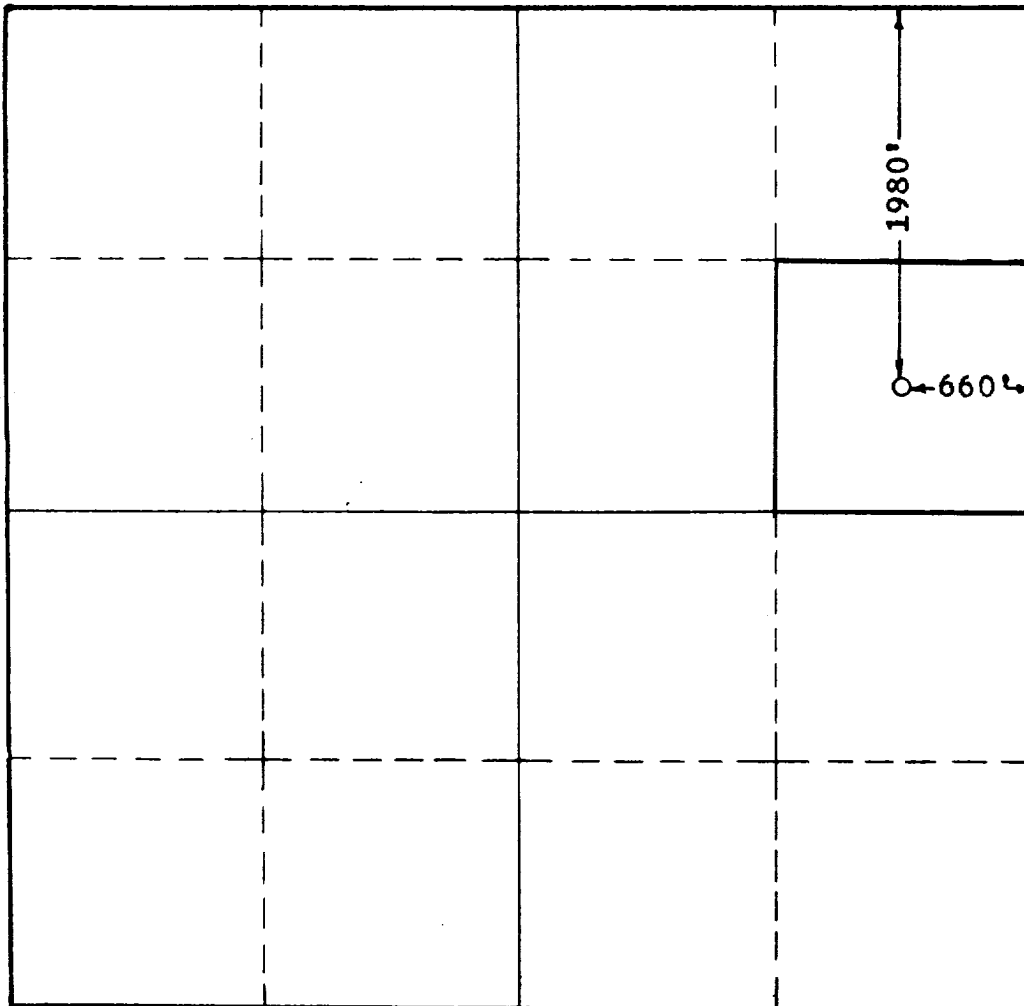

This is to certify that the information in Section A above is true and complete to the best of my knowledge and belief.

Pan American Petroleum Corp.  
(Operator)

\_\_\_\_\_  
(Representative)

Box 68, Hobbs, New Mexico  
Address

This is to certify that the well location shown on the plat in Section B was plotted from field notes of actual surveys made by me or under my supervision and that the same is true and correct to the best of my knowledge and belief.

Date Surveyed 8-22-57

John W. West  
Registered Professional  
Engineer and/or Land Surveyor.

Certificate No. 676

(See instructions for completing this form on the reverse side)