

# Mobil Oil Corporation

P. O. BOX 633  
MIDLAND, TEXAS 79701

May 20, 1976

New Mexico Oil Conservation Commission (3)  
P. O. Box 2088  
Santa Fe, New Mexico 87501

Attention: Mr. Joe D. Ramey

UNORTHODOX WELL LOCATION  
MOBIL OIL CORPORATION'S  
BRIDGES-STATE, WELL NO. 86  
UNDESIGNATED QUEEN GAS POOL  
LEA COUNTY, NEW MEXICO

Gentlemen:

Mobil Oil Corporation respectfully requests authority to recomplete the subject well at an unorthodox location under the provisions of Rule 104 F. Until recently Well No. 86 was completed as an oil well in the Vacuum (Grayburg-San Andres) Pool. This pay watered out and the well became uneconomical to produce (3 BO + 116 BW/day). It has been plugged back to the Queen zone (perforations 3902-2912) and completed as a small volume gas well. It is presently shut in pending Commission action on this request.

Well No. 86 is located in Unit Letter P, 330 ft from the south line and 330 ft from the east line of Sec. 3, T17S, R34E, Lea County, New Mexico. Since this well is less than 660 ft to the section line, as required by Rule 104 C II(a), this request is made.

Supporting documents being submitted in triplicate are:

1. NMOCC Form C-102 - Well location and acreage dedication plat.
2. Certified plat showing the well location and offset operators.
3. List of offset operators.

By registered mail the offset operators are being furnished a copy of this letter and attachments as their notice of this application and request for their waiver of objection.

Yours very truly,



J. A. Morris  
Regulatory Engineering Supervisor

ADBond/cs  
cc: Offset Operators  
NMOCC - Hobbs

NEW MEXICO OIL CONSERVATION COMMISSION  
WELL LOCATION AND ACREAGE DEDICATION

Form C-102  
Supersedes C-128  
Effective 1-1-65

All distances must be from the outer boundaries of the Section.

Operator <b>Mobil Oil Corporation</b>		Lease <b>Bridges-State</b>		Well No. <b>86</b>
Unit Letter <b>P</b>	Section <b>3</b>	Township <b>17S</b>	Range <b>34E</b>	County <b>Lea</b>
Actual Footage Location of Well: <b>330</b> feet from the <b>South</b> line and <b>330</b> feet from the <b>East</b> line				
Ground Level elev. <b>4056</b>	Producing Formation <b>Queen</b>	Pool <b>Undesignated Queen Gas</b>		Dedicated Acreage: <b>160</b> Acres

1. Outline the acreage dedicated to the subject well by colored pencil or hachure marks on the plat below.
2. If more than one lease is dedicated to the well, outline each and identify the ownership thereof (both as to working interest and royalty).
3. If more than one lease of different ownership is dedicated to the well, have the interests of all owners been consolidated by communitization, unitization, force-pooling, etc?

☐ Yes ☐ No If answer is "yes," type of consolidation \_\_\_\_\_

If answer is "no," list the owners and tract descriptions which have actually been consolidated. (Use reverse side of this form if necessary.) \_\_\_\_\_

No allowable will be assigned to the well until all interests have been consolidated (by communitization, unitization, forced-pooling, or otherwise) or until a non-standard unit, eliminating such interests, has been approved by the Commission.

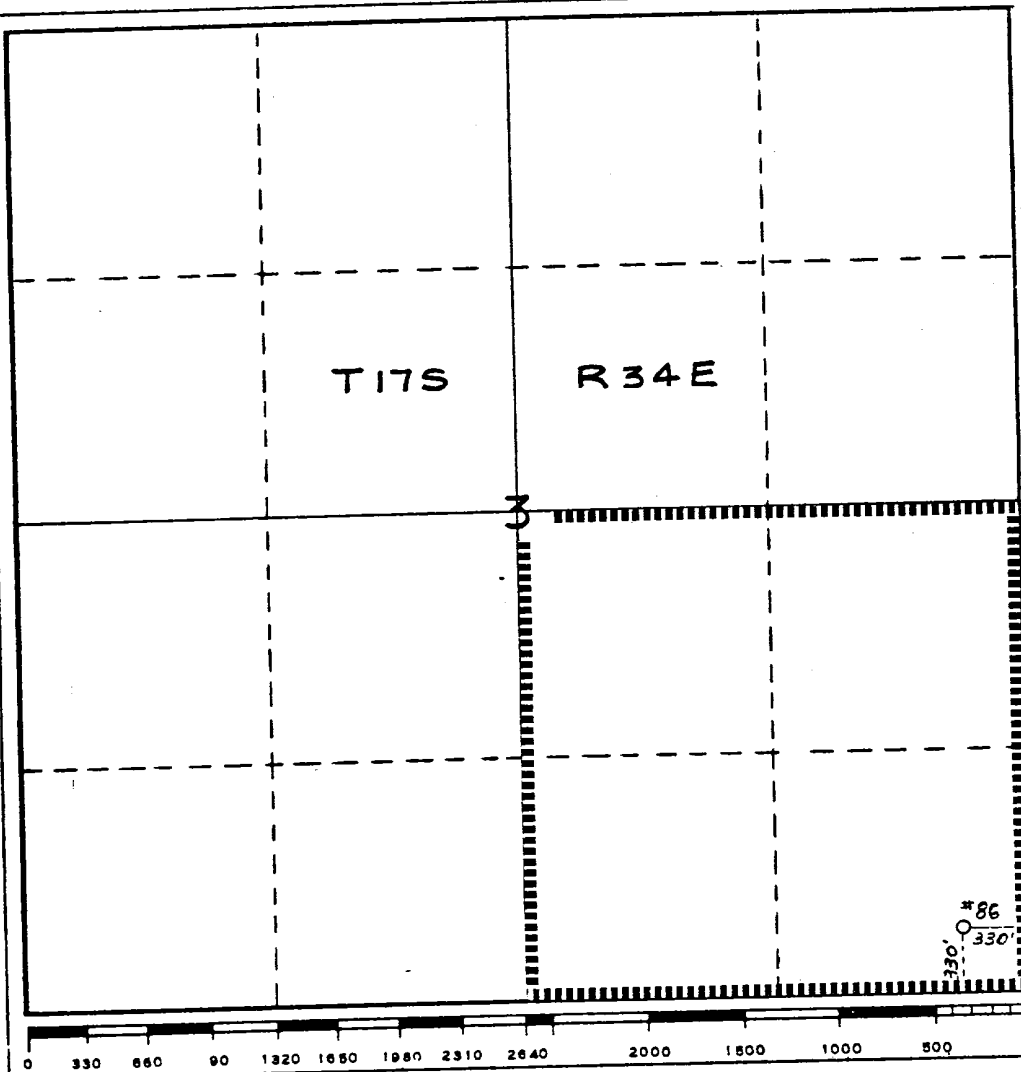

CERTIFICATION

I hereby certify that the information contained herein is true and complete to the best of my knowledge and belief.

*A. D. Bond*

Name

A. D. Bond

Position

Proration Staff Assistant

Company

Mobil Oil Corporation

Date

May 20, 1976

I hereby certify that the well location shown on this plat was plotted from field notes of actual surveys made by me or under my supervision, and that the same is true and correct to the best of my knowledge and belief.

Date Surveyed

Registered Professional Engineer and/or Land Surveyor

Certificate No.

Reserve None

Permit depth

### Special instructions

- LOC. OR DRLG. WELL
- ✖ ABANDONED LOC.
- ✦ DRY & ABANDONED
- OIL WELL
- ✖ ABD. OIL WELL
- ✦ GAS WELL
- ✖ ABD. GAS WELL
- ⊗ S.W. DISPOSAL WELL
- ⊗ GAS INPUT WELL
- ⊗ WATER INPUT WELL

**Date work is commenced**

Location approved by

9

Supt.

Location made by

THE STATE OF TEXAS  
COUNTY OF MIDLAND

I hereby certify that this plat truly represents conditions as they actually exist on this lease; that said plat which is drawn to the scale indicated hereon, is to the best of my knowledge true and correct; that it accurately shows said lease with all wells on same; that number and locations of said wells are as indicated hereon; and that this plat correctly reflects all pertinent and required data.

required data.

A. D. Bond 5-20-76

MOBIL OIL CORPORATION  
HOUSTON E&P DIVISION

LEASE ..... Bridges - State .....

DISTRICT ..... LEASE NO. .... NIM-565

LOCATION MADE ..... 19 ..... WELL NO. ....

TOTAL ACRES IN LEASE 5281.38 ACRES COVERED BY PLAT

DESCRIPTION Lot 2, SW  $\frac{1}{4}$  NE  $\frac{1}{4}$ , & SE  $\frac{1}{4}$  Sec. 3; NE  $\frac{1}{4}$  Sec. 10; S  $\frac{1}{2}$  Sec. 11; E  $\frac{1}{2}$  & SW  $\frac{1}{4}$  Sec. 12; W  $\frac{1}{2}$  & NE  $\frac{1}{4}$  Sec. 13; Sec. 14; E  $\frac{1}{2}$  Sec. 15; N  $\frac{1}{2}$  & SE  $\frac{1}{4}$  Sec. 23; W  $\frac{1}{2}$  NW  $\frac{1}{4}$ , SE  $\frac{1}{4}$  NW  $\frac{1}{4}$ , & SW  $\frac{1}{4}$  Sec. 24; NW  $\frac{1}{4}$ , N  $\frac{1}{2}$  NE  $\frac{1}{4}$  & SW  $\frac{1}{4}$  NE  $\frac{1}{4}$  Sec. 25; Sec. 26; E  $\frac{1}{2}$  Sec. 27; T-17 S, R-34 E; E  $\frac{1}{2}$  Sec. 25; & E  $\frac{1}{2}$  Sec. 34; T-16 S, R-34 E.  
Lea County, New Mexico.

Lea County, New Mexico

DATE: N.V. Sovinsky...

DATE June 13, 1937

FIELD	Vacuum
-------	--------

SCALE 1" = 1000'

FILE NO. 45

ADDRESS LIST OF OFFSET OPERATORS TO  
MOBIL OIL CORPORATION'S  
BRIDGES-STATE LEASE  
LEA COUNTY, NEW MEXICO

---

Gulf Oil Corporation, P. O. Box 1150, Midland, Texas 79701

Pennzoil Company, P. O. Box 1828, Midland, Texas 79701

Superior Oil Company, P. O. Box 1521, Houston, Texas 77001

Yates Petroleum Corporation, Transco Tower, Suite 2390,  
Houston, Texas 77027