

NEW MEXICO OIL CONSERVATION COMMISSION
Well Location and Acreage Dedication Plat

Section A.

Date August 1, 1957

Operator MAGNOLIA PETROLEUM COMPANY Lease STATE-BRIDGES
Well No. 92 Unit Letter Section 3 Township 17S Range 34E NMPM
Located 1980 Feet From East 660 Feet From South Line
County Lea G. L. Elevation Dedicated Acreage 40 Acres
Name of Producing Formation San Andres Pool Vacuum

1. Is the Operator the only owner* in the dedicated acreage outlined on the plat below?
Yes X No .
2. If the answer to question one is "no," have the interests of all the owners been consolidated by communitization agreement or otherwise? Yes No . If answer is "yes," Type of Consolidation
3. If the answer to question two is "no," list all the owners and their respective interests below:

Owner

Land Description

Section B.

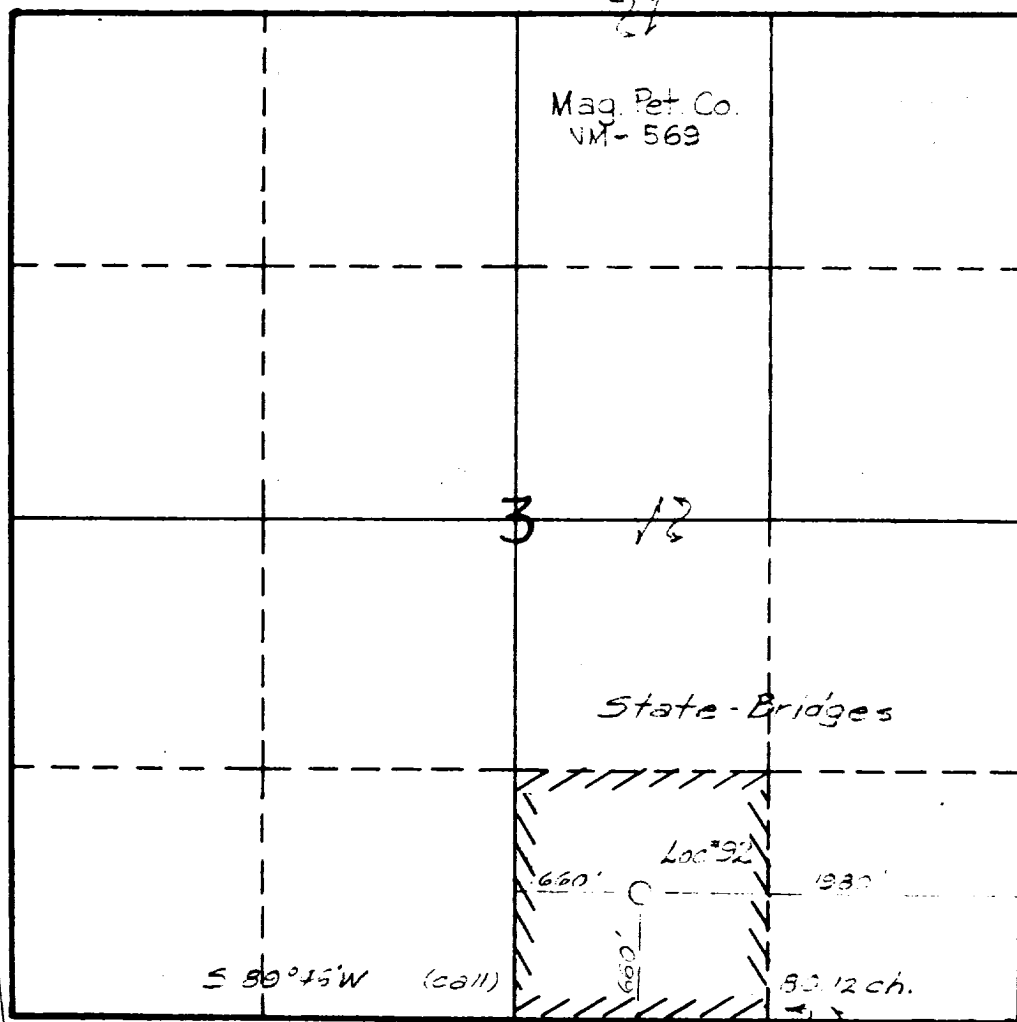

This is to certify that the information in Section A above is true and complete to the best of my knowledge and belief.

Magnolia Petroleum Company

(Operator)

W. H. Hughes

(Representative)

Box 2406, El Paso, New Mexico

Address

This is to certify that the well location shown on the plat in Section B was plotted from field notes of actual surveys made by me or under my supervision and that the same is true and correct to the best of my knowledge and belief.

Date Surveyed July 30, 1957

Carl E. Turner
Registered Professional
Engineer and/or Land Surveyor.

Certificate No. 2490