

NEW MEXICO OIL CONSERVATION COMMISSION
Santa Fe, New Mexico

NOTICE OF INTENTION TO DRILL OR RECOMPLETE

Notice must be given to the District Office of the Oil Conservation Commission and approval obtained before drilling or recompletion begins. If changes in the proposed plan are considered advisable, a copy of this notice showing such changes will be returned to the sender. Submit this notice in QUINTUPPLICATE. One copy will be returned following approval. See additional instructions in Rules and Regulations of the Commission. If State Land submit 6 Copies

Hobbs, New Mexico

(Place)

May 24, 1955

(Date)

OIL CONSERVATION COMMISSION
SANTA FE, NEW MEXICO

Gentlemen:

You are hereby notified that it is our intention to commence the (Drilling) (~~Recompletion~~) of a well to be known as

The Ohio Oil Company

(Company or Operator)

State Bridges "B"

(Lease)

Well No. 1, in E The well is

(Unit)

660

located 1900 feet from the North line and 660 feet from the

West

line of Section 12

T. 17 S

R. 3 E

NMPM.

(GIVE LOCATION FROM SECTION LINE)

Vacuum

Pool,

B-2244

County

If State Land the Oil and Gas Lease is No.

If patented land the owner is

Address

We propose to drill well with drilling equipment as follows:

rotary tools

The status of plugging bond is

Drilling Contractor Howard P. Holmes Drilling Contractor

We intend to complete this well in the San Andres formation at an approximate depth of 4800 feet.

CASING PROGRAM

We propose to use the following strings of Casing and to cement them as indicated:

| Size of Hole | Size of Casing | Weight per Foot | New or Second Hand | Depth | Sacks Cement |
|--------------|----------------|-----------------|--------------------|-------|--------------|
| 13-3/4" | 10-3/4" | 32.75 | New | 600' | 300 |
| 8-3/4" | 5-1/2" | 15.50 | " | 4800' | 1450 |
| | | | | | |
| | | | | | |
| | | | | | |

If changes in the above plans become advisable we will notify you immediately.

ADDITIONAL INFORMATION (If recompletion give full details of proposed plan of work.)

Approved....., 19.....
Except as follows:

OIL CONSERVATION COMMISSION

Sincerely yours,

The Ohio Oil Company

(Company or Operator)

By

Superintendent

Position

Send Communications regarding well to

The Ohio Oil Company

Name

P. O. Box 2107, Hobbs, New Mexico

WELL LOCATION SURVEY PLAT

RECORDS OFFICE 000

OPERATOR OHIO OIL CO.

LEASE STATE BRIDGES "B"

JAN 10 1955 7:20

WELL NO. 1

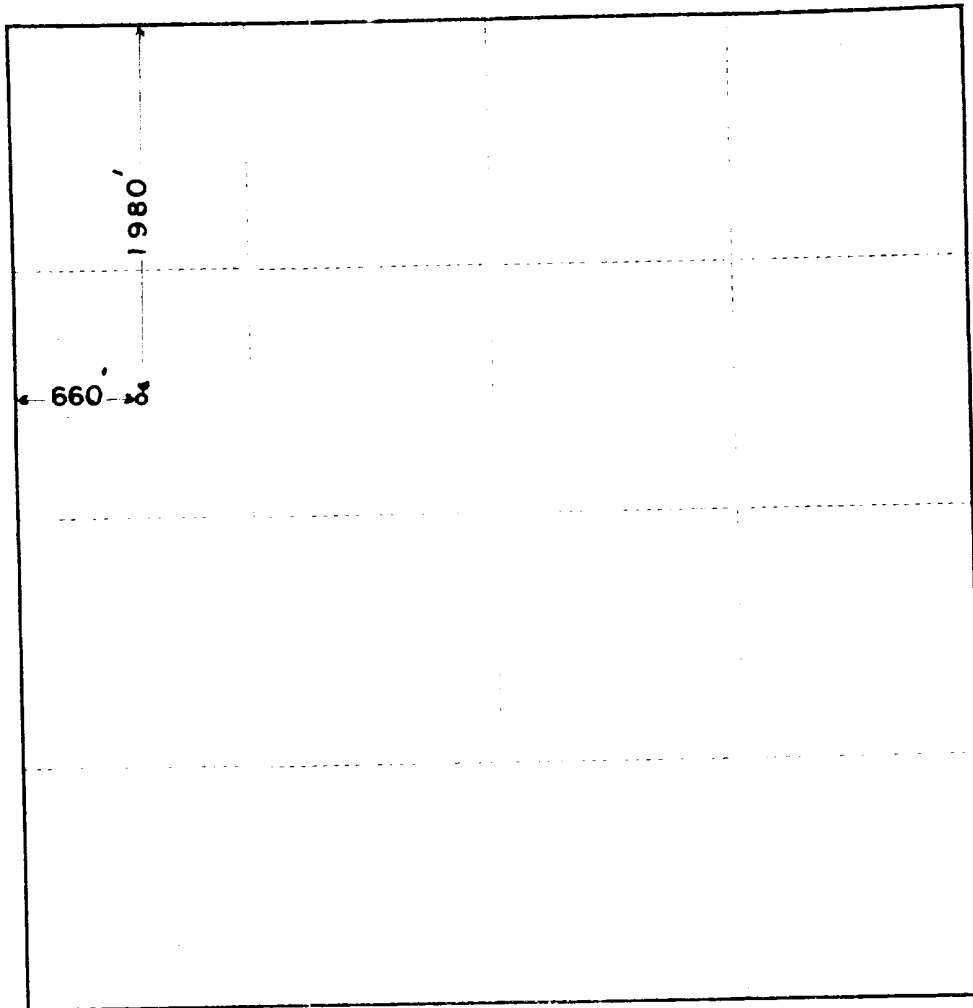

SEC. 12, TWP. 17 S., RGE. 34 E., N.M.P.M.

I HEREBY CERTIFY THAT THIS PLAT WAS MADE
FROM NOTES TAKEN IN THE FIELD BY ME AND
THAT THE SAME IS TRUE AND CORRECT TO THE
BEST OF MY KNOWLEDGE AND BELIEF.

John W West

JOHN W. WEST, PE & LS NO. 676

| | | | | | | |
|---|----------------------|-----------|--------|-----------------|-------|------|
| COUNTY | LEA | FIELD | Vacuum | STATE | NM | OWWO |
| SPR | MARATHON OIL COMPANY | | | | | MAP |
| 1 State-Bridges "B" | | | | | | |
| Sec. 12, T-17-S, R-34-E | | | | | | |
| 1980' FNL & 660' FWL of Sec. | | | | | | |
| Re-Spd 8-9-65 | | | | | | |
| Re-Cmp 11-11-65 | | | | | | |
| | | CLASS | | owd# [REDACTED] | | |
| | | FORMATION | DATUM | FORMATION | DATUM | |
| CSG & SX - TUBING | | | | | | |
| 10 3/4" 638' 415 | | | | | | |
| 5 1/2" 4770' 1700 | | | | | | |
| | | | | | | |
| | | | | | | |
| LOGS EL GR RA IND HC A | | | | | | |
| TD 4823', PBD 3995' | | | | | | |
| IP Queen Perfs 3890-3918' CAOF 2167 MCFGPD. | | | | | | |

Distribution limited and publication prohibited by subscribers' agreement.
Reproduction rights reserved by Williams & Lee Scouting Service, Inc.

| | | |
|-------|------------|------|
| CONT. | PROP DEPTH | TYPE |
| DATE | | |

11-22-65 F.R.C. 11-24-65; OWWO
Orig. The Ohio Oil Co., comp from San Andres
Perfs 4690-4764', OTD 4823'.
TD 4823', PBD 3995', COMPLETE.
Set CIBP @ 4000' & PB to 3995' to shut off
Perfs 4690-4764'.
Perf 3890-3918' W/2 SPF
Ac. 1000 gals.,
Frac 20,000 gals wtr + 32,500# sd. 3890-3918'.

NEW MEXICO OIL CONSERVATION COMMISSION

WELL LOCATION AND ACREAGE DEDICATION PLAT

FORM C-128
Revised 5/1/57

SEE INSTRUCTIONS FOR COMPLETING THIS FORM ON THE REVERSE SIDE

| | | | | | | | |
|---|----------------------|-------------------------------------|-------------------------|---------------------------------|--|--|--|
| Operator MARATHON OIL COMPANY | | | | SECTION A | | Nov 10 / 32 PM '65 | |
| Lease | | | | STATE BRIDGES "B" | | No. 1 | |
| Unit Letter E | Section 12 | Township 17 SOUTH | Range 34 EAST | County LEA | | | |
| Actual Footage Location of Well: 1980 feet from the NORTH line and 660 feet from the WEST line | | | | | | | |
| Ground Level Elev. 1,031 | | Producing Formation QUEEN | | Pool VACUUM QUEEN GAS | | Dedicated Acreage: 160 Acres | |

1. Is the Operator the only owner in the dedicated acreage outlined on the plat below? YES ☒ NO ☐ ("Owner" means the person who has the right to drill into and to produce from any pool and to appropriate the production either for himself or for himself and another. (65-3-29 (e) NMSA 1935 Comp.)
2. If the answer to question one is "no," have the interests of all the owners been consolidated by communitization agreement or otherwise? YES ☐ NO ☐ . If answer is "yes," Type of Consolidation _____
3. If the answer to question two is "no," list all the owners and their respective interests below:

| Owner | Land Description |
|-------|------------------|
| | |
| | |

SECTION B

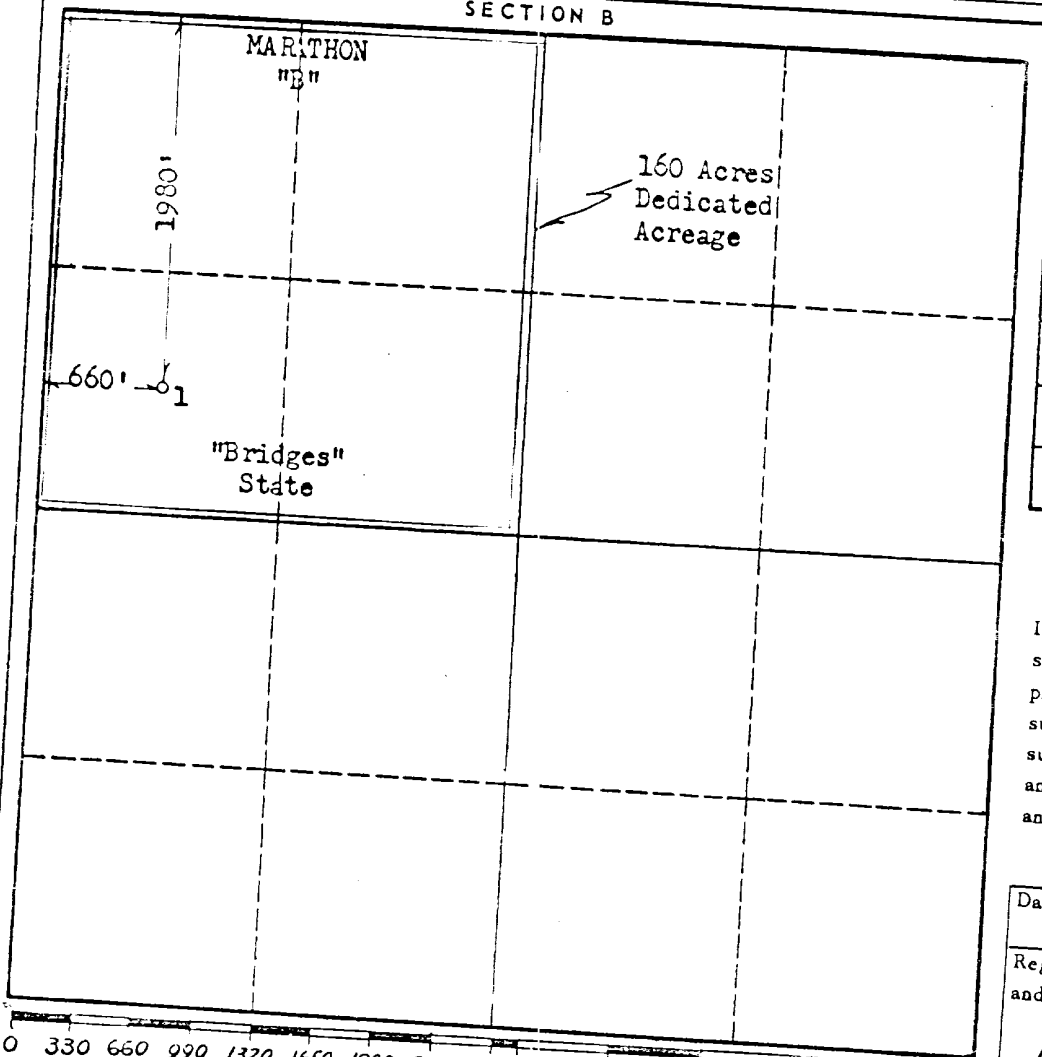

CERTIFICATION

I hereby certify that the information in SECTION A above is true and complete to the best of my knowledge and belief.

John R. Barber
 Name
J. R. Barber
 Position
Area Petroleum Engineer
 Company
Marathon Oil Company
 Date
11-1-65

I hereby certify that the well location shown on the plat in SECTION B was plotted from field notes of actual surveys made by me or under my supervision, and that the same is true and correct to the best of my knowledge and belief.

Date Surveyed
5-17-55
 Registered Professional Engineer
 and/or Land Surveyor
/s/ John W. West
 Certificate No. **676**