

SANTA FE	
FILE	
U.S.G.S.	
LAND OFFICE	
TRANSPORTER	OIL GAS
PRORATION OFFICE	
OPERATOR	

**NEW MEXICO OIL CONSERVATION COMMISSION**  
**Santa Fe, New Mexico**

Form C-101  
Revised (12/1/55)

## NOTICE OF INTENTION TO DRILL

Notice must be given to the District Office of the Oil Conservation Commission and approval obtained before drilling or recompletion begins. If changes in the proposed plan are considered advisable, a copy of this notice showing such changes will be returned to the sender. Submit this notice in **QUINTUPLICATE**. One copy will be returned following approval. See additional instructions in Rules and Regulations of the Commission. If State Land submit 6 Copies Attach Form C-128 in triplicate to first 3 copies of form C-101

Hobbs, New Mexico  
(Place)

March 14, 1962  
(Date)

OIL CONSERVATION COMMISSION  
SANTA FE, NEW MEXICO

Gentlemen:

You are hereby notified that it is our intention to commence the Drilling of a well to be known as

Pan American Petroleum Corporation  
(Company or Operator)

State "CL"  
(Lease)

Well No. 2, in M (Unit)

located 990 feet from the South line and 852 feet from the

West

line of Section 6, T. 18S, R. 34E, NMPM.

(GIVE LOCATION FROM SECTION LINE)

Vacuum Queen Pool, Lea County

If State Land the Oil and Gas Lease is No. E-8713

If patented land the owner is

Address

We propose to drill well with drilling equipment as follows: Surface to TD with rotary tools

The status of plugging bond is Blanket bond on file with Commission

Drilling Contractor Cactus Drilling Co.  
San Angelo, Texas

We intend to complete this well in the Queen formation at an approximate depth of 4500 feet.

### CASING PROGRAM

We propose to use the following strings of Casing and to cement them as indicated:

Size of Hole	Size of Casing	Weight per Foot	New or Second Hand	Depth	Sacks Cement
<u>12-1/4"</u>	<u>8-5/8"</u>	<u>22.7#</u>	<u>New</u>	<u>330'</u>	<u>350 sx</u>
<u>7-7/8"</u>	<u>4-1/2"</u>	<u>9.5#</u>	<u>New</u>	<u>4300'</u>	<u>320 sx</u>

If changes in the above plans become advisable we will notify you immediately.

ADDITIONAL INFORMATION (If recompletion give full details of proposed plan of work.)

Approved....., 19.....  
Except as follows:

OIL CONSERVATION COMMISSION

By.....

Sincerely yours,

Pan American Petroleum Corporation  
(Company or Operator)

By.....

Original Signed  
**V. E. STALEY**

Position Area Superintendent

Send Communications regarding well to

Name V. E. Staley

Address Box 68 - Hobbs, New Mexico

**NEW MEXICO OIL CONSERVATION COMMISSION**  
**WELL LOCATION AND ACREAGE DEDICATION PLAT**

FORM C-128  
 Revised 5/1/57

SEE INSTRUCTIONS FOR COMPLETING THIS FORM ON THE REVERSE SIDE

**SECTION A**

Operator <b>Pan American Petroleum Co.</b>			Lease <b>State "CL"</b>		Well No. <b>2</b>
Unit Letter <b>M</b>	Section <b>6</b>	Township <b>18 South</b>	Range <b>34 East</b>	County <b>Lea</b>	
Actual Footage Location of Well: <b>990</b> feet from the <b>South</b> line and <b>852</b> feet from the <b>West</b> line					
Ground Level Elev. <b>5250</b>	Producing Formation <b>Permian</b>	Pool <b>Vacuum</b>	Dedicated Acreage: <b>1.00</b> Acres		

1. Is the Operator the only owner in the dedicated acreage outlined on the plat below? YES \_\_\_\_\_ NO \_\_\_\_\_. ("Owner" means the person who has the right to drill into and to produce from any pool and to appropriate the production either for himself or for himself and another. (65-3-29 (e) NMSA 1935 Comp.)
2. If the answer to question one is "no," have the interests of all the owners been consolidated by communitization agreement or otherwise? YES \_\_\_\_\_ NO \_\_\_\_\_. If answer is "yes," Type of Consolidation \_\_\_\_\_
3. If the answer to question two is "no," list all the owners and their respective interests below:

Owner	Land Description

**SECTION B**

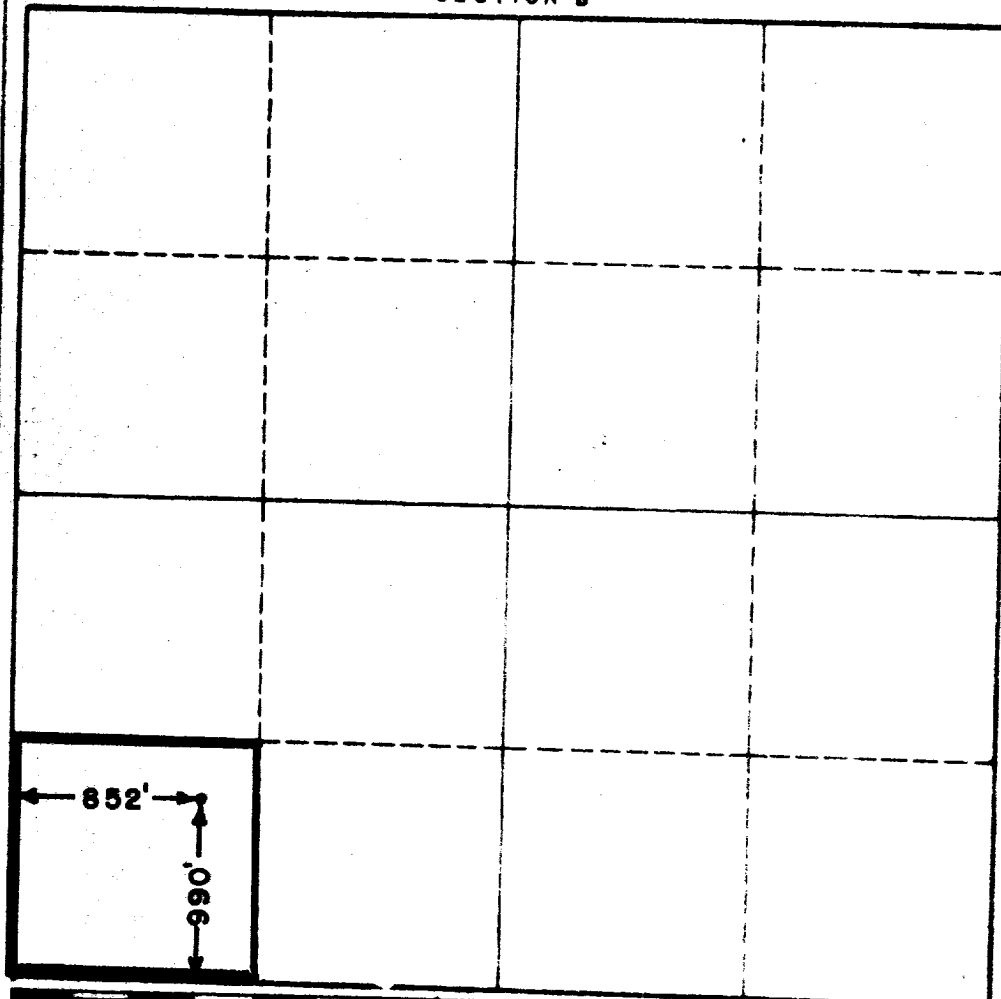

**CERTIFICATION**

I hereby certify that the information in SECTION A above is true and complete to the best of my knowledge and belief.

Name Original Signed by: <b>V. E. STALEY</b>
Position <b>Area Superintendent</b>
Company <b>Pan American Pet. Corp.</b>
Date <b>March 14, 1962</b>

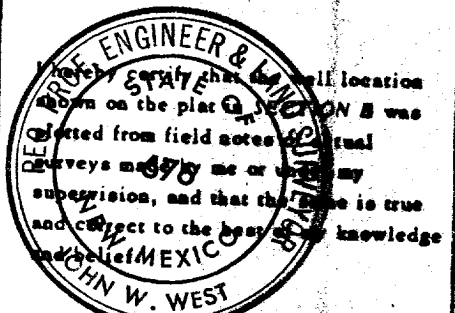

Date Surveyed <b>3-9-62</b>
Registered Professional Engineer and/or Land Surveyor, <b>JOHN W. WEST</b>
Certificate No. <b>N. M. - P. E. &amp; L. S. NO. 678</b>