

SANTA FE	
FILE	
U.S.G.S.	
LAND OFFICE	
TRANSPORTER	OIL
	GAS
PRORATION OFFICE	
OPERATOR	

**NEW MEXICO OIL CONSERVATION COMMISSION**  
**Santa Fe, New Mexico**

Form G-101  
Revised (12/1/55)

**NOTICE OF INTENTION TO DRILL**

Notice must be given to the District Office of the Oil Conservation Commission and approval obtained before drilling or recompletion begins. If changes in the proposed plan are considered advisable, a copy of this notice showing such changes will be returned to the sender. Submit this notice in **QUINTUPPLICATE**. One copy will be returned following approval. See additional instructions in Rules and Regulations of the Commission.

If State Land submit 6 Copies Attach Form G-101 to first 3 copies of form G-101

**Hobbs, New Mexico**

(Place)

**June 27, 1962**

(Date)

OIL CONSERVATION COMMISSION  
SANTA FE, NEW MEXICO

Gentlemen:

You are hereby notified that it is our intention to commence the Drilling of a well to be known as

**Pan American Petroleum Corporation**

(Company or Operator)

**State "CL"**

(Lease)

Well No. **4**, in **0** (Unit) The well is

located **660** feet from the **South** line and **2310** feet from the

**East** line of Section **6**, T. **18S**, R. **34E**, NMPM.

(GIVE LOCATION FROM SECTION LINE) **Vacuum Queen** Pool, **Lea** County

If State Land the Oil and Gas Lease is No. **E-8714**

If patented land the owner is

Address

We propose to drill well with drilling equipment as follows: **Surface to total depth with rotary tools.**

The status of plugging bond is **Blanket bond on file with Commission.**

Drilling Contractor **Cactus Drilling Company**  
**San Angelo, Texas**

We intend to complete this well in the **Queen** formation at an approximate depth of **4400** feet.

**CASING PROGRAM**

We propose to use the following strings of Casing and to cement them as indicated:

Size of Hole	Size of Casing	Weight per Foot	New or Second Hand	Depth	Sacks Cement
<b>11"</b>	<b>8 5/8"</b>	<b>22.7</b>	<b>New</b>	<b>300'</b>	<b>Circulate</b>
<b>7 7/8"</b>	<b>4 1/2"</b>	<b>9.5</b>	<b>New</b>	<b>4300'</b>	<b>320 Sx.</b>

If changes in the above plans become advisable we will notify you immediately.

**ADDITIONAL INFORMATION** (If recompletion give full details of proposed plan of work.)

Approved....., 19.....  
Except as follows:

Sincerely yours,

**Pan American Petroleum Corporation**

(Original Signed Company or Operator)

By **V. E. STALEY**

Position **Area Superintendent**

Send Communications regarding well to

Name **V. E. Staley**

Address **Box 68 Hobbs, New Mexico**

OIL CONSERVATION COMMISSION

By **Leslie A. Clements**

# NEW MEXICO OIL CONSERVATION COMMISSION WELL LOCATION AND ACREAGE DEDICATION PLAT

FORM C-128  
Revised 5/1/57

SEE INSTRUCTIONS FOR COMPLETING THIS FORM ON THE REVERSE SIDE

## SECTION A

Operator <b>PAN AMERICAN OIL CORP.</b>			Lease <b>STATE "CL" #</b>		Well No. <b>4</b>
Unit Letter <b>O</b>	Section <b>6</b>	Township <b>18 SOUTH</b>	Range <b>34 EAST</b>	County <b>LEA</b>	
Actual Footage Location of Well: <b>660</b> feet from the <b>SOUTH</b> line and <b>2310</b> feet from the <b>EAST</b> line					
Ground Level Elev. <b>524</b>	Producing Formation <b>Galena</b>		Pool <b>Vacuum Queen</b>		Dedicated Acreage: <b>1.4</b> Acres

1. Is the Operator the only owner in the dedicated acreage outlined on the plat below? YES ☒ NO ☐ ("Owner" means the person who has the right to drill into and to produce from any pool and to appropriate the production either for himself or for himself and another. (65-3-29 (e) NMSA 1935 Comp.)
2. If the answer to question one is "no," have the interests of all the owners been consolidated by communitization agreement or otherwise? YES ☐ NO ☐ If answer is "yes," Type of Consolidation \_\_\_\_\_
3. If the answer to question two is "no," list all the owners and their respective interests below:

Owner	Land Description

## SECTION B

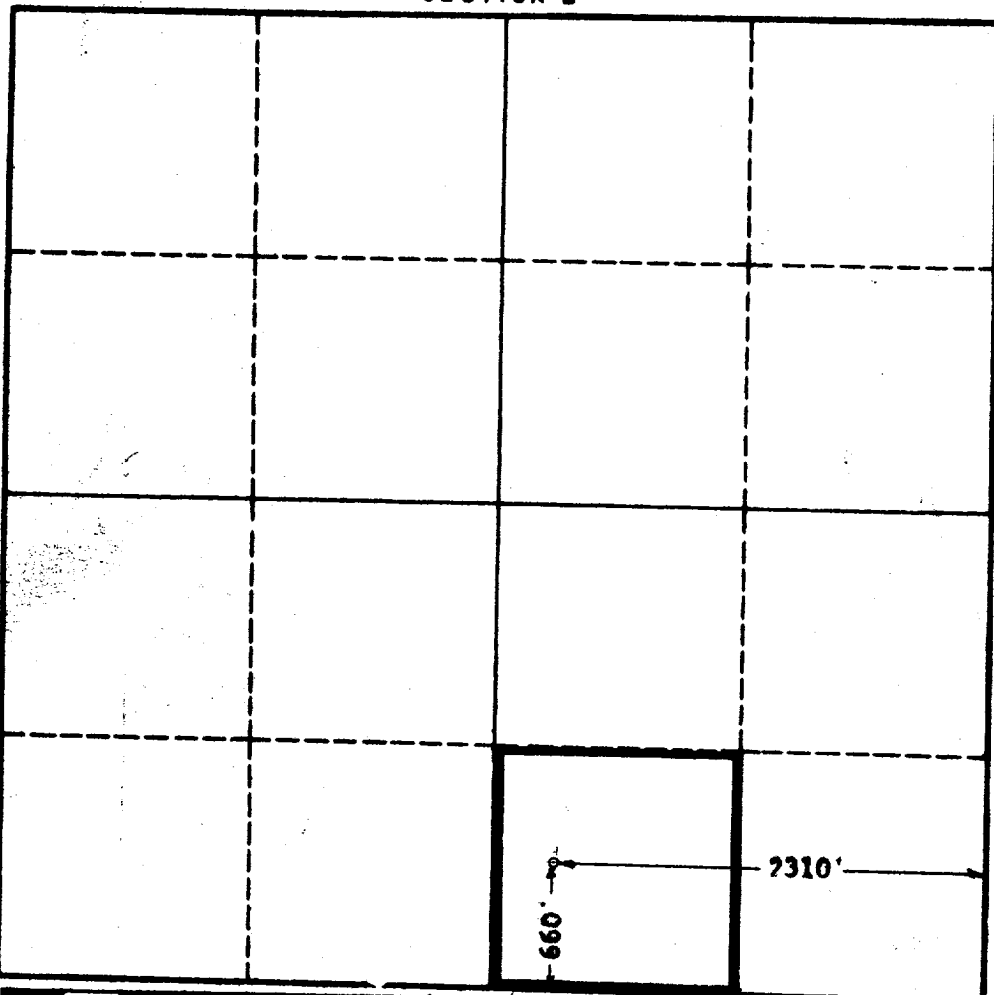

## CERTIFICATION

I hereby certify that the information in SECTION A above is true and complete to the best of my knowledge and belief.

Name Original signed by  
**V. E. STALEY**

Position  
**Area Superintendent**

Company  
**Pan American Petroleum Corp.**

Date  
**6/27/62**

I hereby certify that the well location shown on the plat in SECTION B was plotted from field notes of a survey made by me or under my supervision, and that the same is true and correct to the best of my knowledge and belief.

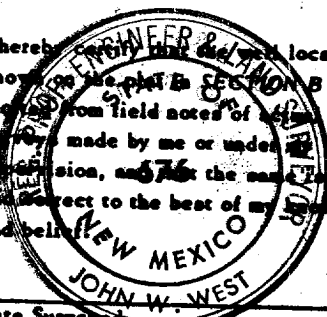

Date Surveyed  
**6-23-62**

Registered Professional Engineer and/or Land Surveyor, **JOHN W. WEST**

*John W. West*

Certificate No. **N.M. - P.E. & L.S. NO. 676**