

NO. OF COPIES RECEIVED	
DISTRIBUTION	
SANTA FE	
FILE	
U.S.G.S.	
LAND OFFICE	
OPERATOR	

5A. Indicate Type of Lease
STATE <input checked="" type="checkbox"/> FEE <input type="checkbox"/>
5. State Oil & Gas Lease No.
LG- 3406

## APPLICATION FOR PERMIT TO DRILL, DEEPEN, OR PLUG BACK

1a. Type of Work	XXXX <input checked="" type="checkbox"/> RE-ENTER	DEEPEN <input type="checkbox"/>	PLUG BACK <input type="checkbox"/>
b. Type of Well	OIL WELL <input checked="" type="checkbox"/>	GAS WELL <input type="checkbox"/>	OTHER <input type="checkbox"/>
2. Name of Operator	GENERAL OPERATING COMPANY		
3. Address of Operator	SUITE 1007, RIDGLEA BANK BUILDING, FORT WORTH, TEXAS 76116		
4. Location of Well	UNIT LETTER <u>D</u> LOCATED <u>660</u> FEET FROM THE <u>NORTH</u> LINE		
AND <u>661.5</u> FEET FROM THE <u>WEST</u> LINE OF SEC. <u>17</u> TWP. <u>18-S</u> RGE. <u>34-E</u> NMPM			
12. County	LEA		
19. Proposed Depth	4490	19A. Formation	QUEEN
20. Rotary or C.T.	ROTARY		
21. Elevations (Show whether DT, RT, etc.)	4080 RT	21A. Kind & Status Plug. Bond	BLANKET
21B. Drilling Contractor	NOT SELECTED		
22. Approx. Date Work will start	UPON APPROVAL		

23.

## PROPOSED CASING AND CEMENT PROGRAM

SIZE OF HOLE	SIZE OF CASING	WEIGHT PER FOOT	SETTING DEPTH	SACKS OF CEMENT	EST. TOP
12-1/4"	*8-5/8"	22.7#	254'	200	SURFACE
7-7/8"	*5-1/2"	14#	4490'	1000	2170'

\*THIS CASING SET AND CEMENTED WHEN WELL DRILLED ORIGINALLY. HOWEVER, WHEN WELL WAS PLUGGED AND ABANDONED, 5-1/2" CASING WAS CUT AND PULLED FROM A DEPTH OF 1984 FEET.

PLANS ARE TO DRILL OUT PLUGS AND CLEAN OUT TO TOP OF 5-1/2" CASING STUB AND EXTEND 5-1/2" CASING TO SURFACE. 5-1/2" CASING WILL BE CEMENTED FROM THIS POINT TO SURFACE WITH APPROXIMATELY 300 SACKS OF CEMENT. WILL THEN DRILL OUT REMAINING CEMENT PLUG AND CLEAN OUT TO ORIGINAL TOTAL DEPTH OF 4490 FEET TO TEST THE QUEEN FORMATION.

THIS WELL WAS DRILLED ORIGINALLY BY THE ATLANTIC REFINING COMPANY AS WELL NUMBER 1 STATE "AJ", AND WAS PLUGGED AND ABANDONED AUGUST 26, 1965.

SEE ATTACHED FOR BOP SKETCH.

IN ABOVE SPACE DESCRIBE PROPOSED PROGRAM: IF PROPOSAL IS TO DEEPEN OR PLUG BACK, GIVE DATA ON PRESENT PRODUCTIVE ZONE AND PROPOSED NEW PRODUCTIVE ZONE. GIVE BLOWOUT PREVENTER PROGRAM, IF ANY.

I hereby certify that the information above is true and complete to the best of my knowledge and belief.

Signed Arthur R. Brown Title Agent Date FEBRUARY 20, 1986  
(This space for State Use)

ORIGINAL SIGNED BY JERRY SIXTON

APPROVED BY DISTRICT 1 SUPERVISOR TITLE \_\_\_\_\_ DATE FEB 20 1986

CONDITIONS OF APPROVAL, IF ANY:

REC

FEB 20 1986

O.C.D.  
HOBBS OFFICE

## L CONSERVATION DIVISIO

P. O. BOX 2088

Form C-102  
Revised 10-1-78STATE OF NEW MEXICO  
ENERGY AND MINERALS DEPARTMENT

SANTA FE, NEW MEXICO 87501

All distances must be from the outer boundaries of the Section.

Operator GENERAL OPERATING COMPANY		Lease STATE "AJ"		Well No. 1	
Init Letter D	Section 17	Township 18 SOUTH	Range 34 EAST	County LEA	
Actual Footage Location of Well: 660 feet from the NORTH line and 661.5 feet from the WEST line					
Ground Level Elev. 4080 RT	Producing Formation QUEEN		Pool EK YATES SEVEN RIVERS QUEEN		Dedicated Acreage: 40 Acres

1. Outline the acreage dedicated to the subject well by colored pencil or hatchure marks on the plat below.
2. If more than one lease is dedicated to the well, outline each and identify the ownership thereof (both as to working interest and royalty).
3. If more than one lease of different ownership is dedicated to the well, have the interests of all owners been consolidated by communitization, unitization, force-pooling, etc?

☐ Yes ☐ No If answer is "yes," type of consolidation \_\_\_\_\_

If answer is "no," list the owners and tract descriptions which have actually been consolidated. (Use reverse side of this form if necessary.) \_\_\_\_\_

No allowable will be assigned to the well until all interests have been consolidated (by communitization, unitization, forced-pooling, or otherwise) or until a non-standard unit, eliminating such interests, has been approved by the Division.

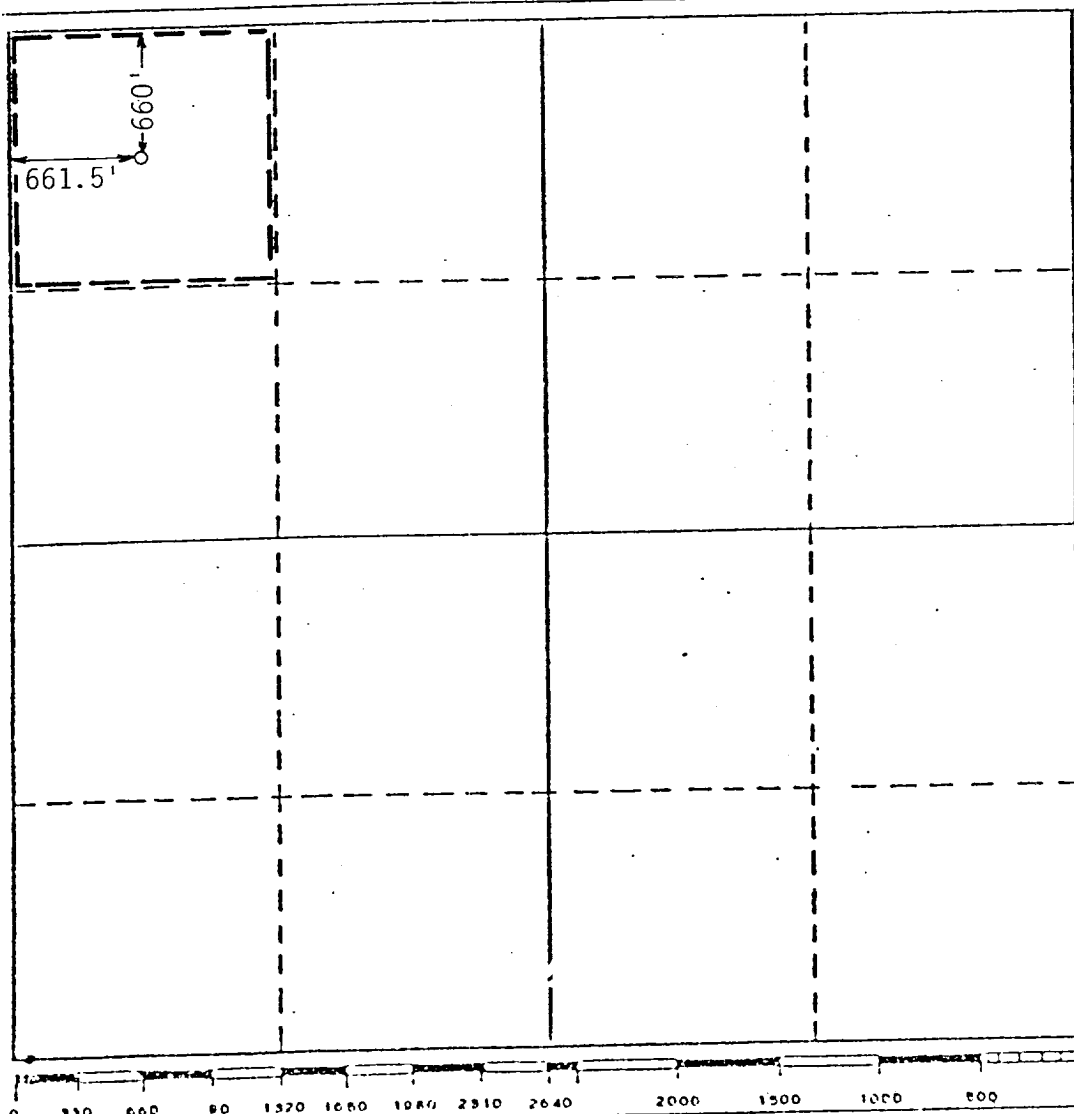

## CERTIFICATION

I hereby certify that the information contained herein is true and complete to the best of my knowledge and belief.

Name Arthur R. Brown  
Position  
Agent  
Company  
GENERAL OPERATING COMPANY  
Date  
FEBRUARY 19, 1986

I hereby certify that the well location shown on this plat was plotted from field notes of actual surveys made by me or under my supervision, and that the same is true and correct to the best of my knowledge and belief.

Date Surveyed  
FEBRUARY 21, 1986  
Registered Professional Engineer  
and/or Land Surveyor

SEE ORIGINAL PLAT

Certificate No.

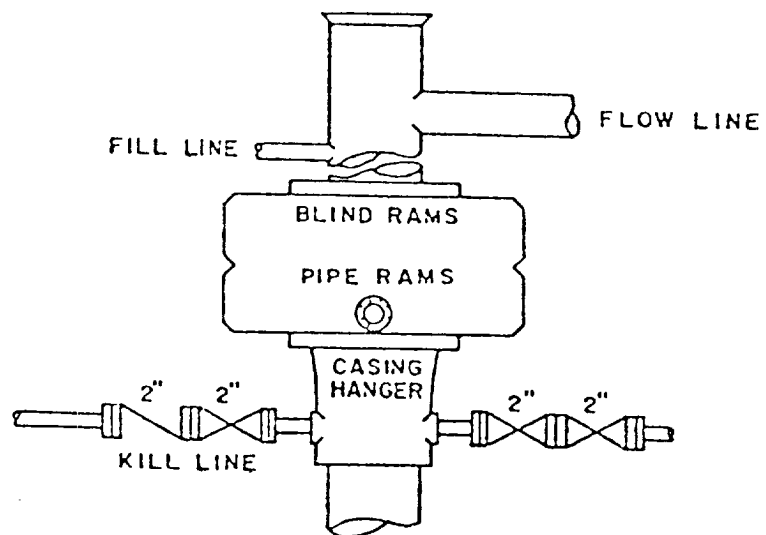

BOP STACK

2000 PSI WORKING PRESSURE

BOP ARRANGEMENT