

NO. OF COPIES RECEIVED		
DISTRIBUTION		
STATE FEE		
FILE		
U.S.G.S.		
LAND OFFICE		
OPERATOR		

NEW MEXICO OIL CONSERVATION COMMISSION

Form C-101
Revised 1-1-65

5A. Indicate Type of Lease	
STATE <input type="checkbox"/>	FEE <input checked="" type="checkbox"/>
5. State Oil & Gas Lease No.	

APPLICATION FOR PERMIT TO DRILL, DEEPEN, OR PLUG BACK

1a. Type of Work		7. Unit Agreement Name	
b. Type of Well DRILL <input type="checkbox"/> Re-enter <input checked="" type="checkbox"/> DEEPEN <input type="checkbox"/> PLUG BACK <input type="checkbox"/> OIL WELL <input checked="" type="checkbox"/> GAS WELL <input type="checkbox"/> OTHER <input type="checkbox"/> SINGLE ZONE <input checked="" type="checkbox"/> MULTIPLE ZONE <input type="checkbox"/>		8. Farm or Lease Name Quebedeaux	
2. Name of Operator V. H. Westbrook		9. Well No. 1	
3. Address of Operator P. O. Box 2264, Hobbs, New Mexico 88240		10. Field and Pool, or Wildcat Vacuum San Andres	
4. Location of Well UNIT LETTER A LOCATED 330 FEET FROM THE North LINE AND 990 FEET FROM THE East LINE OF SEC. 2 TWP. 18S RGE. 35E NMPM		12. County Lea	
19. Proposed Depth 5200		19A. Formation San Andres	
20. Rotary or C.T. Rotary		21. Elevations (Show whether DF, RT, etc.) 3891.6 GL	
21A. Kind & Status Plug. Road Blanket		21B. Drilling Contractor Pulling unit-Select	
22. Approx. Date Work will start 12-17-74			

PROPOSED CASING AND CEMENT PROGRAM

SIZE OF HOLE	SIZE OF CASING	WEIGHT PER FOOT	SETTING DEPTH	SACKS OF CEMENT	EST. TOP
17"	13 3/8"	48#	320'	330	Circ.
11"	8 5/8"	24# & 32#	3499'	1365	Circ.
7 7/8"	5 1/2"	15.5 c 17#	9259'	700	3500'

We propose to re-enter well and complete in the following manner.

1. Drill out 10 sk plug at surface, 25 sk plug at 2888'.
2. Dress 5 1/2" casing at 2888' and drill out 25 sk plug at 4832-44 and circulate mud out of hole from C. I. B. P. at 5200'.
3. Perforate San Andres section at 5062'-72'.
4. Treat w/1000 gallons 15% HCL Acid and swab test.

IN ABOVE SPACE DESCRIBE PROPOSED PROGRAM: IF PROPOSAL IS TO DEEPEN OR PLUG BACK, GIVE DATA ON PRESENT PRODUCTIVE ZONE AND PROPOSED NEW PRODUCTIVE ZONE. GIVE BLOWOUT PREVENTER PROGRAM, IF ANY.

I hereby certify that the information above is true and complete to the best of my knowledge and belief.

Signed *V. H. Westbrook* Title Operator Date 12-16-74

(This space for State Use)

APPROVED BY *[Signature]* TITLE SECRETARY DATE

CONDITIONS OF APPROVAL, IF ANY:

**NEW XICO OIL CONSERVATION COMMISSION
WELL LOCATION AND ACREAGE DEDICATION PLAT**

Form C-102
Supersedes C-128
Effective 1-1-65

All distances must be from the outer boundaries of the Section.

Operator V. H. Westbrook			Lease Quebedeaux			Well No. 1		
Unit Letter A	Section 2	Township 18 South		Range 35 East	County Lea			
Actual Footage Location of Well:								
330 feet from the North line and			990 feet from the East line					
Ground Level Elev. 3891.6		Producing Formation Abo		Pool Undesignated			Dedicated Acreage: 40 Acres	

1. Outline the acreage dedicated to the subject well by colored pencil or hachure marks on the plat below.
2. If more than one lease is dedicated to the well, outline each and identify the ownership thereof (both as to working interest and royalty).
3. If more than one lease of different ownership is dedicated to the well, have the interests of all owners been consolidated by communitization, unitization, force-pooling, etc?

☐ Yes ☐ No If answer is "yes," type of consolidation _____

If answer is "no," list the owners and tract descriptions which have actually been consolidated. (Use reverse side of this form if necessary.) _____

No allowable will be assigned to the well until all interests have been consolidated (by communitization, unitization, forced-pooling, or otherwise) or until a non-standard unit, eliminating such interests, has been approved by the Commission.

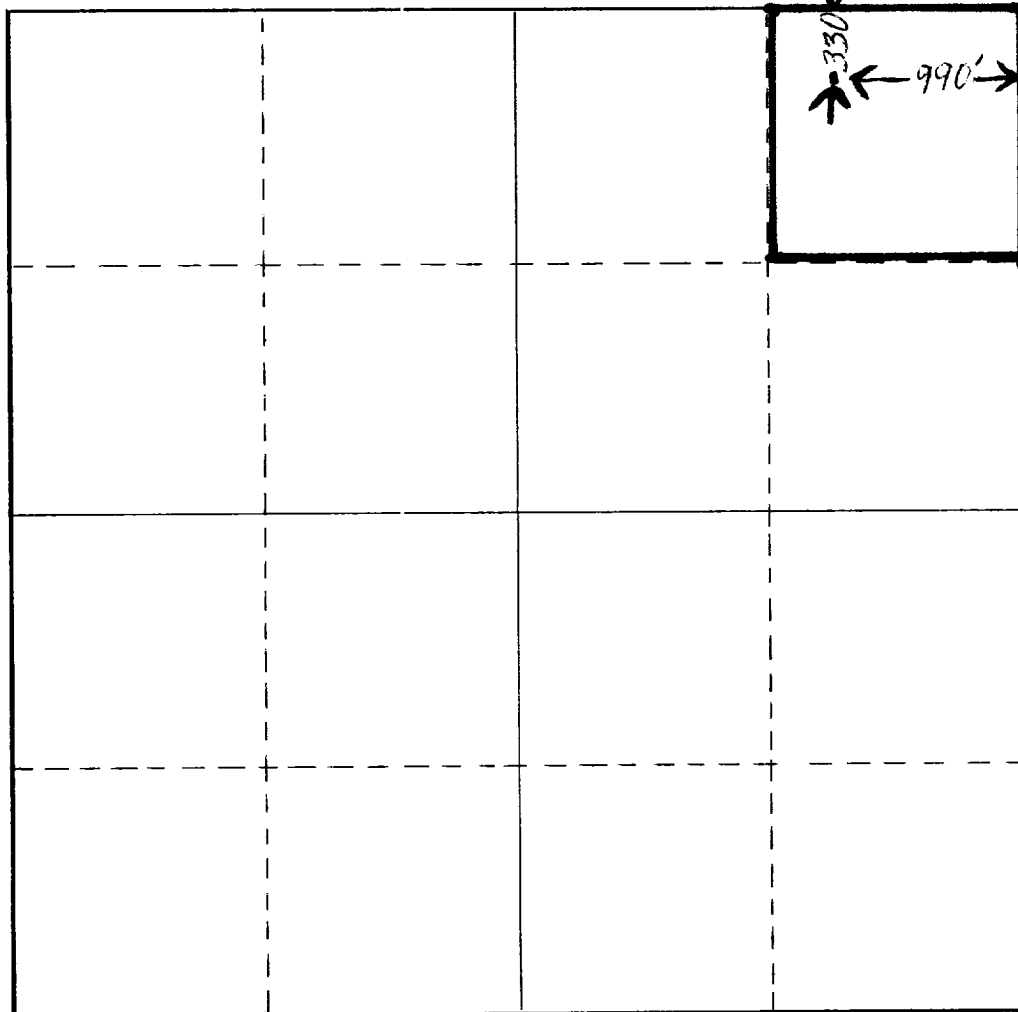

CERTIFICATION

I hereby certify that the information contained herein is true and complete to the best of my knowledge and belief.

V. H. Westbrook
 Name
General Manager
 Position
V. H. Westbrook
 Company
12-16-74
 Date

I hereby certify that the well location shown on this plat was plotted from field notes of actual surveys made by me or under my supervision, and that the same is true and correct to the best of my knowledge and belief.

Date Surveyed
10-5-61
 Registered Professional Engineer
 and/or Land Surveyor

Certificate No. _____

