

District I
1625 N. French Dr., Hobbs, NM 88240
District II
811 S. 1st Street, Artesia, NM 88210
District III
1000 Rio Brazos Rd., Aztec, NM 87410
District IV
2040 South Pacheco, Santa Fe, NM 87505

State of New Mexico
Energy, Minerals & Natural Resources

Form C-101
Revised March 17, 1999

Oil Conservation Division
2040 South Pacheco
Santa Fe, NM 87505

Submit to appropriate District Office
State Lease - 6 Copies
Fee Lease - 5 Copies

☐ AMENDED REPORT

APPLICATION FOR PERMIT TO DRILL, RE-ENTER, DEEPEN, PLUGBACK, OR ADD A ZONE

¹ Operator Name and Address PHILLIPS PETROLEUM COMPANY 4001 PENBROOK STREET, ODESSA, TEXAS 79762		² OGRID Number 017643
		³ API Number 30- 025-03058
⁴ Property Code 9166	⁵ Property Name VACUUM GB/SA UNIT EAST TRACT #0524	⁶ Well No. 036

⁷ Surface Location

UL or lot no.	Section	Township	Range	Lot. Idn	Feet from the	North/South Line	Feet from the	East/West line	County
C	5	18-S	35-E		660	NORTH	1980	WEST	LEA

⁸ Proposed Bottom Hole Location If Different From Surface

UL or lot no.	Section	Township	Range	Lot. Idn	Feet from the	North/South Line	Feet from the	East/West line	County
D	5	18-S	35-E		660	NORTH	360	WEST	LEA

⁹ Proposed Pool 1 VACUUM GRAYBURG SAN ANDRES	¹⁰ Proposed Pool 2
--	-------------------------------

¹¹ Work Type Code P	¹² Well Type Code 0	¹³ Cable/Rotary R	¹⁴ Lease Type Code S	¹⁵ Ground Level Elevation 3960' G.L., 3971' RKB
¹⁶ Multiple	¹⁷ Proposed Depth 6125.65' MD/4697' TVD	¹⁸ Formation SAN ANDRES	¹⁹ Contractor SPERRY SUN	²⁰ Spud Date UPON APPROVAL

²¹ Proposed Casing and Cement Program

Hole Size	Casing Size	Casing weight/foot	Setting Depth	Sacks of Cement	Estimated TOC
12-1/4"	9-5/8"	24.5#	1561.4'	650	SURFACE
8-3/4"	7"	24#	4122'	400	1500' CALC.

²² Describe the proposed program. If this application is to DEEPEN or PLUG BACK, give the data on the present productive zone and proposed new productive zone.

Describe the blowout prevention program, if any. Use additional sheets if necessary.

Plug back well to 4395' and kickoff with 6-1/8" hole.

K.O.P. @ 4395'

Drill a 1620' 6-1/8" lateral hole to 6125.65' M.D. at an 85.38 degree angle of inclination.

Permit Expires 1 Year From Approval
Date Unless Drilling Underway

Plug-Back

²³ I hereby certify that the information given above is true and complete to the best of my knowledge and belief.

Signature: *L. M. Sanders*

Printed name: L. M. SANDERS

Title: SUPV., REGULATION/PRORATION

Date: 05/06/01

Phone: 915/368-1488

OIL CONSERVATION DIVISION

Approved by:

Title:

Approval Date:

Expiration Date:

Conditions of Approval:

Attached ☐

Lea Co., New Mexico
East Vacuum Unit
Sec. 5, T18S-R35E
EVGSAU 0524-036

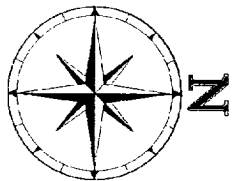

TRUE NORTH

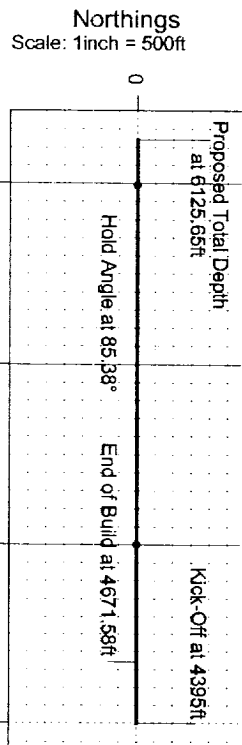

Proposal Data for Plan-02.15.01

Vertical Origin :		Well					
Horizontal Origin :		Well					
Measurement Units :		ft					
North Reference :		True North					
Dogleg severity : Degrees per 100 feet							
Vertical Section Azimuth :		270.000°					
Vertical Section Description:		Well					
Vertical Section Origin :		0.00 N,0.00 E					
Measured Depth	Incl.	Azim.	Vertical Depth	Northings	Eastings	Vertical Section	Dogleg Rate
4395.00	0.000	359.178	4395.00	0.00 N	0.00 E	0.00	30.87
4671.58	85.380	270.000	4580.00	0.00 N	170.65 W	170.65	0.00
6125.65	85.380	270.000	4697.12	0.00 N	1620.00 W	1620.00	0.00

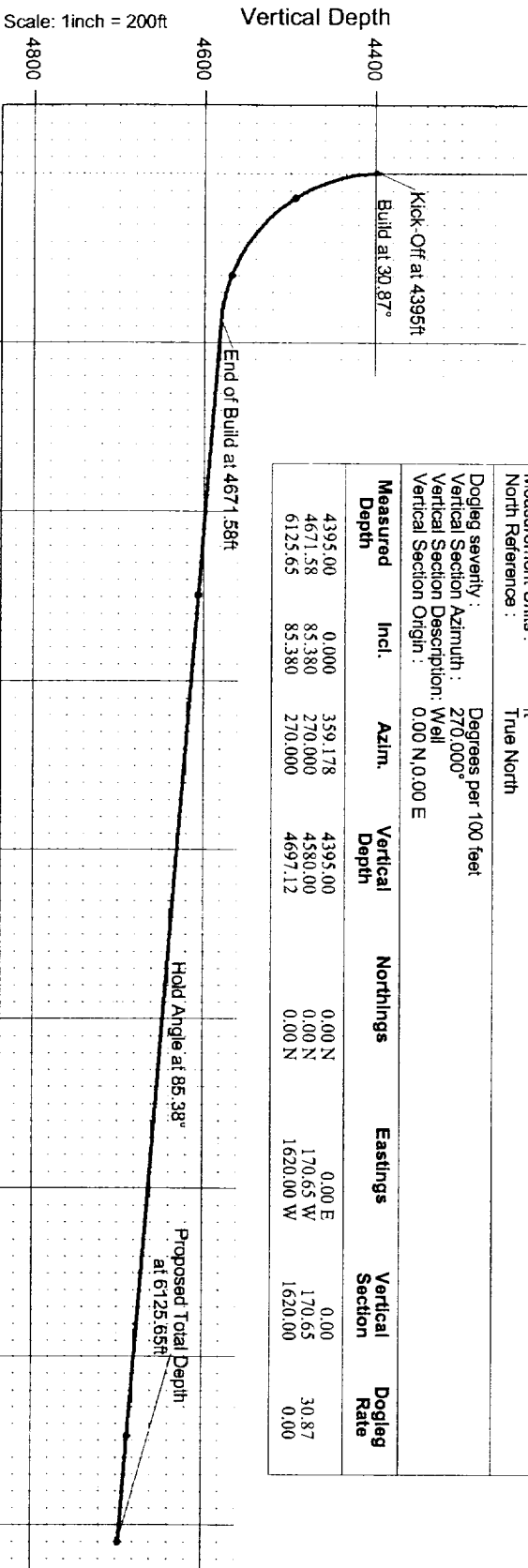

Vertical Section

Section Azimuth: 270.000° (True North)

Prepared by: Deane Durham
Date/Time: 15-February, 2001 - 15:19

Sperry-Sun Drilling Services
 Proposal Report for EVGSAU 0524-036 - Plan-02.15.01
 Your Ref: Proposal #1



**Phillips Petroleum
 Lea Co., New Mexico**

**East Vacuum Unit
 Sec. 5, T18S-R35E**

Measured Depth (ft)	Incl.	Azim.	Vertical Depth (ft)	Northings (ft)	Eastings (ft)	Vertical Section (ft)	Dogleg Rate (°/100ft)
4395.00	0.000	0.000	4395.00	0.00 N	0.00 E	0.00	
4400.00	1.544	270.000	4400.00	0.00 N	0.07 W	0.07	30.87
4420.00	7.718	270.000	4419.92	0.00 N	1.68 W	1.68	30.87
4440.00	13.892	270.000	4439.56	0.00 N	5.43 W	5.43	30.87
4460.00	20.066	270.000	4458.68	0.00 N	11.27 W	11.27	30.87
4480.00	26.240	270.000	4477.06	0.00 N	19.13 W	19.13	30.87
4500.00	32.414	270.000	4494.49	0.00 N	28.92 W	28.92	30.87
4520.00	38.588	270.000	4510.76	0.00 N	40.53 W	40.53	30.87
4540.00	44.762	270.000	4525.69	0.00 N	53.82 W	53.82	30.87
4560.00	50.936	270.000	4539.11	0.00 N	68.64 W	68.64	30.87
4580.00	57.110	270.000	4550.85	0.00 N	84.81 W	84.81	30.87
4600.00	63.284	270.000	4560.79	0.00 N	102.16 W	102.16	30.87
4620.00	69.458	270.000	4568.80	0.00 N	120.47 W	120.47	30.87
4640.00	75.632	270.000	4574.80	0.00 N	139.54 W	139.54	30.87
4660.00	81.806	270.000	4578.71	0.00 N	159.15 W	159.15	30.87
4671.58	85.380	270.000	4580.00	0.00 N	170.65 W	170.65	30.87
5000.00	85.380	270.000	4606.45	0.00 N	498.01 W	498.01	0.00
6000.00	85.380	270.000	4687.00	0.00 N	1494.76 W	1494.76	0.00
6125.65	85.380	270.000	4697.12	0.00 N	1620.00 W	1620.00	0.00

All data is in Feet unless otherwise stated. Directions and coordinates are relative to True North.
 Vertical depths are relative to Well. Northings and Eastings are relative to Well.

Magnetic Declination at Surface is 10.423° (15-Feb-01)

The Dogleg Severity is in Degrees per 100 feet.

Vertical Section is from Well and calculated along an Azimuth of 270.000° (True).

Based upon Minimum Curvature type calculations, at a Measured Depth of 6125.65ft.,
 The Bottom Hole Displacement is 1620.00ft., in the Direction of 270.000° (True).

Comments

Measured Depth (ft)	Station Coordinates			Comment
	TVD (ft)	Northings (ft)	Eastings (ft)	
4395.00	4395.00	0.00 N	0.00 E	Kick-Off at 4395ft
4410.00	4409.98	0.00 N	0.61 W	Build at 30.87°
4671.58	4580.00	0.00 N	170.65 W	End of Build at 4671.58ft
5398.61	4638.56	0.00 N	895.33 W	Hold Angle at 85.38°
6125.65	4697.12	0.00 N	1620.00 W	Proposed Total Depth at 6125.65ft

District I
1625 N. French Dr., Hobbs, NM 88240

District II
811 S. 1st Street, Artesia, NM 88210

District III
1000 Rio Brazos Rd., Aztec, NM 87410

District IV
2040 South Pacheco, Santa Fe, NM 87505

State of New Mexico
Energy, Minerals & Natural Resources

OIL CONSERVATION DIVISION
2040 South Pacheco
Santa Fe, NM 87505

Form C-102
Revised March 17, 1999

Submit to Appropriate District Office
State Lease - 4 Copies
Fee Lease - 3 Copies

☐ AMENDED REPORT

WELL LOCATION AND ACREAGE DEDICATION PLAT

¹ API Number 30-025-03058	² Pool Code 62180	³ Pool Name VACUUM GRAYBURG SAN ANDRES
⁴ Property Code 9166	⁵ Property Name VACUUM GB/SA UNIT EAST TRACT #0524	⁶ Well Number 036
⁷ OGRID No. 017643	⁸ Operator Name PHILLIPS PETROLEUM COMPANY	⁹ Elevation 3960' GL, 3971' KB

¹⁰ Surface Location

UL or lot no. C	Section 5	Township 18-S	Range 35-E	Lot. Idn	Feet from the 660	North/South line NORTH	Feet from the 1980	East/West line WEST	County LEA
--------------------	--------------	------------------	---------------	----------	----------------------	---------------------------	-----------------------	------------------------	---------------

¹¹ Bottom Hole Location If Different From Surface

UL or lot no. D	Section 5	Township 18-S	Range 35-E	Lot. Idn	Feet from the 660	North/South line NORTH	Feet from the 360	East/West line WEST	County LEA
--------------------	--------------	------------------	---------------	----------	----------------------	---------------------------	----------------------	------------------------	---------------

¹² Dedicated Acres 320	¹³ Joint or Infill	¹⁴ Consolidation Code	¹⁵ Order No.
--------------------------------------	-------------------------------	----------------------------------	-------------------------

NO ALLOWABLE WILL BE ASSIGNED TO THIS COMPLETION UNTIL ALL INTERESTS HAVE BEEN CONSOLIDATED OR A
NON-STANDARD UNIT HAS BEEN APPROVED BY THE DIVISION

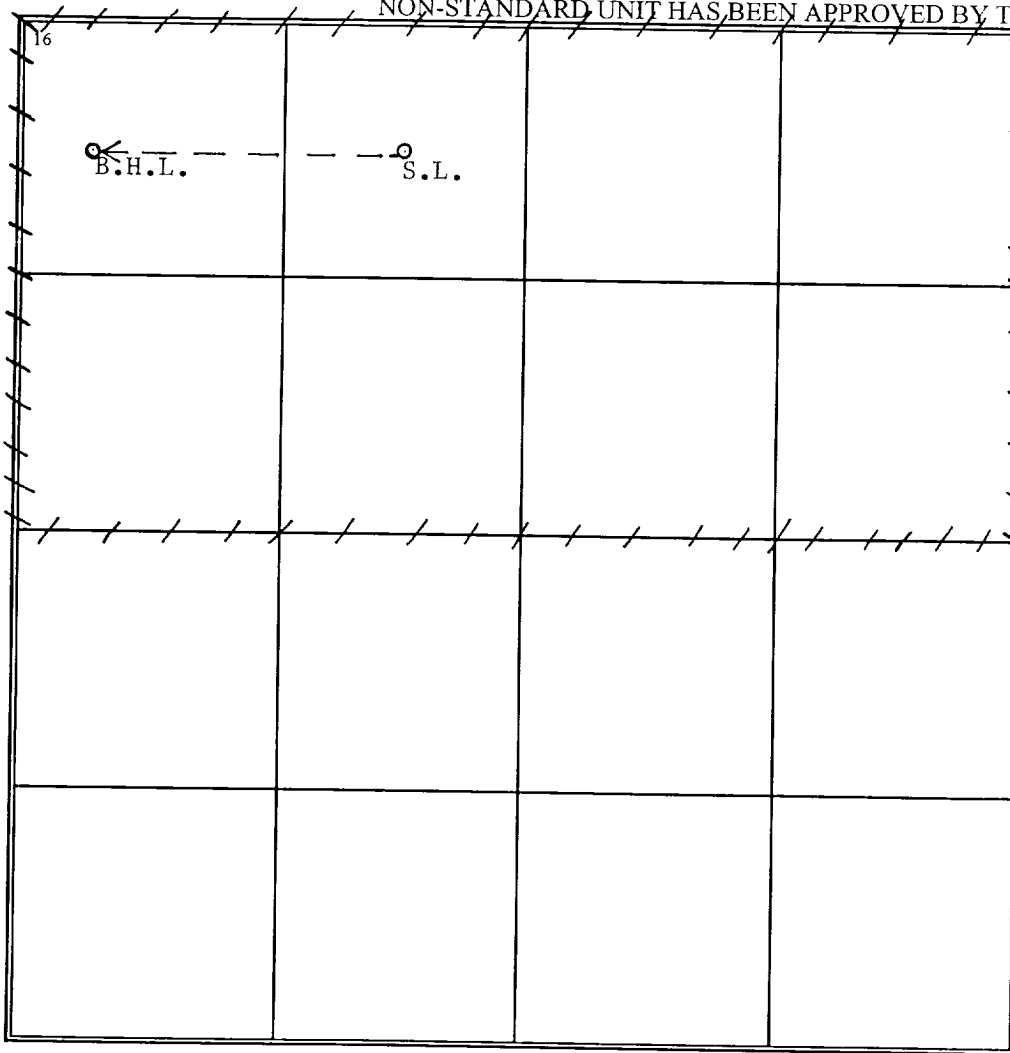
	¹⁷ OPERATOR CERTIFICATION I hereby certify that the information contained herein is true and complete to the best of my knowledge and belief. C. M. Sanders Signature L. M. SANDERS Printed Name SUPV., REGULATION/PRORATION Title 03/06/01 Date
	¹⁸ SURVEYOR CERTIFICATION I hereby certify that the well location shown on this plat was plotted from field notes of actual surveys made by me or under my supervision, and that the same is true and correct to the best of my belief. 11/1939 Date of Survey Signature and Seal of Professional Surveyer: (Location staked & surveyed by Phillips Petroleum Company 11/1939)
	Certificate Number