

Submit to Appropriate  
District Office  
State Lease - 6 copies  
Fee Lease - 5 copies

State of New Mexico  
Energy, Minerals and Natural Resources Department

Form C-101  
Revised 1-1-89

OIL CONSERVATION DIVISION

P.O. Box 2088  
Santa Fe, New Mexico 87504-2088

DISTRICT I  
P.O. Box 1980, Hobbs, NM 88240

DISTRICT II  
P.O. Drawer DD, Artesia, NM 88210

DISTRICT III  
1000 Rio Brazos Rd., Aztec, NM 87410

API NO. (assigned by OCD on New Wells) 30-025-03083	
5. Indicate Type of Lease STATE <input checked="" type="checkbox"/> FEE <input type="checkbox"/>	
6. State Oil & Gas Lease No. 874850	
7. Lease Name or Unit Agreement Name WARN STATE A/C 2	
8. Well No. 9	
9. Pool name or Wildcat VACUUM (DRINKARD)	
10. Proposed Depth 8068'	
11. Formation DRINKARD	
12. Rotary or C.T.	
13. Elevations (Show whether DF, RT, GR, etc.) GL: 3978'	
14. Kind & Status Plug. Bond BLANKET CURRENT	
15. Drilling Contractor	
16. Approx. Date Work will start DECEMBER 15, 1992	
17. PROPOSED CASING AND CEMENT PROGRAM	
SIZE OF HOLE	SIZE OF CASING
WEIGHT PER FOOT	SETTING DEPTH
SACKS OF CEMENT	EST. TOP

APPLICATION FOR PERMIT TO DRILL, DEEPEN, OR PLUG BACK

1a. Type of Work:

DRILL ☐ RE-ENTER ☐ DEEPEN ☐ PLUG BACK ☒

b. Type of Well:

OIL WELL ☒ GAS WELL ☐ OTHER ☐ SINGLE ZONE ☒ MULTIPLE ZONE ☐

2. Name of Operator

Marathon Oil Company

3. Address of Operator

P.O. Box 552 Midland, Tx. 79702

4. Well Location

Unit Letter M : 330 Feet From The SOUTH Line and 914.3 Feet From The WEST Line

Section 6

Township 18-S

Range 35-E

NMPM LEA

County

10. Proposed Depth

8068'

11. Formation

DRINKARD

12. Rotary or C.T.

13. Elevations (Show whether DF, RT, GR, etc.)

GL: 3978'

14. Kind & Status Plug. Bond

BLANKET CURRENT

15. Drilling Contractor

16. Approx. Date Work will start

DECEMBER 15, 1992

17. PROPOSED CASING AND CEMENT PROGRAM

SIZE OF HOLE	SIZE OF CASING	WEIGHT PER FOOT	SETTING DEPTH	SACKS OF CEMENT	EST. TOP

RECOMPLETE TO DRINKARD

1. MIRU PU. ND WELLHEAD. INSTALL & TEST BOPS. POOH W/PRODUCTION EQUIPMENT.
2. SET CIBP @ 8200'. SELECTIVELY PERFORATE DRINKARD @ 7954'-8068'. ACID FRACTURE SAME. SWAB BACK LOAD.
3. SELECTIVELY PERFORATE DRINKARD @ 7871'-7908'. ACID FRACTURE SAME. SWAB BACK LOAD.
4. SELECTIVELY PERFORATE DRINKARD @ 7800'-7841'. ACID FRACTURE SAME. SWAB BACK LOAD.
5. ND BOPS & INSTALL WELLHEAD. RD PU & MOL.

AFTER EVALUATION MAY WANT TO COMMINGLE DRINKARD WITH ABO REEF.

Verbal Approval by  
Jerry Sexton 12/18/92

IN ABOVE SPACE DESCRIBE PROPOSED PROGRAM: IF PROPOSAL IS TO DEEPEN OR PLUG BACK, GIVE DATA ON PRESENT PRODUCTIVE ZONE AND PROPOSED NEW PRODUCTIVE ZONE. GIVE BLOWOUT PREVENTER PROGRAM, IF ANY.

I hereby certify that the information above is true and complete to the best of my knowledge and belief.

SIGNATURE Brent D. Lockhart TITLE ADVANCED ENGINEERING TECH DATE 12/18/92

TYPE OR PRINT NAME BRENT D. LOCKHART TELEPHONE NO. 915-682-1621

(This space for State Use)

ORIGINAL SIGNED BY RAY SMITH

FIELD REP. II

APPROVED BY \_\_\_\_\_ TITLE \_\_\_\_\_ DATE DEC 24 '92

CONDITIONS OF APPROVAL, IF ANY:

Submit to Appropriate  
District Office  
State Lease - 4 copies  
Fee Lease - 3 copies

State of New Mexico  
Energy, Minerals and Natural Resources Department

Form C-102  
Revised 1-1-89

OIL CONSERVATION DIVISION

DISTRICT I  
P.O. Box 1980, Hobbs, NM 88240

P.O. Box 2088  
Santa Fe, New Mexico 87504-2088

DISTRICT II  
P.O. Drawer DD, Artesia, NM 88210

DISTRICT III  
1000 Rio Brazos Rd., Aztec, NM 87410

WELL LOCATION AND ACREAGE DEDICATION PLAT

All Distances must be from the outer boundaries of the section

Operator Marathon Oil Company			Lease Warn State A/C 2		Well No. 9
Unit Letter M	Section 6	Township 18-S	Range 35-E	County Lea	
Actual Footage Location of Well: 330' feet from the South line and 914.3' feet from the West line					
Ground level Elev. 3979'	Producing Formation Vacuum	Pool Drinkard		Dedicated Acreage: 40 Acres	

1. Outline the acreage dedicated to the subject well by colored pencil or hatchure marks on the plat below.

2. If more than one lease is dedicated to the well, outline each and identify the ownership thereof (both as to working interest and royalty).

3. If more than one lease of different ownership is dedicated to the well, have the interest of all owners been consolidated by communitization, unitization, force-pooling, etc.?

☐ Yes

☐ No

If answer is "yes" type of consolidation

If answer is "no" list the owners and tract descriptions which have actually been consolidated. (Use reverse side of this form if necessary.)

No allowable will be assigned to the well until all interests have been consolidated (by communitization, unitization, forced-pooling, or otherwise) or until a non-standard unit, eliminating such interest, has been approved by the Division.

OPERATOR CERTIFICATION

I hereby certify that the information contained herein is true and complete to the best of my knowledge and belief.

Signature

Brent D. Lockhart

Printed Name

Brent D. Lockhart

Position

Advanced Eng. Tech

Company

Marathon Oil Company

Date

December 18, 1992

SURVEYOR CERTIFICATION

I hereby certify that the well location shown on this plat was plotted from field notes of actual surveys made by me or under my supervision, and that the same is true and correct to the best of my knowledge and belief.

Date Surveyed

Signature & Seal of  
Professional Surveyor

Certificate No.

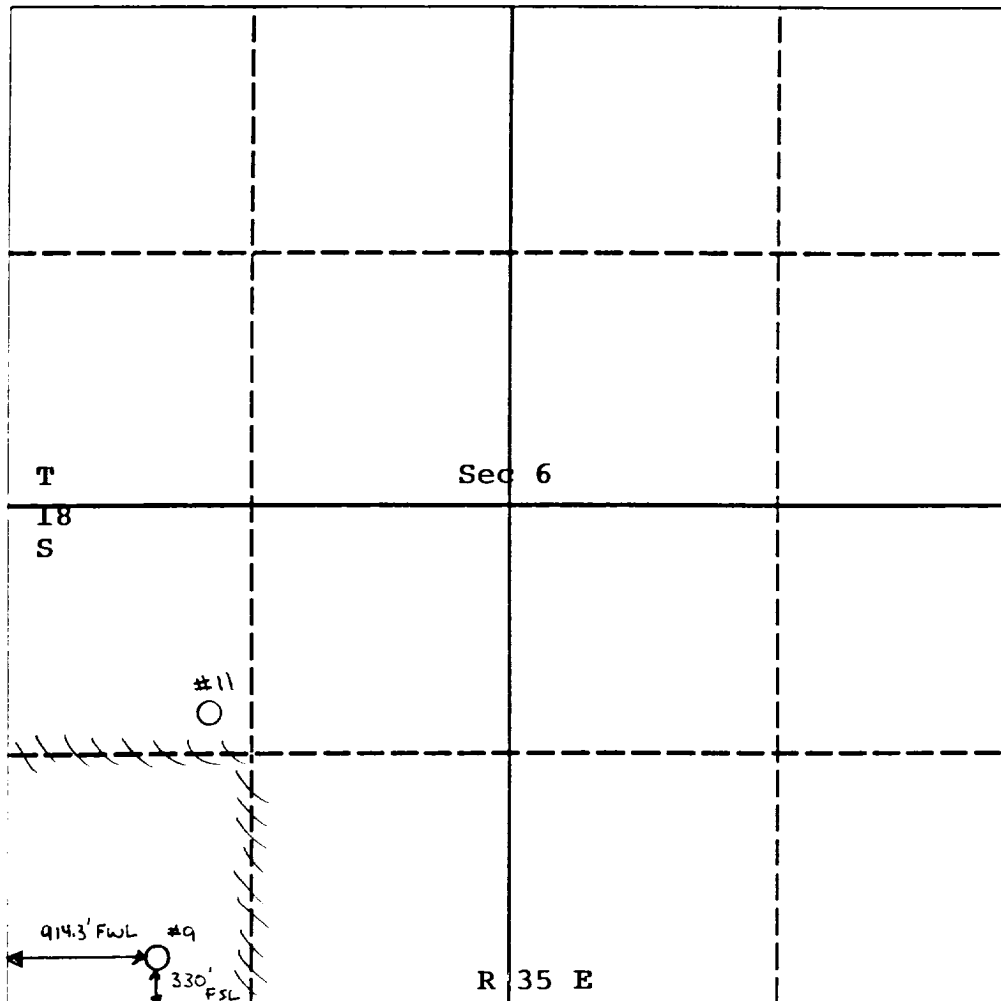

0 330 660 990 1320 1650 1980 2310 2640 2000 1500 1000 500 0