

NEW MEXICO OIL CONSERVATION COMMISSION  
Santa Fe, New Mexico

Form G-101  
Revised (12/1/55)

NOTICE OF INTENTION TO DRILL

Notice must be given to the District Office of the Oil Conservation Commission and approval obtained before drilling or recompletion begins. If changes in the proposed plan are considered advisable, a copy of this notice showing such changes will be returned to the sender. Submit this notice in QUINTUPLICATE. One copy will be returned following approval. See additional instructions in Rules and Regulations of the Commission. If State Land submit 6 Copies Attach Form G- 128 in triplicate to first 3 copies of form G-101

Midland, Texas

(Place)

SEP 26 1962

(Date)

OIL CONSERVATION COMMISSION  
SANTA FE, NEW MEXICO

Gentlemen:

You are hereby notified that it is our intention to commence the Drilling of a well to be known as

Tidewater Oil Company

(Company or Operator)

State "AM"

(Lease)

Well No. 7, in I The well is

(Unit)

located 990 feet from the East line and 2310 feet from the

South

line of Section 7, T. 18-S, R. 35-E, NMPM.

(GIVE LOCATION FROM SECTION LINE) Vacuum Abo Pool, Lea County

If State Land the Oil and Gas Lease is No. E-7653

If patented land the owner is

Address

We propose to drill well with drilling equipment as follows: Rotary

The status of plugging bond is Blanket Bond dated November 30, 1937

With Saint Paul - Indemnity

Drilling Contractor Rowan Drilling Company

We intend to complete this well in the Vacuum Abo Reef

formation at an approximate depth of 9000 feet.

CASING PROGRAM

We propose to use the following strings of Casing and to cement them as indicated:

Size of Hole	Size of Casing	Weight per Foot	New or Second Hand	Depth	Sacks Cement
17-1/4"	13-3/8"	36#	New	300'	400
11"	8-5/8"	32#	New	3000'	750
7-7/8"	5-1/2"	17#	New	9100'	1000

If changes in the above plans become advisable we will notify you immediately.

ADDITIONAL INFORMATION (If recompletion give full details of proposed plan of work.)

Approved....., 19.....  
Except as follows:

OIL CONSERVATION COMMISSION

By.....

Sincerely yours,

Tidewater Oil Company

(Company or Operator)

By.....

Position Authorized Employee

Send Communications regarding well to

Name C. L. Wade

Address Box 547, Hobbs, New Mexico

NEW MEXICO OIL CONSERVATION COMMISSION  
WELL LOCATION AND ACREAGE DEDICATION PLAT  
SEE INSTRUCTIONS FOR COMPLETING THIS FORM ON THE REVERSE SIDE

FORM C-128  
Revised 5-1-57

SECTION A

Operator <b>Tidewater Oil Company</b>		Lease <b>State "AN"</b>		Well No. <b>7</b>
Unit Letter <b>I</b>	Section <b>7</b>	Township <b>18-S</b>	Range <b>35-E</b>	County <b>Lea</b>
Actual Footage Location of Well: <b>2310</b> feet from the <b>South</b> line and <b>990</b> feet from the <b>East</b> line				
Ground Level Elev.	Producing Formation <b>Abo Reef</b>		Pool <b>Vacuum Abo Reef</b>	Dedicated Acreage: <b>40</b> Acres

1. Is the Operator the only owner in the dedicated acreage outlined on the plat below? YES ☒ NO \_\_\_\_ ("Owner" means the person who has the right to drill into and to produce from any bore hole and to appropriate the production either for himself or for himself and another. (65-3-29 (e) NMSA 1935 Comp)
2. If the answer to question one is "no," have the interests of all the owners been consolidated by communitization agreement or otherwise? YES \_\_\_\_ NO \_\_\_\_ If answer is "yes," Type of Consolidation \_\_\_\_
3. If the answer to question two is "no," list all the owners and their respective interests below:

Owner	Land Description

SECTION B

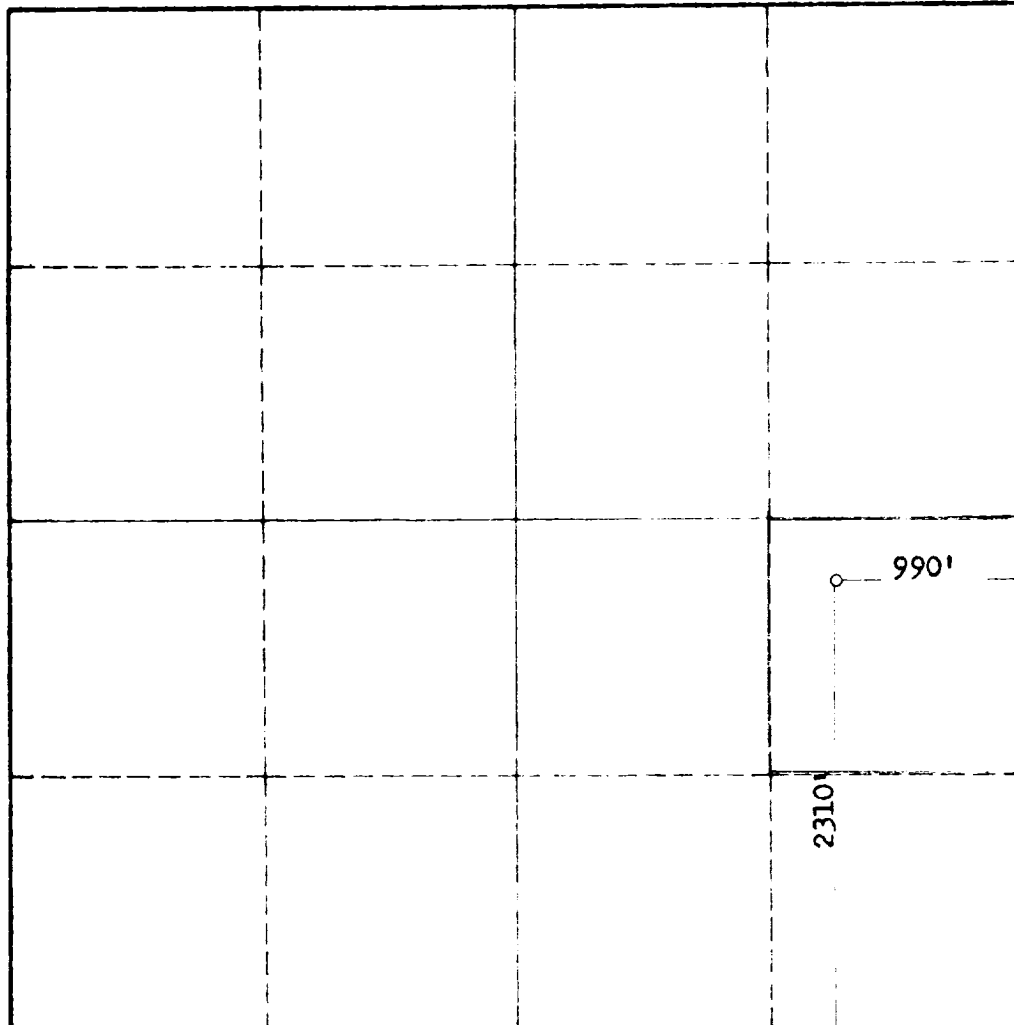

CERTIFICATION

I hereby certify that the information in SECTION A above is true and complete to the best of my knowledge and belief.

Name J. M. Amis  
Position Authorized Employee  
Company Tidewater Oil Company  
Date September 26, 1962

I hereby certify that the well location shown on the plat in SECTION B was plotted from field notes of actual surveys made by me or under my supervision, and that the same is true and correct to the best of my knowledge and belief.

Date Surveyed September 26, 1962  
Registered Professional Engineer and/or Land Surveyor J. M. Amis  
Certificate No. 5129 and 465

0 330 660 990 1320 1650 1980 2310 2640 2000 1500 1000 500 0