

LAND CONSERVATION DIVISION

STATE OF NEW MEXICO
ENERGY AND MINERALS DEPARTMENT

P. O. BOX 2088
SANTA FE, NEW MEXICO 87501

Form C-102
Revised 10-1-78

All distances must be from the outer boundaries of the Section.

Operator Mobil Producing Texas & New Mexico, Inc.			Lease State Sec. 27		Well No. #2
Unit Letter H	Section 27	Township T-18-S	Range R-35E	County Lea	
Actual Footage Location of Well:					
1980'	feet from the North	line and	660'	feet from the East	line
Ground Level Elev. 3887'	Producing Formation Devonian	Pool South Vacuum		Dedicated Acreage: NA Acres	

1. Outline the acreage dedicated to the subject well by colored pencil or hatchure marks on the plat below.
2. If more than one lease is dedicated to the well, outline each and identify the ownership thereof (both as to working interest and royalty).
3. If more than one lease of different ownership is dedicated to the well, have the interests of all owners been consolidated by communitization, unitization, force-pooling, etc?

☐ Yes ☐ No If answer is "yes," type of consolidation _____

If answer is "no," list the owners and tract descriptions which have actually been consolidated. (Use reverse side of this form if necessary.) _____

No allowable will be assigned to the well until all interests have been consolidated (by communitization, unitization, forced-pooling, or otherwise) or until a non-standard unit, eliminating such interests, has been approved by the Division. There are no other wells in this quarter-quarter of the Section.

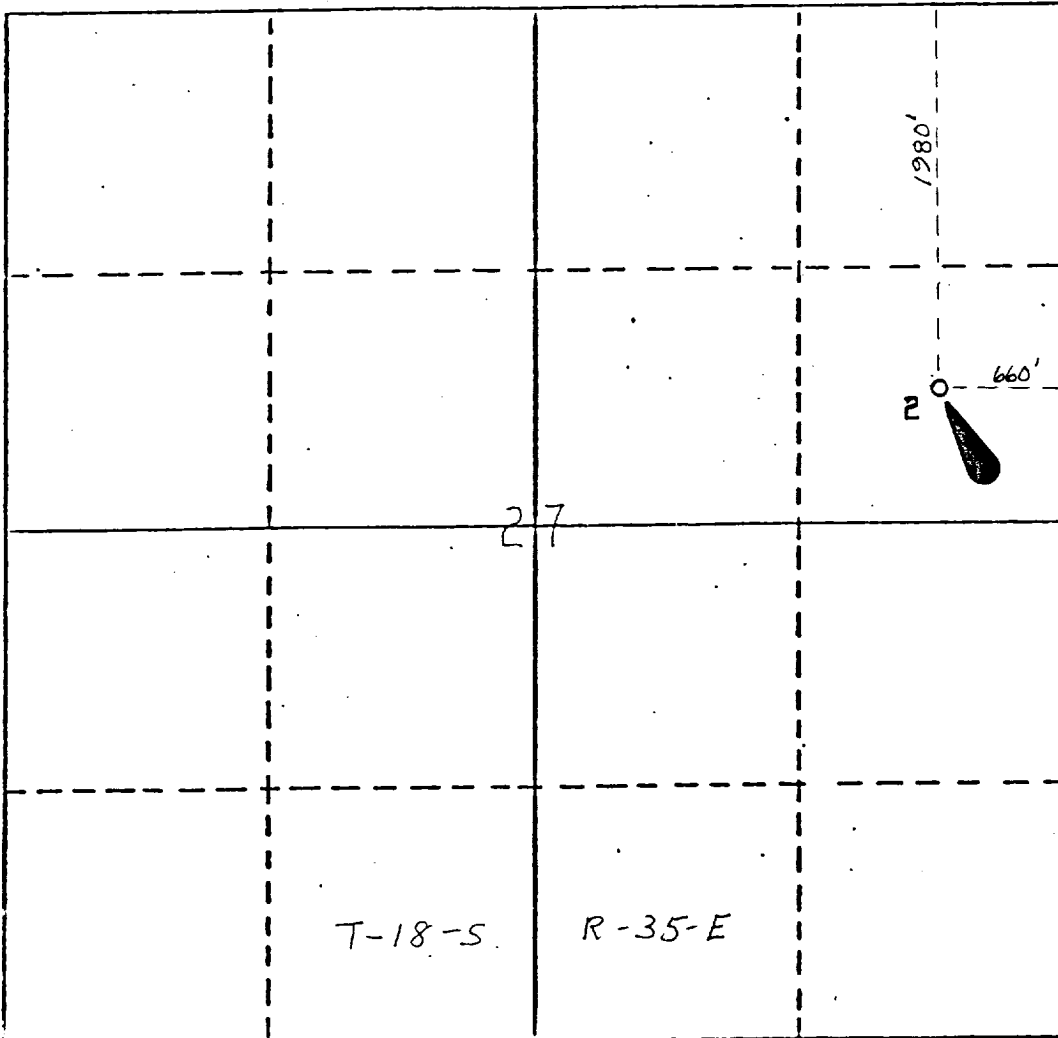

CERTIFICATION

I hereby certify that the information contained herein is true and complete to the best of my knowledge and belief.

M. E. Sweeney

Name
M. E. Sweeney
Position Manager,
Environmental & Regulatory
Company Mobil Exploration &
Producing U.S. Inc. as Agent for
Date Mobil Producing Texas &
New Mexico, Inc. 12/15/87

I hereby certify that the well location shown on this plat was plotted from field notes of actual surveys made by me or under my supervision, and that the same is true and correct to the best of my knowledge and belief.

Date Surveyed

Registered Professional Engineer
and/or Land Surveyor

Certificate No.