

NEW MEXICO OIL CONSERVATION COMMISSION
Well Location and Acreage Dedication Plat

Section A.

Date 11/17/59
Operator Lease STATE-SEC. 27
Well No. 2 Unit Letter Section 27 Township 13S Range 35E NMPM
Located 660 Feet From East Line, 1980 Feet From North Line
County Lea G. L. Elevation Dedicated Acreage Acres
Name of Producing Formation Devonian Pool South Vacuum Devonian

1. Is the Operator the only owner* in the dedicated acreage outlined on the plat below?
Yes X No .
2. If the answer to question one is "no," have the interests of all the owners been consolidated by communitization agreement or otherwise? Yes No . If answer is "yes," Type of Consolidation
3. If the answer to question two is "no," list all the owners and their respective interests below:

Owner

Land Description

Section B.

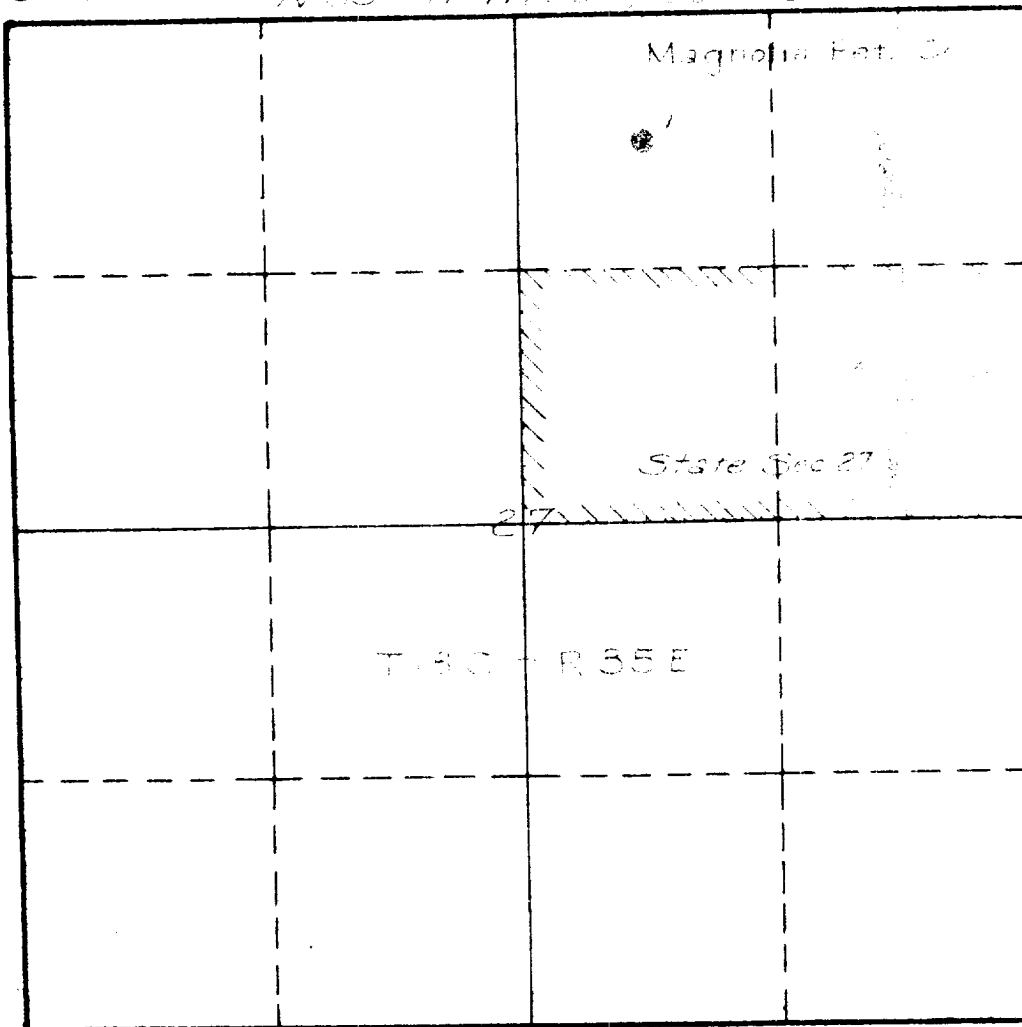

This is to certify that the information in Section A above is true and complete to the best of my knowledge and belief.

(Operator)

(Representative)

BOX 2406, Hobbs, New Mexico
Address

This is to certify that the well location shown on the plat in Section B was plotted from field notes of actual surveys made by me or under my supervision and that the same is true and correct to the best of my knowledge and belief.

Date Surveyed April 16, 1959

John L. Sanders
Registered Professional
Engineer and/or Land Surveyor.

Certificate No. 3339