

NEW MEXICO
OIL CONSERVATION COMMISSION

Form C-128

Well Location and/or Gas Proration Plat

Date 3-19-57

Operator BOB L JOHNSON

Lease SINCLAIR STATE

Well No. 1 Section 30 Township 18.5 Range 35.6 NMPM

Located 1980 Feet From SOUTH Line, 1980 Feet From WEST Line,

LEA County, New Mexico. G. L. Elevation _____

Name of Producing Formation _____ Pool _____ Dedicated Acreage _____

(Note: All distances must be from outer boundaries of Section)

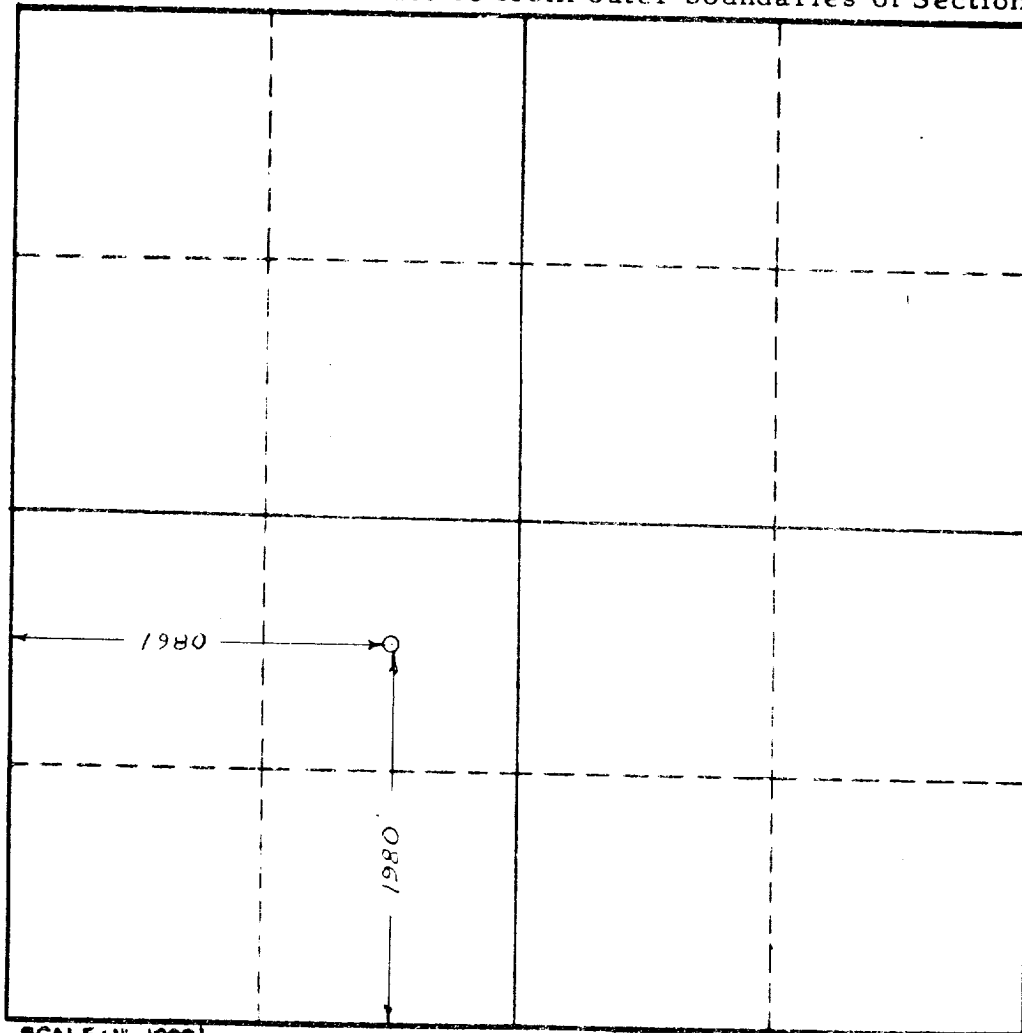

SCALE: 1" = 1000'

1. Is this Well a Dual Comp.? Yes ☐ No ☒
2. If the answer to Question 1 is yes, are there any other dually completed wells within the dedicated acreage? Yes ☐ No ☒

This is to certify that the above plat was prepared from field notes of actual surveys made by me or under my supervision and that the same are true and correct to the best of my knowledge and belief.

Name Bob L. Johnson

Position _____

Representing _____

Address 1202 Ruthbert Midland, Texas

Date Surveyed 3-18-57

Registered John W. What
Professional Engineer and/or
Land Surveyor

