

NEW MEXICO OIL CONSERVATION COMMISSION
Well Location and Acreage Dedication Plat

Section A.

Date December 8, 1956

Operator The Pure Oil Company Lease South Vacuum Unit
Well No. 2-35 Unit Letter 1 Section 35 Township 18-S Range 35-E NMPM
Located 1980 Feet From South Line, 660 Feet From East Line
County Lee G. L. Elevation 3860' SCF Dedicated Acreage 160 Acres
Name of Producing Formation McKee Pool South Vacuum McKee

1. Is the Operator the only owner* in the dedicated acreage outlined on the plat below?
Yes _____ No X _____.
2. If the answer to question one is "no," have the interests of all the owners been consolidated by communitization agreement or otherwise? Yes X No _____. If answer is "yes," Type of Consolidation State Unit Agreement
3. If the answer to question two is "no," list all the owners and their respective interests below:

Owner

Land Description

Section B

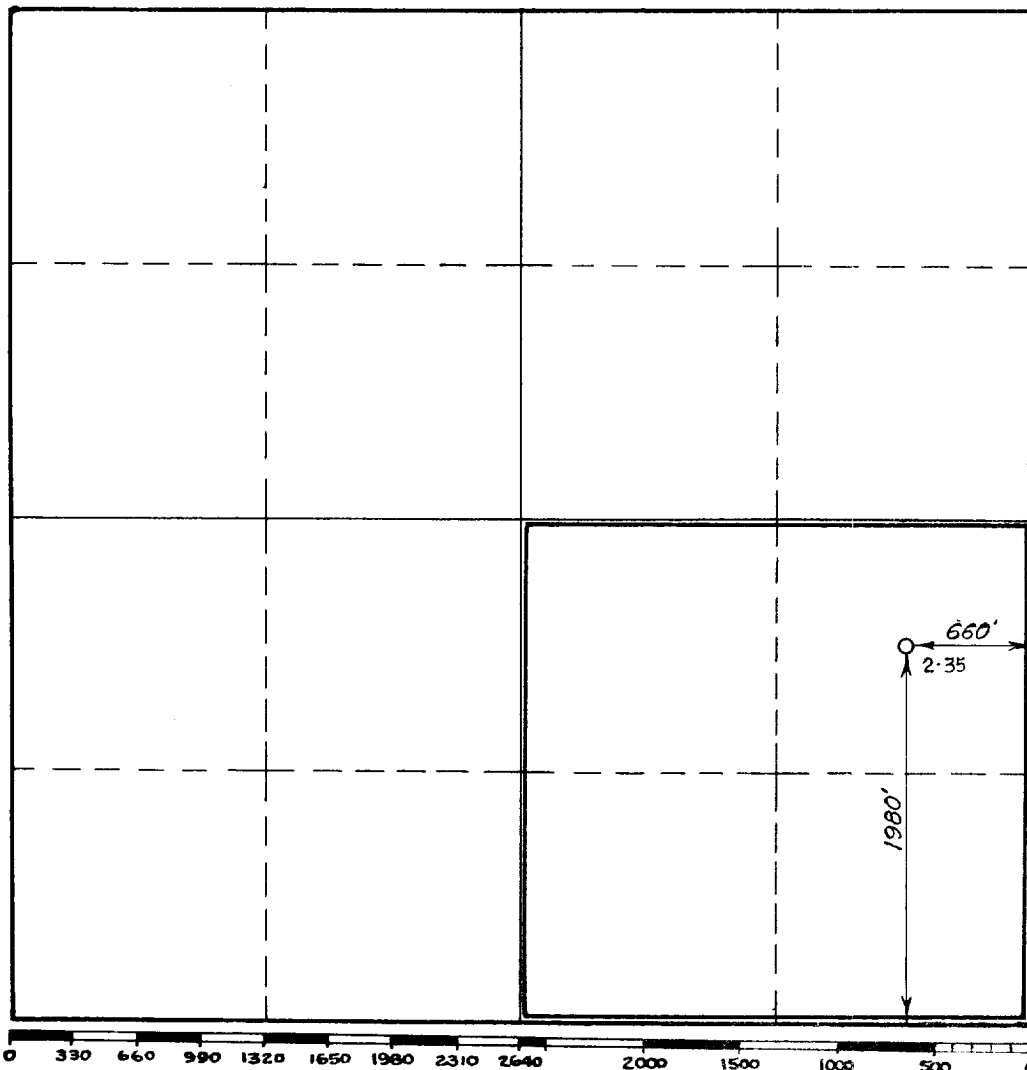

This is to certify that the information in Section A above is true and complete to the best of my knowledge and belief.

The Pure Oil Company
(Operator)

[Signature]
(Representative)

Box 2107, Fort Worth 1, Texas
Address

This is to certify that the well location shown on the plat in Section B was plotted from field notes of actual surveys made by me or under my supervision and that the same is true and correct to the best of my knowledge and belief.

Date Surveyed Jan. 16, 1956

[Signature]
Registered Professional
Engineer and/or Land Surveyor.

Texas

Certificate No. 5093

INSTRUCTIONS FOR COMPLETION:

1. Operator shall furnish and certify to the information called for in Section A.
2. Operator shall outline the dedicated acreage for both oil and gas wells on the plat in Section B.
3. A registered professional engineer or land surveyor registered in the State of New Mexico or approved by the Commission shall show on the plat the location of the well and certify this information in the space provided.
4. All distances shown on the plat must be from the outer boundaries of Section.
5. If additional space is needed for listing owners and their respective interests as required in question 3, Section A, please use space below

* "Owner" means the person who has the right to drill into and to produce from any pool and to appropriate the production either for himself or for himself and another. (65-3-29 (e) NMSA 1953 Comp.)