

NEW MEXICO OIL CONSERVATION COMMISSION

Well Location and Acreage Dedication Plat

Form C-128
Revised 5/1/57

HOBBS OFFICE OCC

Section A.

Date 10-9-57
1957 OCT 14 AM 11:01

Operator Amerada Pet. Corp. Lease State W H B
Well No. 1 Unit letter O Section 14 Township 18 S Range 37E NMPM
Located 660 Feet From South Line, 1650 Feet From East Line
County Lea C. L. Elevation - Dedicated Acreage 40 Acres
Name of Producing Formation Grayburg Pool Hobbs

1. Is the Operator the only owner* in the dedicated acreage outlined on the plat below?
Yes X No .
2. If the answer to question one is "no," have the interests of all the owners been consolidated by communitization agreement or otherwise? Yes No . If answer is "yes," Type of Consolidation
3. If the answer to question two is "no," list all the owners and their respective interests below:

Owner

Land Description

Section B

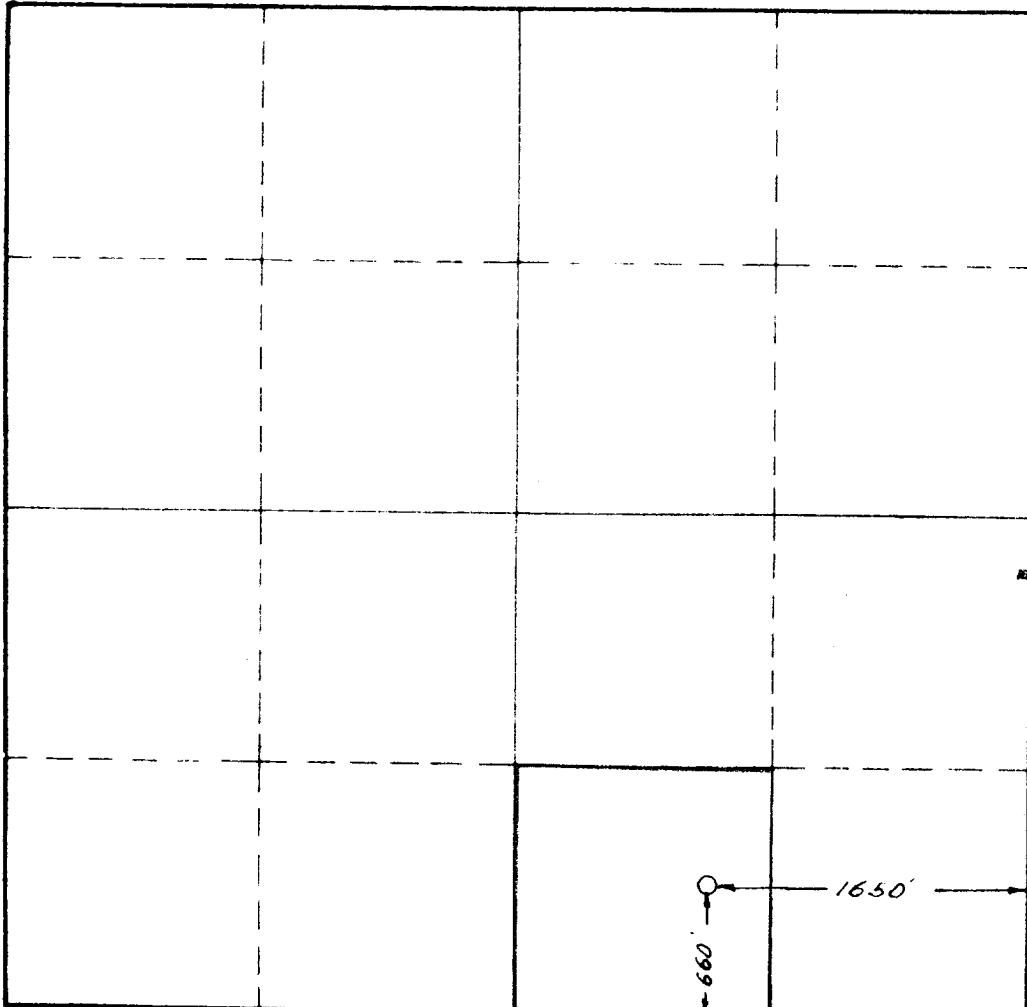

This is to certify that the information in Section A above is true and complete to the best of my knowledge and belief.

Amerada Petroleum Corporation

(Operator)

R. C. Capps
(Representative)

Drawer "D" - Monument, N.M.

Address

This is to certify that the well location shown on the plat in Section B was plotted from field notes of actual surveys made by me or under my supervision and that the same is true and correct to the best of my knowledge and belief.

Date Surveyed 10-8-57

John W. West
Registered Professional
Engineer and/or Land Surveyor.

Certificate No. 676

(See instructions for completing this form on the reverse side)