

NEW MEXICO OIL CONSERVATION COMMISSION  
Santa Fe, New Mexico

Form G-101  
Revised (12/1/55)

NOTICE OF INTENTION TO DRILL

Notice must be given to the District Office of the Oil Conservation Commission and approval obtained before drilling or recompletion begins. If changes in the proposed plan are considered advisable, a copy of this notice showing such changes will be returned to the sender. Submit this notice in **QUINTUPLICATE**. One copy will be returned following approval. See additional instructions in **RG-101** and Regulations of the Commission. If State Land submit 6 Copies Attach Form G-128 in triplicate to first 3 copies of form G-101

Midland, Texas

April 28, 1958

(Place)

(Date)

OIL CONSERVATION COMMISSION  
SANTA FE, NEW MEXICO

Gentlemen:

You are hereby notified that it is our intention to commence the Drilling of a well to be known as  
**Heath Humbard and Long Operating Company**

(Company or Operator)

**Gulf Tomlinson**

(Lease)

Well No. **1**

**K**

(Unit)

The well is

located **2221** feet from the **South** line and **2175** feet from the

**West**

line of Section **1**, T. **18**, R. **38**, NMPM.

(GIVE LOCATION FROM SECTION LINE)

**Wildcat**

Pool, **Lee**

County

If State Land the Oil and Gas Lease is No. \_\_\_\_\_

If patented land the owner is **Mr. Ted Rose**

Address **Hobbs, New Mexico, Star Route**

We propose to drill well with drilling equipment as follows: \_\_\_\_\_

**Reverse circulation unit (See Attached)**

The status of plugging bond is **Applied for**

Drilling Contractor **X-Port Well Service Company**

We intend to complete this well in the **San Andres**

formation at an approximate depth of **5250** feet.

CASING PROGRAM

We propose to use the following strings of Casing and to cement them as indicated:

Size of Hole	Size of Casing	Weight per Foot	New or Second Hand	Depth	Sacks Cement
<b>11"</b>	<b>9 5/8</b>	<b>32.30</b>	<b>New</b>	<b>324</b>	<b>Circulated(200)</b>
<b>8 3/4</b>	<b>7"</b>	<b>23.00</b>	<b>New</b>	<b>5200</b>	<b>100 sx</b>

If changes in the above plans become advisable we will notify you immediately.

ADDITIONAL INFORMATION (If recompletion give full details of proposed plan of work.)

Approved \_\_\_\_\_, 19\_\_\_\_\_  
Except as follows:

OIL CONSERVATION COMMISSION

By **R. F. Montgomery**

Sincerely yours,

**Heath Humbard and Long Operating Co.**

(Company or Operator)

By **H. D. Heath**

Position **Partner**

Send Communications regarding well to

Name **Heath Humbard and Long**

Address **Suite A, Ezell Bldg., Midland, Texas**

It is our intention to re-enter the Bishop Uranium Corp. No. 1 Gulf-Tomlinson in Sec. 1, T18S R38E and clean out to the original total depth of 5254 feet. We then propose to run straddle packers and test two separate zones of porosity in the San Andres formations. If fluid recovery is satisfactory, we will run 7 inch casing and complete the well.

Revised 5/1/57

## NEW MEXICO OIL CONSERVATION COMMISSION

## Well Location and Acreage Dedication Plat

## Section A.

Date

Operator Heath Humbard & Long Operating Co. Gulf Tomlinson 1 PM 2:54  
 Well No. 1 Unit Letter K Section 1 Township 18 Range 38 NMFM  
 Located 2221 Feet From South Line, 2175 Feet From West Line  
 County Lea G. L. Elevation 3647.3 Dedicated Acreage 40 Acres  
 Name of Producing Formation San Andres Pool Wildcat

1. Is the Operator the only owner\* in the dedicated acreage outlined on the plat below?  
Yes ☒ No ☐.
2. If the answer to question one is "no," have the interests of all the owners been consolidated by communitization agreement or otherwise? Yes ☐ No ☐. If answer is "yes," Type of Consolidation \_\_\_\_\_
3. If the answer to question two is "no," list all the owners and their respective interests below:

OwnerLand Description



## Section B

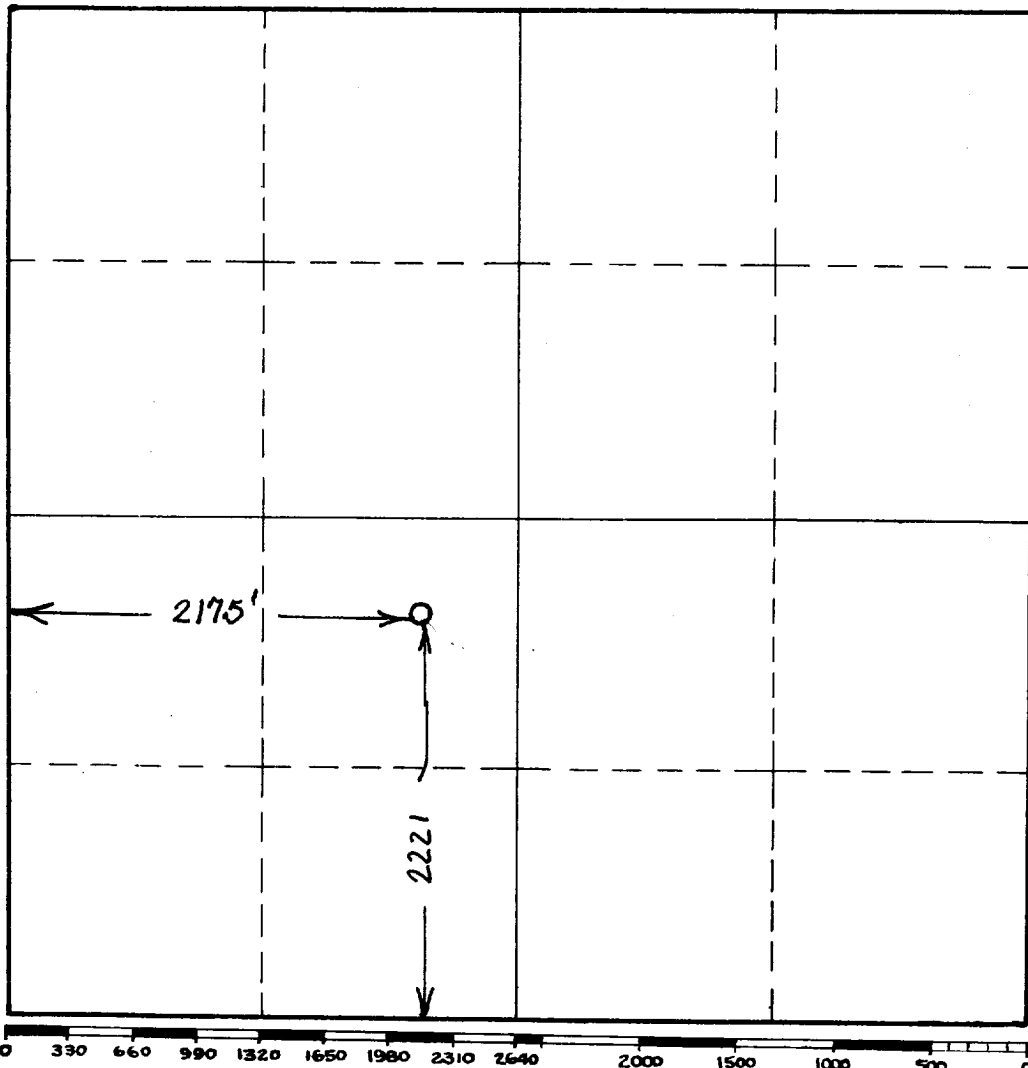

This is to certify that the information in Section A above is true and complete to the best of my knowledge and belief.

**Heath Humbard and Long Operating Company**

(Operator)

*H. H. Heath*

(Representative)

**Suite A - Ezell Building  
Midland, Texas**

Address

This is to certify that the well location shown on the plat in Section B was plotted from field notes of actual surveys made by me or under my supervision and that the same is true and correct to the best of my knowledge and belief.

Date Surveyed 11-15-57

**Originally surveyed by  
John W. West**

Registered Professional  
Engineer and/or Land Surveyor.

Certificate No. 676

(See instructions for completing this form on the reverse side)

INSTRUCTIONS FOR COMPLETION.

1. Operator shall furnish and certify to the information called for in Section A.
2. Operator shall outline the dedicated acreage for both oil and gas wells on the plat in Section B.
3. A registered professional engineer or land surveyor registered in the State of New Mexico or approved by the Commission shall show on the plat the location of the well and certify this information in the space provided.
4. All distances shown on the plat must be from the outer boundaries of Section.
5. If additional space is needed for listing owners and their respective interests as required in question 3, Section A, please use space below

\* "Owner" means the person who has the right to drill into and to produce from any pool and to appropriate the production either for himself or for himself and another. (65-3-29 (e) NMSA 1953 Comp.)