

NEW MEXICO OIL CONSERVATION COMMISSION

Well Location and Acreage Dedication Plat

HOBBS OFFICE OCC

Section A.

1958 APR 22-58 3:38

Operator O. D. Alsabrook Lease Sanders
Well No. 1 Unit Letter J Section 3 Township 18 S. Range 38 E. NMFM
Located 1980 Feet From South Line, 1980 Feet From East Line
County Lea G. L. Elevation 3649.2" Dedicated Acreage 40 Acres
Name of Producing Formation San Andres Pool San Andres

1. Is the Operator the only owner* in the dedicated acreage outlined on the plat below?
Yes No No No.
2. If the answer to question one is "no," have the interests of all the owners been consolidated by communitization agreement or otherwise? Yes Yes No No. If answer is "yes," Type of Consolidation Operating agreement
3. If the answer to question two is "no," list all the owners and their respective interests below:

Owner

Land Description

Section 8

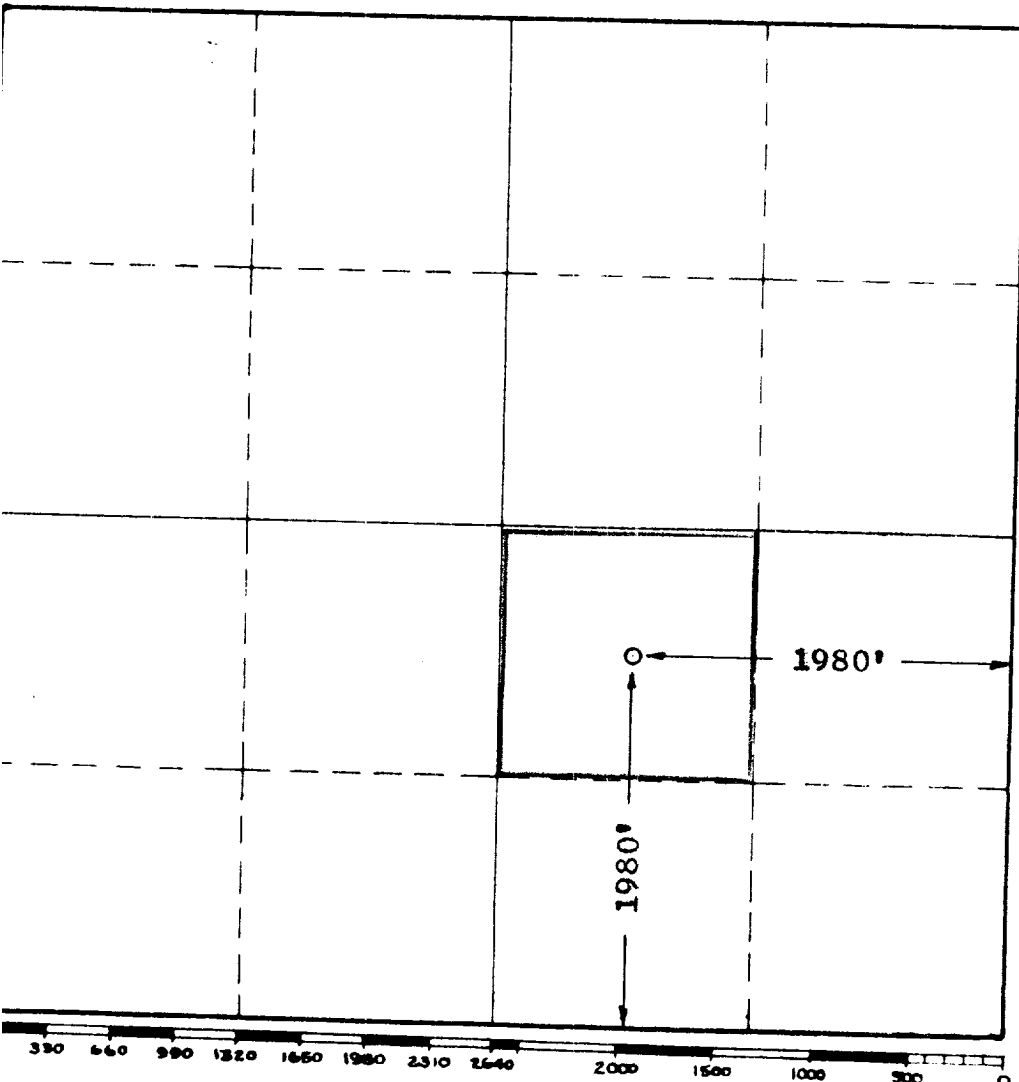

This is to certify that the information in Section A above is true and complete to the best of my knowledge and belief.

O. D. Alsabrook

(Operator)

Howard P. Helmer
Agent

(Representative)

519 First National Bank Bldg.
Dallas, Texas
Address

This is to certify that the well location shown on the plat in Section B was plotted from field notes of actual surveys made by me or under my supervision and that the same is true and correct to the best of my knowledge and belief.

Date Surveyed 4-22-58

John W. West
Registered Professional
Engineer and/or Land Surveyor.