

DEPARTMENT OF THE STATE GEOLOGIST  
NEW MEXICO SCHOOL OF MINES  
SOCORRO, NEW MEXICO

## NOTICE OF INTENTION TO DRILL NEW WELL

Notice must be given to the State Geologist or to the proper Oil and Gas Inspector and approval obtained before drilling begins. If changes in the proposed plan are considered advisable a copy of this notice showing such changes will be returned to the sender. Submit this notice in duplicate.

Mr. **Robert Halley, Carlsbad, N.M.** **Midland, Texas. March 29, 1930**  
State Geologist,  
Socorro, N. Mex.

Dear Sir:

You are hereby notified that it is our intention to commence the drilling of a well to be known as  
**State "A"** Well No. **One** in **SS/4** of Sec. **Seven**  
T. **18 South**, R. **38 East**, N. M. P. M., **Hobbs** Oil Field,  
**Lea** County.

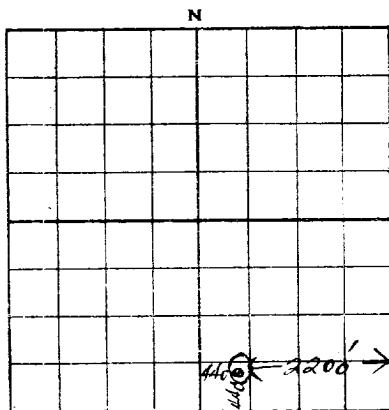

AREA 640 ACRES

LOCATE WELL CORRECTLY

The well is **440** feet { **N.** } of **South** line and **2200** feet  
{ **E.** }  
{ **W.** }  
of **East** line of **Section 7-18-38**

(Give location from section or other legal subdivision lines.  
Cross out wrong directions.)

If state land the oil and gas lease is No. **1-1646**  
Assignment No. ....

If patented land the owner is .....  
Address .....

The lessee is **Mallanar Oil & Gas Company** Address **Artesia, New Mexico.**

The elevation of the derrick floor above sea level is ..... feet. We propose to drill well with  
No. **Rotary & Cable tools**

MAKE OF DRILL

We propose to use the following strings of casing and to land or cement them as indicated.

SIZE OF CASING	WEIGHT PER FOOT	NEW OR SECOND HAND	DEPTH	LANDED OR CEMENTED
<b>20"</b>	<b>90</b>	<b>S. H.</b>	<b>125</b>	<b>Landed</b>
<b>12 1/2"</b>	<b>50</b>	<b>New &amp; S. H. Mixed</b>	<b>1400</b>	<b>Cemented</b>
<b>10"</b>	<b>40</b>	<b>New-Seamless</b>	<b>2700</b>	<b>Cemented</b>
<b>8 1/2"</b>	<b>32</b>	<b>New-Seamless</b>	<b>3600</b>	<b>Cemented</b>
<b>6-5/8"</b>	<b>24</b>	<b>New-Seamless</b>	<b>4000</b>	<b>Cemented</b>

If changes in the above plan become advisable we will notify you before cementing or landing casing.  
We estimate that the first productive oil or gas sand should occur at a depth of about **3200** feet.  
Additional information:

Approved

4/4

1930

Except as follows:

20" Pipe must be cemented

*R. Halley*  
STATE GEOLOGIST OR OIL AND GAS INSPECTOR.

Sincerely yours,

LANDRITH PRODUCTION CORPORATION

COMPANY OR OPERATOR.

By

*A. N. Hendrickson*  
Supt.

Position

Send communications regarding well to

Name **A. N. Hendrickson**Address **Box #1117, Midland, Texas.**