

NEW MEXICO OIL CONSERVATION COMMISSION
WELL LOCATION AND ACREAGE DEDICATION PLAT

Form C-102
Supersedes C-128
Effective 1-1-65

All distances must be from the outer boundaries of the Section.

Operator Amerada Petroleum Corporation			Lease B. Hardin <i>JUL 19 11 45 AM '68</i>		Well No. 2
Unit Letter N	Section 18	Township 18-S	Range 38-E	County Lea County, New Mexico	
Actual Footing Location of Well:					
330	feet from to South	line and	2310	feet from to West	line
Ground Level Elev.	Producing Formation San Andres		Pool Hobbs	Dedicated Acreage: 40 Acres	

1. Outline the acreage dedicated to the subject well by colored pencil or hatchure marks on the plat below.
2. If more than one lease is dedicated to the well, outline each and identify the ownership thereof (both as to working interest and royalty).
3. If more than one lease of different ownership is dedicated to the well, have the interests of all owners been consolidated by communitization, unitization, force-pooling, etc?

☐ Yes ☐ No If answer is "yes," type of consolidation _____

If answer is "no," list the owners and tract descriptions which have actually been consolidated. (Use reverse side of this form if necessary.) _____

No allowable will be assigned to the well until all interests have been consolidated (by communitization, unitization, forced-pooling, or otherwise) or until a non-standard unit, eliminating such interest, has been approved by the Commission.

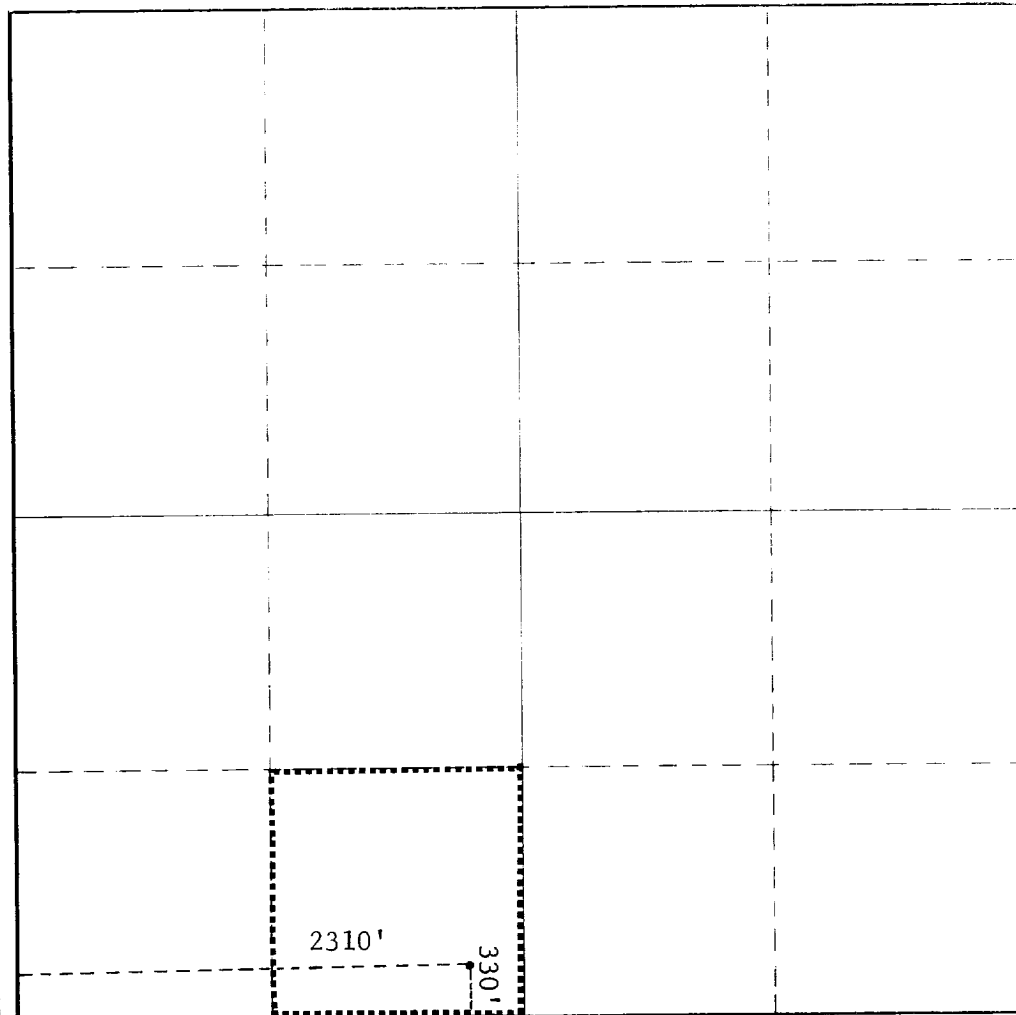

CERTIFICATION

I hereby certify that the information contained herein is true and complete to the best of my knowledge and belief.

John H. Swendeg

District Engineer

Amerada Petroleum Corp.

7-17-68

I hereby certify that the well location shown on this plat was plotted from field notes of actual surveys made by me or under my supervision, and that the same is true and correct to the best of my knowledge and belief.

State Surveyor

Independent Professional Engineer and/or Land Surveyor

Notary Public

0 330 660 990 1320 1650 1980 2310 2640 2000 1500 1000 500 0