

N.

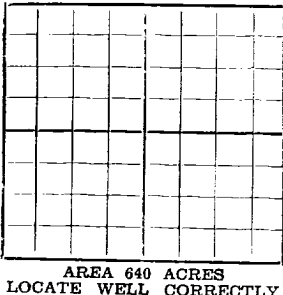

NEW MEXICO STATE LAND OFFICE
SANTA FE, NEW MEXICO

DEPARTMENT OF THE STATE GEOLOGIST

WELL RECORD

Mail to State Geologist, Santa Fe, New Mexico, not more than ten days after completion of well. Indicate questionable data by following it with (?). Submit in duplicate.

Company Empire Gas & Fuel (Inc) Address Bartlesville, Okla.
Send correspondence to D.D. Rodie Address Drawer G, Hobbs, N. Mex.
Well No. 5 in NW 1/4 of Sec. 19 T. 18
R. 38, N. M. P. M. Hobbs Oil Field Lea County.
If State land the oil and gas lease is No. _____ Assignment No. _____
If patented land the owner is Boon Harbin Address _____
The lessee is _____ Address _____
If not state or patented land, give status _____
Drilling commenced 10-7 19 50 Drilling was completed 11-21 19 50
Name of drilling contractor Loran Drilling Co. Address Wichita Falls, Texas
Elevation above sea level at top of casing 3665 feet.
The information given is to be kept confidential until _____ 19 _____

OIL SANDS OR ZONES

No. 1, from line production No. 4, from _____ to _____
No. 2, from _____ to _____ No. 5, from _____ to _____
No. 3, from _____ to _____ No. 6, from _____ to _____

IMPORTANT WATER SANDS

No. 1, from _____ to _____ No. 3, from _____ to _____
No. 2, from _____ to _____ No. 4, from _____ to _____

CASING RECORD

SIZE	WEIGHT PER FOOT	THREADS PER INCH	MAKE	AMOUNT	KIND OF SHOE	CUT AND PULLED FROM	PERFORATED		PURPOSE
							FROM	TO	
<u>12 1/2</u>	<u>50</u>	<u>8</u>		<u>241</u>	<u>Tex. Int.</u>				
<u>9"OD</u>	<u>38</u>			<u>2750</u>	<u>"</u>				
<u>7"OD</u>	<u>24</u>	<u>10</u>		<u>2985</u>					

MUDDING AND CEMENTING RECORD

SIZE	WHERE SET	NO. SACKS OF CEMENT	METHODS USED	MUD GRAVITY	AMOUNT OF MUD USED
<u>12 1/2</u>	<u>241</u>	<u>200</u>	<u>Halliburton</u>		
<u>9"OD</u>	<u>2750</u>	<u>500</u>	<u>"</u>		
<u>7"OD</u>	<u>2985</u>	<u>200</u>	<u>"</u>		

PLUGS AND ADAPTERS

Heaving plug—Material _____ Length _____ Depth Set _____
Adapters—Material _____ Size _____

SHOOTING RECORD

SIZE	SHELL USED	EXPLOSIVE USED	QUANTITY	DATE	DEPTH SHOT	DEPTH CLEANED OUT

TOOLS USED

Rotary tools were used from 0 feet to 4220 feet, and from _____ feet to _____ feet
Cable tools were used from _____ feet to _____ feet, and from _____ feet to _____ feet

PRODUCTION

Put to producing Nov. 23 19 50
The production of the first 24 hours was 3685 barrels of fluid of which 100 % was oil; _____ %
emulsion; _____ % water; and _____ % sediment. Gravity, Be _____
If gas well, cu. ft. per 24 hours _____ Gallons gasoline per 1,000 cu. ft. of gas _____
Rock pressure, lbs. per sq. in. _____

EMPLOYEES

H. Giles, Driller L. Havens, Driller
_____, Driller _____, Driller

FORMATION RECORD ON OTHER SIDE

I hereby swear or affirm that the information given herewith is a complete and correct record of the well and all work done on it so far as can be determined from available records.
Subscribed and sworn to before me this 10 Name D. D. Rodie
day of Dec, 19 50 Position Dist. Superintendent
D. E. Cherry Representing Empire Gas & Fuel Co.
Notary Public Company or Operator
My commission expires July 17, 1953

FORMATION RECORD

FROM	TO	THICKNESS IN FEET	FORMATION
0	102	102	caliche & sand
102	111	9	granite
111	114	3	sand
114	117	3	granite
117	221	104	sand & gravel
221	241	20	red bed
241	1188	947	red bed, sand & shells
1188	1334	146	hard sand
1334	1415	81	sand & lime
1415	1460	45	sand & red bed
1460	1472	12	gypsum
1472	1494	22	" & red bed
1494	1514	20	anhydrite
1514	1798	274	"
1798	1805	7	" & potash
1805	2106	301	salt & potash
2106	2349	243	salt
2349	2400	51	salt & potash
2400	2565	165	" & anhydrite
2565	2580	15	"
2580	2672	92	lime & anhydrite
2672	2835	163	anhydrite
2835	2970	135	lime
2970	3045	75	anhydrite & lime
3045	3447	402	sand & anhydrite
3447	3543	96	sand
3543	3675	132	anhydrite
3675	3808	133	sand & anhydrite
3808	3840	32	anhydrite
3840	3983	143	sand & anhydrite
3983	4220	237	lime (total depth)