

(SUBMIT IN TRIPLICATE)

UNITED STATES
DEPARTMENT OF THE INTERIOR
GEOLOGICAL SURVEY

Land Office _____

Lease No. **LC 032233 (d)**

Unit _____

SUNDRY NOTICES AND REPORTS ON WELLS

NOTICE OF INTENTION TO DRILL.....	<input checked="" type="checkbox"/>	SUBSEQUENT REPORT OF WATER SHUT-OFF.....	
NOTICE OF INTENTION TO CHANGE PLANS.....		SUBSEQUENT REPORT OF SHOOTING OR ACIDIZING.....	
NOTICE OF INTENTION TO TEST WATER SHUT-OFF.....		SUBSEQUENT REPORT OF ALTERING CASING.....	
NOTICE OF INTENTION TO RE-DRILL OR REPAIR WELL.....		SUBSEQUENT REPORT OF RE-DRILLING OR REPAIR.....	
NOTICE OF INTENTION TO SHOOT OR ACIDIZE.....		SUBSEQUENT REPORT OF ABANDONMENT.....	
NOTICE OF INTENTION TO PULL OR ALTER CASING.....		SUPPLEMENTARY WELL HISTORY.....	
NOTICE OF INTENTION TO ABANDON WELL.....			

(INDICATE ABOVE BY CHECK MARK NATURE OF REPORT, NOTICE, OR OTHER DATA)

Carper-Read-Hodges**January 2**, 19 **54****"Bowers"**Well No. **2** is located **990** ft. from ☒ **S** line and **330** ft. from ☒ **E** line of sec. **25****SE 1/4**

(1/4 Sec. and Sec. No.)

25**18 S**

(Twp.)

36 E

(Range)

NM PM

(Meridian)

East Hobbs

(Field)

Lea

(County or Subdivision)

New Mexico

(State or Territory)

The elevation of the derrick floor above sea level is **3635** ^{est.} ft.

DETAILS OF WORK

(State names of and expected depths to objective sands; show sizes, weights, and lengths of proposed casings; indicate mudding jobs, cementing points, and all other important proposed work)

We propose to drill this well to an approximate total depth of 4500' to test the San Andres formation. We will run approximately 1850' of 8 5/8" - 24# seamless casing and cement w/ 900 sac. We will run approximately 4425' of 5 1/2" casing and cement with enough cement to adequately cover the Seven Rivers formation.

Designation of Operator filed with Intention to Drill on No. 1 well.

I understand that this plan of work must receive approval in writing by the Geological Survey before operations may be commenced.

Company **Carper Drilling Co., Inc.**Address **Carper Bldg.****Artesia, N. M.**By *J. Marshall Kautz*Title **Vice-Pres.**

RECEIVED

JAN 6 - 1954

U. S. GEOLOGICAL SURVEY
ARTESIA, NEW MEXICO

Company Carper-Read-Hodges

Lease Bowers Well No. 2

Sec. 25 T. 18 S S., R. 38 E E., N.M.P.M.

Location 990' from S and 330' from E lines

County Lea, New Mexico

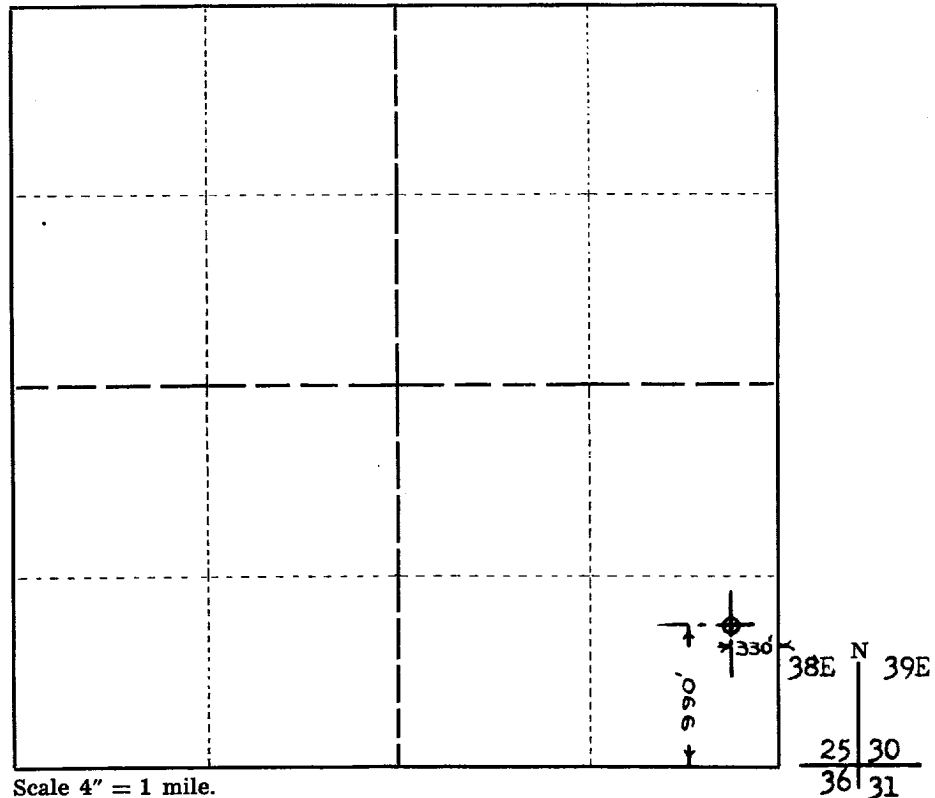

Scale 4" = 1 mile.

This is to certify that the above plat was prepared from field notes of actual surveys made by me or under my supervision and that the same are true and correct to the best of my knowledge and belief.

Seal:
Artesia, New Mexico

Clark E. Storm
Registered Professional
Engineer and Land Surveyor.

Surveyed December 1, 1953

14286-14307 Advocate Print

RECEIVED

1914-1915

OFFICE OF THE

LAND SURVEYOR

Company Carpet-Head-Boysen

Lease Bowers Well No. 2

Sec. 22 T. 18 S. R. 38 E. N.M.P.M.

Location 1000' from S and 250' from E

County Los New Mexico

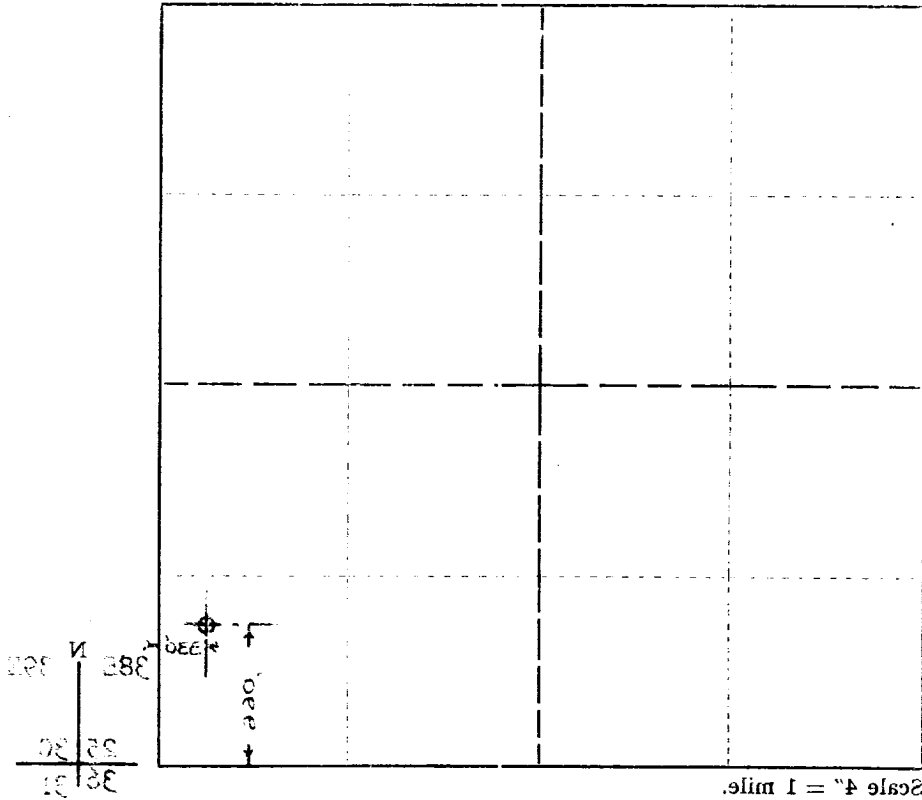

This is to certify that the above plat was prepared from field notes of actual surveys made by me or under my supervision and that the same are true and correct to the best of my knowledge and belief.

[Signature]

Registered Professional
Engineer and Land Surveyor

Seal:

Artesia, New Mexico

Surveyed December 1 1914

147-4-11307 Advocate Print